

COMPANY Phillips Petroleum Company

Well Name & No. _____ Lease No. _____

Location 990' from the North line and 1650' from the West line.

Being in the NE $\frac{1}{4}$ of the NW $\frac{1}{4}$

Sec. 33, T 29 N., R 3 W., N.M.P.M., Rio Arriba County, New Mexico.

Ground Elevation 7020, ungraded ground.

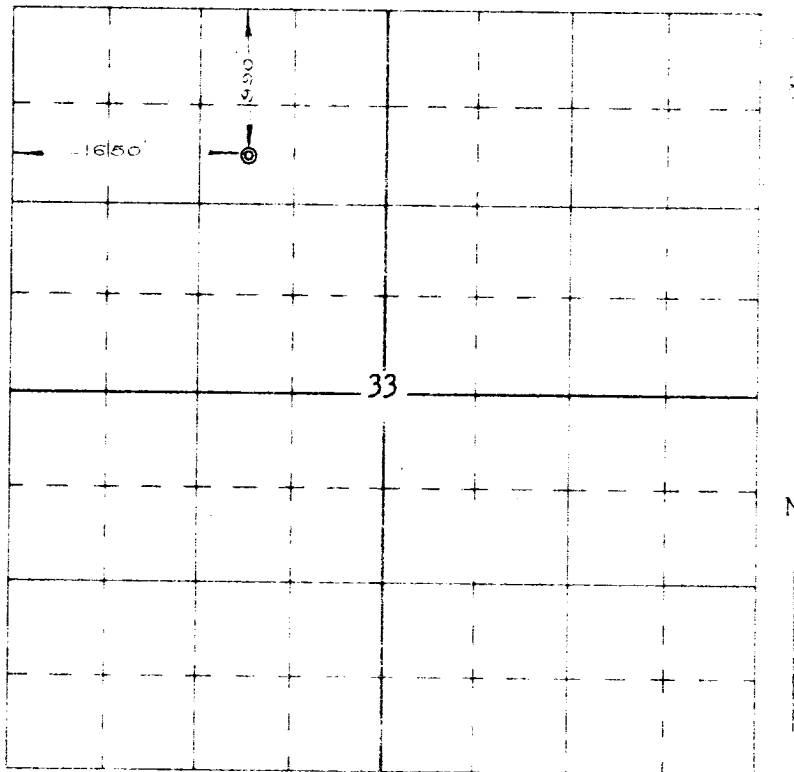

DEED SURVEY
FARMINGTON, NEW MEXICO

Scale -- 4 inches equals 1 mile

Surveyed November 13, 19 54

This is to certify that the above plat was prepared from field notes of actual surveys made by me or under my supervision and that the same are true and correct to the best of my knowledge and belief.



Ernest V. Echohawk
Registered Professional
Engineer and Land Surveyor.
Ernest V. Echohawk
N. Mex. Reg. No. 1545