

UNITED STATES
DEPARTMENT OF THE INTERIOR
GEOLOGICAL SURVEY

APPLICATION FOR PERMIT TO DRILL, DEEPEN, OR PLUG BACK

1a. TYPE OF WORK

DRILL ☒DEEPEN ☐PLUG BACK ☐

b. TYPE OF WELL

OIL
WELL ☐GAS
WELL ☒

OTHER

SINGLE
ZONE ☐MULTIPLE
ZONE ☐

2. NAME OF OPERATOR

Jerome P. McHugh

3. ADDRESS OF OPERATOR

Box 234, Farmington, NM 87401

4. LOCATION OF WELL (Report location clearly and in accordance with any State requirements.)*

At surface

1860' FNL - 990' FWL

At proposed prod. zone

14. DISTANCE IN MILES AND DIRECTION FROM NEAREST TOWN OR POST OFFICE*

20 miles southwest Dulce, NM

15. DISTANCE FROM PROPOSED*

LOCATION TO NEAREST
PROPERTY OR LEASE LINE, FT.
(Also to nearest drlg. unit line, if any)

990'

16. NO. OF ACRES IN LEASE

17. NO. OF ACRES ASSIGNED
TO THIS WELL18. DISTANCE FROM PROPOSED LOCATION*
TO NEAREST WELL, DRILLING, COMPLETED,
OR APPLIED FOR, ON THIS LEASE, FT.Approx
2000'

19. PROPOSED DEPTH

4000'

20. ROTARY OR CABLE TOOLS

Rotary

21. ELEVATIONS (Show whether DF, RT, GR, etc.)

7005' GR

22. APPROX. DATE WORK WILL START*

10-15-76

23.

PROPOSED CASING AND CEMENTING PROGRAM

SIZE OF HOLE	SIZE OF CASING	WEIGHT PER FOOT	SETTING DEPTH	QUANTITY OF CEMENT
12-1/2"	8-5/8"	24#	150'	125 SX
7-7/8"	4-1/2"	10.5#	4000'	300 SX

We propose to drill well with mud to test Pictured Cliffs formation. Set 4-1/2" casing thru Pictured Cliffs formation, selectively perforate, sand-water frac, clean out after frac, run 1-1/4" tubing and complete well.

NMERB Requirement: Gas not dedicated at this time.

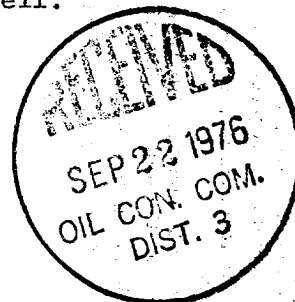

IN ABOVE SPACE DESCRIBE PROPOSED PROGRAM: If proposal is to deepen or plug back, give data on present productive zone and proposed new productive zone. If proposal is to drill or deepen directionally, give pertinent data on subsurface locations and measured and true vertical depths. Give blowout preventer program, if any.

24.

SIGNED

Thomas A. Dugan

TITLE

Engineer

DATE

9-9-76

(This space for Federal or State office use)

PERMIT NO.

APPROVAL DATE

APPROVED BY

TITLE

DATE

CONDITIONS OF APPROVAL, IF ANY:

*See Instructions On Reverse Side

**NEW MEXICO OIL CONSERVATION COMMISSION
WELL LOCATION AND ACREAGE DEDICATION PLAT**

Form C-102
Supersedes C-128
Effective 1-1-65

All distances must be from the outer boundaries of the Section.

Operator Jerome P. McHugh			Lease Burke		Well No. 1
Unit Letter F	Section 31	Township 29 North	Range 3 West	County Rio Arriba	
Actual Footage Location of Well: 1860 feet from the North line and 990 feet from the West line					
Ground Level Elev. 7005	Producing Formation Pictured Cliffs		Pool Choza Mesa		Dedicated Acreage: 186.80 Acres

1. Outline the acreage dedicated to the subject well by colored pencil or hatchure marks on the plat below.
2. If more than one lease is dedicated to the well, outline each and identify the ownership thereof (both as to working interest and royalty).
3. If more than one lease of different ownership is dedicated to the well, have the interests of all owners been consolidated by communitization, unitization, force-pooling, etc?

☐ Yes ☐ No If answer is "yes," type of consolidation _____

If answer is "no," list the owners and tract descriptions which have actually been consolidated. (Use reverse side of this form if necessary.) _____

No allowable will be assigned to the well until all interests have been consolidated (by communitization, unitization, forced-pooling, or otherwise) or until a non-standard unit, eliminating such interests, has been approved by the Commission.

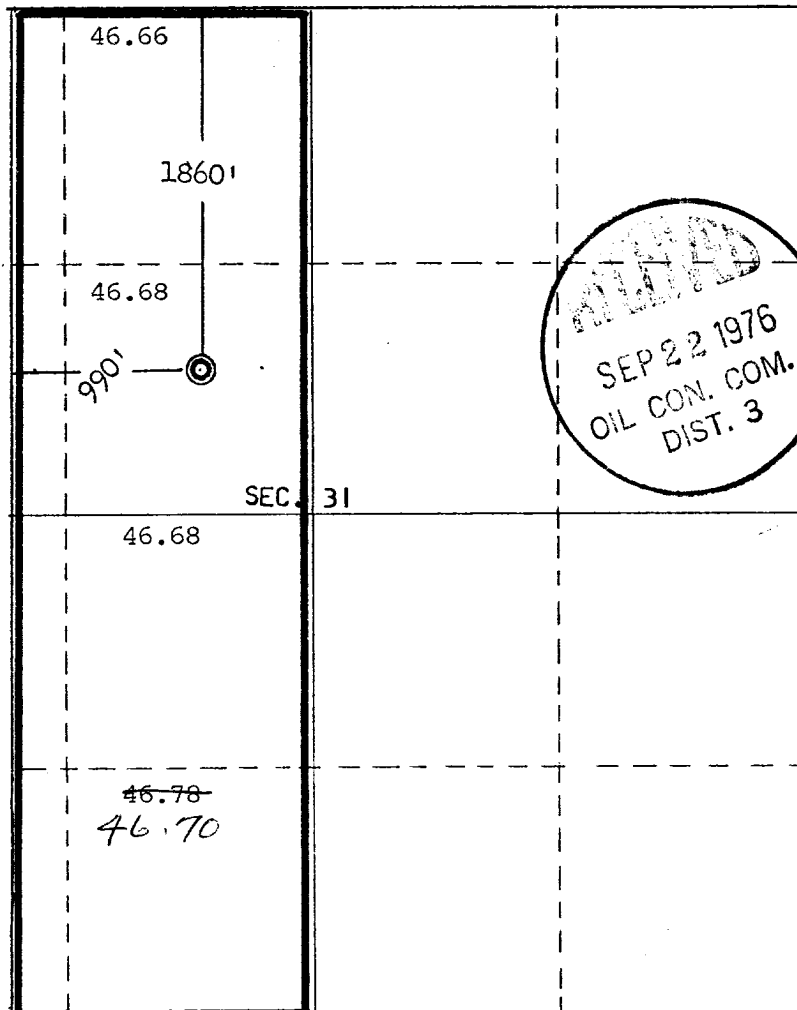

CERTIFICATION

I hereby certify that the information contained herein is true and complete to the best of my knowledge and belief.

Thomas A. Dugan
Name
Thomas A. Dugan
Position
Engineer
Company
Jerome P. McHugh
Date
9-9-76

REGISTERED LAND SURVEYOR
I hereby certify that the well location on this plat was plotted from field notes of surveys made by me or under my supervision, and that the same is true and correct to the best of my knowledge and belief.
NEW MEXICO
3602
REG. NO.
E. V. ECHOHAWK

Date Surveyed
August 31, 1976
Registered Professional Engineer and/or Land Surveyor
E. V. Echohawk
Certificate No. **3602**
E.V. Echohawk LS

Form 9-331
(May 1963)UNITED STATES
DEPARTMENT OF THE INTERIOR
GEOLOGICAL SURVEYSUBMIT IN TRIPPLICATE*
(Other instructions on reverse side)Form approved.
Budget Bureau No. 42-R1424.

5. LEASE DESIGNATION AND SERIAL NO.

Contract 82

6. IF INDIAN, ALLOTTEE OR TRIBE NAME

Jicarilla Apache

7. UNIT AGREEMENT NAME

8. FARM OR LEASE NAME

Burke

9. WELL NO.

1

10. FIELD AND POOL, OR WILDCAT

Choza Mesa - PC

11. SEC., T., R., M., OR BLK. AND
SURVEY OR AREA

Sec 31, T29N, R3W

12. COUNTY OR PARISH

Rio Arriba

13. STATE

NM

1. OIL ☐ GAS ☒ OTHER ☐
WELL WELL

2. NAME OF OPERATOR

Jerome P. McHugh

3. ADDRESS OF OPERATOR

Box 234, Farmington, NM 87401

4. LOCATION OF WELL (Report location clearly and in accordance with any State requirements.*
See also space 17 below.)
At surface

1860' FNL - 990' FWL

14. PERMIT NO.

15. ELEVATIONS (Show whether DF, RT, GR, etc.)

7005' GR

16. Check Appropriate Box To Indicate Nature of Notice, Report, or Other Data

NOTICE OF INTENTION TO:

TEST WATER SHUT-OFF

FRACTURE TREAT

SHOOT OR ACIDIZE

REPAIR WELL

(Other)

PULL OR ALTER CASING

MULTIPLE COMPLETE

ABANDON*

CHANGE PLANS

SUBSEQUENT REPORT OF

WATER SHUT-OFF

FRACTURE TREATMENT

SHOOTING OR ACIDIZING

(Other)

REPAIRING WELL

ALTERING CASING

ABANDONMENT*

(NOTE: Report results of multiple completion on Well
Completion or Recompletion Report and Log form.)

17. DESCRIBE PROPOSED OR COMPLETED OPERATIONS (Clearly state all pertinent details, and give pertinent dates, including estimated date of starting any proposed work. If well is directionally drilled, give subsurface locations and measured and true vertical depths for all markers and zones pertinent to this work.)*

11-17-76

Moved in Ludwick rig. Spudded 12-1/4" hole @ 11:00 AM 11-17-76. Drilled to 160' and shut down for night.

11-18-76

Finished drilling 12-1/4" hole to 190' GR. Ran 6 jts 8-5/8" OD 24# 8R ST&C csg. TE 188.35' set @ 199' RKB. Cemented by Woodco with 125 sx "neat" plus 2% CaCl. Good cement to surface. POB 2:00 PM 11-18-76. WOC and moving in and rigging up Young Drilling Company.

11-26-76

TD 4050'. Go International ran IES and Density log. Laid down drill pipe. Ran 129 jts 4-1/2" OD 10.5# K-55 8R ST&C csg set @ 4038' RKB. BJ-Hughes cemented with 400 sx 65-35+12 and 1/4# gel flake/sk plus 200 sx "neat" 1/4# gel flake/sk (total slurry 1200 cu ft). Max cementing press 1100 psi. POB 11:45 PM 11-25-76. Set slips. Released rig 1:00 AM 11-26-76.

18. I hereby certify that the foregoing is true and correct

SIGNED Thomas A. DuganTITLE EngineerDATE 12-16-76

(This space for Federal or State office use)

APPROVED BY _____
CONDITIONS OF APPROVAL, IF ANY:

TITLE _____

DATE _____

*See Instructions on Reverse Side