

UNITED STATES  
DEPARTMENT OF THE INTERIOR  
GEOLOGICAL SURVEY

## APPLICATION FOR PERMIT TO DRILL, DEEPEN OR PLUG BACK

## 1a. TYPE OF WORK

DRILL ☒DEEPEN ☐PLUG BACK ☐

## b. TYPE OF WELL

OIL  
WELL ☐GAS  
WELL ☒OTHER ☐

## 2. NAME OF OPERATOR

Southland Royalty Company

## 3. ADDRESS OF OPERATOR

P.O. Drawer 570, Farmington, New Mexico 87499

## 4. LOCATION OF WELL (Report location clearly and in accordance with any State requirements.)

At surface

1650' FSL &amp; 1750' FWL

At proposed prod. zone

## 14. DISTANCE IN MILES AND DIRECTION FROM NEAREST TOWN OR POST OFFICE\*

50 miles East of Blanco, New Mexico

## 15. DISTANCE FROM PROPOSED\*

LOCATION TO NEAREST

PROPERTY OR LEASE LINE, FT.

(Also to nearest drlg. unit line, if any)

1800'

18. DISTANCE FROM PROPOSED LOCATION\*  
TO NEAREST WELL, DRILLING, COMPLETED,  
OR APPLIED FOR, ON THIS LEASE, FT.

---

## 21. ELEVATIONS (Show whether DF, RT, GR, etc.)

7151' GL

DRILLING OPERATIONS AUTHORIZED ARE  
SUBJECT TO COMPLIANCE WITH ATTACHED

## 23.

PROPOSED PROGRAM AND CEMENTING PROGRAM

SIZE OF HOLE	SIZE OF CASING	WEIGHT PER FOOT	SETTING DEPTH	QUANTITY OF CEMENT:
12-1/4"	9-5/8"	32.30#, K-55	500'	313 cu.ft. (Circ to surface)
7-7/8"	5-1/2"	15.50#, K-55	7000'	Stge 1: 367 cu.ft. (Cover Gallup)
7-7/8"	5-1/2"	17#, K-55	8626'	Stge 2: 156 cu.ft. (Cover Cliff House)
				Stge 3: 207 cu.ft. (Cover Ojo Alamo)

Surface formation is San Jose.

Top of Ojo Alamo sand is at 3303'.

Top of Pictured Cliffs sand is at 3708'.

Fresh water mud will be used to drill from surface to total depth.

It is anticipated that an DIL, CNL, FDC, and BHC Sonic logs will be run from  
total depth to surface casing.

No abnormal pressures or poisonous gases are anticipated in this well.

It is expected that this well will be drilled before December 31, 1983.

This depends on time required for approvals, rig availability and the weather.

Gas is not dedicated.

IN ABOVE SPACE DESCRIBE PROPOSED PROGRAM: If proposal is to deepen or plug back, give data on present productive zone and proposed new productive zone. If proposal is to drill or deepen directionally, give pertinent data on subsurface locations and measured and true vertical depths. Give blowout preventer program, if any.

## 24.

SIGNED

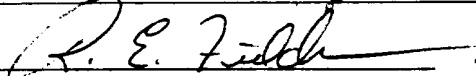

TITLE District Engineer

(This space for Federal or State office use)

PERMIT NO.

APPROVAL DATE

APPROVED BY

TITLE

CONDITIONS OF APPROVAL, IF ANY:

ch S

NMOC

## 5. LEASE DESIGNATION AND SERIAL NO.

Jicarilla Contract 451

## 6. IF INDIAN ALLOTTEE OR TRIBE NAME

## 7. UNIT AGREEMENT NAME

## 8. FARM OR LEASE NAME

Jicarilla 451

## 9. WELL NO.

## 12. FIELD AND FOOT, OR WHOLECAT

Basin Dakota  
Wildcat Pictured Cliffs

## 13. SEC. T., R., M., OR BLK.

## 14. SURVEY OR AREA

Section 4, T29N R3W

## 15. COUNTY OR PARISH

## 16. STATE

Rio Arriba New Mexico

## 17. NO. OF ACRES ASSIGNED TO THIS WELL

12.87 320/160

## 20. ROTARY OR CABLE TOOLS

Rotary

## 22. APPROX. DATE WORK WILL START\*

December 1, 1983

## 23. APPROX. DATE WORK WILL START\*

December 1, 1983

## 24. APPROX. DATE WORK WILL START\*

December 1, 1983

## 25. APPROX. DATE WORK WILL START\*

December 1, 1983

## 26. APPROX. DATE WORK WILL START\*

December 1, 1983

## 27. APPROX. DATE WORK WILL START\*

December 1, 1983

## 28. APPROX. DATE WORK WILL START\*

December 1, 1983

## 29. APPROX. DATE WORK WILL START\*

December 1, 1983

## 30. APPROX. DATE WORK WILL START\*

December 1, 1983

## 31. APPROX. DATE WORK WILL START\*

December 1, 1983

## 32. APPROX. DATE WORK WILL START\*

December 1, 1983

## 33. APPROX. DATE WORK WILL START\*

December 1, 1983

## 34. APPROX. DATE WORK WILL START\*

December 1, 1983

## 35. APPROX. DATE WORK WILL START\*

December 1, 1983

## 36. APPROX. DATE WORK WILL START\*

December 1, 1983

## 37. APPROX. DATE WORK WILL START\*

December 1, 1983

## 38. APPROX. DATE WORK WILL START\*

December 1, 1983

## 39. APPROX. DATE WORK WILL START\*

December 1, 1983

## 40. APPROX. DATE WORK WILL START\*

December 1, 1983

## 41. APPROX. DATE WORK WILL START\*

December 1, 1983

## 42. APPROX. DATE WORK WILL START\*

December 1, 1983

## 43. APPROX. DATE WORK WILL START\*

December 1, 1983

## 44. APPROX. DATE WORK WILL START\*

December 1, 1983

## 45. APPROX. DATE WORK WILL START\*

December 1, 1983

## 46. APPROX. DATE WORK WILL START\*

December 1, 1983

## 47. APPROX. DATE WORK WILL START\*

December 1, 1983

## 48. APPROX. DATE WORK WILL START\*

December 1, 1983

## 49. APPROX. DATE WORK WILL START\*

December 1, 1983

## 50. APPROX. DATE WORK WILL START\*

December 1, 1983

## 51. APPROX. DATE WORK WILL START\*

December 1, 1983

## 52. APPROX. DATE WORK WILL START\*

December 1, 1983

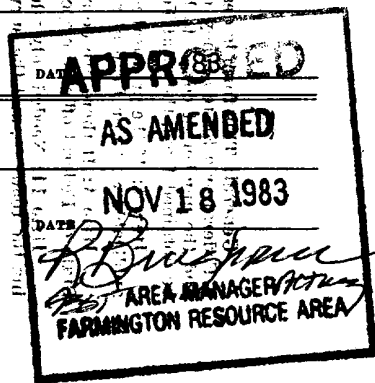

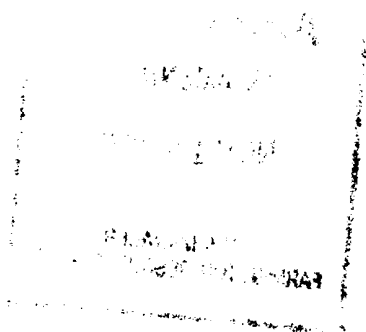

OIL CONSERVATION DIVISION

P. O. BOX 2088  
SANTA FE, NEW MEXICO 87501

Form C-107  
Revised 10-1-78

All distances must be from the outer boundaries of the Section.

Operator <b>SOUTHLAND ROYALTY COMPANY</b>			Lease <b>JICARILLA 451</b>		Well No. <b>1</b>
Unit Letter <b>K</b>	Section <b>4</b>	Township <b>29N</b>	Range <b>3W</b>	County <b>Rio Arriba</b>	
Actual Footage Location of Well: <b>1650</b> feet from the <b>South</b> line and <b>1750</b> feet from the <b>West</b> line					
Ground Level Elev. <b>7151' GL</b>	Producing Formation <b>Dakota/Pictured Cliffs</b>		Pool <b>Basin/Wildcat</b>	Dedicated Acreage <b>372.82 220/160</b> Acres	

1. Outline the acreage dedicated to the subject well by colored pencil or hachure marks on the plat below.
2. If more than one lease is dedicated to the well, outline each and identify the ownership thereof (both as to working interest and royalty).
3. If more than one lease of different ownership is dedicated to the well, have the interests of all owners been consolidated by communitization, unitization, force-pooling, etc?

☐ Yes ☐ No If answer is "yes," type of consolidation \_\_\_\_\_

If answer is "no," list the owners and tract descriptions which have actually been consolidated. (Use reverse side of this form if necessary.) \_\_\_\_\_

No allowable will be assigned to the well until all interests have been consolidated (by communitization, unitization, forced-pooling, or otherwise) or until a non-standard unit, eliminating such interests, has been approved by the Commission.

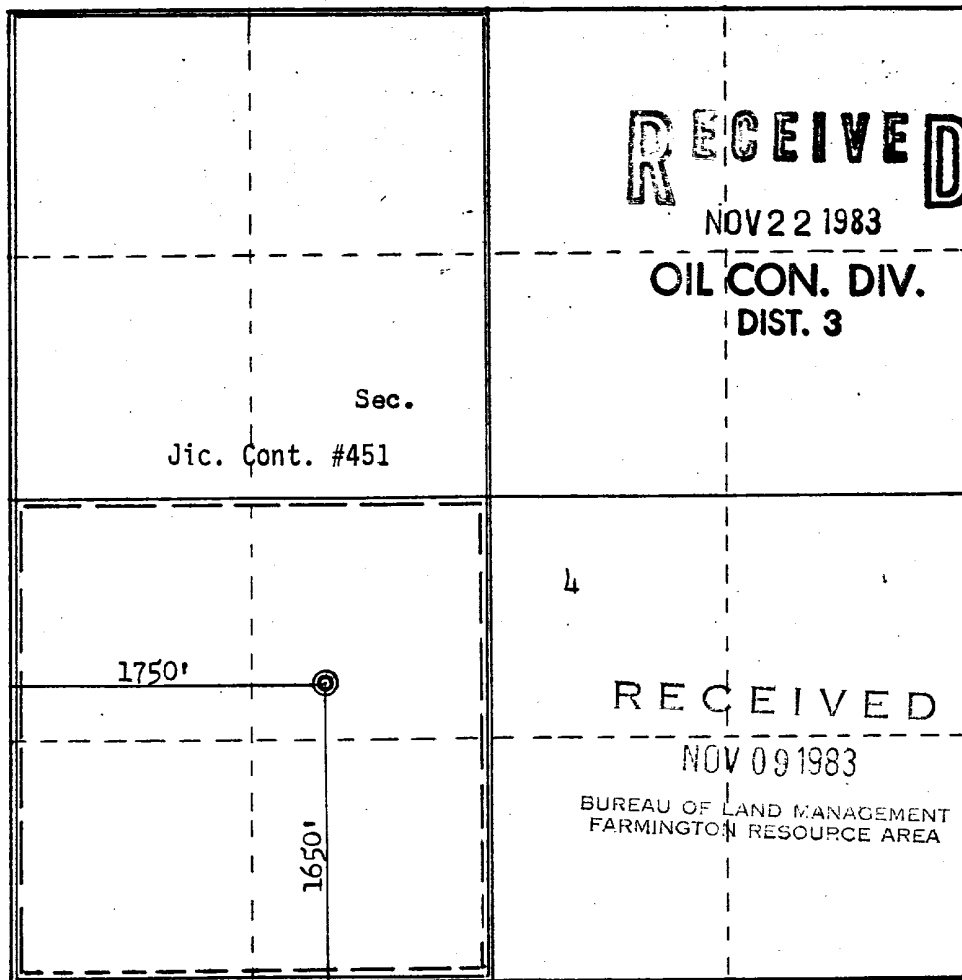

Scale: 1"=1000'

CERTIFICATION

I hereby certify that the information contained herein is true and complete to the best of my knowledge and belief.

*R. E. Fielder*

Name  
**R. E. Fielder**  
Position  
**District Engineer**  
Company  
**Southland Royalty Company**  
Date  
**November 7, 1983**

I hereby certify that the well location shown on this plat was plotted from field notes of actual surveys made by me or under my supervision, and that the same is true and correct to the best of my knowledge and belief.

Date Surveyed  
**September 23, 1983**

Registered Professional Engineer and Land Surveyor

*Fred E. Kent Jr.*  
**Fred E. Kent Jr.**

Certificate No. **3950**

