

Company SMITH DRILLING CORPORATION

Lease JICARILLA APACHE Well No. 5-1 JICARILLA

Sec. 19, T. 29 N., R. 2 W., N.M.P.M.

Location 990' FROM THE SOUTH LINE AND 1650' FROM THE WEST LINE.

Elevation 7106.0 UNGRADED GROUND.

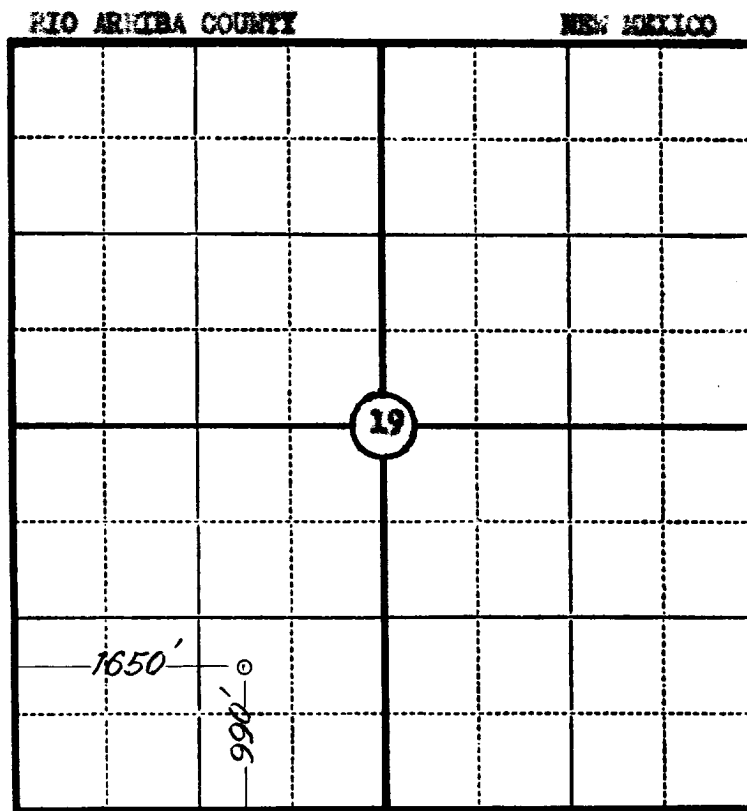

Scale—4 inches equal 1 mile.

This is to certify that the above plat was prepared from field notes of actual surveys made by me or under my supervision and that the same are true and correct to the best of my knowledge and belief.

Seal:

*James P. Leese*  
Registered Land Surveyor.

**James P. Leese**  
**N. Mex. Reg. No. 1463**

Surveyed 21 November, 1955

SAN JUAN ENGINEERING COMPANY, FARMINGTON, N. M.

