

(SUBMIT IN TRIPLICATE)

UNITED STATES
DEPARTMENT OF THE INTERIOR
GEOLOGICAL SURVEY

Land Office Santa Fe
Lease No. SF-078904-1
Unit Gallegos Canyon Unit

SUNDRY NOTICES AND REPORTS ON WELLS

NOTICE OF INTENTION TO DRILL	<input checked="" type="checkbox"/>	SUBSEQUENT REPORT OF WATER SHUT-OFF
NOTICE OF INTENTION TO CHANGE PLANS	<input type="checkbox"/>	SUBSEQUENT REPORT OF SHOOTING OR ACIDIZING
NOTICE OF INTENTION TO TEST WATER SHUT-OFF	<input type="checkbox"/>	SUBSEQUENT REPORT OF ALTERING CASING
NOTICE OF INTENTION TO RE-DRILL OR REPAIR WELL	<input type="checkbox"/>	SUBSEQUENT REPORT OF RE-DRILLING OR REPAIR
NOTICE OF INTENTION TO SHOOT OR ACIDIZE	<input type="checkbox"/>	SUBSEQUENT REPORT OF ABANDONMENT
NOTICE OF INTENTION TO PULL OR ALTER CASING	<input type="checkbox"/>	SUPPLEMENTARY WELL HISTORY
NOTICE OF INTENTION TO ABANDON WELL	<input type="checkbox"/>	

(INDICATE ABOVE BY CHECK MARK NATURE OF REPORT, NOTICE, OR OTHER DATA)

RECEIVED
JAN 29 1962
U. S. GEOLOGICAL SURVEY
FARMINGTON, NEW MEXICO

Gallegos Canyon Unit Farmington, New Mexico Jan. 25, 1962

Well No. 123 is located 790 ft. from N line and 1850 ft. from W line of sec. 25

NE 1/4, NW 1/4 Section 25 T-28-N R-12-W N.M.P.M.
(1/4 Sec. and Sec. No.) (Twp.) (Range) (Meridian)
Basin Dakota San Juan New Mexico
(Field) (County or Subdivision) (State or Territory)

The elevation of the derrick floor above sea level is _____ ft. (To be reported later)

DETAILS OF WORK

(State names of and expected depths to objective sands; show sizes, weights, and lengths of proposed casings; indicate mudlogging jobs, cementing points, and all other important proposed work)

We propose to drill the above well to approximately 6400' with rotary tools to evaluate the Dakota zone. Stimulation and completion will be as indicated upon reaching total depth. The following casing program is proposed:

SIZE	DEPTH	CEMENT	REMARKS
8-5/8"	350'	250	Inner Neat - circulated.
4-1/2"	6400'	First stage	250 sacks 4 percent Gel with 1-1/2# Tuf Plug per sack, 100 sacks Inner neat on bottom.
		Second stage	350 sacks Inner cement 4 percent Gel (To cover Pictured Cliffs)

Two stage tool to be set at about 100' below Pictured Cliffs. A copy of any survey taken will be submitted upon completion of well. Copies of location plat are attached.

I understand that this plan of work must receive approval in writing by the Geological Survey before operations may be commenced.

Company Pan American Petroleum Corporation
Address P. O. Box 480
Farmington, New Mexico
Attn: L. O. Speer, Jr.
By R. M. Bauer, Jr.
Title Senior Petroleum Engineer

Verbal approval received 1-25-62 Dick Krahle to J. C. Glover

NEW MEXICO OIL CONSERVATION COMMISSION

Well Location and Acreage Dedication Plat

Section A.

Date January 8, 1962

Operator PAN AMERICAN PETROLEUM CORPORATION Lease GALLEGOS CANYON UNIT
 Well No. 123 Unit Letter C Section 25 Township 28 NORTH Range 12 WEST, NMPM
 Located 790 Feet From the NORTH Line, 1850 Feet From the WEST Line
 County SAN JUAN G. L. Elevation Report later Dedicated Acreage 320 Acres
 Name of Producing Formation Dakota Pool Basin Dakota

1. Is the Operator the only owner in the dedicated acreage outlined on the plat below?
 Yes _____ No X
2. If the answer to question one is "no", have the interests of all the owners been consolidated by communitization agreement or otherwise? Yes X No ____ If answer is "yes", Type of Consolidation.

Gallegos Canyon Unit acreage

3. If the answer to question two is "no", list all the owners and their respective interests below:

OwnerLand Description

Section B.

This is to certify that the information in Section A above is true and complete to the best of my knowledge and belief.

Pan American Petroleum Corp.

(Operator)

R. M. Bauer, Jr.

(Representative)

Box 480, Farmington, New Mexico

(Address)

Note: All distances must be from outer boundaries of section.

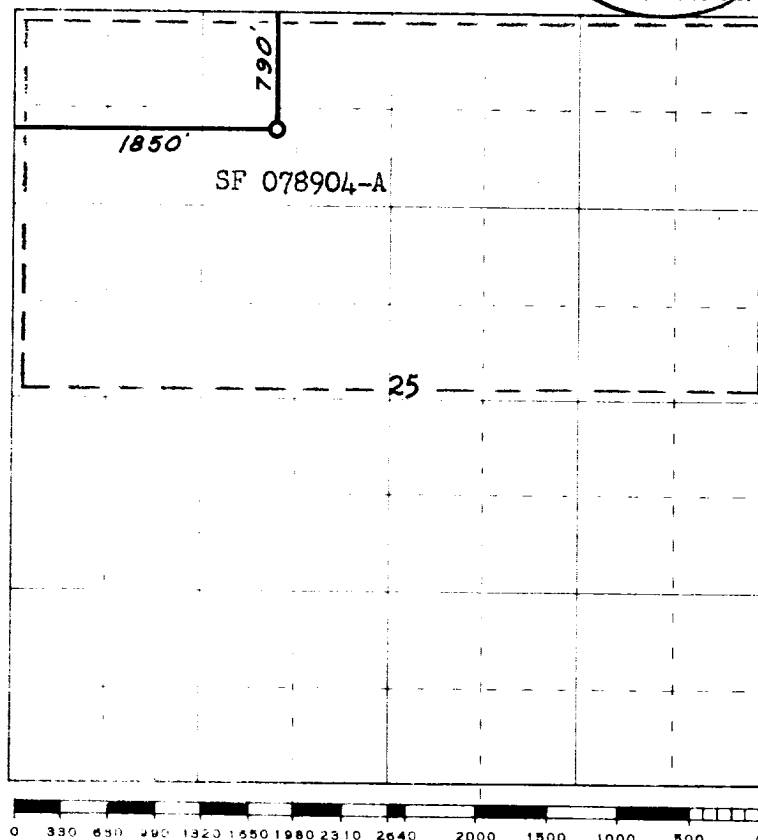

Scale 4 inches equal 1 mile

Ref: GLO plat dated 19 July 1915

This is to certify that the above plat was prepared from field notes of actual surveys made by me or under my supervision and that the same are true and correct to the best of my knowledge and belief.

Date Surveyed 5 January 1962

James P. Leese
 Registered Professional Engineer and/or Land Surveyor
 James P. Leese N. Mex. Reg. No. 1463

