

(SUBMIT IN TRIPLICATE)

UNITED STATES
DEPARTMENT OF THE INTERIOR
GEOLOGICAL SURVEY

Land Office Santa Fe
Lease No. 676106
Unit _____

SUNDRY NOTICES AND REPORTS ON WELLS

NOTICE OF INTENTION TO DRILL	<input checked="" type="checkbox"/>	SUBSEQUENT REPORT OF WATER SHUT-OFF	
NOTICE OF INTENTION TO CHANGE PLANS		SUBSEQUENT REPORT OF SHOOTING OR ACIDIZING	
NOTICE OF INTENTION TO TEST WATER SHUT-OFF		SUBSEQUENT REPORT OF ALTERING CASING	
NOTICE OF INTENTION TO RE-DRILL OR REPAIR WELL		SUBSEQUENT REPORT OF RE-DRILLING OR REPAIR	
NOTICE OF INTENTION TO SHOOT OR ACIDIZE		SUBSEQUENT REPORT OF ABANDONMENT	
NOTICE OF INTENTION TO PULL OR ALTER CASING		SUPPLEMENTARY WELL HISTORY	
NOTICE OF INTENTION TO ABANDON WELL			

(INDICATE ABOVE BY CHECK MARK NATURE OF REPORT, NOTICE, OR OTHER DATA)

Gallegos Canyon Unit

December 3, 1962

Well No. 130 is located 810 ft. from N line and 1450 ft. from E line of sec. _____
1/4 of 1/4 Sec. 18 28N 12W 107N
 (1/4 Sec. and Sec. No.) (Twp.) (Range) (Meridian)
Totah Gallup San Juan New Mexico
 (Field) (County or Subdivision) (State or Territory)

The elevation of the derrick floor above sea level is 5679 ft.

DETAILS OF WORK

(State names of and expected depths to objective sands; show sizes, weights, and lengths of proposed casings; indicate mudding jobs, cementing points, and all other important proposed work)

We propose to drill this 5600' Gallup test as follows:

Drill 12-1/4" hole to 200', set 8-5/8" 21# J-55 casing to 200' w/sufficient cement to circulate to surface. @ 24 hours, test csg. to 1000 psi for 30 min., drill 7-7/8" hole to 500', core 100' in Gallup interval, set 4-1/2" 11.6# J-55 csg. to 500' and cement w/200 sacks cement. Stage cement from 1750' w/150 sacks cement. @ 24 hrs., test csg. to 2000 psi for 30 min. The csg. will be perforated & the well sand fractured for completion.

I understand that this plan of work must receive approval in writing by the Geological Survey before operations may be commenced.

Company Sanrey Oil Company

Address 200 Petroleum Club Plaza

Paradise, New Mexico

By _____

Title Production Engineer

NEW MEXICO OIL CONSERVATION COMMISSION

Well Location and Acreage Dedication Plat

Section A.

Date 12-3-62

Operator SUNRAY MID-CONTINENT OIL COMPANY Lease Gallegos Canyon Unit
 Well No. 13 Unit Letter B Section 18 Township 28 NORTH Range 12 WEST NMPM
 Located 810 Feet From the NORTH Line, 1850 Feet From the EAST Line
 County SAN JUAN G. L. Elevation 5619.0' Dedicated Acreage 80 Acres
 Name of Producing Formation Gallup Pool Totah Gallup

1. Is the Operator the only owner in the dedicated acreage outlined on the plat below?
 Yes X No _____
2. If the answer to question one is "no", have the interests of all the owners been consolidated by communitization agreement or otherwise? Yes _____ No _____. If answer is "yes", Type of Consolidation.
3. If the answer to question two is "no", list all the owners and their respective interests below:

OwnerLand Description

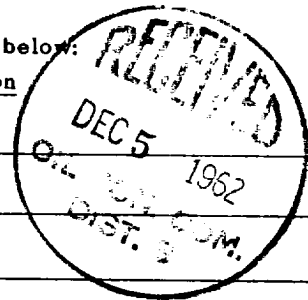

Section B.

Note: All distances must be from outer boundaries of section.

This is to certify that the information in Section A above is true and complete to the best of my knowledge and belief.

Sunray DX Oil Company
 (Operator)

(Representative)
Charles W. Rogers
 (Address)

200 Petroleum Club PlazaFarmington, New Mexico

Ref: GLO plat dated 19 July 1915

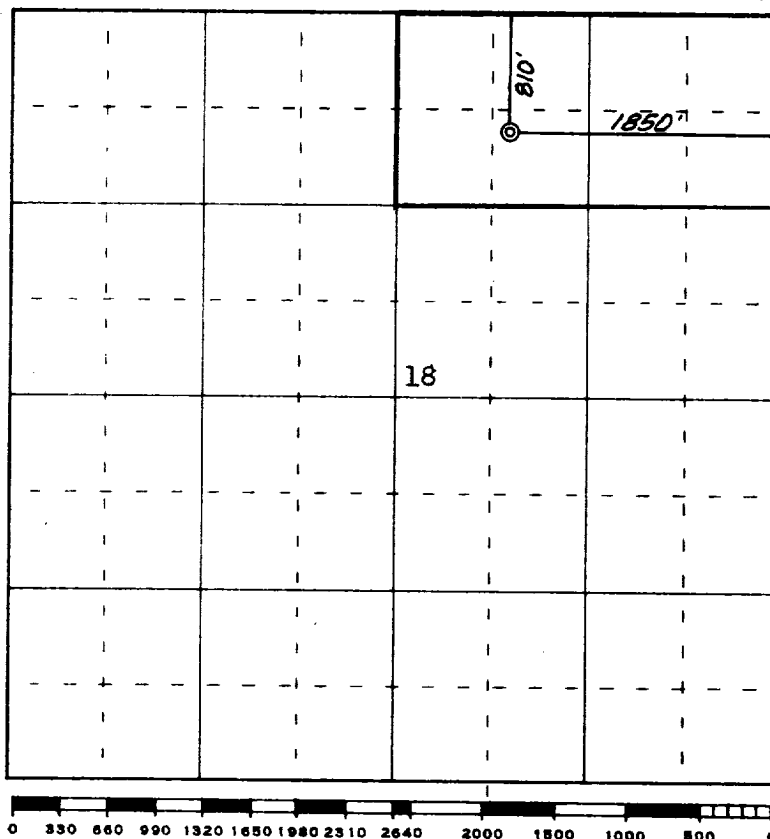

Scale 4 inches equal 1 mile

This is to certify that the above plat was prepared from field notes of actual surveys made by me or under my supervision and that the same are true and correct to the best of my knowledge and belief.

Date Surveyed 1 December 1962

James P. Lease
 Registered Professional Engineer and/or Land Surveyor
 James P. Lease, N. Mex. Reg. No. 1463
 San Juan Engineering Company

Farmington, New Mexico