

		X	

(SUBMIT IN TRIPLICATE)

UNITED STATES
DEPARTMENT OF THE INTERIOR
GEOLOGICAL SURVEY

Land Office Santa Fe
Lease No. 077976
Unit Jones

SUNDRY NOTICES AND REPORTS ON WELLS

NOTICE OF INTENTION TO DRILL.....	<input checked="" type="checkbox"/>	SUBSEQUENT REPORT OF WATER SHUT-OFF.....	
NOTICE OF INTENTION TO CHANGE PLANS.....		SUBSEQUENT REPORT OF SHOOTING OR ACIDIZING.....	
NOTICE OF INTENTION TO TEST WATER SHUT-OFF.....		SUBSEQUENT REPORT OF ALTERING CASING.....	
NOTICE OF INTENTION TO RE-DRILL OR REPAIR WELL.....		SUBSEQUENT REPORT OF RE-DRILLING OR REPAIR.....	
NOTICE OF INTENTION TO SHOOT OR ACIDIZE.....		SUBSEQUENT REPORT OF ABANDONMENT.....	
NOTICE OF INTENTION TO PULL OR ALTER CASING.....		SUPPLEMENTARY WELL HISTORY.....	
NOTICE OF INTENTION TO ABANDON WELL.....			

(INDICATE ABOVE BY CHECK MARK NATURE OF REPORT, NOTICE, OR OTHER DATA)

August 18th, 19 60

Well No. 6 is located 660 ft. from N line and 1980 ft. from E line of sec. 17
NW/4 NE/4 Sec. 17 28N 134 N.M.P.M.
(¼ Sec. and Sec. No.) (Twp.) (Range) (Meridian)
Undesignated Gallup San Juan New Mexico
(Field) (County or Subdivision) (State or Territory)

The elevation of the derrick floor above sea level is 6071 ft.

DETAILS OF WORK

(State names of and expected depths to objective sands; show sizes, weights, and lengths of proposed casings; indicate mudding jobs, cementing points, and all other important proposed work)

Gallup Sand test. Estimated total depth 5800'.

Surface Casing: 300' of 8-5/8" OD 24# J-55 cemented to surface.
 Production " : Approximately 5800' of 4-1/2" OD 9.5# J-55 cemented with 175 sacks.

If commercial production is indicated, the producing section will be sand-oil fractured.

I understand that this plan of work must receive approval in writing by the Geological Survey before operations may be commenced.

Company BENSON-MONTIN-GREER DRILLING CORP.
 Address 158 Petroleum Center Building
Farmington, New Mexico
 By _____
 Title Vice-President

NEW MEXICO OIL CONSERVATION COMMISSION
WELL LOCATION AND ACREAGE DEDICATION PLAT

FORM C-128
 Revised 5/1/57

SEE INSTRUCTIONS FOR COMPLETING THIS FORM ON THE REVERSE SIDE

SECTION A

Operator BENSON-MONTIN-GREER DRILLING CORPORATION		Lease JONES		Well No. 6
Tract Letter B	Section 17	Township 28 NORTH	Range 13 WEST	County SAN JUAN
Actual Footage Location of Well: 660 feet from the NORTH line and 1980 feet from the EAST line				
Ground Level Elev. 6059.0	Producing Formation Gallup	Pool Undesignated		Dedicated Acreage: 40 Acres

- Ref. GLO plat dated 19 July 1915
- Is the Operator the only owner in the dedicated acreage outlined on the plat below? YES NO ("Owner" means the person who has the right to drill into and to produce from any pool and to appropriate the production either for himself or for himself and another. (65-3-29 (e) NMSA 1935 Comp.)
 - If the answer to question one is "no," have the interests of all the owners been consolidated by communization, agreement or otherwise? YES NO . If answer is "yes," Type of Consolidation _____
 - If the answer to question one is "no," list all the owners and their respective interests below:

Owner	Land Description



SECTION B

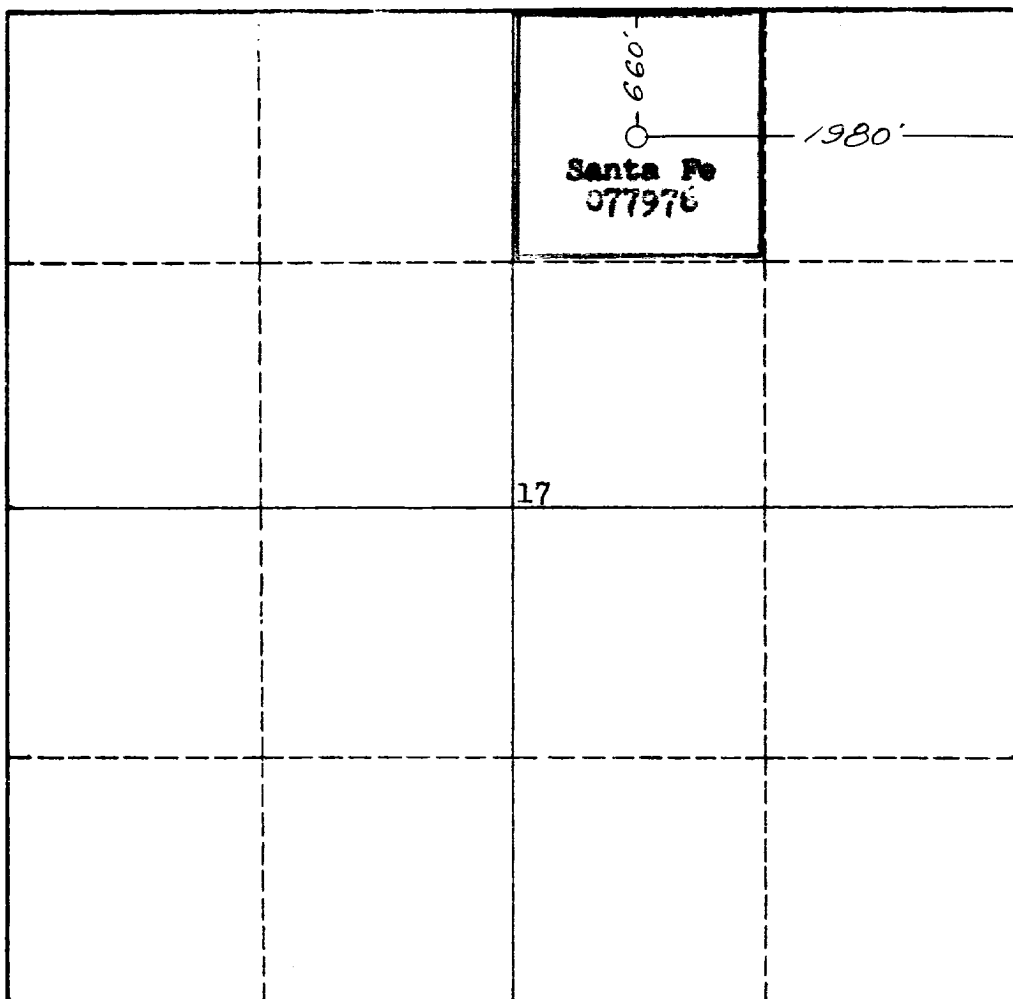

I hereby certify that the information in SECTION A above is true and complete to the best of my knowledge and belief.

Name	
Position	Vice-President
Company	Benson-Montin-Greer Drilling Corp.
Date	August 18, 1960

I hereby certify that the well location shown on the plat in SECTION B was plotted from field notes of actual surveys made by me or under my supervision, and that the same is true and correct to the best of my knowledge and belief.

Date Surveyed	27 July 1960
Registered Professional Engineer and/or Land Surveyor	<i>James P. Leese</i> James P. Leese
Certificate No.	1463

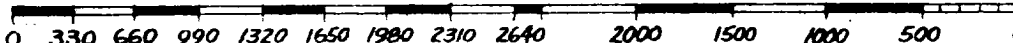

INSTRUCTIONS FOR COMPLETION OF FORM C-128

1. Operator shall furnish and certify to the information called for in Section A.
2. Operator shall outline the dedicated acreage for *both* oil and gas wells on the plat in Section B.
3. A registered professional engineer or land surveyor registered in the State of New Mexico or approved by the Commission shall show on the plat the location of the well and certify this information in the space provided.
4. All distances shown on the plat must be from the outer boundaries of the Section.
5. If additional space is needed for listing owners and their respective interests as required in question 3 of Section A, please use space below.