

(SUBMIT IN TRIPLICATE)

UNITED STATES  
DEPARTMENT OF THE INTERIOR  
GEOLOGICAL SURVEY

Land Office **Santa Fe**  
Lease No. **NM 013365**  
Unit **(SW/4) N**

SUNDRY NOTICES AND REPORTS ON WELLS

NOTICE OF INTENTION TO DRILL <input checked="" type="checkbox"/>	SUBSEQUENT REPORT OF WATER SHUT-OFF
NOTICE OF INTENTION TO CHANGE PLANS	SUBSEQUENT REPORT OF SHOOTING OR ACIDIZING
NOTICE OF INTENTION TO TEST WATER SHUT-OFF	SUBSEQUENT REPORT OF ALTERING CASING
NOTICE OF INTENTION TO RE-DRILL OR REPAIR WELL	SUBSEQUENT REPORT OF RE-DRILLING OR REPAIR
NOTICE OF INTENTION TO SHOOT OR ACIDIZE	SUBSEQUENT REPORT OF ABANDONMENT
NOTICE OF INTENTION TO PULL OR ALTER CASING	SUPPLEMENTARY WELL HISTORY
NOTICE OF INTENTION TO ABANDON WELL	

(INDICATE ABOVE BY CHECK MARK NATURE OF REPORT, NOTICE, OR OTHER DATA)

**November 2,** 19**56**

Well No. **27** is located **1000** ft. from **N** line and **1765** ft. from **E** line of sec. **22**  
**SW/4** **Sec. 22** **28N** **11W** **N.M.P.M.**  
(1/4 Sec. and Sec. No.) (Twp.) (Range) (Meridian)  
**Undesignated** **San Juan** **New Mexico**  
(Field) (County or Subdivision) (State or Territory)

The elevation of the derrick floor above sea level is **5606** ft.

DETAILS OF WORK

(State names of and expected depths to objective sands; show sizes, weights, and lengths of proposed casings; indicate mudding jobs, cementing points, and all other important proposed work)

**R & G #27 Phillips - T. D. 1650 ft.**

**100' of 8-5/8" casing with 50 sacks cement**  
**1650' of 5-1/2", 14# casing with 200 sacks cement**

**Fruitland sand expected at 1350'**  
**Pictured Cliffs sand expected at 1550'**

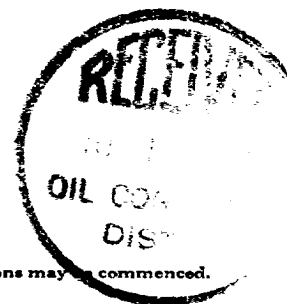

I understand that this plan of work must receive approval in writing by the Geological Survey before operations may be commenced.

Company **R & G DRILLING COMPANY, INC.**

Address **Box 1848**

**Parazington, New Mexico**

By **William C. Russell**  
 Title **President**

NEW MEXICO  
OIL CONSERVATION COMMISSION

Form C-128

Well Location and/or Gas Proration Plat

Date November 2, 1956

Operator R AND G DRILLING COMPANY

Lease Phillips (NM-013365)

Well No. 27 Section 22 Township 28 NORTH Range 11 WEST, NMPM

Located 1000 Feet From the SOUTH Line, 1765 Feet From the WEST Line,

SAN JUAN County, New Mexico. G. L. Elevation 5600.8 UNGRADED.

Name of Producing Formation \_\_\_\_\_ Pool Undesignated Dedicated Acreage 160 A.

(Note: All distances must be from outer boundaries of Section)

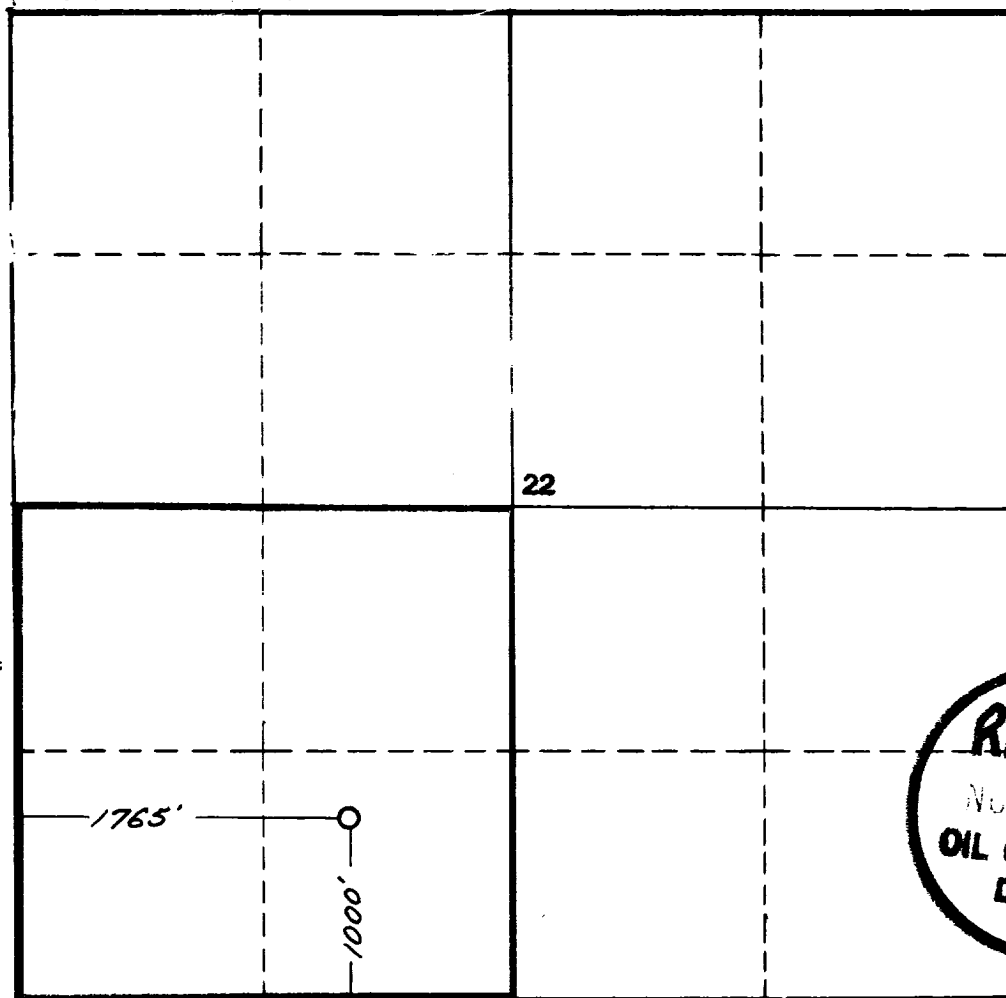

NOTE

This section of form is to be used for gas wells only.



SCALE: 1"=1000'

1. Is this Well a Dual Comp. ? Yes \_\_\_ No \_\_\_.
2. If the answer to Question 1 is yes, are there any other dually completed wells within the dedicated acreage? Yes \_\_\_ No \_\_\_.

Name William C. Russell  
Position President  
Representing R & G DRILLING COMPANY, I.C.  
Address Box 1848, Farmington, New Mexico

This is to certify that the above plat was prepared from field notes of actual surveys made by me or under my supervision and that the same are true and correct to the best of my knowledge and belief.

Date Surveyed 25 OCTOBER 1956

James P. Leese  
Registered Professional Engineer and/or  
Land Surveyor James P. Leese  
N. Mex. Reg. No. 1463