

UNITED STATES
DEPARTMENT OF THE INTERIOR
GEOLOGICAL SURVEY

APPLICATION FOR PERMIT TO DRILL, DEEPEN, OR PLUG BACK

1a. TYPE OF WORK DRILL <input checked="" type="checkbox"/> DEEPEN <input type="checkbox"/> PLUG BACK <input type="checkbox"/>		
b. TYPE OF WELL OIL WELL <input type="checkbox"/> GAS WELL <input type="checkbox"/> OTHER <input checked="" type="checkbox"/> Injection Well SINGLE ZONE <input checked="" type="checkbox"/> MULTIPLE ZONE <input type="checkbox"/>		
2. NAME OF OPERATOR PAN AMERICAN PETROLEUM CORPORATION		
3. ADDRESS OF OPERATOR P. O. Box 480, Farmington, New Mexico		
4. LOCATION OF WELL (Report location clearly and in accordance with any State requirements.*) At surface 740' FSL and 810' FSL At proposed prod. zone Same		
14. DISTANCE IN MILES AND DIRECTION FROM NEAREST TOWN OR POST OFFICE* 8 miles southwest of Bloomfield, New Mexico		
15. DISTANCE FROM PROPOSED* LOCATION TO NEAREST PROPERTY OR LEASE LINE, FT. (Also to nearest drlg. unit line, if any)	16. NO. OF ACRES IN LEASE 43,146.62	17. NO. OF ACRES ASSIGNED TO THIS WELL 80
18. DISTANCE FROM PROPOSED LOCATION* TO NEAREST WELL, DRILLING, COMPLETED, OR APPLIED FOR, ON THIS LEASE, FT. 1750' (Dakota #219)	19. PROPOSED DEPTH 5700'	20. ROTARY OR CABLE TOOLS Rotary
21. ELEVATIONS (Show whether DF, RT, GR, etc.) To be reported later		22. APPROX. DATE WORK WILL START* February 9, 1967

5. LEASE DESIGNATION AND SERIAL NO. 8F-080844-A	
6. IF INDIAN, ALLOTTEE OR TRIBE NAME	
7. UNIT AGREEMENT NAME Gallegos Canyon Unit	
8. FARM OR LEASE NAME	
9. WELL NO. 259	
10. FIELD AND POOL, OR WILDCAT Pinon Gallup	
11. SEC., T., R., M., OR BLK. AND SURVEY OR AREA SE/4 SE/4 Section 14 T-28-N, R-12-W	
12. COUNTY OR PARISH San Juan	13. STATE N. Mex.

23. PROPOSED CASING AND CEMENTING PROGRAM				
SIZE OF HOLE	SIZE OF CASING	WEIGHT PER FOOT	SETTING DEPTH	QUANTITY OF CEMENT
12-1/4"	8-5/8"	24#	250'	150 sz.
7-7/8"	4-1/2"	9.5#	5700'	1500 sz (Stage cementing tool set at base of Mesaverde)

Well to be used for water injection in the Pinon Gallup Secondary Recovery project.

Well was authorized under NMOC Order No. R-3163 covering Pressure Maintenance Project in the Pinon Gallup Pool.

Copies of Location Plat attached.

RECEIVED

JAN 20 1967

U. S. GEOLOGICAL SURVEY
FARMINGTON, N. M.

IN ABOVE SPACE DESCRIBE PROPOSED PROGRAM: If proposal is to drill or plug back, give data on present productive zone and proposed new productive zone. If proposal is to drill or deepen directionally, give pertinent data on subsurface locations and measured and true vertical depths. Give blowout preventer program, if any.

24. Original Signed By: W. EATON, JR.
SIGNED: C. M. Eaton, Jr. TITLE: Area Engineer DATE: January 18, 1967

(This space for Federal or State office use)

PERMIT NO. 77A APPROVAL DATE _____APPROVED BY _____ TITLE _____ DATE _____
CONDITIONS OF APPROVAL, IF ANY:

*See Instructions On Reverse Side

Instructions

General: This form is designed for submitting proposals to perform certain well operations, as indicated, on all types of lands and leases for appropriate action by either a Federal or a State agency, or both, pursuant to applicable Federal and/or State laws and regulations. Any necessary special instructions concerning the use of this form and the number of copies to be submitted, particularly with regard to local, area, or regional procedures and practices, either are shown below or will be issued by, or may be obtained from, the local Federal and/or State office.

Item 1: If the proposal is to redrill to the same reservoir at a different subsurface location or to a new reservoir, use this form with appropriate notations. Consult applicable State or Federal regulations concerning subsequent work proposals or reports on the well.

Item 4: If there are no applicable State requirements, locations on Federal or Indian land should be described in accordance with Federal requirements. Consult local State or Federal office for specific instructions.

Item 14: Needed only when location of well cannot readily be found by road from the land or lease description. A plat, or plats, separate or on this reverse side, showing the roads to, and the surveyed location of, the well, and any other required information, should be furnished when required by Federal or State agency offices.

Items 15 and 18: If well is to be, or has been directionally drilled, give distances for subsurface location of hole in any present or objective production zone.

Item 22: Consult applicable Federal or State regulations, or appropriate officials, concerning approval of the proposal before operations are started.

NEW MEXICO OIL CONSERVATION COMMISSION
WELL LOCATION AND ACERAGE DEDICATION PLAT

All distances must be from the outer boundaries of the Section

Operator PAN AMERICAN PETROLEUM CORPORATION		Lease GALLEGOS CANYON UNIT		Well No. 259
Unit Letter P	Section 14	Township 28 NORTH	Range 12 WEST	County SAN JUAN
Actual Footage Location of Well: 740 feet from the SOUTH line and 810 feet from the EAST line				
Ground Level Elev. REPORT LATER	Rocking Formation GALLUP	Pool PINON GALLUP		Dedicated Acreage: 80 Acres

- Outline the acreage dedicated to the subject well by colored pencil or hatchure marks on the plat below.
- If more than one lease is dedicated to the well, outline each and identify the ownership thereof (both as to working interest and royalty),
- If more than one lease of different ownership is dedicated to the well, have the interests of all owners been consolidated by communitization, unitization, force-pooling, etc?

(X) Yes () No If answer is "yes," type of consolidation Unitization

If answer is "no," list the owners and tract descriptions which have actually consolidated. (Use reverse side of this form if necessary.)

No allowable will be assigned to the well until all interests have been consolidated (by communitization, unitization, forced-pooling, or otherwise) or until a non standard unit, eliminating such interests, has been approved by the Commission.

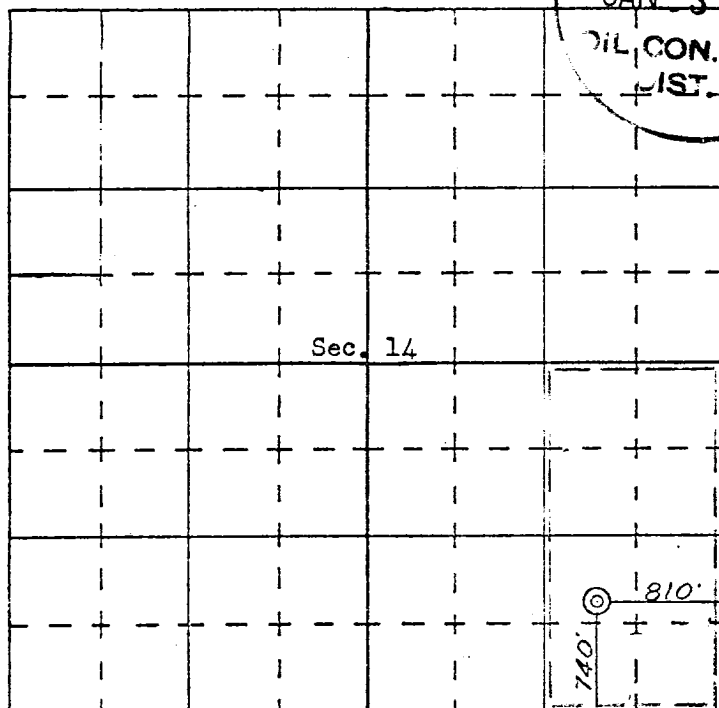

SCALE—4 INCHES EQUALS 1 MILE

SAN JUAN ENGINEERING COMPANY, FARMINGTON, N. M.

CERTIFICATION

I hereby certify that the information contained herein is true and complete to the best of my knowledge and belief.

Name G. W. Eaton, Jr.
 Position Area Engineer
 Company PAN AMERICAN PETROLEUM CORP.
 Date January 18, 1967

I hereby certify that the well location shown on this plat was plotted from field notes of actual surveys made by me or under my supervision, and that the same is true and correct to the best of my knowledge and belief.

Date Surveyed January 14, 1967
James P. Leese
 Registered Professional Engineer
 and/or Land Surveyor
JAMES P. LEESE
1463
 Certificate No.