

UNITED STATES
DEPARTMENT OF THE INTERIOR
GEOLOGICAL SURVEY

SUBMIT IN TRIPLICATE*
(Other instructions on reverse side)

30-045-20611

Form approved.
Budget Bureau No. 42-R1424.

5. LEASE DESIGNATION AND SERIAL NO.

SE-047017-B

6. IF INDIAN, ALLOTTEE OR TRIBE NAME

7. UNIT AGREEMENT NAME

8. FARM OR LEASE NAME

Sally

9. WELL NO.

#1

10. FIELD AND POOL, OR WILDCAT

Fulcher Kutz Picture Cliff

11. SEC., T., R., M., OR BLK. AND SURVEY OR AREA

Section 24-28N-11W

12. COUNTY OR PARISH

San Juan

New Mexico

1. OIL WELL ☐ GAS WELL ☒ OTHER

2. NAME OF OPERATOR

Chaparral Oil & Gas Company

3. ADDRESS OF OPERATOR

Box B, Aztec, New Mexico

4. LOCATION OF WELL (Report location clearly and in accordance with any State requirements.* See also space 17 below.)

At surface

790 FSL & 1850 FEL, Section 24-28N-11W

14. PERMIT NO.

15. ELEVATIONS (Show whether DF, RT, GR, etc.)

5853 Gr

16. Check Appropriate Box To Indicate Nature of Notice, Report, or Other Data

NOTICE OF INTENTION TO:

TEST WATER SHUT-OFF

FRACTURE TREAT

SHOOT OR ACIDIZE

REPAIR WELL

(Other)

PULL OR ALTER CASING

MULTIPLE COMPLETE

ABANDON*

CHANGE PLANS

SUBSEQUENT REPORT OF:

WATER SHUT-OFF

FRACTURE TREATMENT

SHOOTING OR ACIDIZING

(Other)

REPAIRING WELL

ALTERING CASING

ABANDONMENT*

(NOTE: Report results of multiple completion on Well Completion or Recompletion Report and Log form.)

17. DESCRIBE PROPOSED OR COMPLETED OPERATIONS (Clearly state all pertinent details, and give pertinent dates, including estimated date of starting any proposed work. If well is directionally drilled, give subsurface locations and measured and true vertical depths for all markers and zones pertinent to this work.)*

PROPOSE:

Drill 12 1/4" hole to 100'.

Set 7-5/8" surface casing at 100' with 75 sxs cement.

Drill to approximately T.D. 1915' or thru Picture Cliff formation.

Run 4 1/2" casing to T.D. Perf Picture Cliff formation.

San water, frac with 30,000# sand & water.

Run 1" Siphon String. Install well head.

18. I hereby certify that the foregoing is true and correct

SIGNED

TITLE President

DATE February 13, 1970

(This space for Federal or State office use)

APPROVED BY

TITLE

DATE

CONDITIONS OF APPROVAL, IF ANY:

*See Instructions on Reverse Side

**NEW MEXICO OIL CONSERVATION COMMISSION
WELL LOCATION AND ACREAGE DEDICATION PLAT**

Form C-102
Supersedes C-128
Effective 1-1-65

All distances must be from the outer boundaries of the Section.

Operator Chaparral Oil & Gas Co.			Lease Chaparral Sally		Well No. B 1
Unit Letter 0	Section 24	Township 28N	Range 11W	County San Juan	
Actual Footage Location of Well: 790 feet from the South line and 1850 feet from the East line					
Ground Level Elev. 5853	Producing Formation Pictured Cliffs	Pool Fletcher-Kott PC		Dedicated Acreage: 160 Acres	

1. Outline the acreage dedicated to the subject well by colored pencil or hachure marks on the plat below.
2. If more than one lease is dedicated to the well, outline each and identify the ownership thereof (both as to working interest and royalty).
3. If more than one lease of different ownership is dedicated to the well, have the interests of all owners been consolidated by communitization, unitization, force-pooling, etc?

☐ Yes ☐ No If answer is "yes," type of consolidation _____

If answer is "no," list the owners and tract descriptions which have actually been consolidated. (Use reverse side of this form if necessary.) _____

No allowable will be assigned to the well until all interests have been consolidated (by communitization, unitization, forced-pooling, or otherwise) or until a non-standard unit, eliminating such interests, has been approved by the Commission.

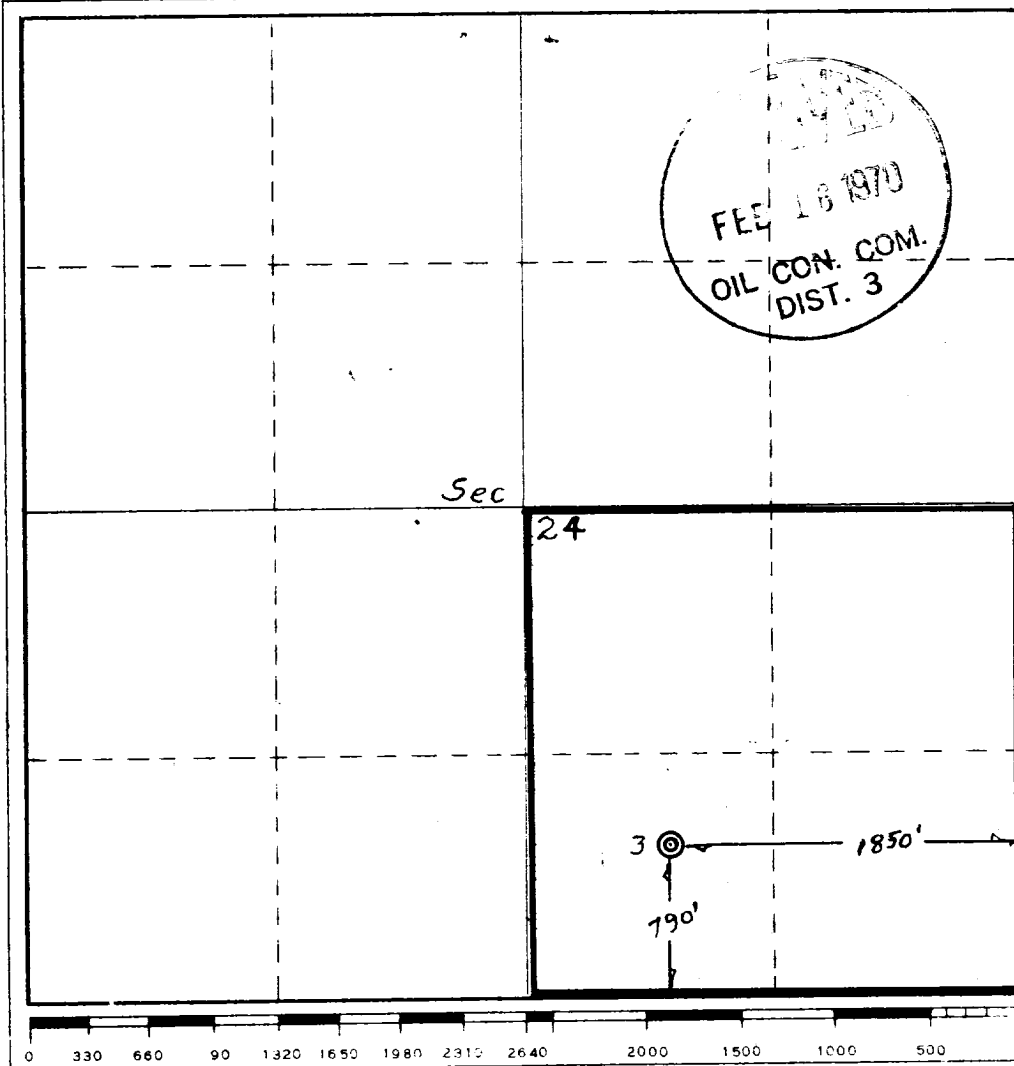

CERTIFICATION

I hereby certify that the information contained herein is true and complete to the best of my knowledge and belief.

Name: *Wayne L. Leland*
Position: _____

President

Company: **Chaparral Oil & Gas**

Date: **February 13, 1970**

I hereby certify that the well location shown on this plat was plotted from field notes of actual surveys made by me or under my supervision, and that the same is true and correct to the best of my knowledge and belief.

Date Surveyed: **January 30, 1970**

Registered Professional Engineer and/or Land Surveyor
Fred B. Kerr Jr.
F.B. Kerr Jr.

Plat No. **3950**