

UNITED STATES
DEPARTMENT OF THE INTERIOR
GEOLOGICAL SURVEY

30-045-21869

APPLICATION FOR PERMIT TO DRILL, DEEPEN, OR PLUG BACK

1a. TYPE OF WORK DRILL <input checked="" type="checkbox"/> DEEPEN <input type="checkbox"/> PLUG BACK <input type="checkbox"/>		5. LEASE DESIGNATION AND SERIAL NO. SF 47017 (b)
b. TYPE OF WELL OIL WELL <input type="checkbox"/> GAS WELL <input checked="" type="checkbox"/> OTHER <input type="checkbox"/>		6. IF INDIAN, ALLOTTEE OR TRIBE NAME J. S.
2. NAME OF OPERATOR W. M. GALLAWAY		7. UNIT AGREEMENT NAME
3. ADDRESS OF OPERATOR 101-2 Petroleum Plaza Bldg., Farmington, N.M. 87401		8. FARM OR LEASE NAME Charles
4. LOCATION OF WELL (Report location clearly and in accordance with any State requirements.) At surface 1190 FSL, 822 FWL At proposed prod. zone		9. WELL NO. 1
14. DISTANCE IN MILES AND DIRECTION FROM NEAREST TOWN OR POST OFFICE* Approx. 5 miles Southeast of Bloomfield, N.M.		10. FIELD AND POOL OR WILDCAT Fruitland exx
10. DISTANCE FROM PROPOSED* LOCATION TO NEAREST PROPERTY OR LEASE LINE, FT. (Also to nearest drlg. unit line, if any) 822'		11. SEC., T., R., M., OR BLK. AND SURVEY OR AREA M Sec. 24, T28N, R11W, N.M.P.M.
18. DISTANCE FROM PROPOSED LOCATION* TO NEAREST WELL, DRILLING, COMPLETED, OR APPLIED FOR, ON THIS LEASE, FT. 930'		12. COUNTY OR PARISH San Juan
16. NO. OF ACRES IN LEASE 160		13. STATE N. M.
17. NO. OF ACRES ASSIGNED TO THIS WELL 160		20. ROTARY OR CABLE TOOLS Rotary
21. ELEVATIONS (Show whether DF, RT, GR, etc.) 5784' GR		22. APPROX. DATE WORK WILL START* 10-1-75

PROPOSED CASING AND CEMENTING PROGRAM				
SIZE OF HOLE	SIZE OF CASING	WEIGHT PER FOOT	SETTING DEPTH	QUANTITY OF CEMENT
8 3/4"	7 5/8"	28#	60'	25 Sacks
6 3/4"	4 1/2"	10.50#	1700'	150 Sacks

Plan to mud drill through Fruitland formation and set production casing through productive zone, perforate casing, stimulate well by fracing, run tubing and test well.

RECEIVED

AUG 25 1975

U.S. GEOLOGICAL SURVEY

IN ABOVE SPACE DESCRIBE PROPOSED PROGRAM: If proposal is to deepen or plug back, give data on present productive zone and proposed new productive zone. If proposal is to drill or deepen directionally, give pertinent data on subsurface locations and measured and true vertical depths. Give blowout preventer program, if any.

24. SIGNED W. M. Gallaway TITLE Operator DATE 8-25-75
(This space for Federal or State office use)

PERMIT NO. _____ APPROVAL DATE _____

APPROVED BY _____ TITLE _____ DATE _____
CONDITIONS OF APPROVAL, IF ANY:OK

*See Instructions On Reverse Side



NEW MEXICO OIL CONSERVATION COMMISSION

Form C-102

**NEW MEXICO OIL CONSERVATION COMMISSION
WELL LOCATION AND ACREAGE DEDICATION PLAT**

Form C-102
Supersedes C-128
Effective 1-1-65

All distances must be from the outer boundaries of the Section.

Operator W. M. GALLAWAY			Lease CHARLES		Well No. 1
Unit Letter M	Section 24	Township 28 NORTH	Range 11 WEST	County SAN JUAN	
Actual Footage Location of Well: 1190 feet from the SOUTH line and 822 feet from the WEST line.					
Ground Level Elev. 5784	Producing Formation FRUITLAND		Pool Indefinite, ext	Dedicated Acreage 160 Acres	

1. Outline the acreage dedicated to the subject well by colored pencil or hachure marks on the plat below.
2. If more than one lease is dedicated to the well, outline each and identify the ownership thereof (both as to working interest and royalty).
3. If more than one lease of different ownership is dedicated to the well, have the interests of all owners been consolidated by communitization, unitization, force-pooling, etc?

☐ Yes ☐ No If answer is "yes," type of consolidation _____

If answer is "no," list the owners and tract descriptions which have actually been consolidated. (Use reverse side of this form if necessary.) _____

No allowable will be assigned to the well until all interests have been consolidated (by communitization, unitization, forced-pooling, or otherwise) or until a non-standard unit, eliminating such interests, has been approved by the Commission.

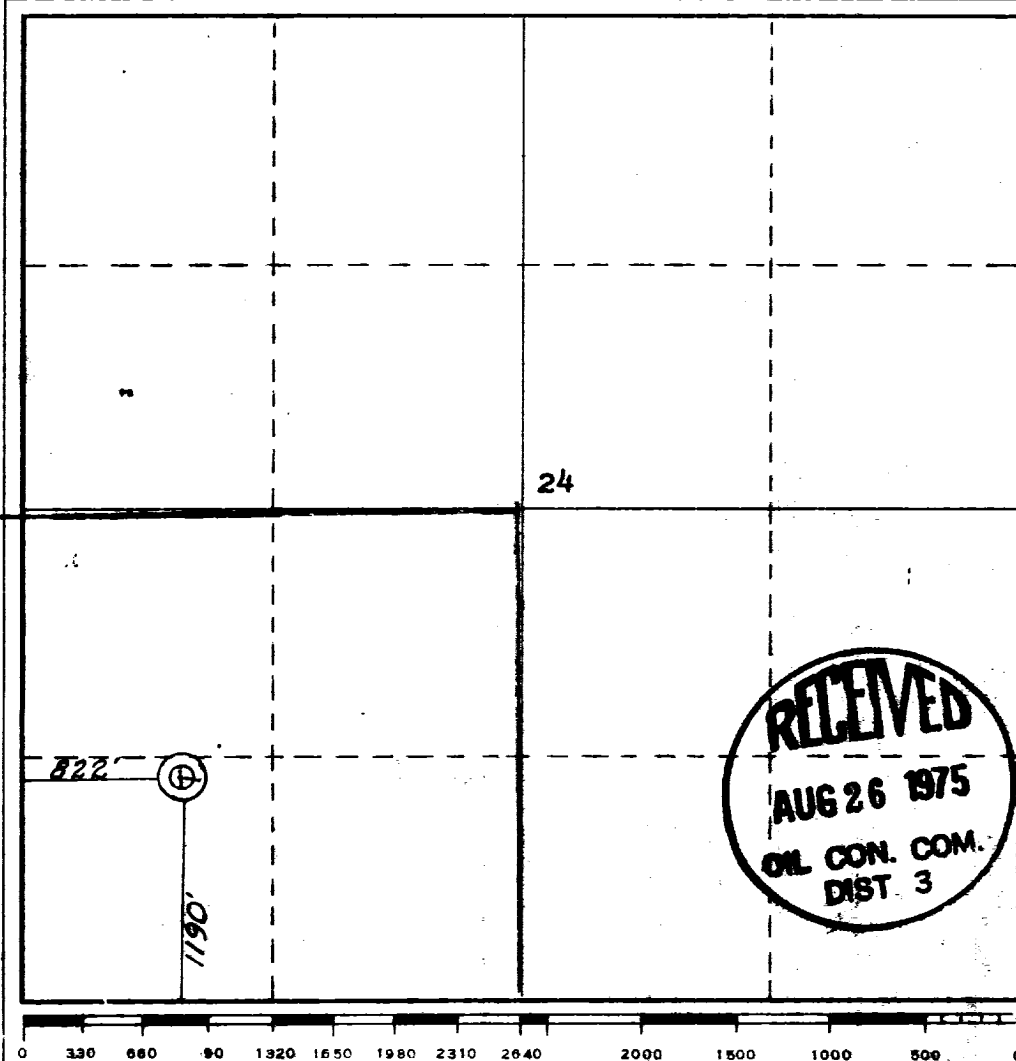

CERTIFICATION

I hereby certify that the information contained herein is true and complete to the best of my knowledge and belief.

W. M. Gallaway

Name

W. M. Gallaway

Position

Operator

Company

W. M. Gallaway

Date

August 26, 1975

I hereby certify that the well location shown on this plat was plotted in the field notes of the well made by me or under my supervision and that the same is true and correct to the best of my knowledge and belief.

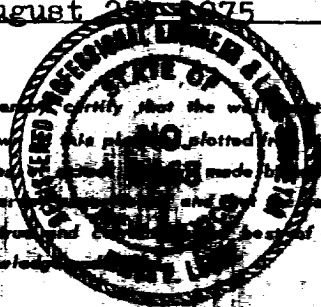

Date Surveyed

19 August 1975

Registered Professional Engineer and/or Land Surveyor

James P. Leese
James P. Leese

Certificate No.

1463

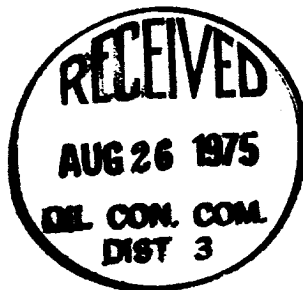
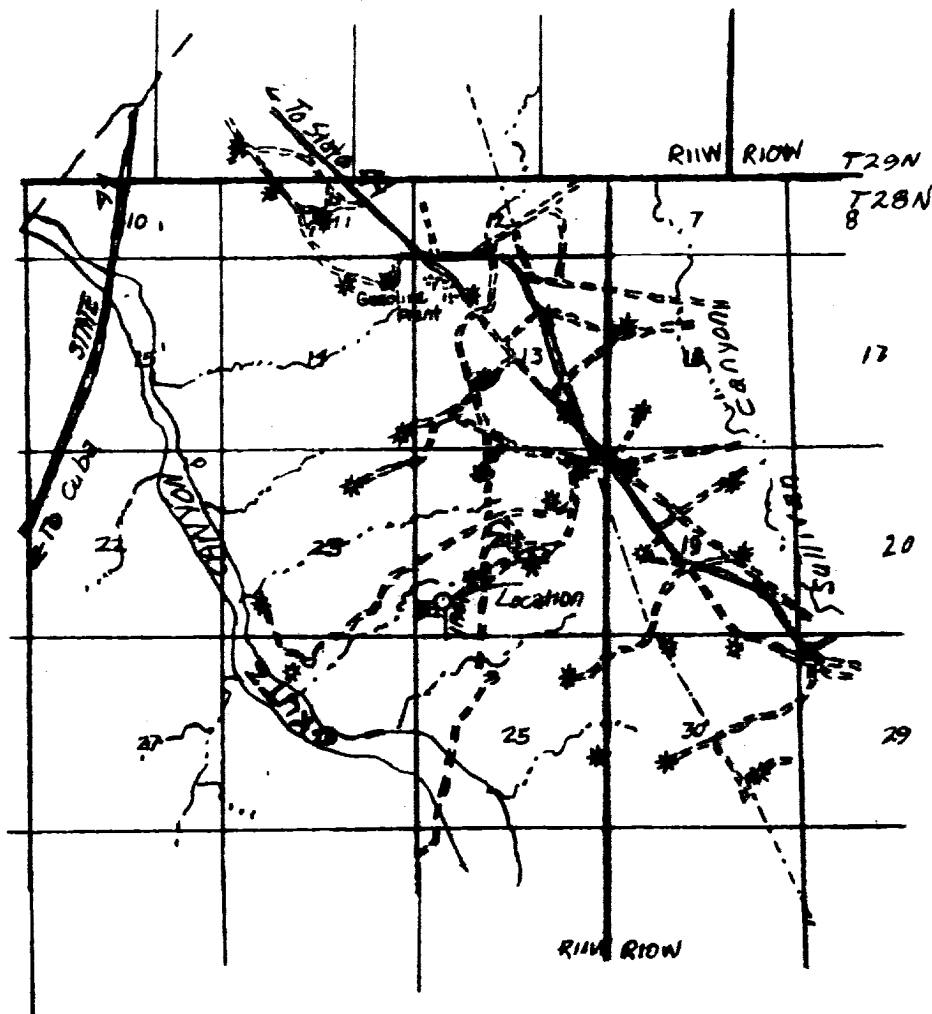

Vicinity Map for

W. M. GALLAWAY.

Showing well location in the
SW/4 SW/4 of Section 24,
T28 N, R11 W, N.M.P.M.,
San Juan County, New Mexico.

Date: 19 August, 1975 Scale: 1"=6000'

San Juan Engineering Company

No Scale Development Plan Charles # 1

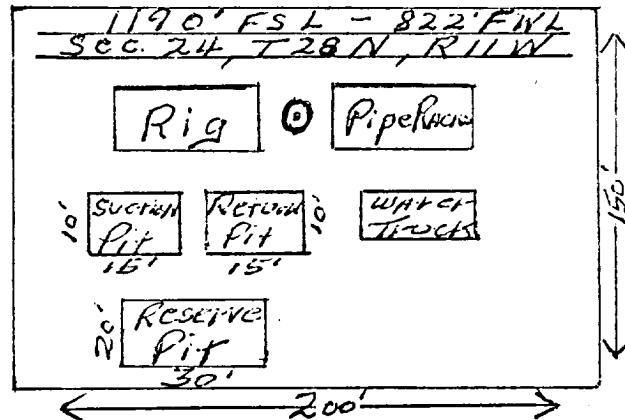

This location is 5 miles Southeast of Bloomfield, New Mexico.

Existing roads adjoin this location so we propose no new roads.

Waste disposal will be handled by reserve pit.

Water supply - off of water truck.

Plan to restore surface by leveling and filling after well is drilled.

No tank batteries, camps or airstrips.

