

UNITED STATES  
DEPARTMENT OF THE INTERIOR  
GEOLOGICAL SURVEY

## APPLICATION FOR PERMIT TO DRILL, DEEPEN, OR PLUG BACK

## 1a. TYPE OF WORK

DRILL ☒DEEPEN ☐PLUG BACK ☐

## b. TYPE OF WELL

OIL  
WELL ☐GAS  
WELL ☒

OTHER

SINGLE  
ZONE ☐MULTIPLE  
ZONE ☐

## 2. NAME OF OPERATOR

Pioneer Production Corp.

## 3. ADDRESS OF OPERATOR

Box 208, Farmington, NM 87401

## 4. LOCATION OF WELL (Report location clearly and in accordance with any State requirements.)

At surface

1740' FNL - 1800' FEL

At proposed prod. zone

## 14. DISTANCE IN MILES AND DIRECTION FROM NEAREST TOWN OR POST OFFICE\*

3-1/2 miles south of Bloomfield, NM

## 15. DISTANCE FROM PROPOSED\*

LOCATION TO NEAREST  
PROPERTY OR LEASE LINE, FT.  
(Also to nearest drlg. unit line, if any)

1740'

## 18. DISTANCE FROM PROPOSED LOCATION\*

TO NEAREST WELL, DRILLING, COMPLETED,  
OR APPLIED FOR, ON THIS LEASE, FT.

1780'

## 16. NO. OF ACRES IN LEASE

240

## 19. PROPOSED DEPTH

6325'

17. NO. OF ACRES ASSIGNED  
TO THIS WELL

N 320

## 20. ROTARY OR CABLE TOOLS

Rotary

## 21. ELEVATIONS (Show whether DF, RT, GR, etc.)

5556' GL

## 22. APPROX. DATE WORK WILL START\*

ASAP

## 23.

## PROPOSED CASING AND CEMENTING PROGRAM

SIZE OF HOLE	SIZE OF CASING	WEIGHT PER FOOT	SETTING DEPTH	QUANTITY OF CEMENT
12-1/2"	8-5/8"	24#	200'	150 SX
7-7/8"	4-1/2"	10.5#	6325'	855 SX

Plan to drill with mud to test the Basin Dakota Formation. Plan to run IES log to TD. If productive, plan to set 4-1/2" casing, cement in two stages, selectively perforate, frac, clean out after frac, run 1-1/2" tbg and complete well.

Plan to use BOP furnished by rig while drilling (10" 3000 psi hydraulic)

Plan to use BOP rental while completing (6" 3000 psi double gate manual)

NMERB: Gas Dedicated.

IN ABOVE SPACE DESCRIBE PROPOSED PROGRAM: If proposal is to deepen or plug back, give data on present productive zone and proposed new productive zone. If proposal is to drill or deepen directionally, give pertinent data on subsurface locations and measured and true vertical depths. Give blowout preventer program, if any.

## 24.

SIGNED

Thomas A. Dugan

TITLE

Agent

DATE

5-20-80

(This space for Federal or State office use)

PERMIT NO.

APPROVAL DATE

APPROVED BY

CONDITIONS OF APPROVAL, IF ANY:

ok 3 m

DRILLING OPERATIONS AUTHORIZED ARE  
SUBJECT TO CONDITIONS WITH ATTACHED  
"GENERAL REQUIREMENTS"

\*See Instructions On Reverse Side

4/10/80

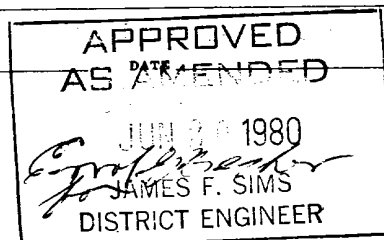
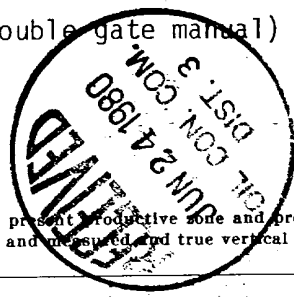

**NEW MEXICO OIL CONSERVATION COMMISSION  
WELL LOCATION AND ACREAGE DEDICATION PLAT**

Form C-102  
Supersedes C-128  
Effective 1-1-65

All distances must be from the outer boundaries of the Section.

Operator <b>Pioneer Production Corporation</b>			Lease <b>Ohio</b>		Well No. <b>1E</b>
Unit Letter <b>G.</b>	Section <b>22</b>	Township <b>28 North</b>	Range <b>11 West</b>	County <b>San Juan</b>	
Actual Footage Location of Well: <div style="display: flex; justify-content: space-between;"> <span>1740 feet from the North line and</span> <span>1800 feet from the East line</span> </div>					
Ground Level Elev. <b>5556</b>	Producing Formation <b>Dakota</b>	Pool <b>Basin Dakota</b>		Dedicated Acreage: <b>320 Acres</b>	

1. Outline the acreage dedicated to the subject well by colored pencil or hachure marks on the plat below.
2. If more than one lease is dedicated to the well, outline each and identify the ownership thereof (both as to working interest and royalty).
3. If more than one lease of different ownership is dedicated to the well, have the interests of all owners been consolidated by communitization, unitization, force-pooling, etc?

☐ Yes   ☐ No   If answer is "yes," type of consolidation \_\_\_\_\_

If answer is "no," list the owners and tract descriptions which have actually been consolidated. (Use reverse side of this form if necessary.) \_\_\_\_\_

No allowable will be assigned to the well until all interests have been consolidated (by communitization, unitization, forced-pooling, or otherwise) or until a non-standard unit, eliminating such interests, has been approved by the Commission.

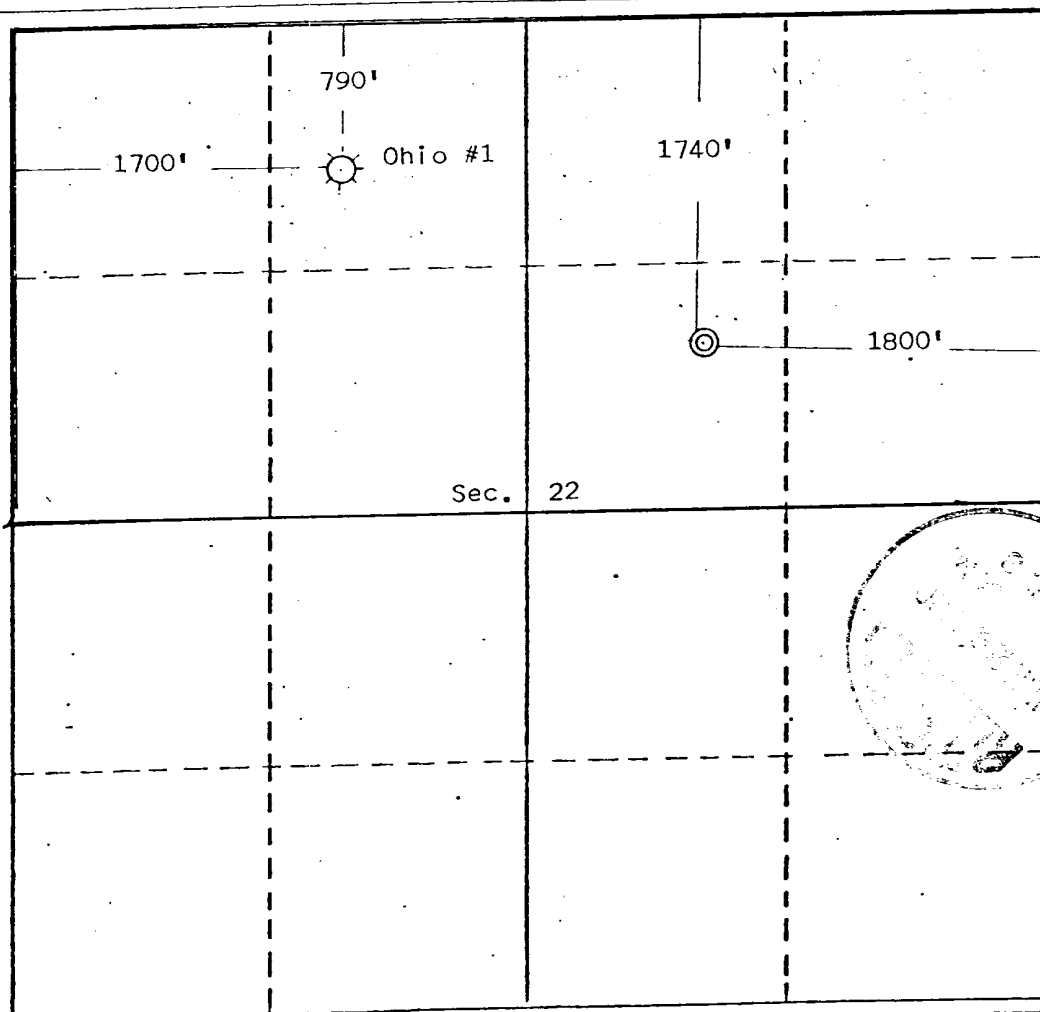

**CERTIFICATION**

I hereby certify that the information contained herein is true and complete to the best of my knowledge and belief.

Name  
**Thomas A. Dugan**

Position  
**Agent**

Company  
**Pioneer Production Corp.**

Date  
**5-20-80**

Date Surveyed  
**May 3, 1980**

Registered Professional Engineer  
and/or Land Surveyor

**Edgar L. Risenhoover**  
Certificate No. 5979

**Edgar L. Risenhoover, L.S.**

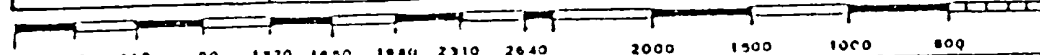

# TYPICAL BOP INSTALLATION

FOR DAKOTA WELL

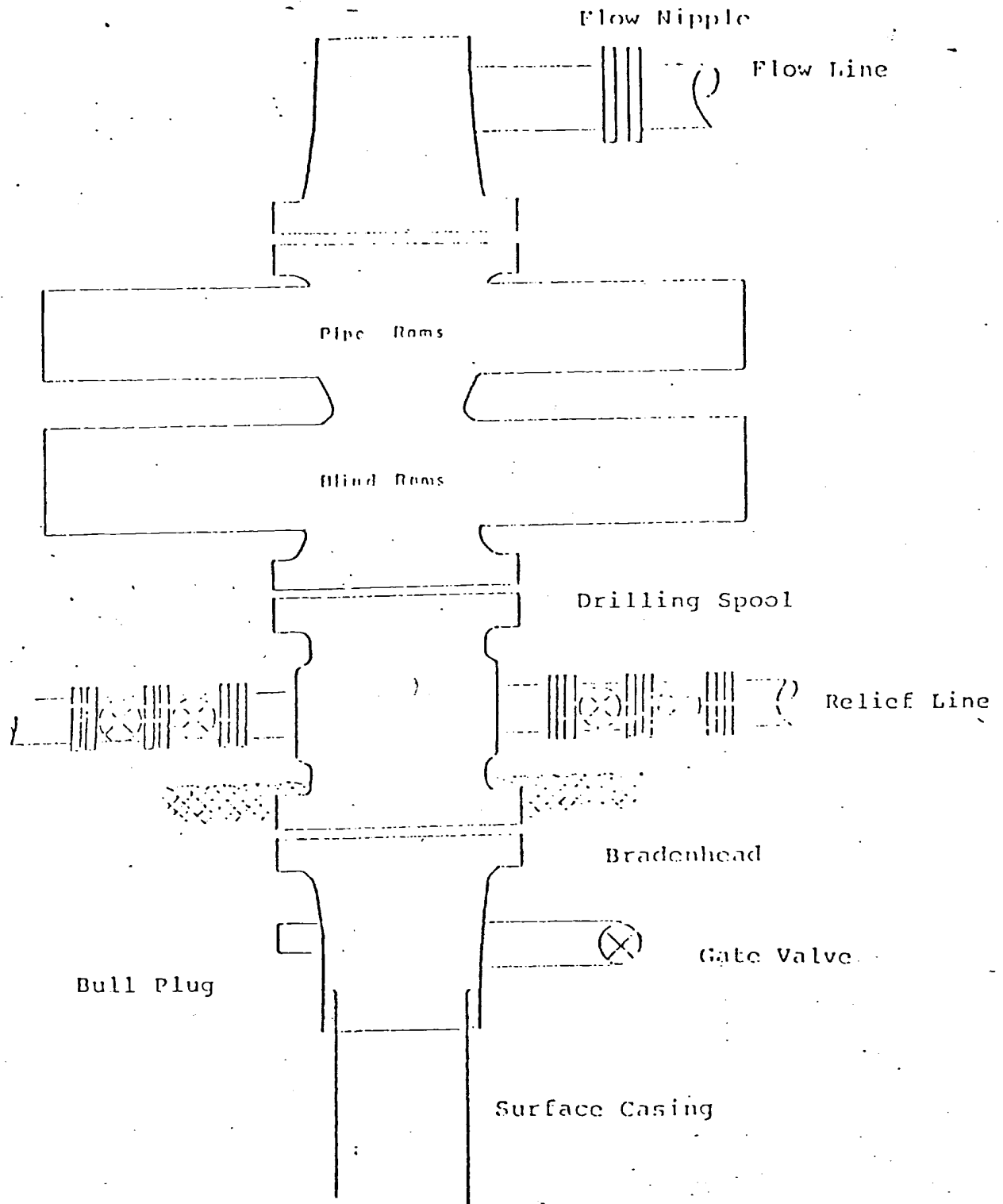

Series 900 Double Gate BOP, rated  
at 3000 psi Working Pressure

When gas drilling operations begin a Shaffer type  
50 or equivalent rotating head is installed on top of  
the flow nipple and the flow line is converted into  
a blowie line.

PIONEER PRODUCTION CORP.  
 OHIO #1E

Proposed Location Layout

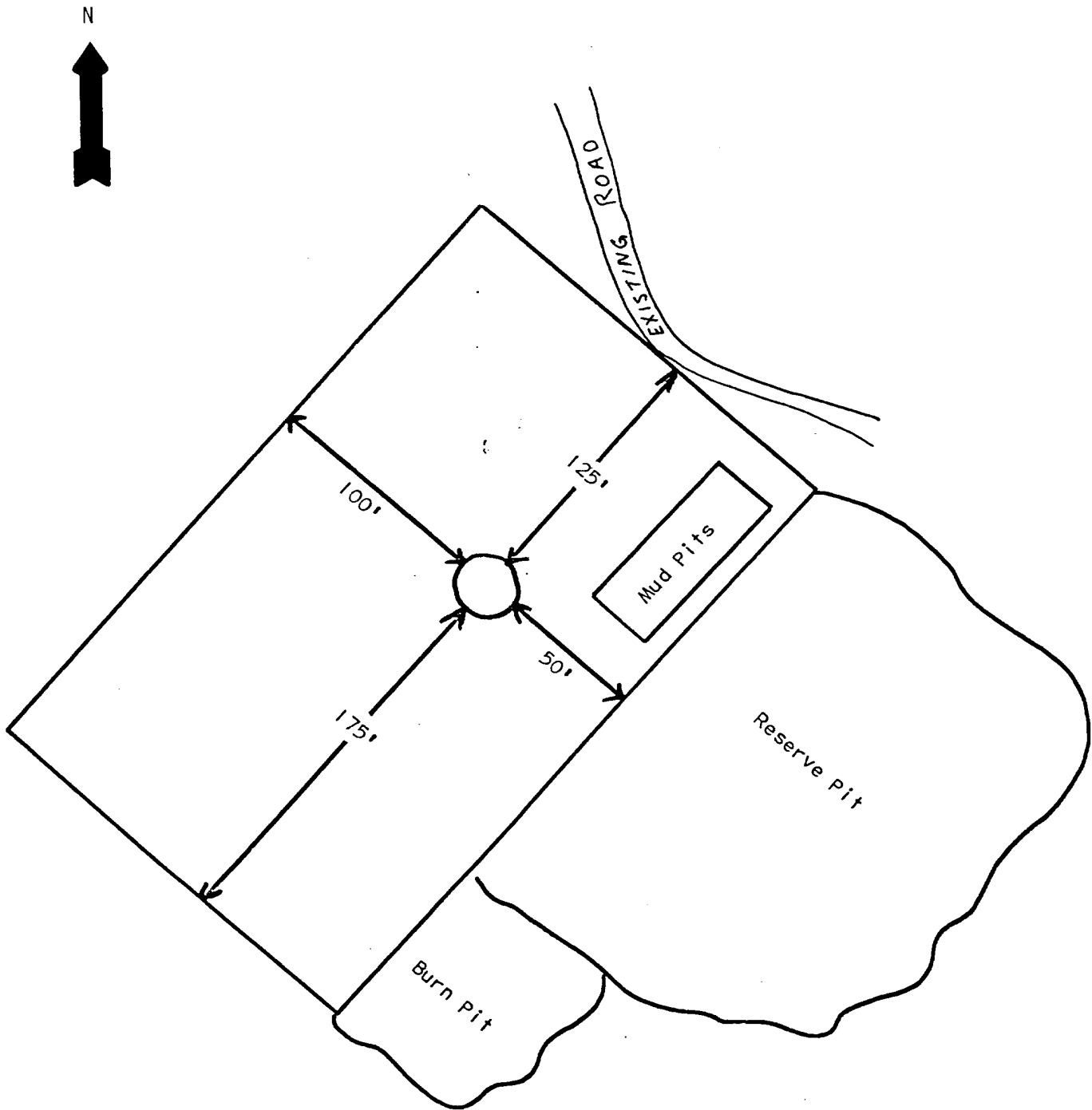

DEVELOPMENT PLAN

Pioneer Production Corp.

Ohio #1F

1. Existing roads and existing wells are shown on attached plat.
2. Planned access from existing road approximately none to new location. Will leave natural grass and small vegetation on roadway. Will remove large brush or trees from road. Do not plan to make road grade or bar ditches. Will bottom-out any arroyo we cross and not install culverts.
3. Location of well: 1740' FNL - 1800' FEL  
Sec 22 T28N R11W  
San Juan County, NM
4. No additional well(s) planned on this lease at this time.
5. Separator and flow line will be located within 50' of wellhead.
6. Water will be secured from San Juan River.
7. Waste materials will be buried on location or in reserve pit.
8. No permanent camp is planned; trailer house will be used on location while drilling.
9. Do not plan to build airstrip.
10. See attached plat for proposed location layout.
11. A general description of the topography, soil characteristics, geologic features, flora and fauna; other surface-use activities and surface ownership of involved lands, proximity of water, occupied dwellings, archeological, historical or cultural sites can be found in the archeologist's report.
12. Geologic name of surface formation: Undifferentiated Tertiary
13. Estimated tops of important geologic markers: See Attached Operations Plan
14. Estimated depths of anticipated water, oil, gas, or other mineral bearing formations which are expected to be encountered: Gallup - oil - 5217' gas - PC - 1686'  
DK - 6125'
15. We do not anticipate to encounter any abnormal pressures or temperatures or any potential hazards such as those associated with hydrogen sulfide.
16. Will clean up location, fill and level pits, level ruts in road, reseed location and road with Seed Mixture #2 and paint equipment with Sandstone Brown.
17. Operator's Representative:  
Thomas A. Dugan  
Box 208  
Farmington, NM 87401
18. Certification: The following statement must be signed by the lessee's or operator's field representative who is identified in Item #17 of the Plan:

I hereby certify that I, or persons under my direct supervision, have inspected the proposed drillsite and access route; that I am familiar with the conditions which presently exist; that the statements made in this Plan are, to the best of my knowledge, true and correct; and, that the work associated with the operations proposed herein will be performed by Pioneer Production Corp. and its contractors and subcontractors in conformity with this Plan and the terms and conditions under which it is approved.

Date: 5-20-80

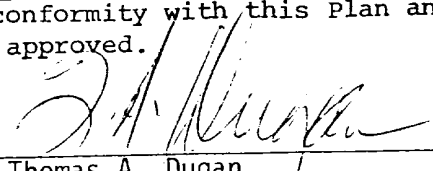
  
Thomas A. Dugan  
Agent

U-1857A

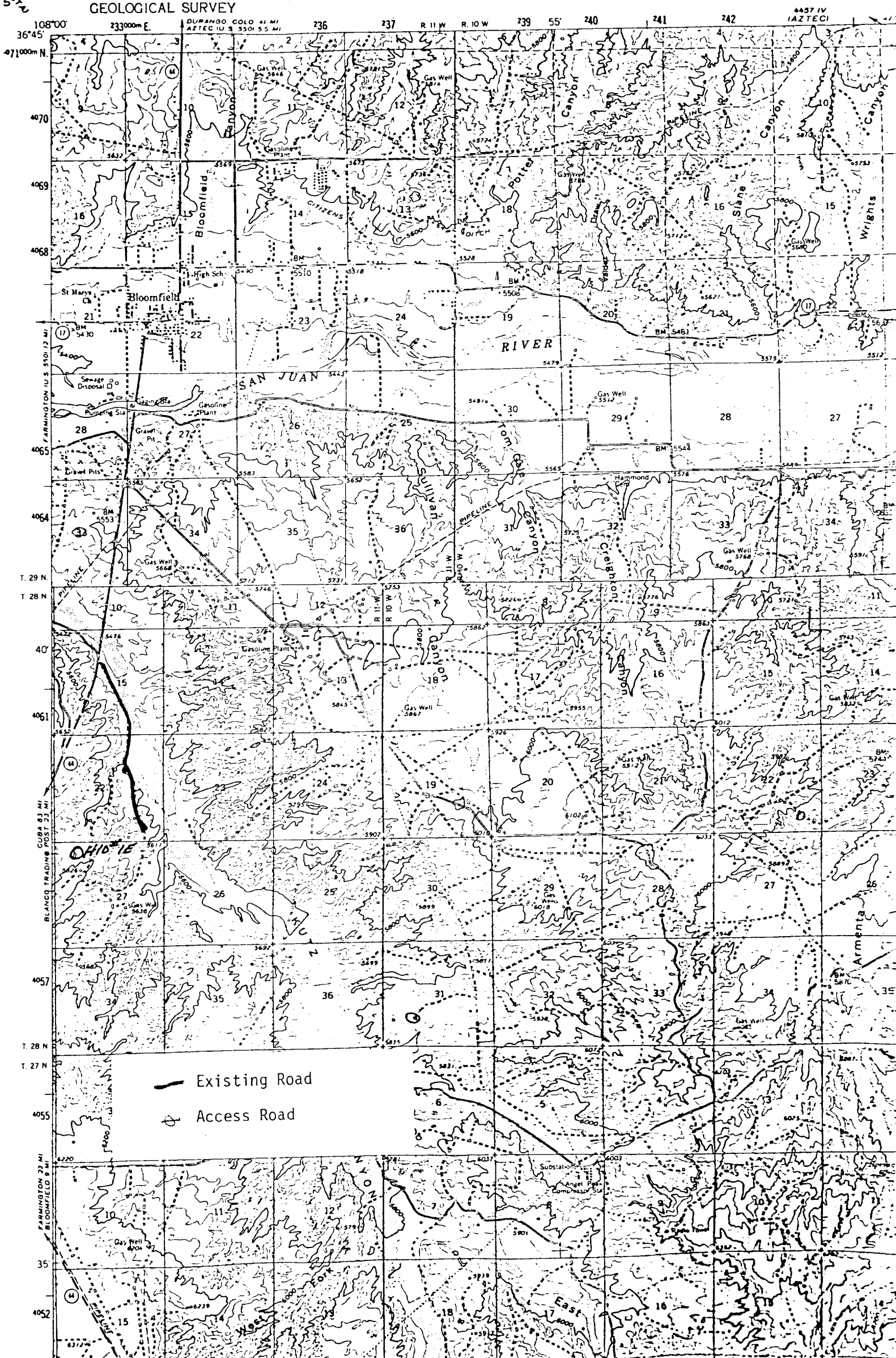

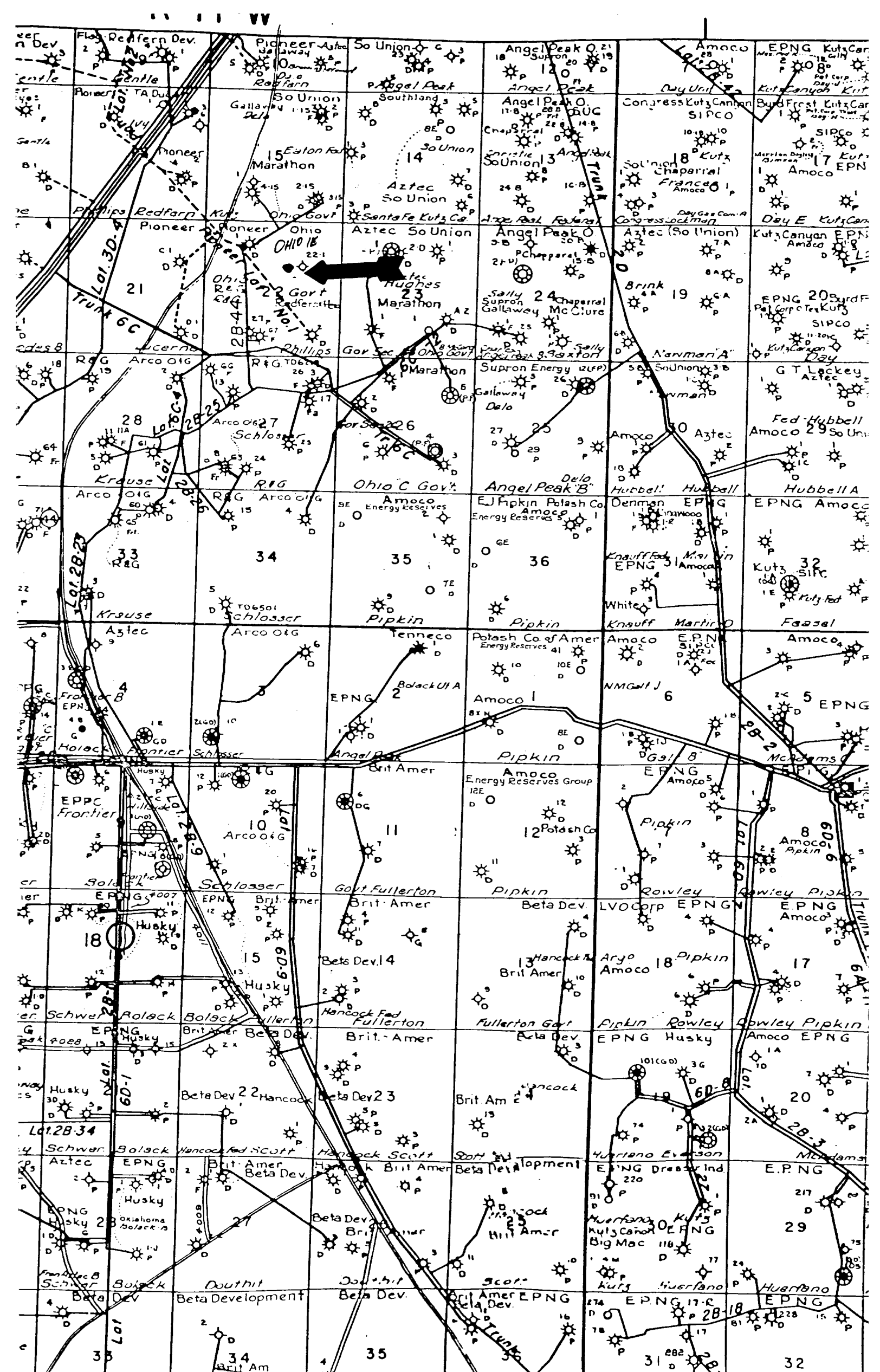

## OPERATIONS PLAN

OPERATOR: Pioneer Production Corp.  
WELL NAME: Ohio #1E  
FIELD: Basin Dakota  
LOCATION: 1740' FNL - 1800' FEL      Sec 22 T28N R11W      San Juan County, NM  
ELEVATION: 5556' GL

EXPECTED FORMATION TOPS:	Ojo Alamo		Point Lookout	4020'
	Kirtland	654'	Mancos	4165'
	Fruitland	1452'	Gallup	5217'
	Pictured Cliffs	1686'	Greenhorn	6025'
	Lewis		Graneros	6085'
	Cliff House	3191'	Dakota	6125'
	Menefee	3388'	Total Depth	6325'

LOGGING PROGRAM: IES and Density Neutron  
SAMPLES: Catch samples in 10' intervals beginning at 6050'

### CASING PROGRAM

<u>Hole Size</u>	<u>Depth</u>	<u>Csg Size, Wt, Grade, &amp; Condition</u>				<u>Cementing Program</u>
12-1/2"	180'	8-5/8"	24#	J-55	New	Cement to surface w/150 sx neat w/2% CaCl.
7-7/8"	6325'	4-1/2"	10.5#	K-55	New	Cement in two stages as follows:

#### 1st stage:

Cement w/200 sx 65-35 plus 12% gel and 150 sx class "B"neat and 1/4# flocele per sx.

#### 2nd stage:

Cement 2nd stage thru stage tool at 4150' w/425 sx of 65-35 plus 12% gel and 80 sx of neat w/4% gel.

Total slurry both stages: 1900 cu ft

### WELLHEAD EQUIPMENT

8-5/8" x 10" 600 series Bradenhead  
10" x 6" 600 series Christmas tree "NEW"

Office	-	325-0238
Tom Dugan		325-5694
Jim Jacobs		325-8353
Sherman Dugan		327-4287
Bill Donovan		325-5692
James Hazen		