

STATE OF NEW MEXICO

ENERGY, MINERALS AND NATURAL RESOURCES DEPARTMENT

OIL CONSERVATION DIVISION



POST OFFICE BOX 2088  
STATE LAND OFFICE BUILDING  
SANTA FE, NEW MEXICO 87504  
(505) 827-5800

BRUCE KING  
GOVERNOR

ANITA LOCKWOOD  
CABINET SECRETARY

June 6, 1994

Meridian Oil, Inc.  
P.O. Box 4289  
Farmington, NM 87499-4289

Attention: Peggy Bradfield

*Reinstated Division Administrative Order NSL-2688*

Dear Ms. Bradfield:

By your letter (with attachments) dated April 12, 1994, Division Administrative Order NSL-2688, dated April 17, 1989, which approved the Angel Peak "8" Well No. 31 as an unorthodox coal gas well location being 990 feet from the North line and 1650 feet from the West line (Unit C) of Section 25, Township 28 North, Range 11 West, NMPM, Basin-Fruitland Coal Gas Pool, San Juan County, New Mexico, is hereby re-instated. All provisions contained therein are to be continued in full force and effect.

Jurisdiction of this cause, however, is retained for the entry of such further orders as the Division may deem necessary.

Sincerely,

William J. LeMay  
Director

WJL/MES/amg

cc: Oil Conservation Division - Aztec  
US Bureau of Land Management - Farmington  
Division File: Case No. 10183  
NSL-2688

**RECEIVED**  
JUN 17 1994  
OIL CON. DIV.  
DIST. 3

## **Ernie Busch**

---

**From:** Ernie Busch  
**To:** Mike Stogner  
**Subject:** MERIDIAN OIL INC. (NSL)  
**Date:** Tuesday, May 17, 1994 7:29AM  
**Priority:** High

**WELL NAME & NO.** ANGEL PEAK B #31  
**LOCATION:** C-25-28N-11W  
**FOOTAGE:** 990 FNL; 1650 FWL  
**RECOMMEND:** APPROVAL

DISTRICT I  
P.O. Box 1980, Hobbs, NM 88240  
DISTRICT II  
P.O. Drawer DD, Artesia, NM 88210  
DISTRICT III  
1000 Rio Brazos Rd., Aztec, NM 87410

State of New Mexico  
Energy, Minerals and Natural Resources Department  
**OIL CONSERVATION DIVISION**  
P.O. Box 2088  
Santa Fe, New Mexico 87504-2088

OPERATOR'S MONTHLY REPORT  
Form C-115 - Revised 1/1/89  
See Distribution and Code  
Information Bottom of Page

Company or Operator Robert C. Dintelman

Address 3109 Mesa Dr., Farmington, NM 87401  
New Mexico  
For Month, 11/91 Page 1 of 1

POOL NAME (Underline) *Lease Name WELL NO. UNIT SEC. TWP R1NG	WELL STATUS	INJECTION		PRODUCTION			DISPOSITION OF GAS			DISPOSITION OF OIL								
		VOLUME	PRESS.	BARRELS OIL/COND. PRODUCED	BARRELS OF WATER PRODUCED	GAS PRODUCED (MCF)	DAYS PROD.	SOLD	TRANS- POR- TER	OTHER	C O D E	OIL ON HAND AT BEG. OF MONTH	BARRELS TO TRANS- POR- TER	TRANS- POR- TER	OTHER	C O D E	OIL ON HAND AT END OF MONTH	
<u>FULCHER KUTZ PICTURED</u>																		
<u>CLIFF (GAS)</u>																		
<u>Viles</u>																		
<u>11 30 29 11</u>																		
<u>Lease Total</u>																		
				0	0	844	29	844	EPG			0	0				0	
				0	0	844												

LEASE NAME - Include State Land Lease Number or Federal Lease Number

STATUS CODE  
F..... FLOWING  
P..... PUMPING  
G..... GAS LIFT  
S..... SHUT IN  
T..... TEMP ABANDONED  
I..... INJECTION  
D..... DISCONTINUED

OTHER GAS DISPOSITION CODE  
X..... USED OFF LEASE  
D..... USED FOR DRILLING  
G..... GAS LIFT  
L..... LOST (MCF ESTIMATED)  
E..... EXPLANATION ATTACHED  
R..... REPRESSURING OR  
V..... VENTED  
U..... USED ON LEASE

OTHER OIL DISPOSITION CODE  
C..... CIRCULATING OIL  
L..... LOST  
S..... SEDIMENTATION (B.S. & W)  
E..... EXPLANATION ATTACHED  
T..... THEFT

I HEREBY CERTIFY THAT THE INFORMATION GIVEN IS TRUE AND COMPLETE TO THE BEST OF MY KNOWLEDGE

TYPED NAME Jo Dintelman 505-325-6804  
Agent  
POSITION  
DATE 12/20/91

# MERIDIAN OIL

April 12, 1994

## Federal Express

Mr. William LeMay  
New Mexico Oil Conservation Division  
310 Old Santa Fe Trail  
Santa Fe, New Mexico 87501

Re: Angel Peak B #31  
990'FNL, 1650'FWL, Section 25, T-28-N, R-11-W, San Juan County, NM  
API #30-045-24458

Dear Mr. LeMay:

Meridian Oil wishes to make application for a non-standard location for this well to be plugged back in the Basin Fruitland Coal formation. This well originally was completed as a Gallup well. This location is considered off-pattern for the northeast/southwest quarter pool rules for the Fruitland Coal.

The following is a chronology of events by Union Texas, Meridian Oil and the New Mexico Oil Conservation Division concerning this well. Attached are copies for each event.

- July 19, 1989 - Application for non-standard location for this well in the Fruitland Coal made by Union Texas Petroleum
- August 17, 1989 - NSL 2688 issued by the New Mexico Oil Conservation Division.
- August 14, 1989 - Union Texas set a cement retainer at 5340' and squeeze cemented the Gallup. The lower Fruitland Coal was perforated 1769-80' and fracture treated. A bridge plug was set at 1740' and two squeeze holes perforated at 1604'. Operations were suspended at that time.
- January 1, 1990 - Meridian Oil assumes operatorship.
- October 10, 1990 - application was made by Meridian Oil for non-standard location.
- November 8, 1990 - letter from M. Stogner of NMOCD asking Meridian's involvement with well and several other issues.
- November 9, 1990 - objection made by General Minerals.
- November 14, 1990 - letter from M. Stogner setting hearing December 19, 1990.
- February 11, 1991 - Order R-9436 Case 10183 dismissed.
- February 12, 1991 - letter from M. Stogner placing Order NSL-2688 in abeyance.

**RECEIVED**  
APR 14 1994  
**OIL CON. DIV.**  
**DIST. 3**

Mr. William LeMay  
New Mexico Oil Conservation Division  
Page Two - Angel Peak B #31  
April 12, 1994

To comply with the New Mexico Oil Conservation Division rules, Meridian is submitting the following for your approval of this non-standard location:

1. C-102 plat showing location of the well;
2. Plat showing offset owners/operators;
3. Affidavit of notification of offset owners/operators;
4. Copy of Well Completion Log for original completion.

A copy of this application is being submitted to all offset owners/operators by certified mail with a request that they furnish your Santa Fe office with a Waiver of Objection, and return one copy to this office.

Sincerely yours,



Peggy Bradfield  
Regulatory/Compliance Representative

#### WAIVER

\_\_\_\_\_ hereby waives objection to Meridian Oil Inc.'s application for non-standard location for the Angel Peak B #31 as proposed above.

By: \_\_\_\_\_ Date: \_\_\_\_\_

xc: Marathan Oil  
BHP Petroleum  
James M. Collins  
Chaparral Oil & Gas  
Vanderslice Petroleum Corp.  
James U. Cnatrell Estate  
Joe C. Salmon  
Bettye Jean Salmon  
General Minerals Corp.



Union Texas Petroleum

1130 Post Oak Blvd  
Box 2100  
Houston, Texas 77002-0100  
713-623-6544

July 19, 1989

William J. LeMay - Director  
New Mexico Oil Conservation Commission  
P.O. Box 2088  
Sante Fe, New Mexico 87504

Re: Angel Peak "8" #31  
San Juan County, New Mexico

WELL FILE

Dear Mr. LeMay:

The well listed above is currently completed in the Armenta Gallup Field. We are planning recompletion to the Fruitland Coal formation but spacing rules place the existing well bore in an unorthodox location.

We request approval for exception to unorthodox location for this well.

Attached for your information is a C-102 reflecting the location of the well.

Please contact me at 713/968-4004 if you have any questions concerning this request.

Best regards,

Ken E. White  
Regulatory Permit Coordinator

KEW/acb  
Attachments

KEW:0436



STATE OF NEW MEXICO

ENERGY, MINERALS AND NATURAL RESOURCES DEPARTMENT

OIL CONSERVATION DIVISION

GARREY CARRUTHERS  
GOVERNOR

POST OFFICE BOX 2088  
STATE LAND OFFICE BUILDING  
SANTA FE, NEW MEXICO 87504  
(505) 927-5800

August 17, 1989

Union Texas Petroleum Corporation  
P.O. Box 2120  
Houston, TX 77252-2120

Attention: Ken E. White

Administrative Order NSL-2688

Dear Mr. White:

Reference is made to your application of July 24, 1989 for a non-standard coal gas well location for your existing Angel Peak "8" Well No. 31 located 990 feet from the North line and 1650 feet from the West line (Unit C) of Section 25, Township 28 North, Range 11 West, NMPM, Basin Fruitland Coal (Gas) Pool, San Juan County, New Mexico. The W/2 of said Section 25 shall be dedicated to the well forming a standard 320-acre gas spacing and proration unit for said pool.

By the authority granted me under the provisions of Rule 8 of the Special Rules and Regulations for the Basin-Fruitland Coal (Gas) Pool as promulgated by Division Order No. R-8768, the above-described unorthodox coal gas well location is hereby approved.

Sincerely,

A handwritten signature in dark ink, appearing to read "William J. LeMay".

William J. LeMay  
Director

WJL/MES/ag

cc: Oil Conservation Division - Aztec  
New Mexico Oil & Gas Engineering Committee - Hobbs  
US Bureau of Land Management - Farmington

UNITED STATES  
DEPARTMENT OF THE INTERIOR  
BUREAU OF LAND MANAGEMENT

RECEIVED  
SLM

Sundry Notices and Reports on Wells

91 JUN 17 21 2:25

1. Type of Well  
GAS

5. Lease Number

6. If Indian, All or  
Tribe Name

2. Name of Operator  
Meridian Oil Inc.

7. Unit Agreement Name

3. Address & Phone No. of Operator  
Box 4289, Farmington, NM 87499 (505) 326-9700

8. Well Name & Number

Angel Peak B #31

9. API Well No.

4. Location of Well, Footage, Sec, T, R, M.  
990' N, 1650' W Sec. 25, T-28-N, R-11-W, NMPM

10. Field and Pool

Basin Fruitland Coal

11. County and State

San Juan County, NM

12. CHECK APPROPRIATE BOX TO INDICATE NATURE OF NOTICE, REPORT, OTHER DATA  
Type of Submission

☐ Notice of Intent

☒ Subsequent Report

☐ Final Abandonment

Type of Action

☐ Abandonment

☐ Recompletion

☐ Plugging Back

☐ Casing Repair

☐ Altering Casing

☐ Other

☐ Change of Plans

☐ New Construction

☐ Non-Routine Fracturing

☐ Water Shut Off

☐ Conversion to Injection

13. Describe Proposed or Completed Operations

08-14-89 MOL&RU. TOO H w/2 3/8" tbg. Set cmt retainer @ 5355' and squeeze w/75 sx cmt. Stung out of retainer & dumped 2 bbl. cmt on top ret. Ran logs and perf'd lower coal 1769-80' w/4 spf, frac'd w/96,600# sand in 30# x-link gel. Set BP @ 1740'. Perf'd 2 squeeze holes @ 1604'.

08-16-89 TOO H w/tbg & suspended operations. Meridian is trying to obtain a non-standard location permit and will resume operations.

NOTE: the above work was done by Union Texas Petroleum

14. I hereby certify that the foregoing is true and correct

Signed Deppa Bradfield (u) Title Regulatory Affairs Date 6-17-91

(This space for Federal or State office use)

ACCEPTED FOR RECORD

APPROVED BY \_\_\_\_\_ TITLE \_\_\_\_\_ DATE 1991

CONDITION OF APPROVAL, IF ANY:

FARMINGTON RESOURCE AREA

BY \_\_\_\_\_

OPERATOR



UNITED STATES  
DEPARTMENT OF THE INTERIOR  
BUREAU OF LAND MANAGEMENT

SUBMIT IN TRI  
(Other, instruct  
verse side)

NOTE

Form approved.  
Budget Bureau No. 1004-0135  
Expires August 31, 1985

5. LEASE DESIGNATION AND SERIAL NO.  
See Attached Exhibit "A"

6. IF INDIAN, ALLOTTEE OR TRIBE NAME  
See Attached Exhibit "A"

7. UNIT AGREEMENT NAME  
See Attached Exhibit "A"

8. FARM OR LEASE NAME  
See Attached Exhibit "A"

9. WELL NO.  
See Attached Exhibit "A"

10. FIELD AND POOL, OR WILDCAT  
See Attached Exhibit "A"

11. SEC., T., R., M., OR BLK. AND  
SURVEY OR AREA  
See Attached Exhibit "A"

12. COUNTY OR PARISH | 13. STATE  
See Attached Exhibit "A"

SUNDRY NOTICES AND REPORTS ON WELLS  
(Do not use this form for proposals to drill or to deepen or plug back to a different reservoir.  
Use "APPLICATION FOR PERMIT—" for such proposals.)

1. OIL WELL ☐ GAS WELL ☒ OTHER Angel Peak B #31

2. NAME OF OPERATOR  
Union Texas Petroleum Corporation

3. ADDRESS OF OPERATOR  
1330 Post Oak Blvd., P.O. Box 2120, Houston, TX 77252-2120

4. LOCATION OF WELL (Report location clearly and in accordance with any State requirements.\*  
See also space 17 below.)  
At surface

See Attached Exhibit "A"

14. PERMIT NO.

15. ELEVATIONS (Show whether OF, RT, GA, etc.)

16. Check Appropriate Box To Indicate Nature of Notice, Report, or Other Data

NOTICE OF INTENTION TO:

TEST WATER SHUT-OFF <input type="checkbox"/>	PULL OR ALTER CASING <input type="checkbox"/>
FRACTURE TREAT <input type="checkbox"/>	MULTIPLE COMPLETE <input type="checkbox"/>
SHOOT OR ACIDIZE <input type="checkbox"/>	ABANDON* <input type="checkbox"/>
REPAIR WELL <input type="checkbox"/>	CHANGE PLANS <input type="checkbox"/>
(Other) <u>Change of Operator</u>	<u>XX</u>

SUBSEQUENT REPORT OF:

WATER SHUT-OFF <input type="checkbox"/>	REPAIRING WELL <input type="checkbox"/>
FRACTURE TREATMENT <input type="checkbox"/>	ALTERING CASING <input type="checkbox"/>
SHOOTING OR ACIDIZING <input type="checkbox"/>	ABANDONMENT* <input type="checkbox"/>
(Other) <u>                    </u>	

(NOTE: Report results of multiple completion on Well Completion or Recompletion Report and Log form.)

17. DESCRIBE PROMISED OR COMPLETED OPERATIONS (Clearly state all pertinent details, and give pertinent dates, including estimated date of starting any proposed work. If well is directionally drilled, give subsurface locations and measured and true vertical depths for all markers and zones pertinent to this work.)\*

Effective January 1, 1990, we request that the operator of the wells set forth on the attached Exhibit "A" be changed to:

**Meridian Oil Inc., as agent for**  
MERIDIAN OIL PRODUCTION INC.  
3535 East 30th Street  
Farmington, NM 87401

ACCEPTED FOR RECORD

FEB 1 1991

RECEIVED  
G. L. Scholz

18. I hereby certify that the foregoing is true and correct

SIGNED

L. C. Scholz

TITLE

L. C. Scholz

Director, U.S. Land Operations

DATE

JUN 21 1990

(This space for Federal or State office use)

APPROVED BY

TITLE

DATE

CONDITIONS OF APPROVAL, IF ANY:

\*See Instructions on Reverse Side

# MERIDIAN OIL

October 10, 1990

Federal Express

Mr. William LeMay  
New Mexico Oil Conservation Division  
310 Old Santa Fe Trail  
Santa Fe, New Mexico 87503

RE: Angel Peak B #31  
990'FNL, 1650'FWL  
Section 25, T-28-N, R-11-W  
San Juan County, New Mexico

Dear Mr. LeMay:

This is a request for administrative approval for a non-standard gas well location in the Basin Fruitland Pool.

Meridian Oil intends to plugback and recomplete the Angel Peak B #31 well from the Wildcat Gallup pool to the Basin Fruitland Coal Pool. The current location of this well is 990'FNL, 1650'FWL, Section 25, T-28-N, R-11-W, San Juan County, New Mexico. The well is considered non-standard due to the NE-SW dedicated pattern established for the Basin Fruitland Coal Pool. To comply with the New Mexico Oil Conservation Division rules, Meridian is submitting the following for your approval of this non-standard location:

1. C-102 plat showing location of the well;
2. Plat showing offset owners/operators;
3. Affidavit of notification of offset owners/operators;
4. Copy of Well Completion Log for original completion.

A copy of this application is being submitted to all offset owners/operators by certified mail with a request that they furnish your Santa Fe office with a Waiver of Objection, and return one copy to this office.

Sincerely yours,

  
Peggy Bradfield  
encl.

## WAIVER

BHP Petroleum (Americas) Inc. hereby waives objection to Meridian Oil Inc.'s application for a non-standard location for their Angel Peak B #31 as proposed above.

By:  Date: 11-7-90  
Reservoir Engineering Manager

xc: Amoco Production Company  
BHP Petroleum  
Marathon Oil Co.  
General Minerals Corp.

Angel Peak B #31  
990'FNL, 1650'FWL  
Section 25, T-28-N, R-11-W  
San Juan County, New Mexico

I hereby certify that the following offset owners/operators have been notified by certified mail of our application for administrative approval for non-standard gas well location for the plugback and recompletion of the above well.

Amoco Production Co.  
P.O. Box 800  
Denver, CO 80201

BHP Petroleum  
1650 Broadway, Suite 1900  
Denver, CO 80202

Marathon Oil Co.  
P.O. Box 88322  
Dallas, TX 75388

General Minerals Corp.  
P.O. Box 1289  
Noble, OK 73068



Peggy Bradfield  
October 10, 1990

San Juan County  
State of New Mexico

My commission expires August 17, 1992

MERIDIAN OIL INC

Well Name Angel Peak B #31

Footage 990' FNL; 1650' FWL

APPLICATION FOR NON-STANDARD LOCATION

County San Juan State New Mexico Section 25 Township 28 N Range 11 W

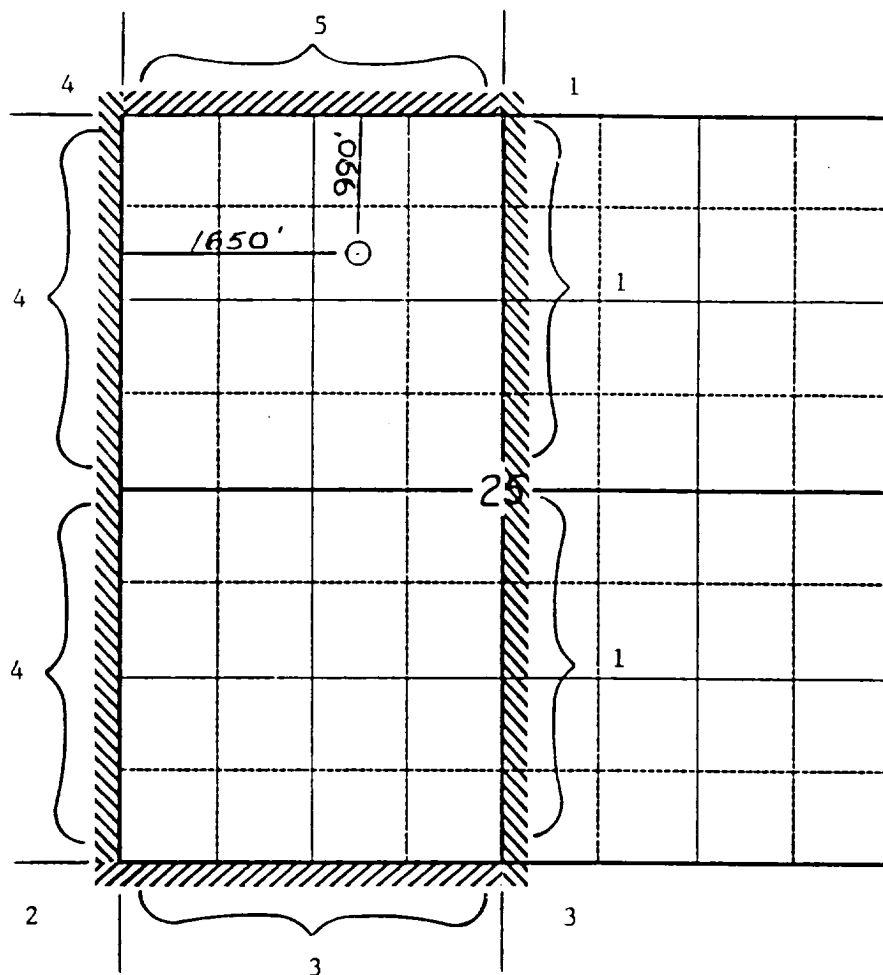

Remarks 1) Meridian Oil Inc.

2) Amoco Production Co.

3) BHP Petroleum- 1650 Broadway, Suite 1900, Denver, CO 80202

4) Marathon Oil Co.-P.O. Box 88322, Dallas, TX 75388

5) General Minerals Corp.-P.O. Box 1289, Noble, OK 73068

STATE OF NEW MEXICO  
ENERGY, MINERALS AND NATURAL RESOURCES DEPARTMENT  
OIL CONSERVATION DIVISION

GARREY CARRUTHERS  
GOVERNOR

November 8, 1990

POST OFFICE BOX 2088  
STATE LAND OFFICE BUILDING  
SANTA FE, NEW MEXICO 87504  
(505) 827-5800

Meridian Oil, Inc.  
P.O. Box 4289  
Farmington, NM 87499-4289

Attention: Peggy Bradfield

*RE: Unorthodox coal gas well location, Union Texas Petroleum Corporation's Angel Peak "B" Well No. 31, 990' FNL - 1650' FWL (Unit C); 25-T28N-R11W, NMPM, Basin-Fruitland Coal Gas Pool, San Juan County, New Mexico.*

Dear Ms. Bradfield:

By Division Administrative Order NSL-2688, dated August 17, 1990, Union Texas Petroleum Corporation was granted an exception to the well location requirements in the Basin-Fruitland Coal Gas Pool for the subject well. Meridian, evidently, has overlooked this since your application is requesting the identical exception, resulting in the need for additional supporting information. At this time said Order NSL-2688 is hereby stayed pending additional information to clarify the following:

- (1) Meridian's involvement in this well;
- (2) Why this well was chosen over any existing wells in the SW/4 of this Section; and,
- (3) How will this off-pattern recompletion effect coal gas development in the surrounding Section.

Our records still show Union Texas Petroleum Corporation as operator of the subject well, what is Meridian's involvement? Has there been a C-104 (Change of Operator) filed for this well?

Please provide me a detailed plat showing all wells in the W/2 of this Section. For each well please show its status, well name, and number, operator, footage location, spud date, current completed interval and discuss why this well has been chosen over the wells in the SW/4 of the Section.

*Meridian Oil, Inc.*  
*Attention: Peggy Bradfield*  
*November 8, 1990*  
*Page 2*

Further, please submit any supporting production data, engineering evaluation and related technical data to support your choice of wells for recompletion. Also submit a plat of the offsetting sections showing the coal completions presently planned or currently producing and provide a discussion addressing the proposed off-pattern development.

Should you have any questions, please contact me.

Sincerely,

A handwritten signature in black ink, appearing to read "Michael E. Stogner", written in a cursive style.

Michael E. Stogner  
Chief Hearing Officer/Engineer

cc: Oil Conservation Division - Aztec  
US Bureau of Land Management - Farmington

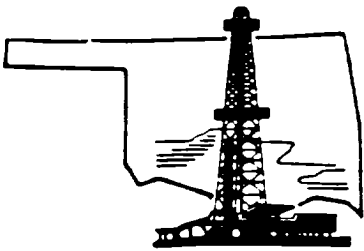

# GENERAL MINERAL CORPORATION

OIL CONSERVATION DIVISION

RECEIVED  
'90 NOV 13 AM 9 04 Suite 203 • 130 South Main • Noble, Oklahoma 73068  
405-872-9281

November 9, 1990

William LeMay  
New Mexico Oil Conservation Division  
310 Old Santa Fe Trail  
Santa Fe, NM 87503

RE: Angel Peak B #44  
485' FNL, 2310' FWL  
Section 24-28N-11W  
Operator-Meridian Oil  
San Juan Co. NM

Angel Peak B #38  
NW/4 SW/4 (S/2)  
Section 24-28N-11W  
San Juan Co. NM  
Operator-Meridian Oil

Angel Peak B #31  
990' FNL, 1650' FWL  
Section 25-28N-11W  
Operator-Meridian Oil  
San Juan Co. NM

Gallegos Canyon Unit #390  
245' FSL and 1530' FWL  
Section 23-29N-13W  
San Juan Co. NM  
Operator-BHP Petroleum  
(Americas) Inc.

Dear Mr. LeMay:

Various companies have filed requests with your office for administrative approval of non-standard gas well locations in the San Juan Basin Fruitland Coal Gas Pool. We believe that all of these locations are selected to encroach upon our coal and gas resources under the disguise of non-standard locations. We are opposed to drilling any well at the proposed locations without compensation to our company for taking of our gas.

We also noticed that each of the operators has clearly avoided furnishing the logs to us which will establish the drainage on our resources of coal and gas and therefore, we sincerely request that the proposed locations not be approved.

Please register our objection to approving any of the locations listed above.

Thank you.

Sincerely,

Kris Agrawal  
cc Meridian Oil Co.  
BHP Petroleum (Americas) Inc.  
Chaparral Resources



STATE OF NEW MEXICO  
ENERGY, MINERALS AND NATURAL RESOURCES DEPARTMENT  
OIL CONSERVATION DIVISION

xc: KOB  
REF

GARREY CARRUTHERS  
GOVERNOR

November 14, 1990

POST OFFICE BOX 2088  
STATE LAND OFFICE BUILDING  
SANTA FE, NEW MEXICO 87504  
(505) 827-5800

**MERIDIAN OIL**

NOV 14 1990

FARMINGTON, NEW MEXICO  
REGULATORY

*Meridian Oil Inc.  
P.O. Box 4289  
Farmington, NM 87499-4289*

*Attention: Peggy Braulfield*

*Re: Application for two unorthodox  
coal gas well locations:*

- 1) Union Texas Petroleum Corp.  
Angel Peak "B" Well No. 31  
990' FWL - 1650' FWL (Unit C)  
25-T28N-R4W*
- 2) Angel Peak "B" Well No. 44  
485' FWL - 2310' FWL (Unit C)  
24-T28N-R11W*

*Both in San Juan County, New  
Mexico.*

*Dear Ms. Braulfield:*

*The Division has received an objection from General  
Minerals Corporation by letter dated November 9, 1990 (see copy  
attached) to both of the subject applications. This matter will  
therefore be set for hearing before a Division Examiner on the  
next available docket, which is scheduled for December 19, 1990.*



Please provide adequate notice for such applications  
prior to the hearing as required by Division General Rule 1207.

If you should have any questions, please contact me.

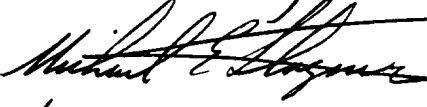
Sincerely  
  
Chief Hearing Officer/Engineer

c.c. - Oil Conservation Division - Austin  
U.S. Bureau of Land Management - Farmington  
W. Thomas Sullivan - Santa Fe  
General Minerals Corporation - Noble, Oklahoma

STATE OF NEW MEXICO  
ENERGY, MINERALS AND NATURAL RESOURCES DEPARTMENT  
OIL CONSERVATION DIVISION

IN THE MATTER OF THE HEARING  
CALLED BY THE OIL CONSERVATION  
DIVISION FOR THE PURPOSE OF  
CONSIDERING:

CASE NO. 10183  
ORDER NO. R-9436

APPLICATION OF MERIDIAN OIL, INC.  
FOR AN UNORTHODOX COAL GAS WELL LOCATION,  
SAN JUAN COUNTY, NEW MEXICO

ORDER OF THE DIVISION

BY THE DIVISION:

This cause came on for hearing at 8:15 a.m. on February 7, 1991, at Santa Fe, New Mexico, before Examiner Michael E. Stogner.

NOW, on this 11th day of February, 1991, the Division Director, having considered the record and the recommendations of the Examiner, and being fully advised in the premises,

FINDS THAT:

The applicant's request for dismissal should be granted.

IT IS THEREFORE ORDERED THAT:

Case No. 10183 is hereby dismissed.

DONE at Santa Fe, New Mexico, on the day and year hereinabove designated.

STATE OF NEW MEXICO  
OIL CONSERVATION DIVISION

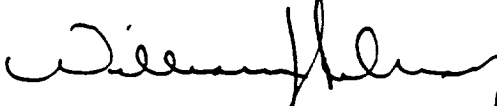
  
WILLIAM J. LEMAY  
Director

S E A L



STATE OF NEW MEXICO

ENERGY, MINERALS AND NATURAL RESOURCES DEPARTMENT

OIL CONSERVATION DIVISION

**MERIDIAN OIL**

FEB 14 1991

BRUCE KING  
GOVERNOR

FARMINGTON, NEW MEXICO  
REGULATORY

February 12, 1991

POST OFFICE BOX 2088  
STATE LAND OFFICE BUILDING  
SANTA FE, NEW MEXICO 87504  
(505) 827-5800

Meridian Oil, Inc.  
c/o Kellahin, Kellahin & Aubrey  
P.O. Box 2265  
Santa Fe, NM 87504-2265

Attention: W. Thomas Kellahin

*RE: Division Case No. 10183: Application of Meridian Oil, Inc. for an unorthodox coal gas well location, Union Texas Petroleum Corporation's Angel Peak "B" Well No. 31, 990' FNL - 1650' FWL (Unit C); 25-T28N-R11W, NMPM, Basin-Fruitland Coal Gas Pool.*

Dear Mr. Kellahin:

By Division Order No. R-9436 the subject application was dismissed. Please refer to my letter to Meridian Oil, Inc. dated November 8, 1990 which stayed said administrative order pending clarification of several issues. On November 13, 1990 an objection to this matter was received from General Minerals Corporation which resulted in the need of placing the matter on the hearing docket.

There are still many issues to be resolved in this matter before this well may be recompleted in the Basin-Fruitland Coal Gas Pool, if such a plan still exists by either Meridian or Union Texas.

Therefore, Division Administrative Order NSL-2688, dated August 17, 1990 is hereby placed in abeyance until further notice.

Sincerely,

Michael E. Stogner  
Chief Hearing Officer/Engineer

MES/ag

cc: Oil Conservation Division - Aztec  
Union Texas Petroleum Corporation - Houston, TX  
Meridian Oil, Inc. - Farmington, NM  
Division Files: Case No. 10183  
NSL-2688

All distances must be from the outer boundaries of the Section

Operator <b>Meridian Oil Inc.</b>			Lease <b>ANGEL PEAK "B"</b>		Well No. <b>31</b>
Unit Letter <b>C</b>	Section <b>25</b>	Township <b>28 NORTH</b>	Range <b>11 WEST</b>	County <b>SAN JUAN</b>	
Actual Location Location of well: <b>990</b> feet from the <b>NORTH</b> line and <b>1650</b> feet from the <b>WEST</b> line					
Ground Level Elev. <b>5807</b>	Producing Formation <b>Fruitland Coal</b>		Pool <b>Basin</b>	Dedicated Acres <b>320</b>	

1. Outline the acreage dedicated to the subject well by colored pencil or hatchure marks on the plat below.
2. If more than one lease is dedicated to the well, outline each and identify the ownership thereof (both as to well interest and royalty).
3. If more than one lease of different ownership is dedicated to the well, have the interests of all owners been consolidated by communitization, unitization, force-pooling, etc?

☐ Yes ☐ No If answer is "yes," type of consolidation \_\_\_\_\_

If answer is "no," list the owners and tract descriptions which have actually been consolidated. (Use reverse side of this form if necessary.) \_\_\_\_\_

No allowable will be assigned to the well until all interests have been consolidated (by communitization, unitization, forced-pooling, or otherwise) or until a non-standard unit, eliminating such interests, has been approved by the Div

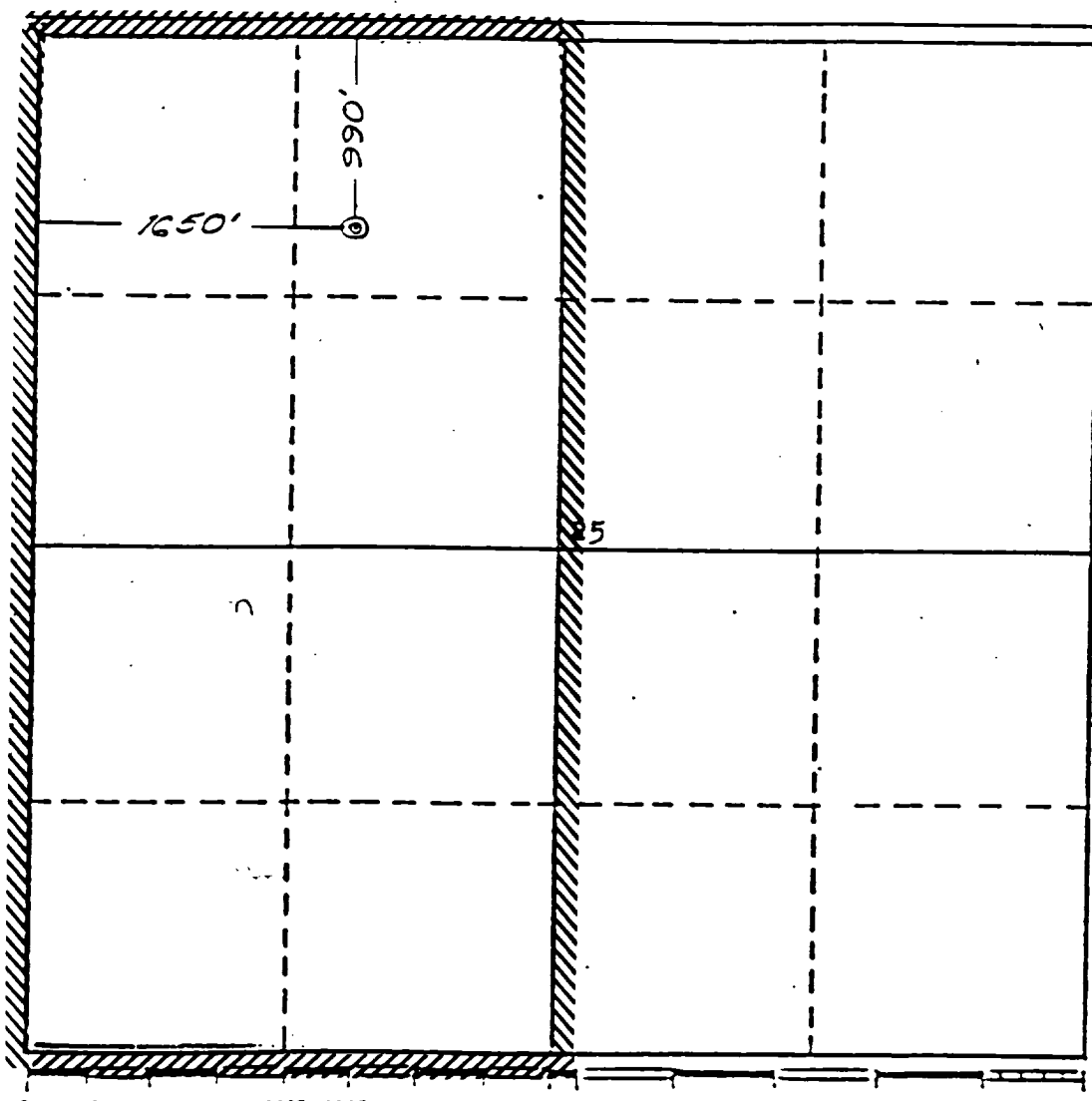

CERTIFICATION

I hereby certify that the information contained herein is true and complete to the best of my knowledge and belief.

Name  
**Peggy Bradfield**  
Position  
**Regulatory Affairs**  
Company  
**Meridian Oil Inc.**  
Date

I hereby certify that the well location shown on this plat was located from notes of actual survey made by \_\_\_\_\_ under my supervision, and that the same is true and correct to the best of my knowledge and belief.  
**JAMES P. LEASE**

Date Surveyed  
**February 21, 1980**

Registered Professional Engineer and Land Surveyor  
**James P. Lease**

Certificate No.  
**1463**

# MERIDIAN OIL INC

## ANGEL PEAK B #31

OFFSET OPERATOR \ OWNER PLAT

### Unorthodox Fruitland Coal Well Location

Township 28 North, Range 11 West

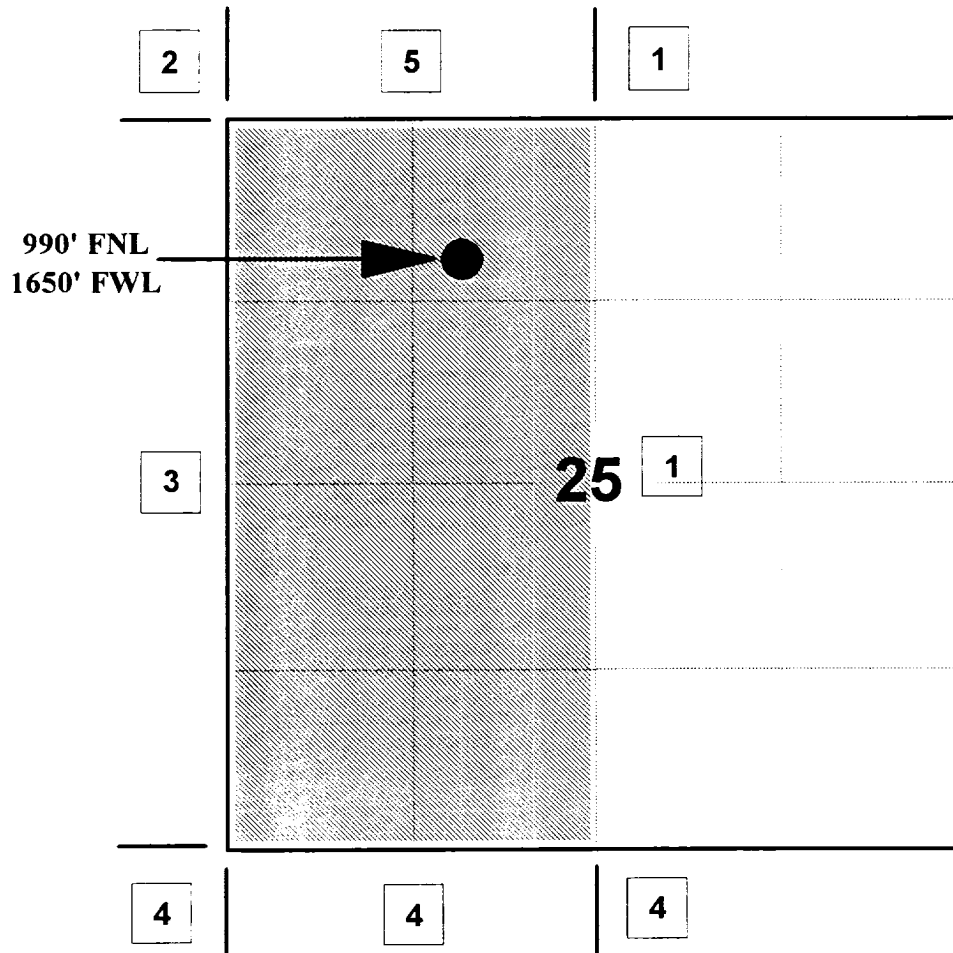

1) Meridian Oil Inc

2) Southland Royalty Company &

Marathon Oil Co.

PO Box 552, Midland, TX 79702

3) Marathon Oil Co.

4) BHP Petroleum

1360 Post Oak Blvd, Suite 500, Houston, TX 77056-3020

5) See Attached

5)	<b>James M. Collins</b>	<b>2001 Bryan Tower, Dallas, TX 75201</b>
	<b>Chaparral Oil &amp; Gas Company</b>	<b>PO Box B, Aztec, NM 87410</b>
	<b>Vanderslice Petroleum Corp.</b>	<b>14335 Regency Place, Dallas, TX 75240</b>
	<b>James U. Cantrell Estate c/o Rick Tully</b>	<b>PO 268, Farmington, NM 87499</b>
	<b>Joe C. Salmon</b>	<b>18929 White Wing Dr. #31484, Rio Verde, AZ 85263</b>
	<b>Bettye Jean Salmon</b>	<b>3604 Melrose Dr., Farmington, NM 87401</b>
	<b>General Minerals Corp. (Operator of Fruitland Sand well in the SW/4)</b>	<b>PO Box 1289, Noble, OK 73068</b>

April 12, 1994

Re: Angel Peak B #31  
990'FNL, 1650'FWL, Section 25, T-28-N, R-11-W, San Juan County, NM  
API #30-045-24458

I hereby certify that the following offset owners/operators have been notified by certified mail of our application for administrative approval for non-standard gas well location for the plugback and recompletion of the above well.

Marathon Oil Co.  
PO Box 552  
Midland, TX 79702

BHP Petroleum  
1360 Post Oak Boulevard, Suite 500  
Houston, TX 77056-3020

James M. Collins  
2001 Bryan Tower  
Dallas, TX 75201

Chapparral Oil & Gas Company  
PO Box "B"  
Aztec, NM 87410

Vanderslice Petroleum Corp.  
14335 Regency Place  
Dallas, TX 75240

James U. Cantrell Estate  
c/o Rick Tully  
PO Box 268  
Farmington, NM 87499

Joe C. Salmon  
18929 White Wing Drive #31484  
Rio Verde, AZ 85263

Bettye Jean Salmon  
3604 Melrose Drive  
Farmington, NM 87401

General Minerals Corp.  
PO Box 1289  
Noble, OK 73068

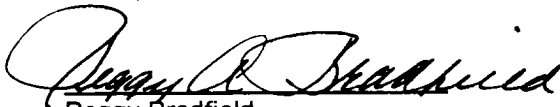

Peggy Bradfield  
Notary Public  
San Juan County, New Mexico  
My commission expires August 17, 1996

UNITED STATES  
DEPARTMENT OF THE INTERIOR  
GEOLOGICAL SURVEY

SUBMIT IN DUP.

(See instructions on  
reverse side)

MAR 16

Form approved.  
Budget Bureau No. 42-R355.5.

## WELL COMPLETION OR RECOMPLETION REPORT AND LOG \*

1a. TYPE OF WELL: OIL WELL <input checked="" type="checkbox"/> GAS WELL <input type="checkbox"/> DRY <input type="checkbox"/> Other _____		3. LEASE DESIGNATION AND SERIAL NO. SF 047017 B	
b. TYPE OF COMPLETION: NEW WELL <input checked="" type="checkbox"/> WORK OVER <input type="checkbox"/> DEEP-EN <input type="checkbox"/> PLUG BACK <input type="checkbox"/> DIFF. RESVR. <input type="checkbox"/> Other _____		6. IF INDIAN ALLOTTEE OR TRIBE NAME	
2. NAME OF OPERATOR Supron Energy Corporation		7. UNIT AGREEMENT NAME	
3. ADDRESS OF OPERATOR P. O. Box 808; Farmington, NM 87401		8. FARM OR LEASE NAME Angel Peak "B"	
4. LOCATION OF WELL (Report location clearly and in accordance with any State requirements) At surface 990 ft./N; 1650 ft/W line At top prod. interval reported below Same as above At total depth Same as above		9. WELL NO. 31	
14. PERMIT NO. U. S. GEOLOGICAL SURVEY FARMINGTON, N. M.		10. FIELD AND POOL, OR WILDCAT Wildcat Gallup	
15. DATE SPUDDED 12/27/80		11. SEC., T., R., M., OR BLOCK AND SURVEY OR AREA Sec. 25, T28N, R11W N.M.P.M.	
16. DATE T.D. REACHED 1/7/81		12. COUNTY OR PARISH San Juan	
17. DATE COMPL. (Ready to prod.) 3/1/82		13. STATE New Mexico	
18. ELEVATIONS (DF, REB, RT, GR, ETC.) 5820 R.K.B.		19. ELEV. CASINGHEAD 5807	
20. TOTAL DEPTH, MD & TVD 6538 MD & TVD		21. PLUG BACK T.D., MD & TVD 5914 MD & TVD	
22. IF MULTIPLE COMPL. HOW MANY* ----		23. INTERVALS DRILLED BY ROTARY TOOLS 0-6538	
24. PRODUCING INTERVAL(S), OF THIS COMPLETION—TOP, BOTTOM, NAME (MD AND TVD)* 5348-5870 Gallup (MD & TVD)		25. WAS DIRECTIONAL SURVEY MADE NO	
26. TYPE ELECTRIC AND OTHER LOGS RUN Induction Electric & Compensated Density		27. WAS WELL CORED NO	
28. CASING RECORD (Report all strings set in well)			
CASING SIZE	WEIGHT, LB./FT.	DEPTH SET (MD)	HOLE SIZE
8 5/8"	24.00	290	12 1/4"
4 1/2"	10.50	6538	7 7/8"
			CEMENTING RECORD
			275 sacks
			1175 sacks (3 stages)
			See Attached
			AMOUNT PULLED
29. LINER RECORD			
SIZE	TOP (MD)	BOTTOM (MD)	SACKS CEMENT*
			SCREEN (MD)
30. TUBING RECORD			
SIZE	DEPTH SET (MD)	PACKER SET (MD)	
2 3/8" EUE	5799 ft.		
31. PERFORATION RECORD (Interval, size and number)			
Lower: 1-0.40" hole at each of the following depths: 5580, 86,96,5604,21,34, 61,69,75,82, 5700,09,29,36,51,57, 89,94,5235,70. (Total of 20 holes). Upper: 1-0.40" hole at each of the following depths: 5348,52,68,72,78,84,96,			
32. ACID, SHOT, FRACTURE, CEMENT SQUEEZE, ETC.			
DEPTH INTERVAL (MD)		AMOUNT AND KIND OF MATERIAL USED	
5580-5870		1000 gal. 7 1/2% HCL, 85,000 gal foam & 95,000 lb. 20-40 sand.	
5348-5530 / 1000		gal. 7 1/2% HCL, 85,000 gal. 70-3 foam, & 95,000 lb. 20-40 sand.	
33.* (OVER) PRODUCTION			
DATE FIRST PRODUCTION 2/2/82		PRODUCTION METHOD (Flowing, gas lift, pumping—size and type of pump) Pumping (TESTING)	
DATE OF TEST 2/19/82		WELL STATUS (Producing or shut-in) Shut-In	
HOURS TESTED 24	CHOKE SIZE 1/2"	PROD'N. FOR TEST PERIOD →	OIL—BBL. 25
			GAS—MCF. 138
			WATER—BBL. 0
			GAS-OIL RATIO 5520
FLOW. TUBING PRESS. 100	CASING PRESSURE 250	CALCULATED 24-HOUR RATE →	OIL—BBL. 25
			GAS—MCF. 138
			WATER—BBL. 0
			OIL GRAVITY-API (CORR.) 40°
34. DISPOSITION OF GAS (Sold, used for fuel, vented, etc.) Vented			
35. LIST OF ATTACHMENTS			
36. I hereby certify that the foregoing and attached information is complete and correct as determined from my own inspection.			

SIGNED

Kenneth E. Roddy

TITLE Production Superintendent

DATE

March 8, 1982

\*(See Instructions and Spaces for Additional Data on Reverse Side)

FARMINGTON DISTRICT