

UNITED STATES
DEPARTMENT OF THE INTERIOR
GEOLOGICAL SURVEY

APPLICATION FOR PERMIT TO DRILL, DEEPEN, OR PLUG BACK

1a. TYPE OF WORK
 DRILL DEEPEN PLUG BACK

b. TYPE OF WELL
 OIL WELL GAS WELL OTHER
 SINGLE ZONE MULTIPLE ZONE

2. NAME OF OPERATOR
 Energy Reserven Group, Inc.

3. ADDRESS OF OPERATOR
 P. O. Box 3280, Casper, Wy 82602

4. LOCATION OF WELL (Report location clearly and in accordance with State requirements.)
 At surface

At proposed prod. zone
 1,150' ENL 1,660' FEL NW/NE

14. DISTANCE IN MILES AND DIRECTION FROM NEAREST TOWN OR POST OFFICE*
 Approximately 9.5 miles southeast of Farmington, New Mexico

15. DISTANCE FROM PROPOSED* LOCATION TO NEAREST PROPERTY OR LEASE LINE, FT. (Also to nearest drlg. unit line, if any)
 980'

18. DISTANCE FROM PROPOSED LOCATION* TO NEAREST WELL, DRILLING COMPLETED, OR APPLIED FOR, ON THIS LEASE, FT.
 100'

21. ELEVATIONS (Show whether DE, RT, GR, etc.)
 5,583' GR ungraded

RECEIVED
MAY 17 1985
BUREAU OF LAND MANAGEMENT
FARMINGTON RESOURCE AREA

5. LEASE DESIGNATION AND SERIAL NO.
SF - 078106

6. IF INDIAN, ALLOTTEE OR TRIBE NAME

7. UNIT AGREEMENT NAME
Gallegos Canyon Unit

8. FARM OR LEASE NAME

9. WELL NO.
361

10. FIELD AND POOL, OR WILDCAT
North Pinon Fruitland

11. SEC., T., R., M., OR BLK. AND SURVEY OR AREA
Section 15 T28N - R12W

12. COUNTY OR PARISH
San Juan

13. STATE
New Mexico

16. NO. OF ACRES IN LEASE
2,536.94

17. NO. OF ACRES ASSIGNED TO THIS WELL
160

19. PROPOSED DEPTH
1,280'

20. ROTARY OR CABLE TOOLS
Rotary

22. APPROX. DATE WORK WILL START*
As soon as approved

23. PROPOSED CASING AND CEMENTING PROGRAM

SIZE OF HOLE	SIZE OF CASING	WEIGHT PER FOOT	SETTING DEPTH	QUANTITY OF CEMENT
12 1/4"	8 5/8"	24#	130'	100 SX
6 1/4"	4 1/2"	10.5#	1,280'	175 SX

This action is subject to technical and procedural review pursuant to 43 CFR 3165.3 and appeal pursuant to 43 CFR 3165.4.

RECEIVED
JUL 12 1985
OIL CON. DIV.
OFF. 9

IN ABOVE SPACE DESCRIBE PROPOSED PROGRAM: If proposal is to deepen or plug back, give data on present productive zone and proposed new productive zone. If proposal is to drill or deepen directionally, give pertinent data on subsurface locations and measured and true vertical depths. Give blowout preventer program, if any.

24. SIGNED [Signature] TITLE Administrator, Field Svcs DATE 5/13/85
 (This space for Federal or State office use)

PERMIT NO. _____ APPROVAL DATE _____

APPROVED BY _____ TITLE _____

CONDITIONS OF APPROVAL, IF ANY:
 [Handwritten initials] NMOC

NEW MEXICO OIL CONSERVATION COMMISSION
WELL LOCATION AND ACREAGE DEDICATION PLAT

Form C-102
Supersedes C-128
Effective 1-1-65

All distances must be from the outer boundaries of the Section.

Operator ENERGY RESERVES GROUP		Lease GALLEOGS CANYON UNIT			Well No. 361
Unit Letter B	Section 15	Township 28N	Range 12W	County San Juan	
Actual Footage Location of Well: 1150 feet from the North line and 1660 feet from the East line					
Ground Level Elev. 5583	Producing Formation Fruitland	Pool North Pinion Fruitland		Dedicated Acreage 160 Acres	

1. Outline the acreage dedicated to the subject well by colored pencil or hachure marks on the plat below.
2. If more than one lease is dedicated to the well, outline each and identify the ownership thereof (both as to working interest and royalty).
3. If more than one lease of different ownership is dedicated to the well, have the interests of all owners been consolidated by communitization, unitization, force-pooling, etc?

Yes No If answer is "yes," type of consolidation _____

If answer is "no," list the owners and tract descriptions which have actually been consolidated. (Use reverse side of this form if necessary.) _____

No allowable will be assigned to the well until all interests have been consolidated (by communitization, unitization, forced-pooling, or otherwise) or until a non-standard unit, eliminating such interests, has been approved by the Commission.

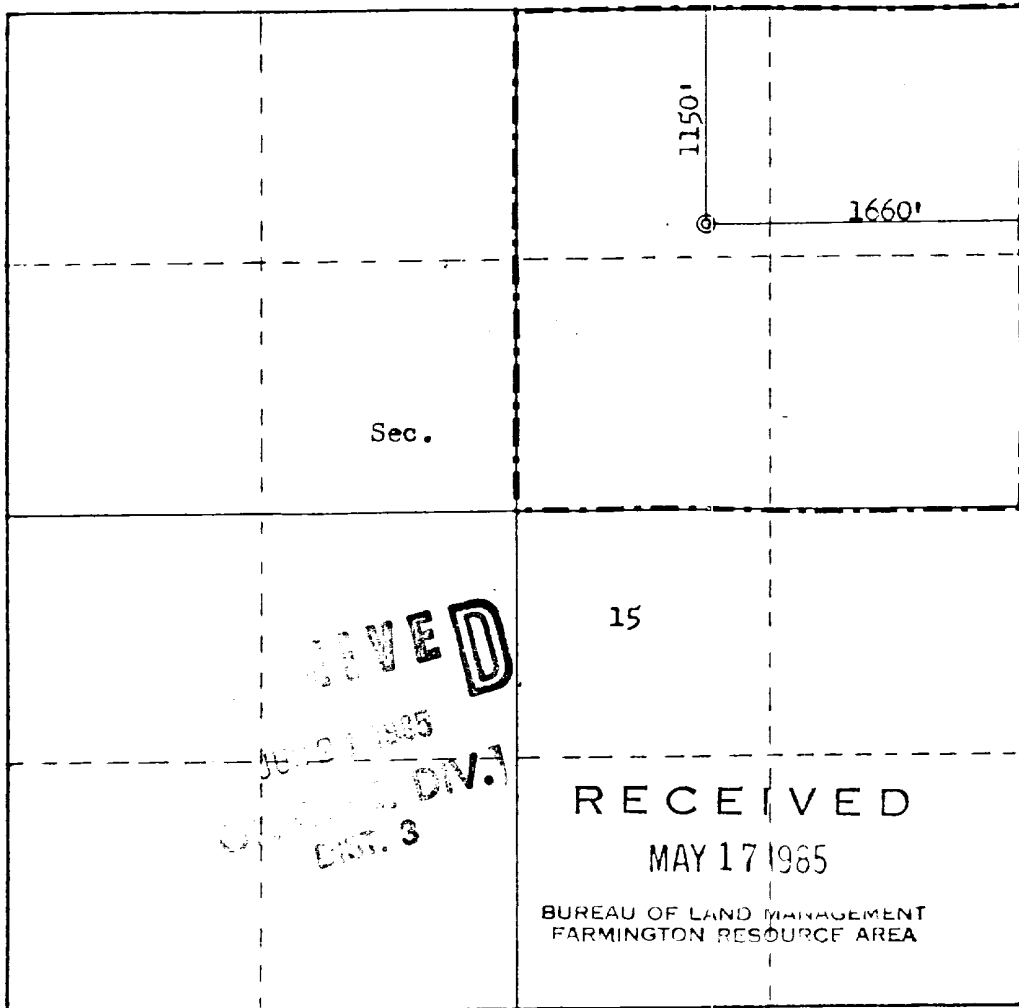

Scale: 1"=1000'

CERTIFICATION	
I hereby certify that the information contained herein is true and complete to the best of my knowledge and belief.	
<i>William J. Fiant</i>	
Name	William J. Fiant
Position	Administrator, Field Services
Company	Energy Reserves Group, Inc.
Date	5/13/85
I hereby certify that the well location shown on this plat was plotted from field notes of actual surveys made by me or under my supervision, and that the same is true and correct to the best of my knowledge and belief.	
Date Surveyed	May 7, 1985
Registered Professional Engineer and Land Surveyor	<i>Fred E. Kerr Jr.</i>
Certificate No.	3950

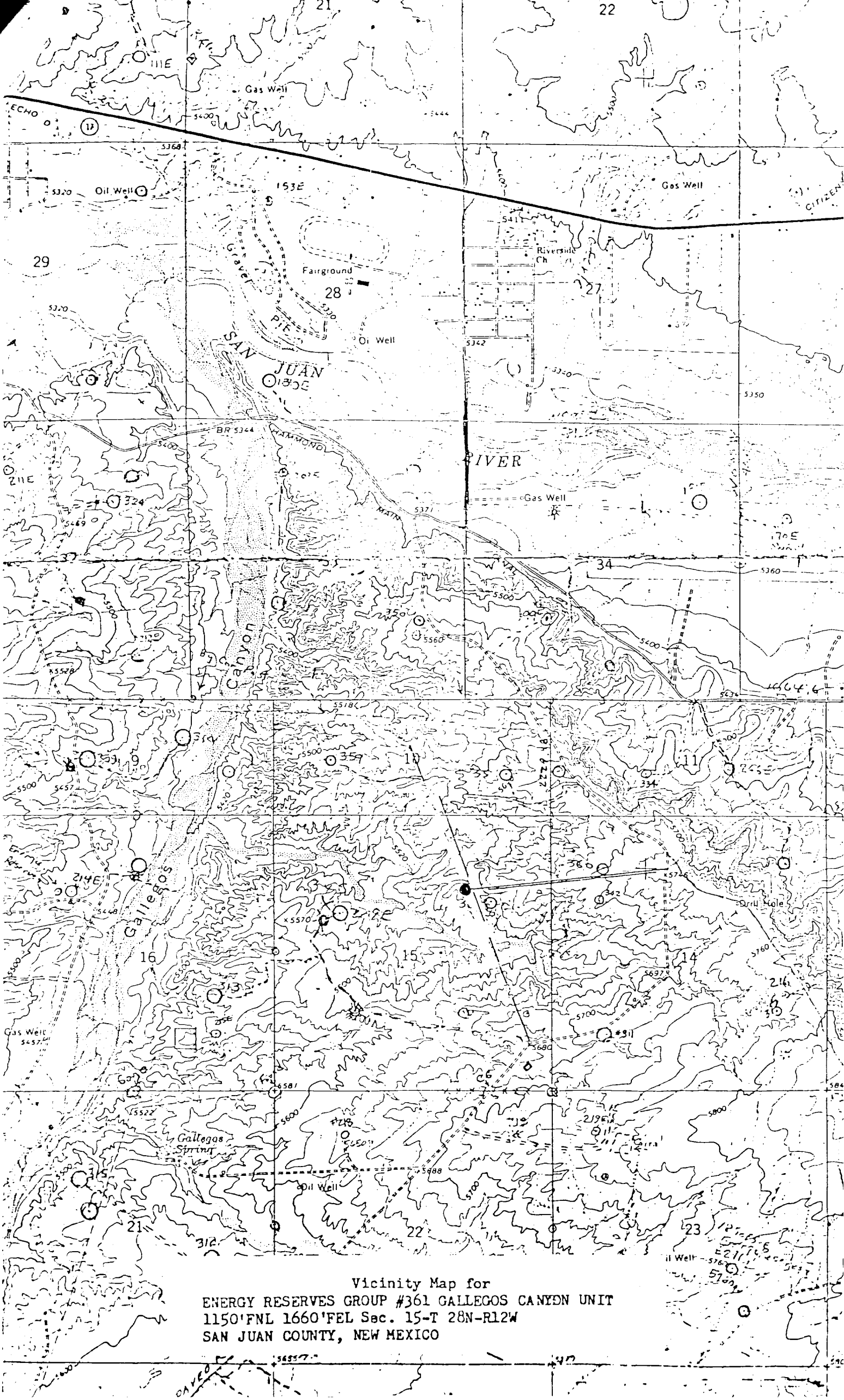

Vicinity Map for
 ENERGY RESERVES GROUP #361 GALLEGOS CANYON UNIT
 1150'FNL 1660'FEL Sec. 15-T 28N-R12W
 SAN JUAN COUNTY, NEW MEXICO