

NEW MEXICO OIL CONSERVATION COMMISSION
Well Location and Acreage Dedication Plat

RECEIVED

Date October 13, 1960

SECTION A.

Operator Aztec Oil and Gas Company Lease Robinson
Well No. 3-D Unit Letter P Section 15 Township 28N U. S. GEOLOGICAL SURVEY RANGE 13W NMPM
Located 810 Feet From South Line, 870 Feet From East Line
County San Juan G. L. Elevation 6078 Dedicated Acreage 320 Acres
Name of Producing Formation Dakota Pool Undesignated

1. Is the Operator the only owner* in the dedicated acreage outlined on the plat below? Yes XXX No
2. If the answer to question One is "No," have the interests of all the owners been consolidated by communitization agreement or otherwise? Yes No If answer is "Yes," Type of Consolidation
3. If the answer to question Two is "No," list all the owners and their respective interests below:

OWNER

LAND DESCRIPTION

SECTION B.

Corrected

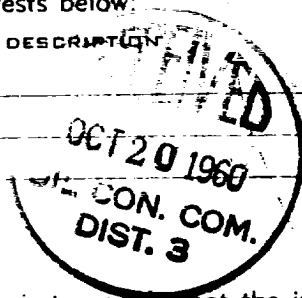
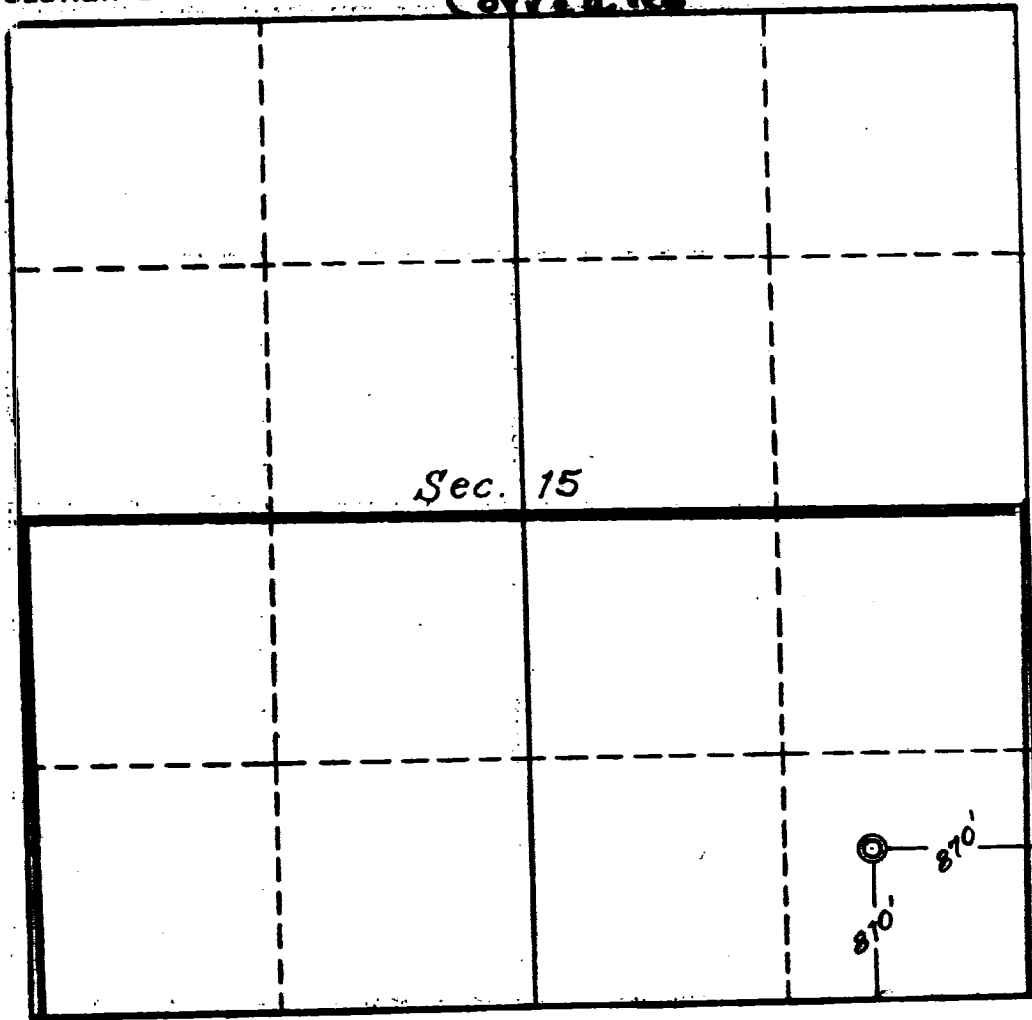

This is to certify that the information in Section A above is true and complete to the best of my knowledge and belief.

Aztec Oil and Gas Company
(OPERATOR)

ORIGINAL SIGNED BY JOE C. SALMON
(REPRESENTATIVE)

Drawer 570, Farmington, N.M.
(ADDRESS)

This is to certify that the well location shown on the plat in Section B was plotted from field notes of actual survey made by me or under my supervision and that the same is true and correct to the best of my knowledge and belief.

Date Surveyed Sept. 28, 1960
Four States Engineering Co.
FARMINGTON, NEW MEXICO

C. L. Poter
REGISTERED ENGINEER OR
LAND SURVEYOR

Certificate No. 3084