

U.S.G.S.  
Biville  
Region  
File4  
1  
1  
1

(SUBMIT IN TRIPLICATE)

Budget Bureau 42-R358.3.  
Approval expires 12-31-55.

Land Office

Santa Fe

Lease No.

000146

Unit

San Juan Unit 29-6

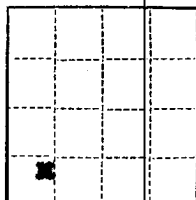
UNITED STATES  
DEPARTMENT OF THE INTERIOR  
GEOLOGICAL SURVEY

## SUNDRY NOTICES AND REPORTS ON WELLS

NOTICE OF INTENTION TO DRILL.....	<input checked="" type="checkbox"/>	SUBSEQUENT REPORT OF WATER SHUT-OFF.....	
NOTICE OF INTENTION TO CHANGE PLANS.....		SUBSEQUENT REPORT OF SHOOTING OR ACIDIZING.....	
NOTICE OF INTENTION TO TEST WATER SHUT-OFF.....		SUBSEQUENT REPORT OF ALTERING CASING.....	
NOTICE OF INTENTION TO RE-DRILL OR REPAIR WELL.....		SUBSEQUENT REPORT OF RE-DRILLING OR REPAIR.....	
NOTICE OF INTENTION TO SHOOT OR ACIDIZE.....		SUBSEQUENT REPORT OF ABANDONMENT.....	
NOTICE OF INTENTION TO PULL OR ALTER CASING.....		SUPPLEMENTARY WELL HISTORY.....	
NOTICE OF INTENTION TO ABANDON WELL.....			

(INDICATE ABOVE BY CHECK MARK NATURE OF REPORT, NOTICE, OR OTHER DATA)

November 6, 1953

Well No. 29-6 Mesa  
7-34 is located 990 ft. from [N] line and 990 ft. from [W] line of sec. \_\_\_\_\_

<u>SW 1/4 Sec 34</u> (1/4 Sec. and Sec. No.)	<u>29N</u> (Twp.)	<u>6W</u> (Range)	<u>N.M.P.M.</u> (Meridian)
<u>Wilcox</u> (Field)	<u>Rio Arriba County</u> (County or Subdivision)	<u>New Mexico</u> (State or Territory)	

The elevation of the ground ~~dominion~~ above sea level is 6423 ft.

## DETAILS OF WORK

(State names of and expected depths to objective sands; show sizes, weights, and lengths of proposed casings; indicate mudding jobs, cementing points, and all other important proposed work)

Propose to drill to approximately 5000' using mud. Set casing at top of pay. Mesa Verde will be drilled with gas and cleaned out with gas after shot. Heavy tools will be used to TD.

## Proposed Casing:

Set 9-5/8" casing at 150' cement with approximately 200 sac.  
Set 7" casing at top of pay cement with approximately 200 sac.

Location Plat attached.

I understand that this plan of work must receive approval in writing by the Geological Survey before operations may be commenced.

Company Phillips Petroleum CompanyAddress P. O. Box 939Astoria, New Mexico

By

*Earl E. Turm*Title District Superintendent

1. The first part of the document is a letter from the President of the United States to the Congress, dated January 3, 1862. It is a very long letter, and it contains a great deal of information about the state of the country at that time. The President talks about the war with Mexico, and about the situation in the South. He also talks about the economy, and about the need for more money. The letter is written in a very formal style, and it is full of references to the Constitution and to the laws of the country.

2. The second part of the document is a report from the Secretary of the Treasury, dated January 10, 1862. It is a very long report, and it contains a great deal of information about the state of the Treasury at that time. The Secretary talks about the amount of money that the Treasury has, and about the amount of money that it needs. He also talks about the different ways that the Treasury can get money, and about the different ways that it can spend money. The report is written in a very formal style, and it is full of references to the laws of the country.

3. The third part of the document is a report from the Secretary of the Interior, dated January 17, 1862. It is a very long report, and it contains a great deal of information about the state of the Interior at that time. The Secretary talks about the different parts of the Interior, and about the different things that are going on in each part. He also talks about the different ways that the Interior can be managed, and about the different ways that it can be improved. The report is written in a very formal style, and it is full of references to the laws of the country.

4. The fourth part of the document is a report from the Secretary of the War, dated January 24, 1862. It is a very long report, and it contains a great deal of information about the state of the War at that time. The Secretary talks about the different parts of the War, and about the different things that are going on in each part. He also talks about the different ways that the War can be managed, and about the different ways that it can be improved. The report is written in a very formal style, and it is full of references to the laws of the country.

5. The fifth part of the document is a report from the Secretary of the Navy, dated January 31, 1862. It is a very long report, and it contains a great deal of information about the state of the Navy at that time. The Secretary talks about the different parts of the Navy, and about the different things that are going on in each part. He also talks about the different ways that the Navy can be managed, and about the different ways that it can be improved. The report is written in a very formal style, and it is full of references to the laws of the country.

6. The sixth part of the document is a report from the Secretary of the Army, dated February 7, 1862. It is a very long report, and it contains a great deal of information about the state of the Army at that time. The Secretary talks about the different parts of the Army, and about the different things that are going on in each part. He also talks about the different ways that the Army can be managed, and about the different ways that it can be improved. The report is written in a very formal style, and it is full of references to the laws of the country.

7. The seventh part of the document is a report from the Secretary of the Post Office, dated February 14, 1862. It is a very long report, and it contains a great deal of information about the state of the Post Office at that time. The Secretary talks about the different parts of the Post Office, and about the different things that are going on in each part. He also talks about the different ways that the Post Office can be managed, and about the different ways that it can be improved. The report is written in a very formal style, and it is full of references to the laws of the country.

8. The eighth part of the document is a report from the Secretary of the Land Office, dated February 21, 1862. It is a very long report, and it contains a great deal of information about the state of the Land Office at that time. The Secretary talks about the different parts of the Land Office, and about the different things that are going on in each part. He also talks about the different ways that the Land Office can be managed, and about the different ways that it can be improved. The report is written in a very formal style, and it is full of references to the laws of the country.

9. The ninth part of the document is a report from the Secretary of the Indian Office, dated February 28, 1862. It is a very long report, and it contains a great deal of information about the state of the Indian Office at that time. The Secretary talks about the different parts of the Indian Office, and about the different things that are going on in each part. He also talks about the different ways that the Indian Office can be managed, and about the different ways that it can be improved. The report is written in a very formal style, and it is full of references to the laws of the country.

Company.....Phillips Petroleum Company.....

Lease..... Well No.....

Sec.....34....., T.....29 N......, R.....6 W......, N.M.P.M......

Location.....990' from the South line and 990' from the West line......

Elevation.....6423 Ungraded ground......

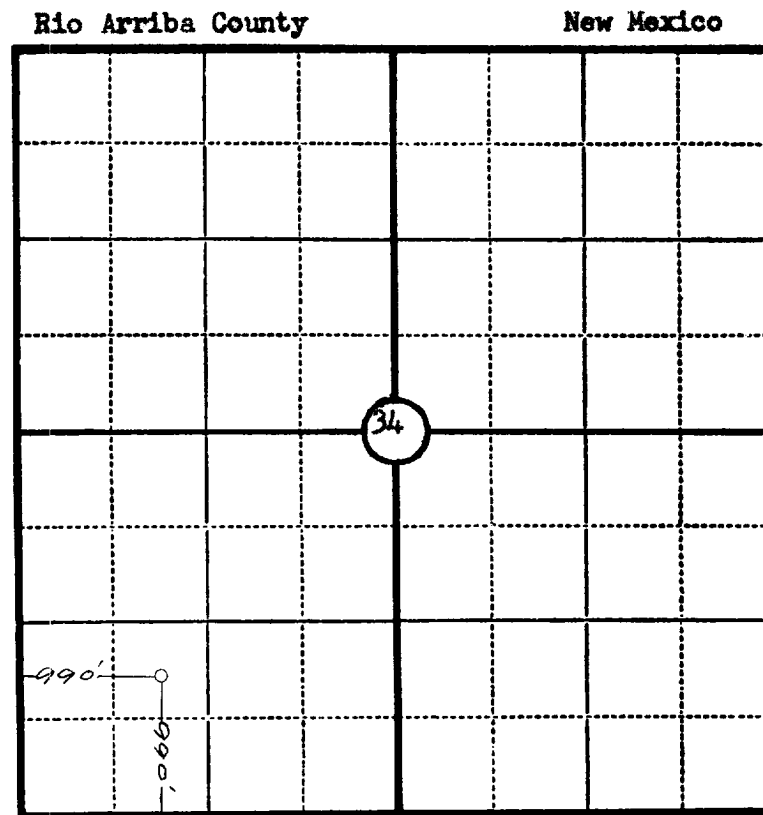

Scale—4 inches equal 1 mile.

This is to certify that the above plat was prepared from field notes of actual surveys made by me or under my supervision and that the same are true and correct to the best of my knowledge and belief.

Seal:

*Charles J. Finklea*  
Registered Professional  
Engineer and Land Surveyor.

Charles J. Finklea  
N. Mex. Reg. No. 1302

Surveyed ..... November 3 ....., 19... 53 .....