

(SUBMIT IN TRIPLICATE)

UNITED STATES
DEPARTMENT OF THE INTERIOR
GEOLOGICAL SURVEY

Land Office Alamosa, N.M.
Lease No. 77971
Unit San Juan 25-4 Unit
14-16-001-1055

SUNDRY NOTICES AND REPORTS ON WELLS

NOTICE OF INTENTION TO DRILL	<input checked="" type="checkbox"/>	SUBSEQUENT REPORT OF WATER SHUT-OFF	
NOTICE OF INTENTION TO CHANGE PLANS		SUBSEQUENT REPORT OF SHOOTING OR ACIDIZING	
NOTICE OF INTENTION TO TEST WATER SHUT-OFF		SUBSEQUENT REPORT OF ALTERING CASING	
NOTICE OF INTENTION TO RE-DRILL OR REPAIR WELL		SUBSEQUENT REPORT OF RE-DRILLING OR REPAIR	
NOTICE OF INTENTION TO SHOOT OR ACIDIZE		SUBSEQUENT REPORT OF ABANDONMENT	
NOTICE OF INTENTION TO PULL OR ALTER CASING		SUPPLEMENTARY WELL HISTORY	
NOTICE OF INTENTION TO ABANDON WELL			

(INDICATE ABOVE BY CHECK MARK NATURE OF REPORT, NOTICE, OR OTHER DATA)

June 13, 1950

Well No. 10-31 is located 1650 ft. from S line and 1700 ft. from E line of sec. 30
Section 30 29N 4E 107W
 (1/4 Sec. and Sec. No.) (Twp.) (Range) (Meridian)
New Mexico
 (Field) (County or Subdivision) (State or Territory)

The elevation of the derrick floor above sea level is 7124 ft.

DETAILS OF WORK

(State names of and expected depths to objective sands; show sizes, weights, and lengths of proposed casings; indicate mudding jobs, cementing points, and all other important proposed work)

It is intended to drill a well thru the Pictured Cliffs formation using rotary tools and to perforate and water fracture possible producing zones. Estimated total depth 4185'.

Casing Program:

9 5/8" at 120' with 125 sacks regular cement circulated to surface.
 5 1/2" at 4185' with 75 sacks regular cement, 75 sacks Pozmix.

The 3/4 of Section 30 is dedicated to this well.
 S.A. 82 77971.

I understand that this plan of work must receive approval in writing by the Geological Survey before operations may be commenced.

Company El Paso Natural Gas Company

Address Box 797
Hartington, New Mexico

By Schuel Schuler
 Title Petroleum Engineer

NEW MEXICO
OIL CONSERVATION COMMISSION

WELL LOCATION AND/OR GAS PRORATION PLAT

APRIL 24, 1956

EL PASO NATURAL GAS COMPANY SAN JUAN 29-4 UNIT SF 079761
10-36 36 29-N 4-W
1650 SOUTH 1700 WEST
RIO ARriba 7184
PICTURED CLIFF ~~By~~ ^{W.C.} ~~RECEIVED~~ 160
(1882 PLAT)

Note: All distances must be from outer boundaries of section.

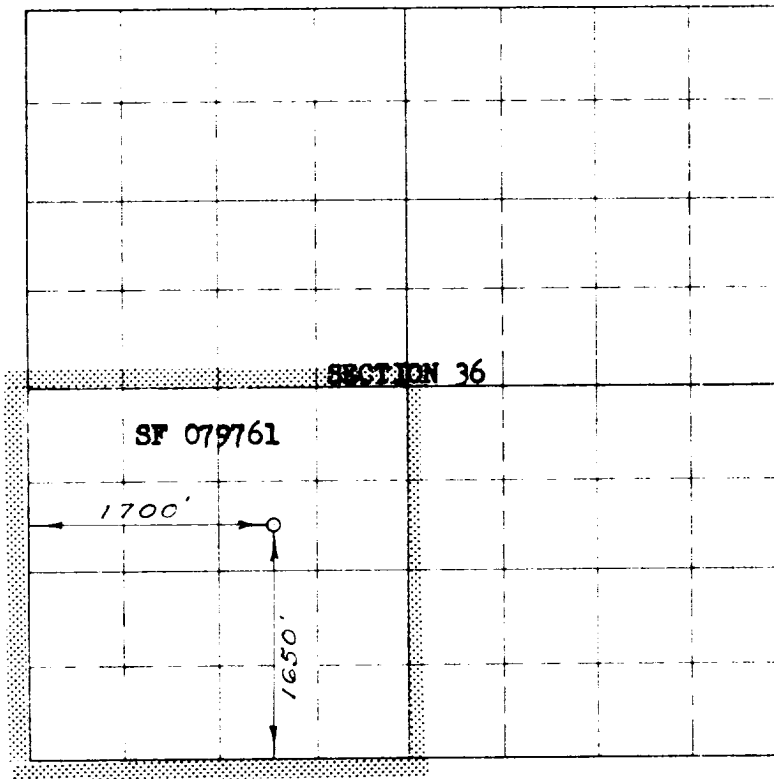

NOTE

This section of
form is to be used
for gas wells only

I hereby certify that the above plat was prepared from
field notes of actual surveys made by me or under my
supervision and that the same are true and correct to the
best of my knowledge and belief.

Date Surveyed APRIL 18, 1956

C. O. Walker
Registered Professional Engineer and Land Surveyor

1. Is this well a Dual Comp.
Yes _____ No ☒
2. If the answer to Question 1
is yes, are there any other dual
completed wells within the
dedicated acreage.

Yes _____ No _____
Name S. Schuler
Petroleum Engineer
Position _____

Representing El Paso Natural Gas Co.
Box 977, Farmington, N.M.
Address _____

(See d)

Farmington, New Mexico