

3-4, 1-6, 3-5,  
1-4, 1-5, Johnston  
1-File

(SUBMIT IN TRIPLICATE)

UNITED STATES  
DEPARTMENT OF THE INTERIOR  
GEOLOGICAL SURVEY

Land Office San Juan Co.  
Lease No. 87470-1  
200 June 29-1  
Unit 14-02-002-1075

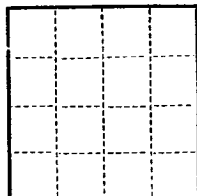

SUNDRY NOTICES AND REPORTS ON WELLS

NOTICE OF INTENTION TO DRILL.....	<input checked="" type="checkbox"/>	SUBSEQUENT REPORT OF WATER SHUT-OFF.....	
NOTICE OF INTENTION TO CHANGE PLANS.....		SUBSEQUENT REPORT OF SHOOTING OR ACIDIZING.....	
NOTICE OF INTENTION TO TEST WATER SHUT-OFF.....		SUBSEQUENT REPORT OF ALTERING CASING.....	
NOTICE OF INTENTION TO RE-DRILL OR REPAIR WELL.....		SUBSEQUENT REPORT OF RE-DRILLING OR REPAIR.....	
NOTICE OF INTENTION TO SHOOT OR ACIDIZE.....		SUBSEQUENT REPORT OF ABANDONMENT.....	
NOTICE OF INTENTION TO PULL OR ALTER CASING.....		SUPPLEMENTARY WELL HISTORY.....	
NOTICE OF INTENTION TO ABANDON WELL.....			

(INDICATE ABOVE BY CHECK MARK NATURE OF REPORT, NOTICE, OR OTHER DATA)

July 18, 1955

Well No. 2-24 is located 1010 ft. from S line and 805 ft. from E line of sec. 24

24 Sec. 24 (1/4 Sec. and Sec. No.) 29 N (Twp.) 4 W (Range) R.M.P.M. (Meridian)  
W.C. (Field) Eliz. Aurora (County or Subdivision) New Mexico (State or Territory)

The elevation of the Original Ground above sea level is 7225 ft.

DETAILS OF WORK

(State names of and expected depths to objective sands; show sizes, weights, and lengths of proposed casings; indicate mudlogging jobs, cementing points, and all other important proposed work)

Proposed: Drill to 175', set and cement 2-5/8" CB casing w/ 150 lb 45 gal cement. Drill to 307'. Set 2-1/2" CB casing and cement w/ 200 lb 45 gal cement. Following the setting of 2-1/2" CB casing, drill well to an approximate total depth of 4252'. Gas sands are expected @ 3937 - 4000 and 4100 - 4250 sand from both zones, upper and true Pictured Cliff, simultaneously down casing using 20,000 gals. w/ 1/2 sand per gal. Test, clean out, run tubing and complete.



I understand that this plan of work must receive approval in writing by the Geological Survey before operations may be commenced

Company Pacific Northwest Pipeline Corp.  
413 1/2 W. Main Street  
Address Farmington, New Mexico

By 2. A. Dugan  
Title Engineer

Company PACIFIC NORTHWEST PIPELINE CORPORATION

Lease..... Well No.....

Sec. 34, T. 29 N., R. 4 W, N.M.P.M.

Location 1010' FROM THE SOUTH LINE AND 855' FROM THE EAST LINE.

Elevation 7225.0 UNGRADED GROUND.

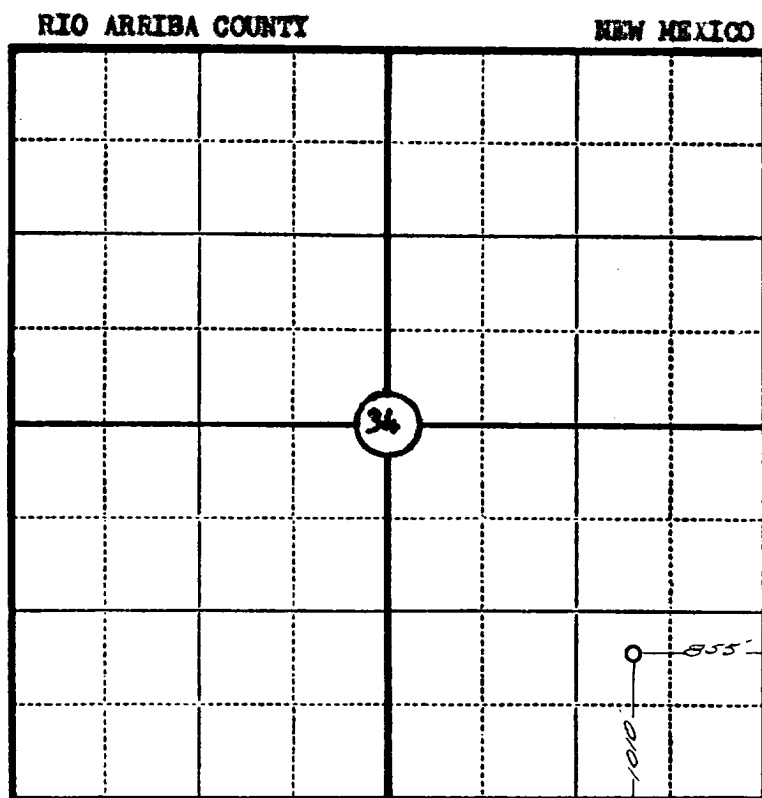

Scale—4 inches equal 1 mile.

This is to certify that the above plat was prepared from field notes of actual surveys made by me or under my supervision and that the same are true and correct to the best of my knowledge and belief.

Seal:

*James P. Leese*  
Registered                       
                     Land Surveyor.

JAMES P. LEESE  
N. MEX. REG. NO. 1463

Surveyed 23 JUNE, 19 55

