

3 - USGS

2 - BNSCC

1 - L. O. Truby

1 - File

(SUBMIT IN TRIPLICATE)

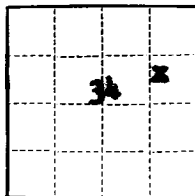
Budget Bureau No. 42-R358.4.
Approval expires 12-31-60.Land Office **Santa Fe**Lease No. **SF-079761-A**Unit **29-4**
14-06-001-1055

UNITED STATES
DEPARTMENT OF THE INTERIOR
GEOLOGICAL SURVEY

SUNDRY NOTICES AND REPORTS ON WELLS

NOTICE OF INTENTION TO DRILL.....	<input checked="" type="checkbox"/>	SUBSEQUENT REPORT OF WATER SHUT-OFF.....	
NOTICE OF INTENTION TO CHANGE PLANS.....		SUBSEQUENT REPORT OF SHOOTING OR ACIDIZING.....	
NOTICE OF INTENTION TO TEST WATER SHUT-OFF.....		SUBSEQUENT REPORT OF ALTERING CASING.....	
NOTICE OF INTENTION TO RE-DRILL OR REPAIR WELL.....		SUBSEQUENT REPORT OF RE-DRILLING OR REPAIR.....	
NOTICE OF INTENTION TO SHOOT OR ACIDIZE.....		SUBSEQUENT REPORT OF ABANDONMENT.....	
NOTICE OF INTENTION TO PULL OR ALTER CASING.....		SUPPLEMENTARY WELL HISTORY.....	
NOTICE OF INTENTION TO ABANDON WELL.....			

(INDICATE ABOVE BY CHECK MARK NATURE OF REPORT, NOTICE, OR OTHER DATA)

May 20, 1957

Well No. **8-34** is located **1850'** ft. from **[N]** line and **890'** ft. from **[E]** line of sec. **34****SE/4 NE/4 Sec. 34** **29 North** **4 West** **H.M.P.M.**
(1/4 Sec. and Sec. No.) (Twp.) (Range) (Meridian)**Blanco Mesa Verde** **Rio Arriba** **New Mexico**
(Field) (County or Subdivision) (State or Territory)The elevation of the ~~measured ground~~ ^{ungraded ground} above sea level is **7166'** ft.

DETAILS OF WORK

(State names of and expected depths to objective sands; show sizes, weights, and lengths of proposed casings; indicate mudding jobs, cementing points, and all other important proposed work)

Propose to drill to 200' and set 10-3/4" casing, cement to surface. Set 7-5/8" casing @ 4310', cement w/150 sz w/8% gal and 50 sz neat. Set 5-1/2" liner @ 6430', cement w/150 sz reg. Test Top of liner and if necessary brodenhead squeeze w/50 sz reg.

Mesa Verde to be fractured thru perforis using approx 150,000 gals water, clean out to total depth, run tubing and complete well.

The E/2 of Section 34, containing 320 acres, is dedicated to this well.

100% Pacific Northwest

I understand that this plan of work must receive approval in writing by the Geological Survey before operations may commence.

Company **PACIFIC NORTHWEST PIPELINE CORPORATION**

Address **405 1/2 West Broadway**

Farmington, New Mexico

By Original signed by T. A. Dugan

Title **Assistant Division Manager**

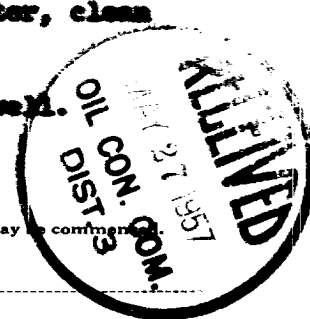

NEW MEXICO
OIL CONSERVATION COMMISSION

Form C-128

Well Location and/or Gas Proration Plat

Date May 20, 1957

Operator PACIFIC NORTHWEST PIPELINE CORPORATION Lease 29-4

Well No. 8-34 Section 34 Township 29 North Range 1 West NMPM

Located 1850' Feet From North Line, 890' Feet From East Line,

Rio Arriba County, New Mexico. G. L. Elevation 7166' ungraded ground

Name of Producing Formation Mesa Verde Pool Blanco Dedicated Acreage 320

(Note: All distances must be from outer boundaries of Section)

		PACIFIC NORTHWEST
		1850'
		890'
		SF-079761-A
		U.S. D.A.

NOTE

This section of form is to be used for gas wells only.



SCALE: 1"=1000'

1. Is this Well a Dual Comp. ? Yes ___ No X .
2. If the answer to Question 1 is yes, are there any other dually completed wells within the dedicated acreage ? Yes ___ No ___ .

Name Original signed by T. A. Dugan
Position Assistant Division Manager
Representing PACIFIC NORTHWEST PIPELINE CORP.
Address 405 1/2 W. Broadway, Farmington, N.M.

This is to certify that the above plat was prepared from field notes of actual surveys made by me or under my supervision and that the same are true and correct to the best of my knowledge and belief.

Date Surveyed _____
Registered Professional Engineer and/or Land Surveyor

Company.....PACIFIC NORTHWEST PIPELINE CORPORATION.

Lease.....~~27-4~~.....Well No. ~~8-24~~

Sec. 34....., T. 29 N., R. 4 W. N.M.P.M.

Location 1850' FROM THE NORTH LINE AND 890' FROM
THE EAST LINE.

Elevation 7166.00 UNGRADED GROUND.

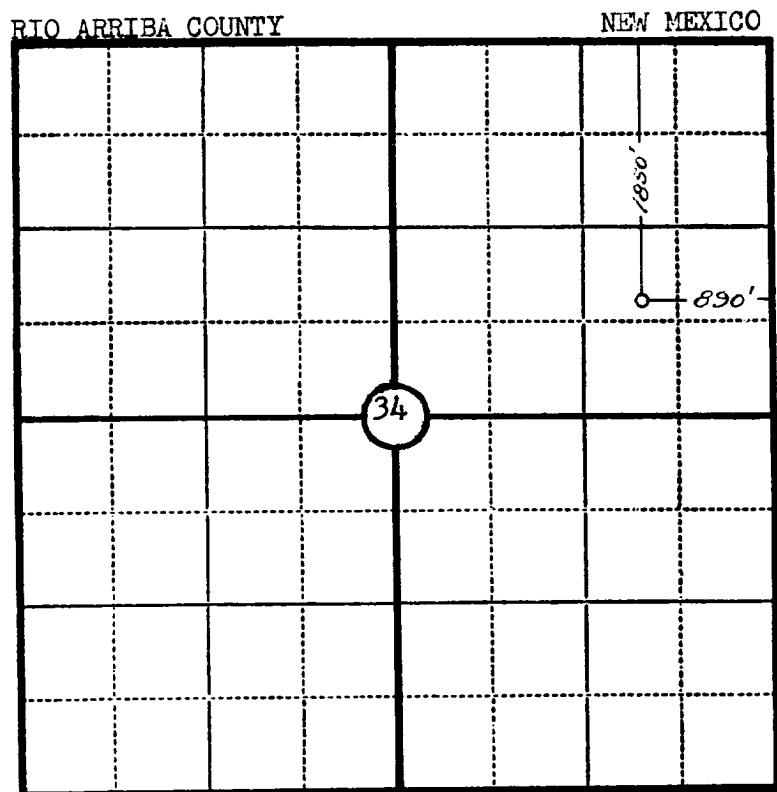

Scale—4 inches equal 1 mile.

This is to certify that the above plat was prepared from field notes of actual surveys made by me or under my supervision and that the same are true and correct to the best of my knowledge and belief.

Seal:

James P. Leese

Registered Land Surveyor.

James P. Leese

N. M. Reg. No. 1463.

Surveyed October 14, 19 55

SAN JUAN ENGINEERING COMPANY, FARMINGTON, N. M.