

U.S.G.S. - 1
Biville - 1
Region - 1
File - 1 (SUBMIT IN TRIPLICATE)

Budget Bureau 42-R358.3.
Approval expires 12-31-55.

New Mexico

Land Office

10011390

Lease No.

New Mex Unit 29-5

Unit

UNITED STATES
DEPARTMENT OF THE INTERIOR
GEOLOGICAL SURVEY

SUNDRY NOTICES AND REPORTS ON WELLS

NOTICE OF INTENTION TO DRILL	<input checked="" type="checkbox"/>	SUBSEQUENT REPORT OF WATER SHUT-OFF	
NOTICE OF INTENTION TO CHANGE PLANS		SUBSEQUENT REPORT OF SHOOTING OR ACIDIZING	
NOTICE OF INTENTION TO TEST WATER SHUT-OFF		SUBSEQUENT REPORT OF ALTERING CASING	
NOTICE OF INTENTION TO RE-DRILL OR REPAIR WELL		SUBSEQUENT REPORT OF RE-DRILLING OR REPAIR	
NOTICE OF INTENTION TO SHOOT OR ACIDIZE		SUBSEQUENT REPORT OF ABANDONMENT	
NOTICE OF INTENTION TO PULL OR ALTER CASING		SUPPLEMENTARY WELL HISTORY	
NOTICE OF INTENTION TO ABANDON WELL			

(INDICATE ABOVE BY CHECK MARK NATURE OF REPORT, NOTICE, OR OTHER DATA)

October 10, 1955

Well No. 29-5 Moon 5-33 is located 990 ft. from {N} line and 990 ft. from {E} line of sec.

NE/4 NE/4 Sec 33
(1/4 Sec. and Sec. No.)

29S
(Twp.)

9M
(Range)

N.M.P.M.
(Meridian)

Wildcat
(Field)

Rio Arriba County
(County or Subdivision)

New Mexico
(State or Territory)

The elevation of the ~~datum~~ ^{ground} above sea level is 6732 ft.

DETAILS OF WORK

(State names of and expected depths to objective sands; show sizes, weights, and lengths of proposed casings; indicate mudding jobs, cementing points, and all other important proposed work)

Propose to drill to approximately 5000' using mud. Set casing at top of pay. Moon Verde will be drilled with gas and cleaned out with gas after shot. Rotary tools will be used to TD.

Proposed Casing:

Set 9-5/8" casing at 150 cement with approximately 200 cwt

Set 7" casing at top of pay cement with approximately 200 cwt

Location Map attached.

I understand that this plan of work must receive approval in writing by the Geological Survey before operations may be commenced.

Company Phillips Petroleum Company

Address P. O. Box 999

Astoria, New Mexico

By Earl Stumm

Title District Superintendent

U.S.O.S. -4
Styl -1
Region -1
File -1

Company Phillips Petroleum Company

Lease Well No.

Sec. 33, T. 29 N., R. 5 W., N.M.P.M.

Location 990' from the North line and 990' from the East line.

Elevation 6732 Ungraded ground.

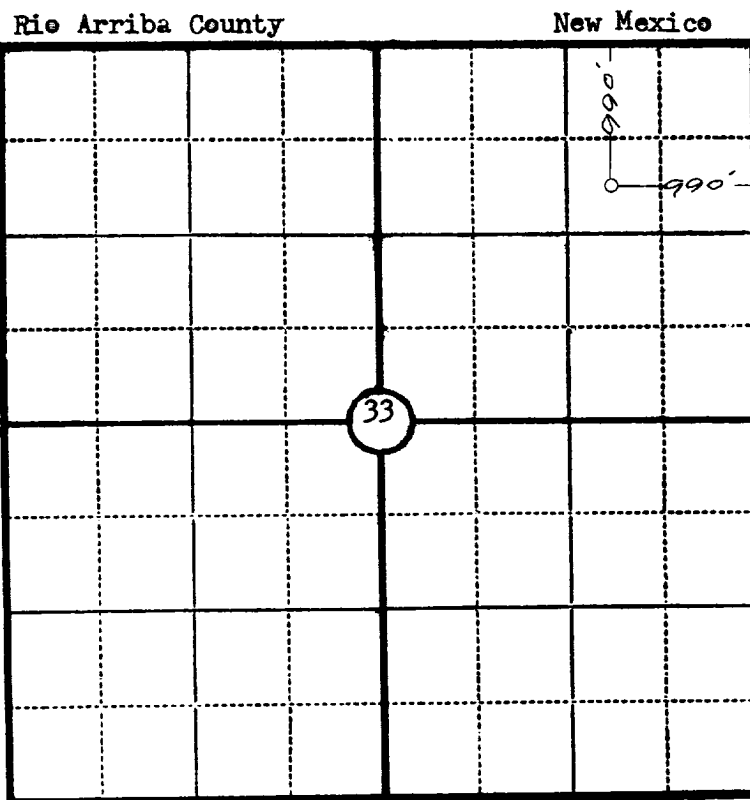

Scale—4 inches equal 1 mile.

This is to certify that the above plat was prepared from field notes of actual surveys made by me or under my supervision and that the same are true and correct to the best of my knowledge and belief.

Seal:

Registered Professional
Engineer and Land Surveyor.

Ernest V. Echohawk
N. Mex. Reg. No. 1545

Surveyed September 5, 1953

