

(SUBMIT IN TRIPLICATE)

UNITED STATES  
DEPARTMENT OF THE INTERIOR  
GEOLOGICAL SURVEY

Land Office **Santa Fe**  
Lease No. **080377**  
Unit **San Juan 29-6 Unit**

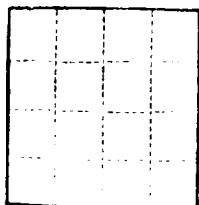

**SUNDRY NOTICES AND REPORTS ON WELLS**

NOTICE OF INTENTION TO DRILL	<input checked="" type="checkbox"/> XX	SUBSEQUENT REPORT OF WATER SHUT-OFF
NOTICE OF INTENTION TO CHANGE PLANS		SUBSEQUENT REPORT OF SHOOTING OR ACIDIZING
NOTICE OF INTENTION TO TEST WATER SHUT-OFF		SUBSEQUENT REPORT OF ALTERING CASING
NOTICE OF INTENTION TO RE-DRILL OR REPAIR WELL		SUBSEQUENT REPORT OF RE-DRILLING OR REPAIR
NOTICE OF INTENTION TO SHOOT OR ACIDIZE		SUBSEQUENT REPORT OF ABANDONMENT
NOTICE OF INTENTION TO PULL OR ALTER CASING		SUPPLEMENTARY WELL HISTORY
NOTICE OF INTENTION TO ABANDON WELL		

**RECEIVED**

**JUN 28 1962**

INDICATE ABOVE BY CHECK MARK NATURE OF REPORT, NOTICE, OR OTHER DATA

June 27 U. S. GEOLOGICAL SURVEY  
FARMINGTON, NEW MEXICO

Well No. 72 is located 990 ft. from ~~XX~~ [S] line and 990 ft. from ~~XX~~ [W] line of sec. 22

SW/4 Sec. 22

29N

6W

N.M.P.M.

Blanco Mesa Verde  
(Field)

Rio Arriba  
(County or Subdivision)

New Mexico  
(State or Territory)

**RECEIVED**

**JUN 29 1962**

**OIL CON. COM.  
DIST. 3**

The elevation of the derrick floor above sea level is 6388 ft.

**DETAILS OF WORK**

(State names of and expected depths to objective sands; show sizes, weights, and lengths of proposed casings; indicate mudlogging, oil-cementing points, and all other important proposed work.)

It is intended to drill a well with rotary tools thru the Mesa Verde formation. Mud circulation will be used thru the Pictured Cliffs and set intermediate casing. Gas circulation will be used thru the Mesa Verde and production liner will be set. Possible productive intervals will be perforated and fractured. Est. T. D. 5665'.

**Casing Program:**

9 5/8" @ 120' w/100 sks. cement circulated to surface.

7" @ 3500' w/130 sks. cement to cover Ojo Alamo.

4 1/2" @ 5665' w/220 sks. cement to cover top of liner.

The W/2 of Section 22 is dedicated to this well.

I understand that this plan of work must receive approval in writing by the Geological Survey before operations may be commenced.

Company **El Paso Natural Gas Company**

Address **Box 990**

**Farmington, New Mexico**

By

Title **Petroleum Engineer**

## NEW MEXICO OIL CONSERVATION COMMISSION

## Well Location and Acreage Dedication Plat

Section A.

Date **JUNE 6, 1962**

Operator **EL PASO NATURAL GAS COMPANY** Lease **SAN JUAN 29-6 UNIT** SF080377  
 Well No. **72** Unit Letter **M** Section **22** Township **29-N** Range **6-W** NMPM  
 Located **990** Feet From **SOUTH** Line, **990** Feet From **WEST** Line  
 County **RIO ARriba** G. L. Elevation **6378** Dedicated Acreage **320** Acres  
 Name of Producing Formation **MESA VERDE** Pool **BLANCO** M.V.

1. Is the Operator the only owner in the dedicated acreage outlined on the plat below?

Yes ☒ No

2. If the answer to question one is "no", have the interests of all the owners been consolidated by communitization agreement or otherwise? Yes No . If answer is "yes", Type of Consolidation.

3. If the answer to question two is "no", list all the owners and their respective interests below:

Owner

Description



RECEIVED  
JUN 28 1962

U. S. GEOLOGICAL SURVEY  
FARMINGTON, NEW MEXICO

Section B.

This is to certify that the information in Section A above is true and complete to the best of my knowledge and belief.

**El Paso Natural Gas Company**  
(Operator)

Original Signed **D. W. Meehan**  
(Representative)

**Box 990**  
(Address)

**Farmington, New Mexico**

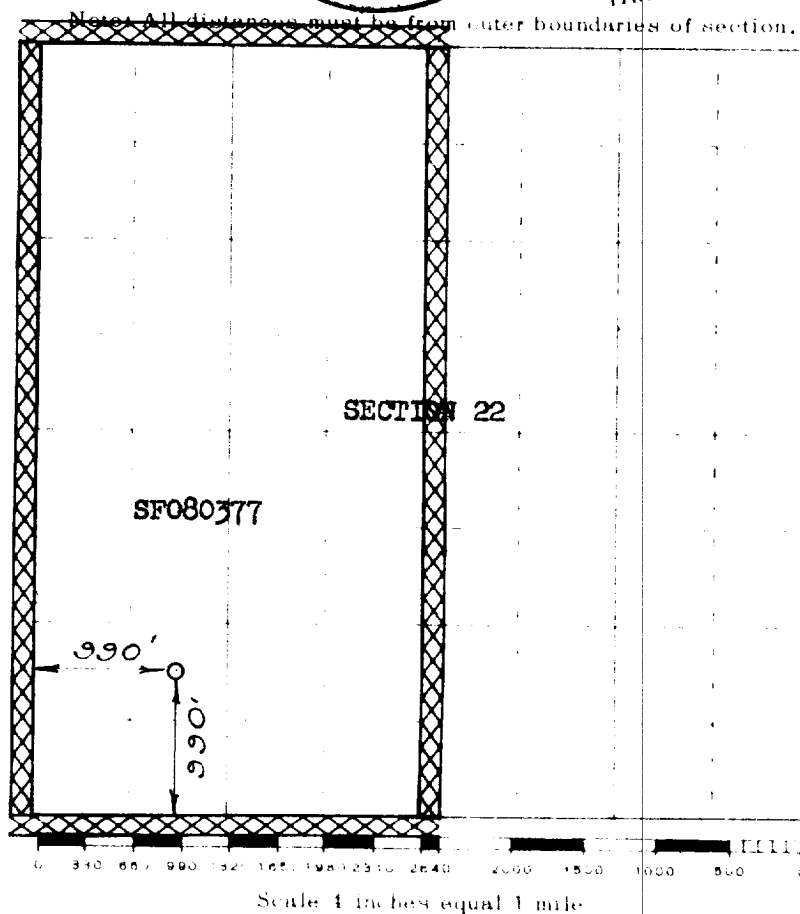

This is to certify that the above plat was prepared from field notes of actual surveys made by me or under my supervision and that the same are true and correct to the best of my knowledge and belief.

5-5043

Date Surveyed

**JUNE 4, 1962**

*David G. Kilner*  
Registered Professional Engineer and/or Land Surveyor

Farmington, New Mexico