

3 - U.S.G.S. (SUBMIT IN TRIPLICATE)

1 - U.S. Johnston
1 - File

UNITED STATES
DEPARTMENT OF THE INTERIOR
GEOLOGICAL SURVEY

Land Office

Lease No. 09100

Unit 22-5

11-01-11-437

SUNDRY NOTICES AND REPORTS ON WELLS

NOTICE OF INTENTION TO DRILL	<input checked="" type="checkbox"/>	SUBSEQUENT REPORT OF WATER SHUT-OFF	
NOTICE OF INTENTION TO CHANGE PLANS		SUBSEQUENT REPORT OF SHOOTING OR ACIDIZING	
NOTICE OF INTENTION TO TEST WATER SHUT-OFF		SUBSEQUENT REPORT OF ALTERING CASING	
NOTICE OF INTENTION TO RE-DRILL OR REPAIR WELL		SUBSEQUENT REPORT OF RE-DRILLING OR REPAIR	
NOTICE OF INTENTION TO SHOOT OR ACIDIZE		SUBSEQUENT REPORT OF ABANDONMENT	
NOTICE OF INTENTION TO PULL OR ALTER CASING		SUPPLEMENTARY WELL HISTORY	
NOTICE OF INTENTION TO ABANDON WELL			

(INDICATE ABOVE BY CHECK MARK NATURE OF REPORT, NOTICE, OR OTHER DATA)

November 8, 1955

Well No. 16-21 is located 990 ft. from N line and 990 ft. from E line of sec. 21

21 36 4 21
(1/4 Sec. and Sec. No.)

29
(Twp.)

3
(Range)

114.1
(Meridian)

Blanco
(Field)

San Arriba
(County or Subdivision)

New Mexico
(State or Territory)

The elevation of the Ungraded Ground above sea level is 6702.3 ft.

DETAILS OF WORK

(State names of and expected depths to objective sands; show sizes, weights, and lengths of proposed casings; indicate mudding jobs, cementing points, and all other important proposed work)

Propose to drill 15" hole to 175', set 10-1/4" casing cemented w/ 125 sz 46 gel. Then drill to 3655' w/ water or minimum mud, run 7-5/8" casing cemented w/ 150 sz 36 gel w/ 50 sz 36 at bottom. Drill to 6040' w/ gas, set 5" casing cemented w/ 125 sz 28 gel. Perf. & Sand Frac Cliff House, Manatee, Point Lookout separately each w/ 40,000 gals water w/ approx. 1 1/2 ad/gal. Run tubing & complete well.

320 Acres dedicated to this well.

I understand that this plan of work must receive approval in writing by the Geological Survey before operations may be commenced.

Company PACIFIC NORTHWEST PIPELINE CORPORATION

Address 411 West Main Street

Farmington, New Mexico

By J. H. Kegan

Title District Engineer

Company PACIFIC NORTHWEST PIPELINE CORPORATION

Lease..... Well No.....

Sec. 21, T. 29 N., R. 5 W., N.M.P.M.

Location 990' FROM THE SOUTH LINE AND 990' FROM THE WEST LINE.

Elevation 6702.3 UNGRADED GROUND.

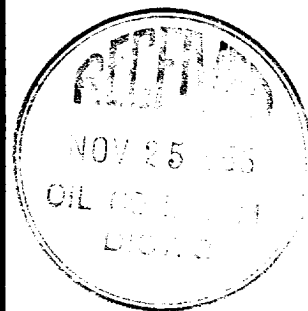
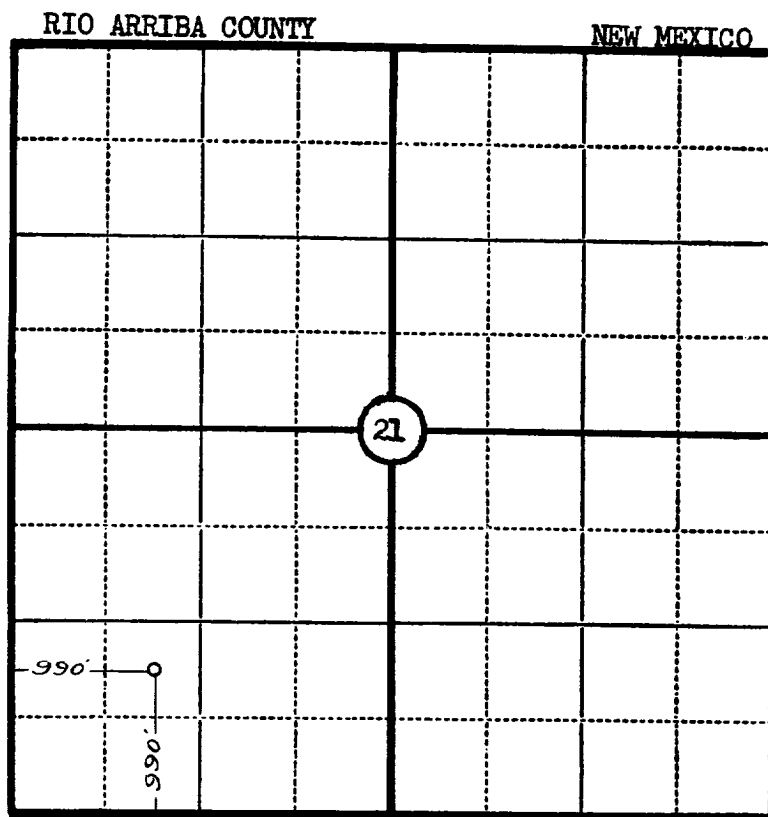

Scale—4 inches equal 1 mile.

This is to certify that the above plat was prepared from field notes of actual surveys made by me or under my supervision and that the same are true and correct to the best of my knowledge and belief.

Seal:

James P. Leese
Registered Land Surveyor.
James P. Leese
N. Mex. Reg. No. 1463

Surveyed 28 July 1955.....

SAN JUAN ENGINEERING COMPANY, FARMINGTON, N. M.