

(SUBMIT IN TRIPLICATE)

UNITED STATES
DEPARTMENT OF THE INTERIOR
GEOLOGICAL SURVEY

Land Office Santa Fe
Lease No. 078736
Unit San Juan 29-5 Unit

SUNDRY NOTICES AND REPORTS ON WELLS

NOTICE OF INTENTION TO DRILL.....	<input checked="" type="checkbox"/>	SUBSEQUENT REPORT OF WATER SHUT-OFF.....
NOTICE OF INTENTION TO CHANGE PLANS.....		SUBSEQUENT REPORT OF SHOOTING OR ACIDIZING.....
NOTICE OF INTENTION TO TEST WATER SHUT-OFF.....		SUBSEQUENT REPORT OF ALTERING CASING.....
NOTICE OF INTENTION TO RE-DRILL OR REPAIR WELL.....		SUBSEQUENT REPORT OF RE-DRILLING OR REPAIR.....
NOTICE OF INTENTION TO SHOOT OR ACIDIZE.....		SUBSEQUENT REPORT OF ABANDONMENT.....
NOTICE OF INTENTION TO PULL OR ALTER CASING.....		SUPPLEMENTARY WELL HISTORY.....
NOTICE OF INTENTION TO ABANDON WELL.....		

(INDICATE ABOVE BY CHECK MARK NATURE OF REPORT, NOTICE, OR OTHER DATA)

February 20, 1961

Well No. 51 is located 1090 ft. from XNN line and 800 ft. from XNE line of sec. 14
S.W. Sec. 14 29-N 5-W N.M.P.M.
($\frac{1}{4}$ Sec. and Sec. No.) (Twp.) (Range) (Meridian)
Blanco Mesa Verde Rio Arriba New Mexico
(Field) (County or Subdivision) (State or Territory)

The elevation of the derrick floor above sea level is 6759 ft.

DETAILS OF WORK

(State names of and expected depths to objective sands; show sizes, weights, and lengths of proposed casings; indicate mudding jobs, cementing points, and all other important proposed work)

It is intended to drill a well with rotary tools thru the Mesa Verde formation. Mud circulation will be used thru the Pictured Cliffs & set intermediate casing. Gas circulation will be used thru the Mesa Verde and production csg. will be set. Possible productive intervals will be perforated and fractured. Estimated Total Depth 6138'.

Casing Program:

9 5/8" @ 120' with 140 sacks cement circulated

7" @ 3920' with 90 sacks cement.

2 7/8" @ 6138' with 130 sacks cement.

The W/2 of Section 14 is dedicated to this well.

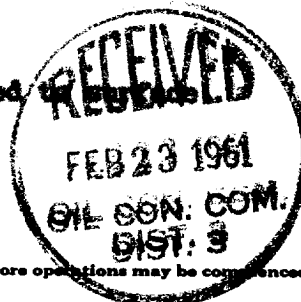

I understand that this plan of work must receive approval in writing by the Geological Survey before operations may be commenced.

Company El Paso Natural Gas Company

Address Box 990

Farmington, New Mexico

Original Signed By: D.H. Oheim
By _____

Title Petroleum Engineer

NEW MEXICO OIL CONSERVATION COMMISSION

Well Location and Acreage Dedication Plat

Section A.

Date **FEBRUARY 17, 1961**

Operator **EL PASO NATURAL GAS COMPANY** Lease **SAN JUAN 29-5 UNIT** SF **078736**
 Well No. **51** Unit Letter **M** Section **14** Township **29-N** Range **5-W** NMPM
 Located **1090** Feet From **SOUTH** Line, **800** Feet From **WEST** Line
 County **RIO ARriba** G. L. Elevation **6749** Dedicated Acreage **320** Acres
 Name of Producing Formation **MESA VERDE** Pool **BLANCO MESA VERDE**

1. Is the Operator the only owner in the dedicated acreage outlined on the plat below?
 Yes ☒ No ☐
2. If the answer to question one is "no", have the interests of all the owners been consolidated by communitization agreement or otherwise? Yes ☐ No ☐ If answer is "yes", Type of Consolidation

3. If the answer to question two is "no", list all the owners and their respective interests below:
- | Owner | Land Description |
|-------|------------------|
|-------|------------------|

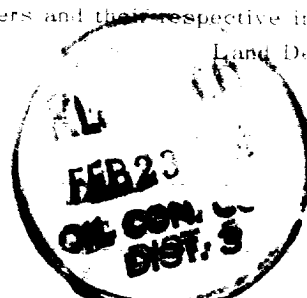
RECEIVED**FEB 21 1961**U. S. GEOLOGICAL SURVEY
FARMINGTON, NEW MEXICO

Section B.

This is to certify that the information in Section A above is true and complete to the best of my knowledge and belief.

El Paso Natural Gas Company
(Operator)

Original Signed By: D.H. Oheim
(Representative)

Box 990

Address:
Farmington, New Mexico

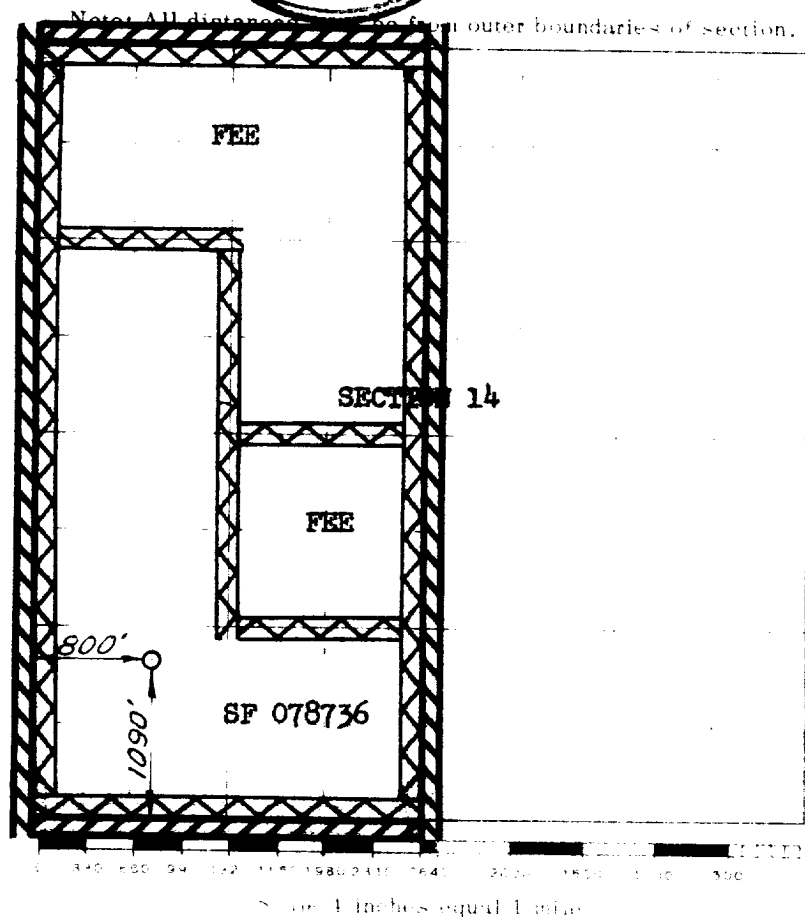

This is to certify that the above plat was prepared from field notes of actual surveys made by me or under my supervision and that the same are true and correct to the best of my knowledge and belief.

(Seal)

Farmington, New Mexico

Dated and Surveyed

JANUARY 23, 1961

David O. Vilner
 Registered Professional Engineer and/or Land Surveyor