

- 3 - USGS
- 2 - HNDCC
- 1 - State Land Office
- 1 - L. O. Truby (SUBMIT IN TRIPLICATE)
- 1 - File

Budget Bureau No. 42-B358.4
Approval expires 12-31-60.

Land Office Santa Fe
Lease No. 37-078281
Unit 14-08-001-437

UNITED STATES
DEPARTMENT OF THE INTERIOR
GEOLOGICAL SURVEY

SUNDRY NOTICES AND REPORTS ON WELLS

NOTICE OF INTENTION TO DRILL	<input checked="" type="checkbox"/>	SUBSEQUENT REPORT OF WATER SHUT-OFF	
NOTICE OF INTENTION TO CHANGE PLANS		SUBSEQUENT REPORT OF SHOOTING OR ACIDIZING	
NOTICE OF INTENTION TO TEST WATER SHUT-OFF		SUBSEQUENT REPORT OF ALTERING CASING	
NOTICE OF INTENTION TO RE-DRILL OR REPAIR WELL		SUBSEQUENT REPORT OF RE-DRILLING OR REPAIR	
NOTICE OF INTENTION TO SHOOT OR ACIDIZE		SUBSEQUENT REPORT OF ABANDONMENT	
NOTICE OF INTENTION TO PULL OR ALTER CASING		SUPPLEMENTARY WELL HISTORY	
NOTICE OF INTENTION TO ABANDON WELL			

(INDICATE ABOVE BY CHECK MARK NATURE OF REPORT, NOTICE, OR OTHER DATA)

April 11th, 1958

S.J. Unit 29-5

Well No. 25-16 is located 1650 ft. from N line and 1650 ft. from E line of sec. 18

SW/4 NW/4 Sec. 18 29 North 5 West N.M.P.M.
(1/4 Sec. and Sec. No.) (Twp.) (Range) (Meridian)

Blanco Mesa Verde Rio Arriba New Mexico
(Field) (County or Subdivision) (State or Territory)

The elevation of the ground surface above sea level is 6500 ft.

DETAILS OF WORK

(State names of and expected depths to objective sands; show sizes, weights, and lengths of proposed casings; indicate mudlogging jobs, cementing points, and all other important proposed work)

Propose to drill to 200' and set 10-3/4" casing, cement to surface. Set 7-5/8" casing @ 3710', cement w/150 ex regular w/8% gal and 50 ex bent. Set 5-1/2" liner @ 5050', cement w/200 ex regular.

Mesa Verde to be fractured thru perforations using approximately 150,000 gallons of water. Clean out to total depth, set tubing and complete well.

The N/2 of Section 18, containing 320 acres, is dedicated to this well.

100% Pacific Northwest Pipeline Corporation

I understand that this plan of work must receive approval in writing by the Geological Survey before operations may be commenced.

Company PACIFIC NORTHWEST PIPELINE CORPORATION

Address 418 1/2 West Broadway

Farmington, New Mexico

By Original signed by L. E. Stone

Title Division Manager

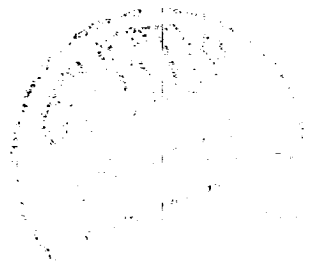

NEW MEXICO OIL CONSERVATION COMMISSION

Well Location and Acreage Dedication Plat

Section A.

Date **MARCH 28, 1958**

Operator **PACIFIC NORTHWEST PIPELINE CORPORATION** Lease **SAN JUAN 29-5 UNIT** SF **078281**
 Well No. **25-18** Unit Letter **G** Section **18** Township **29-N** Range **5-W** NMPM
 Located **1650** Feet From **NORTH** Line **1650** Feet From **EAST** Line
 County **RIO ARriba** G. L. Elevation **6500** Dedicated Acreage **320** Acres
 Name of Producing Formation **MESA VERDE** Pool **BLANCO MESA VERDE**

1. Is the Operator the only owner in the dedicated acreage outlined on this plat below?
 Yes ☒ No ☐
2. If the answer to question one is "no", have the interests of all the owners been a written conveyance or unitization agreement or otherwise? Yes ☐ No ☐ If answer is "yes", Type of Consolidation

3. If the answer to question two is "no", list all the owners and their respective interests below:

Owner

Land Description



Section B.

This is to certify that the information in Section A above is true and complete to the best of my knowledge and belief.

(Operator)
Original signed by L. F. Stone
 (Representative)

(Address)
Pacific Northwest Pipeline Corp.
418 1/2 W. Broadway
Farmington, New Mexico

Note: All distances must be in proper units and correct.

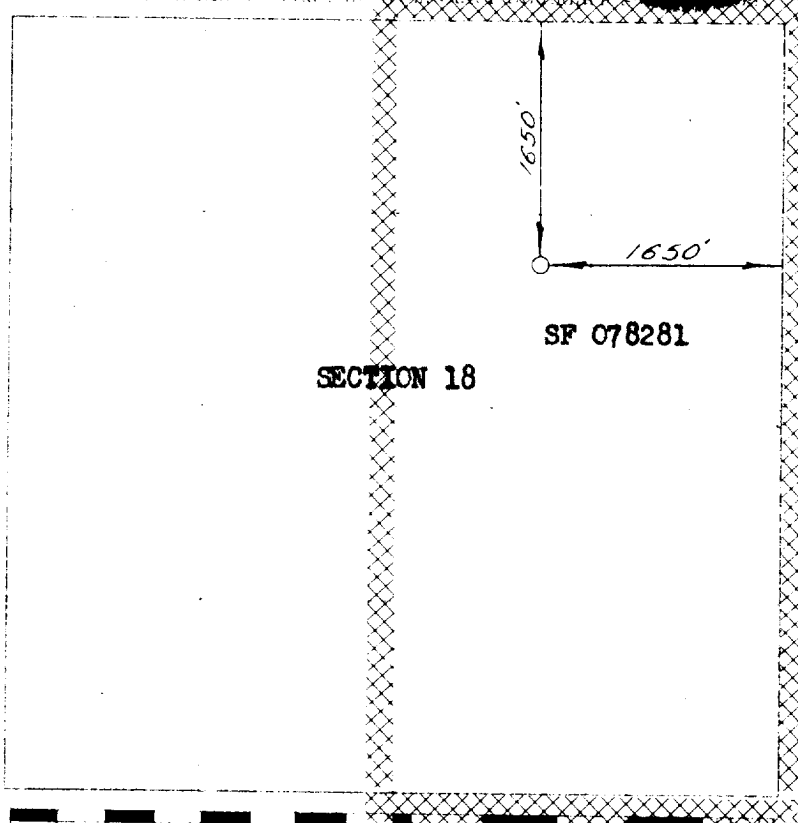

0 337 690 944 1225 1650 1931 2311 2641 2971 3300 3630 3960

Scale: 1 inch = 1 mile

This is to certify that the above plat was prepared from field notes of actual surveys made by me or under my supervision and that the same are true and correct to the best of my knowledge and belief.

Dated Surveyed **AUGUST 24, 1955**

James B. Lease
 Registered Professional Engineer and/or Land Surveyor



Farmington, New Mexico