

NEW MEXICO OIL CONSERVATION COMMISSION
Santa Fe, New Mexico

NOTICE OF INTENTION TO DRILL OR RECOMPLETE

Notice must be given to the District Office of the Oil Conservation Commission and approval obtained before drilling or recompletion begins. If changes in the proposed plan are considered advisable, a copy of this notice showing such changes will be returned to the sender. Submit this notice in QUINTUPPLICATE. One copy will be returned following approval. See additional instructions in Rules and Regulations of the Commission.

Dallas, Texas

(Place)

May 5, 1953

(Date)

OIL CONSERVATION COMMISSION
SANTA FE, NEW MEXICO

Gentlemen:

You are hereby notified that it is our intention to commence the (Drilling) (~~Recompletion~~) of a well to be known as

Southern Union Gas Company

(Company or Operator)

P. Candelaria

(Lease)

Well No. 1

in K

(Unit)

The well is

located 1650 feet from the South line and 1650 feet from the

West

line of Section 9

T. 29-N

R. 7-W

NMPM.

(GIVE LOCATION FROM SECTION LINE)

Blanco

Pool,

Rio Arriba

County

If State Land the Oil and Gas Lease is No.

If patented land the owner is P. Candelaria (Communitized Unit)

Address (See below)

We propose to drill well with drilling equipment as follows: Rotary to top of Cliff House and pay sands by natural gas method.

The status of plugging bond is Blanket Bond

Drilling Contractor

We intend to complete this well in the Cliff House and Point Lookout formation at an approximate depth of Cliff House 4700; Point Lookout 5150 feet.

CASING PROGRAM T. D. 5400

We propose to use the following strings of Casing and to cement them as indicated:

Size of Hole	Size of Casing	Weight per Foot	New or Second Hand	Depth	Sacks Cement
	<u>10 3/4"</u>	<u>54#</u>	<u>New</u>	<u>150'</u>	<u>75</u>
	<u>7"</u>	<u>20#</u>	<u>"</u>	<u>4700'</u>	<u>200</u>

If changes in the above plans become advisable we will notify you immediately.

ADDITIONAL INFORMATION (If recompletion give full details of proposed plan of work.)

Well will be shot with 1800 quarts of nitro glycerine from 4700 to 5400

Communitized Unit: W $\frac{1}{2}$ Sec. 9, T-29-N, R-7-W, N.M.P.M.

J. A. Pierce and Tom Bolack-Fee, P. Candelaria; N $\frac{1}{2}$, NW $\frac{1}{4}$, SE $\frac{1}{4}$, NW $\frac{1}{4}$, NE $\frac{1}{4}$, SW $\frac{1}{4}$

Southern Union Gas Company - S. F. 078423-SW $\frac{1}{4}$, NW $\frac{1}{4}$, W $\frac{1}{2}$, SW $\frac{1}{4}$, SE $\frac{1}{4}$, SW $\frac{1}{4}$

Approved S-9, 19 53

Except as follows:

Sincerely yours,

SOUTHERN UNION GAS COMPANY

(Company or Operator)

By

Van Thompson

Position

Send Communications regarding well to

Name

Address

OIL CONSERVATION COMMISSION

By

Title

Emily C. Gurned

Company.....Southern Union Gas Company.....

Lease.....P. Candelaria.....Well No. 1.....

Sec. 9....., T. 29 N....., R. 7 W., N.M.P.M.....

Location.....1650' from the South line and 1650' from
the West line.

Rio Arriba County

New Mexico

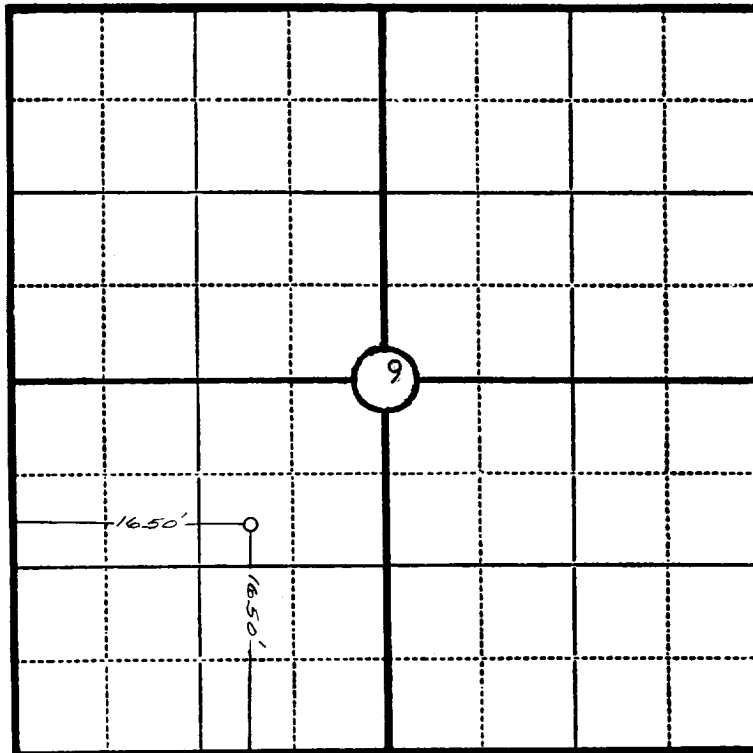

Scale—4 inches equal 1 mile.

This is to certify that the above plat was prepared from field notes of actual surveys made by me or under my supervision and that the same are true and correct to the best of my knowledge and belief.

Seal:

James P. Leese
Registered Professional
Engineer and Land Surveyor.

James P. Leese
N. Mex. Reg. No. 1463

SurveyedMarch 16....., 19..53..

OIL CONSERVATION COMMISSION		
AZTEC DISTRICT OFFICE		
No. Copies Received <u>6</u>		
DISTRIBUTION		
	NO. FURNISHED	
Operator	<u>1</u>	
Santa Fe	<u>1</u>	
Proration Office		
State Land Office	<u>1</u>	
U. S. G. S.	<u>2</u>	
Transporter		
File	<u>1</u>	✓