

NO. OF COPIES RECEIVED	6
DISTRIBUTION	
SANTA FE	1
FILE	1
U.S.G.S.	2
LAND OFFICE	1
OPERATOR	1

NEW MEXICO OIL CONSERVATION COMMISSION

Form C-101
Revised 1-1-65 30-039-20297

5A. Indicate Type of Lease	
STATE <input type="checkbox"/>	FEE <input checked="" type="checkbox"/>
5. State Oil & Gas Lease No.	
Fee	

APPLICATION FOR PERMIT TO DRILL, DEEPEN, OR PLUG BACK

1a. Type of Work	
DRILL <input checked="" type="checkbox"/>	DEEPEN <input type="checkbox"/>
b. Type of Well	
OIL WELL <input type="checkbox"/>	GAS WELL <input checked="" type="checkbox"/>
2. Name of Operator	
El Paso Natural Gas Company	
3. Address of Operator	
Box 990, Farmington, New Mexico 87401	
4. Location of Well	
UNIT LETTER K	LOCATED 1850 FEET FROM THE South LINE
AND 1850 FEET FROM THE West LINE OF SEC. 26 TWP. 29N RGE. 6W NMPM	
19. Proposed Depth	
7720	
19A. Formation	
Dakota	
20. Rotary or C.T.	
Rotary	
21. Elevations (Show whether DF, RT, etc.)	
6342' GL	
21A. Kind & Status Plug. Bond	
Statewide	
21B. Drilling Contractor	
Loffland Bros.	
22. Approx. Date Work will start	

7. Unit Agreement Name
San Juan 29-6 Unit
8. Farm or Lease Name
San Juan 29-6 Unit
9. Well No.
98
10. Field and Pool, or Wildcat
Basin Dakota
12. County
Rio Arriba

PROPOSED CASING AND CEMENT PROGRAM					
SIZE OF HOLE	SIZE OF CASING	WEIGHT PER FOOT	SETTING DEPTH	SACKS OF CEMENT	EST. TOP
13 3/4"	9 5/8"	32.30#	200'	165	Circulate
8 3/4"	7"	20#	3450'	185	2405'
6 1/4"	4 1/2"	10.5 & 11.6#	7720'	360	3450'

Selectively perforate and sand water fracture the Dakota formation.

The S/2 of Sec. 26 ~~xxxxx~~ is dedicated to this well.

APPROVAL VALID
FOR 90 DAYS UNLESS
DRILLING COMMENCED,
EXPIRES May 11, 1970



IN ABOVE SPACE DESCRIBE PROPOSED PROGRAM: IF PROPOSAL IS TO DEEPEN OR PLUG BACK, GIVE DATA ON PRESENT PRODUCTIVE ZONE AND PROPOSED NEW PRODUCTIVE ZONE. GIVE BLOWOUT PREVENTER PROGRAM, IF ANY.

I hereby certify that the information above is true and complete to the best of my knowledge and belief.
Original signed by:
Signed L. O. Van Ryan Title Petroleum Engineer Date 2-6-70

(This space for State Use)
APPROVED BY [Signature] TITLE Sup. Dist. III DATE 2-9-70
CONDITIONS OF APPROVAL, IF ANY:

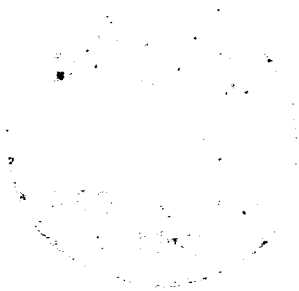

1870-1871
1872-1873
1874-1875
1876-1877
1878-1879
1880-1881
1882-1883
1884-1885
1886-1887
1888-1889
1890-1891
1892-1893
1894-1895
1896-1897
1898-1899
1900-1901
1902-1903
1904-1905
1906-1907
1908-1909
1910-1911
1912-1913
1914-1915
1916-1917
1918-1919
1920-1921
1922-1923
1924-1925
1926-1927
1928-1929
1930-1931
1932-1933
1934-1935
1936-1937
1938-1939
1940-1941
1942-1943
1944-1945
1946-1947
1948-1949
1950-1951
1952-1953
1954-1955
1956-1957
1958-1959
1960-1961
1962-1963
1964-1965
1966-1967
1968-1969
1970-1971
1972-1973
1974-1975
1976-1977
1978-1979
1980-1981
1982-1983
1984-1985
1986-1987
1988-1989
1990-1991
1992-1993
1994-1995
1996-1997
1998-1999
2000-2001
2002-2003
2004-2005
2006-2007
2008-2009
2010-2011
2012-2013
2014-2015
2016-2017
2018-2019
2020-2021
2022-2023
2024-2025

NEW MEXICO OIL CONSERVATION COMMISSION
WELL LOCATION AND ACREAGE DEDICATION PLAT

Form 7-1
Supersedes C-128
Effective 1-1-67

All distances must be from the outer boundaries of the Section

EL PASO NATURAL GAS COMPANY		SAN JUAN 29-6 UNIT		(FEE)	98
K	26	29-N	6-W	RIO ARriba	
1850	SOUTH		1850	WEST	
6342	DAKOTA		BASIN DAKOTA		320.00

- Outline the acreage dedicated to the subject well by colored pencil or hatchure marks on the plat below.
- If more than one lease is dedicated to the well, outline each and identify the ownership thereof (both as to working interest and royalty).
- If more than one lease of different ownership is dedicated to the well, have the interests of all wells pooled or consolidated by communitization, unitization, force-pooling, etc?

☒ Yes ☐ No If answer is "yes," type of consolidation — **Unitization**

If answer is "no," list the owners and tract descriptions which have actually been consolidated (the reverse side of this form if necessary.)

No allowable will be assigned to the well until all interests have been consolidated (by communitization, unitization, forced-pooling, or otherwise) or until a non-standard unit, eliminating such interests, has been approved by the Commission.

CERTIFICATION

I hereby certify that the information contained herein is true and complete to the best of my knowledge and belief.

Original Signed by:

L. O. Van Ryan

Petroleum Engineer

El Paso Natural Gas Co.

February 6, 1970

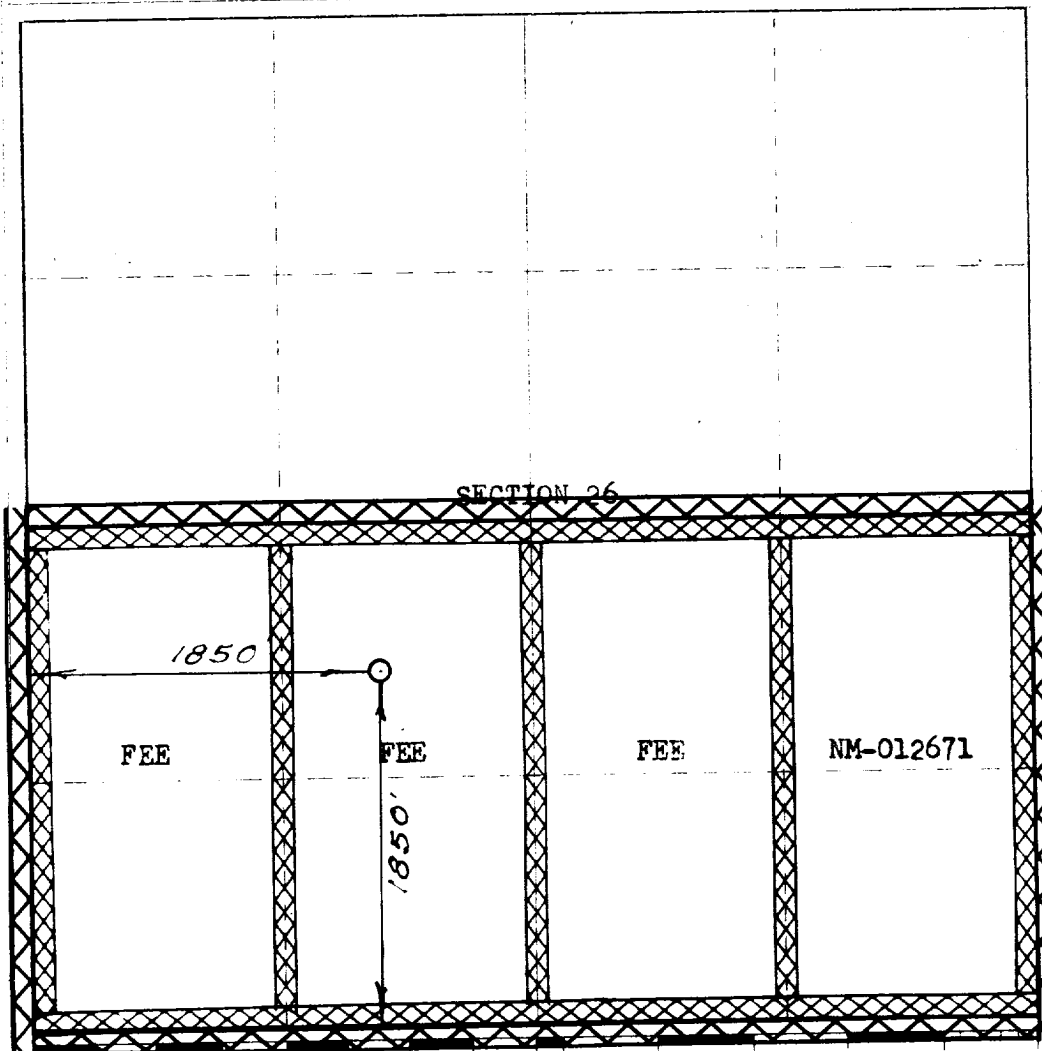

I hereby certify that the well location shown on this plat was plotted from field notes of actual surveys made by me or under my supervision, and that the same is true and correct to the best of my knowledge and belief.

JANUARY 16, 1970

Paul Olsen
1760