

NO. OF COPIES RECEIVED	6
DISTRIBUTION	
SANTA FE	1
FILE	1
U.S.G.S.	2
LAND OFFICE	
OPERATOR	2

NEW MEXICO OIL CONSERVATION COMMISSION

Form C-101
Revised 1-4-65 36-059-20325

5A. Indicate Type of Lease	
STATE <input type="checkbox"/>	FEE <input checked="" type="checkbox"/>

5. State Oil & Gas Lease No.

APPLICATION FOR PERMIT TO DRILL, DEEPEN, OR PLUG BACK

1a. Type of Work		7. Unit Agreement Name	
DRILL <input checked="" type="checkbox"/> DEEPEN <input type="checkbox"/> PLUG BACK <input type="checkbox"/>		San Juan 29-6 Unit	
b. Type of Well		8. Farm or Lease Name	
OIL WELL <input type="checkbox"/> GAS WELL <input checked="" type="checkbox"/> OTHER <input type="checkbox"/> SINGLE ZONE <input checked="" type="checkbox"/> MULTIPLE ZONE <input type="checkbox"/>		San Juan 29-6 Unit	
2. Name of Operator		9. Well No.	
El Paso Natural Gas Company		102	
3. Address of Operator		10. Field and Pool, or Wildcat	
Box 990, Farmington, New Mexico 87401		Basin Dakota	
4. Location of Well		12. County	
UNIT LETTER <u>G</u> LOCATED <u>1650</u> FEET FROM THE <u>North</u> LINE <u>1750</u> FEET FROM THE <u>East</u> LINE OF SEC. <u>10</u> TWP. <u>29N</u> RGE. <u>6W</u> NMPM		Rio Arriba	
19. Proposed Depth		19A. Formation	
7802'		Dakota	
20. Rotary or C.T.		Rotary	
21. Elevations (Show whether DF, RT, etc.)		22. Approx. Date Work will start	
6439' GL			
21A. Kind & Status Plug. Bond		21B. Drilling Contractor	
Statewide		Loffland Bros.	

23.

PROPOSED CASING AND CEMENT PROGRAM

SIZE OF HOLE	SIZE OF CASING	WEIGHT PER FOOT	SETTING DEPTH	SACKS OF CEMENT	EST. TOP
13 3/4"	9 5/8"	32.30#	200'	190 Sks.	Circulated
8 3/4"	7"	20#	3650'	190 Sks.	2460'
6 1/4"	4 1.2"	10.5 & 11.6#	7802'	325 Sks.	3650'

Selectively perforate and sand water fracture the Dakota formation.

The E/2 of Section 10 is dedicated to this well.

APPROVAL VALID
FOR 30 DAYS UNLESS
DRILLING COMMENCED,
EXPIRES July 6, 1971



IN ABOVE SPACE DESCRIBE PROPOSED PROGRAM: IF PROPOSAL IS TO DEEPEN OR PLUG BACK, GIVE DATA ON PRESENT PRODUCTIVE ZONE AND PROPOSED NEW PRODUCTIVE ZONE. GIVE BLOWOUT PREVENTER PROGRAM, IF ANY.

I hereby certify that the information above is true and complete to the best of my knowledge and belief.

Signed [Signature] Title Petroleum Engineer Date 4-2-71

(This space for State Use) U. Van Pelt

APPROVED BY [Signature] TITLE Sup Dist III DATE 4-7-71

CONDITIONS OF APPROVAL IF ANY:

NEW MEXICO OIL CONSERVATION COMMISSION
WELL LOCATION AND ACREAGE DEDICATION PLAT

Superseries 0-128
10-10-1968

All distances must be from the outer boundaries of the Section

EL PASO NATURAL GAS COMPANY		SAN JUAN 29-6 UNIT		(FEE)	102
G	10	29-N	6-W	RIO ARRIBA	
1650	NORTH		1750	EAST	
6439	DAKOTA		BASIN DAKOTA		320.00

- Outline the acreage dedicated to the subject well by colored pencil or hatchure marks on the plat below.
- If more than one lease is dedicated to the well, outline each and identify the ownership interest (both as to ownership interest and royalty).
- If more than one lease of different ownership is dedicated to the well, have the interests of all owners been consolidated by communitization, unitization, force-pooling, etc?

☒ Yes ☐ No If answer is "yes," type of consolidation _____

Unitization OIL CON. COM.
DIST. 3

If answer is "no," list the owners and tract descriptions which have actually been consolidated. (Use reverse side of this form if necessary.) _____

No allowable will be assigned to the well until all interests have been consolidated (by communitization, unitization, forced-pooling, or otherwise) or until a non-standard unit, eliminating such interests, has been approved by the Commission. **NOTE: THIS PLAT REISSUED TO SHOW CORRECTED DEDICATION AND COUNTY. 2-2-71**

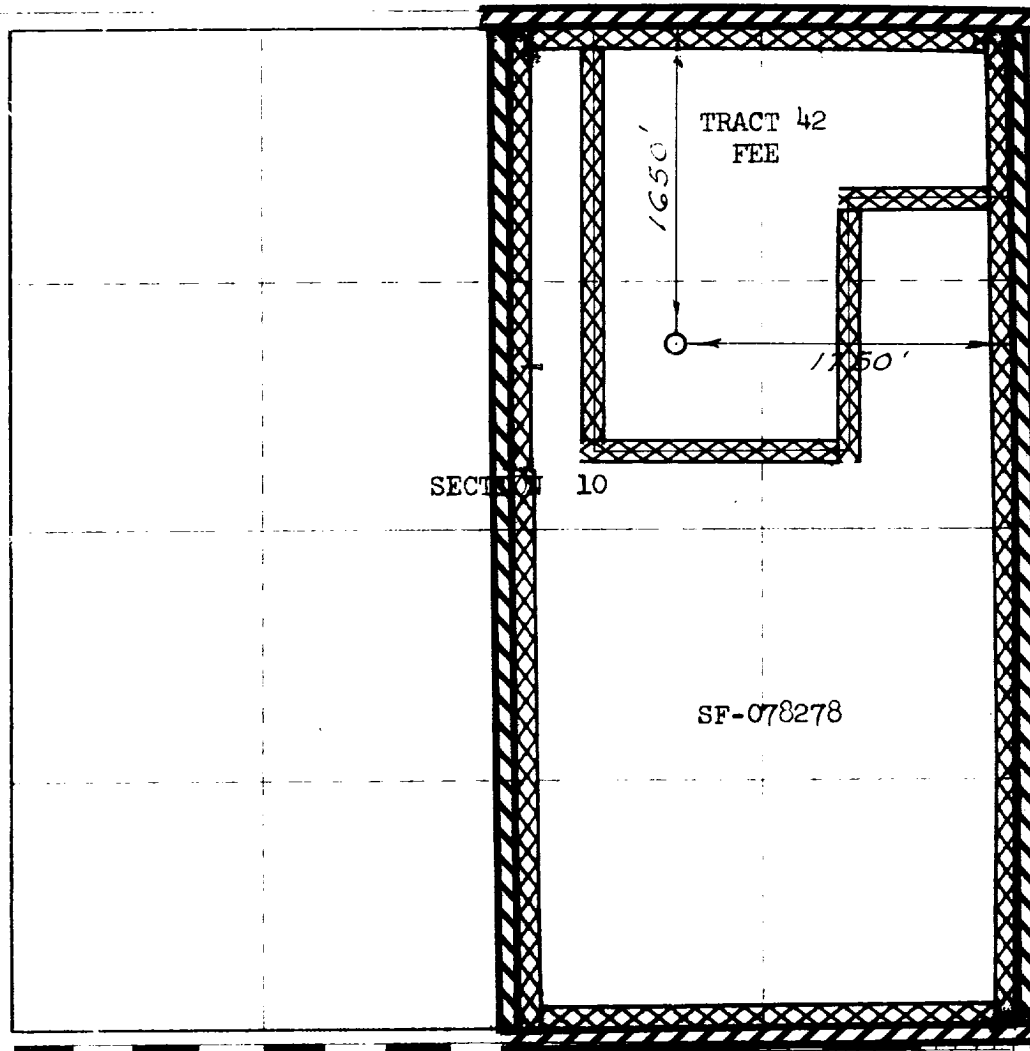

CERTIFICATION

I hereby certify that the information contained herein is true and complete to the best of my knowledge and belief.

~~Oil and Gas Engineer~~ By: _____

L. O. Van Ryan
Petroleum Engineer

El Paso Natural Gas Co.

April 2, 1971

I hereby certify that the well location shown on this plat was located by the notes of actual surveys made by me or under my supervision, and that the same is true and correct to the best of my knowledge and belief.

DECEMBER 31, 1970

[Signature]
1760