

UNITED STATES  
DEPARTMENT OF THE INTERIOR  
GEOLOGICAL SURVEY

30-039-20712

## APPLICATION FOR PERMIT TO DRILL, DEEPEN, OR PLUG BACK

## 1a. TYPE OF WORK

DRILL ☒DEEPEN ☐PLUG BACK ☐

## 5. LEASE DESIGNATION AND SERIAL NO.

SF 078281

## 6. IF INDIAN, ALLOTTEE OR TRIBE NAME

## 7. UNIT AGREEMENT NAME

San Juan 29-5 Unit

## 8. FARM OR LEASE NAME

San Juan 29-5 Unit

## 9. WELL NO.

68

## 10. FIELD AND POOL, OR WILDCAT

Basin Dakota

11. SEC., T., R., M., OR BLK.  
AND SURVEY OR AREASec. 18, T-29-N, R-5-W  
NMPM

## 12. COUNTY OR PARISH

Rio Arriba

## 13. STATE

New Mexico

## b. TYPE OF WELL

OIL  
WELL ☐GAS  
WELL ☒

OTHER

SINGLE  
ZONE ☒MULTIPLE  
ZONE ☐

## 2. NAME OF OPERATOR

El Paso Natural Gas Company

## 3. ADDRESS OF OPERATOR

PO Box 990, Farmington, NM 87401

## 4. LOCATION OF WELL (Report location clearly and in accordance with any State requirements.)\*

At surface

1180'N, 1180'E

At proposed prod. zone

## 14. DISTANCE IN MILES AND DIRECTION FROM NEAREST TOWN OR POST OFFICE\*

## 15. DISTANCE FROM PROPOSED\*

LOCATION TO NEAREST  
PROPERTY OR LEASE LINE, FT.  
(Also to nearest drig. unit line, if any)

## 16. NO. OF ACRES IN LEASE

17. NO. OF ACRES ASSIGNED  
TO THIS WELL

320

18. DISTANCE FROM PROPOSED LOCATION\*  
TO NEAREST WELL, DRILLING, COMPLETED,  
OR APPLIED FOR, ON THIS LEASE, FT.

## 19. PROPOSED DEPTH

7946'

## 20. ROTARY OR CABLE TOOLS

Rotary

## 21. ELEVATIONS (Show whether DF, RT, GR, etc.)

6500'GR

## 22. APPROX. DATE WORK WILL START\*

## 23.

## PROPOSED CASING AND CEMENTING PROGRAM

SIZE OF HOLE	SIZE OF CASING	WEIGHT PER FOOT	SETTING DEPTH	QUANTITY OF CEMENT
13 3/4"	9 5/8"	32.3#	200'	220 cu.ft. to circ. to surface
8 3/4"	7"	20#	3800'	260 cu.ft. to cover Ojo Alamo
6 1/4"	4 1/2"	10.5#& 11.6#	7946'	635 cu.ft. to fill to intermediate casing

Selectively perforate and sandwater fracture the Dakota formation.

Surface is patented and owner approval has been secured.

The E/2 of Section 18 is dedicated to this well.

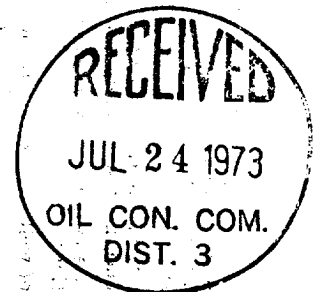

IN ABOVE SPACE DESCRIBE PROPOSED PROGRAM: If proposal is to deepen or plug back, give data on present productive zone and proposed new productive zone. If proposal is to drill or deepen directionally, give pertinent data on subsurface locations and measured and true vertical depths. Give blowout preventer program, if any.

## 24.

SIGNED

*A. G. Ducas*

TITLE

Drilling Clerk

DATE

July 20, 1973

(This space for Federal or State office use)

PERMIT NO.

APPROVAL DATE

APPROVED BY

TITLE

DATE

CONDITIONS OF APPROVAL, IF ANY:

*OK*

\*See Instructions On Reverse Side

**NEW MEXICO OIL CONSERVATION COMMISSION**  
**WELL LOCATION AND ACERAGE DEDICATION PLAT**

All distances must be from the outer boundaries of the Section

Operator <b>EL PASO NATURAL GAS COMPANY</b>			Lease <b>SAN JUAN 29-5 (SF-078281)</b>		Well No. <b>68</b>
Unit Letter <b>A</b>	Section <b>18</b>	Township <b>29 NORTH</b>	Range <b>5 WEST</b>	County <b>RIO ARriba</b>	
Actual Footage Location of Well: <b>1180</b> feet from the <b>NORTH</b> line and <b>1180</b> feet from the <b>EAST</b> line					
Ground Level Elev. <b>6500.0</b>	Producing Formation <b>DAKOTA</b>	Pool <b>BASIN DAKOTA</b>	Dedicated Acreage: <b>320.00</b> Acres		

1. Outline the acreage dedicated to the subject well by colored pencil or hachure marks on the plat below.
2. If more than one lease is dedicated to the well, outline each and identify the ownership thereof (both as to working interest and royalty),
3. If more than one lease of different ownership is dedicated to the well, have the interests of all owners been consolidated by communitization, unitization, force-pooling, etc?

( ) Yes ( ) No If answer is "yes," type of consolidation ..... unitization

If answer is "no," list the owners and tract descriptions which have actually consolidated. (Use reverse side of this form if necessary.) .....

No allowable will be assigned to the well until all interests have been consolidated (by communitization, unitization, forced-pooling, or otherwise) or until a non standard unit, eliminating such interests, has been approved by the Commission.

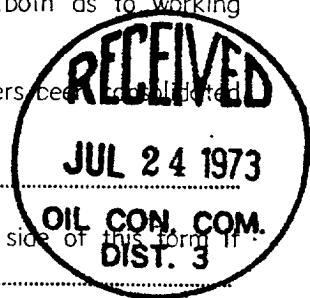

**CERTIFICATION**

I hereby certify that the information contained herein is true and complete to the best of my knowledge and belief.

**Original Signed by**

Name **D. G. Brisco**

Position **El Paso Natural Gas Co.**

Company **El Paso Natural Gas Co.**

Date **7/21/73**

Date                     

Date                     

Date                     

Date                     

Date                     

Date                     

Date                     

Date                     

Date                     

Date                     

Date                     

Date                     

Date                     

Date                     

Date                     

Date                     

Date                     

Date                     

Date                     

Date                     

Date                     

Date                     

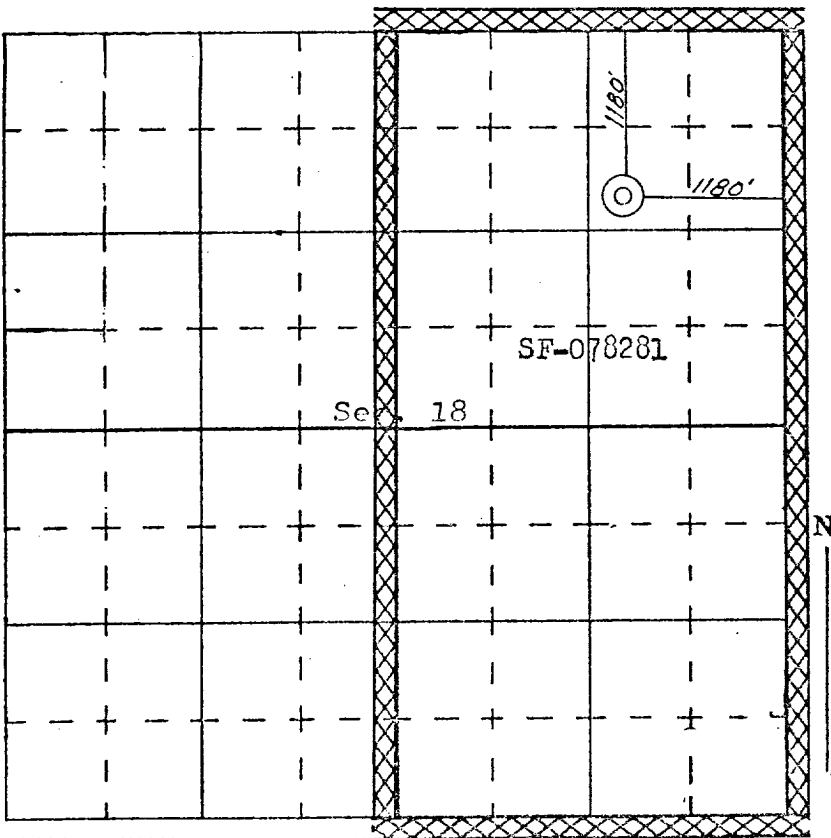
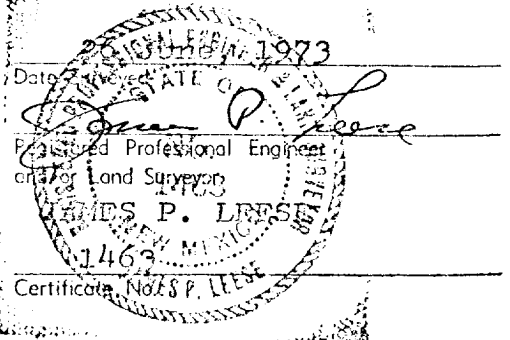

SCALE—4 INCHES EQUALS 1 MILE