

UNITED STATES  
DEPARTMENT OF THE INTERIOR  
GEOLOGICAL SURVEY

## APPLICATION FOR PERMIT TO DRILL, DEEPEN, OR PLUG BACK

## 1a. TYPE OF WORK

DRILL ☒DEEPEN ☐PLUG BACK ☐

## b. TYPE OF WELL

OIL  
WELL ☐GAS  
WELL ☒

OTHER

SINGLE  
ZONE ☐MULTIPLE  
ZONE ☐

## 2. NAME OF OPERATOR

Continental Oil Company

## 3. ADDRESS OF OPERATOR

152 North Durbin St., Casper, Wyo. 82501

## 4. LOCATION OF WELL (Report location clearly and in accordance with any State regulations.)

At surface

1710' FNL, 800' FEL (SE NE)

At proposed prod. zone

## 14. DISTANCE IN MILES AND DIRECTION FROM NEAREST TOWN OR POST OFFICE\*

## 15. DISTANCE FROM PROPOSED\*

LOCATION TO NEAREST  
PROPERTY OR LEASE LINE, FT.  
(Also to nearest drlg. unit line, if any)

## 16. NO. OF ACRES IN LEASE

1,760.94

17. NO. OF ACRES ASSIGNED  
TO THIS WELL

320

18. DISTANCE FROM PROPOSED LOCATION\*  
TO NEAREST WELL, DRILLING, COMPLETED,  
OR APPLIED FOR, ON THIS LEASE, FT.

## 19. PROPOSED DEPTH

8500'

## 20. ROTARY OR CABLE TOOLS

Rotary

## 21. ELEVATIONS (Show whether DF, RT, GR, etc.)

7112.0 GR

## 22. APPROX. DATE WORK WILL START\*

10-15-73

## 23.

## PROPOSED CASING AND CEMENTING PROGRAM

SIZE OF HOLE	SIZE OF CASING	WEIGHT PER FOOT	SETTING DEPTH	QUANTITY OF CEMENT
12 1/4"	8 5/8"	24#	200'	150 sacks Class "A"
7 7/8"	5 1/2"	14-15.5-17#	8500'	300-200-110 Poz "A" - 3 stages

It is proposed to drill the subject well to test for commercial gas production from the Dakota formation. The drilling rig will be equipped with a blowout preventer which will be tested daily. Also, all equipment used in the drilling operations will be equipped with all safety devices prescribed by the U. S. Forest Service, and all operations will be conducted according to their rules and regulations.

IN ABOVE SPACE DESCRIBE PROPOSED PROGRAM: If proposal is to deepen or plug back, give data on present productive zone and proposed new productive zone. If proposal is to drill or deepen directionally, give pertinent data on subsurface locations and measured and true vertical depths. Give blowout preventer program, if any.

## 24.

SIGNED

*J. A. Maben*TITLE Administrative SupervisorDATE 10/2/73

(This space for Federal or State office use)

PERMIT NO. \_\_\_\_\_

APPROVAL DATE \_\_\_\_\_

APPROVED BY \_\_\_\_\_

TITLE \_\_\_\_\_

CONDITIONS OF APPROVAL, IF ANY:

*Ok*

\*See Instructions On Reverse Side

**NEW MEXICO OIL CONSERVATION COMMISSION  
WELL LOCATION AND ACERAGE DEDICATION PLAT**

All distances must be from the outer boundaries of the Section

Operator <b>CONTINENTAL OIL COMPANY</b>			Lease <b>CONOCO 29-4</b>		Well No <b>5</b>
Unit Letter <b>H</b>	Section <b>12</b>	Township <b>29 NORTH</b>	Range <b>4 WEST</b>	County <b>RIO ARriba</b>	
Actual Factage Location of Well:					
<b>1710</b> feet from the <b>NORTH</b> line and		<b>800</b> feet from the <b>EAST</b> line			
Ground Level Elev. <b>7112.0</b>	Producing Formation <b>Basin Dakota</b>		Dedicated Acreage: <b>320</b> Acres		

1. Outline the acreage dedicated to the subject well by colored pencil or hatchure marks on the plat below.
2. If more than one lease is dedicated to the well, outline each and identify the ownership thereof (both as to working interest and royalty).
3. If more than one lease of different ownership is dedicated to the well, have the interests of all owners been consolidated by communitization, unitization, force-pooling, etc?

( ) Yes ( ) No If answer is "yes," type of consolidation \_\_\_\_\_

If answer is "no," list the owners and tract descriptions which have actually consolidated. (Use reverse side of this Form if necessary.) \_\_\_\_\_

No allowable will be assigned to the well until all interests have been consolidated (by communitization, unitization, forced-pooling, or otherwise) or until a non standard unit, eliminating such interests, has been approved by the Commission.

**CERTIFICATION**

I hereby certify that the information contained herein is true and complete to the best of my knowledge and belief.

Name *J. A. Uhlen*  
 Position Administrative Supervisor  
 Company Continental Oil Company  
 Date October 2, 1973

I hereby certify that the well location shown on this plat was plotted from field notes of actual surveys made by me or under my supervision, and that the same is true and correct to the best of my knowledge and belief.

**PROFESSIONAL ENGINEER**  
**September, 1973**  
 Date Received \_\_\_\_\_  
 Registered Professional Engineer and/or Land Surveyor  
**JAMES P. LEESE**  
 1463  
 Certificate No. \_\_\_\_\_

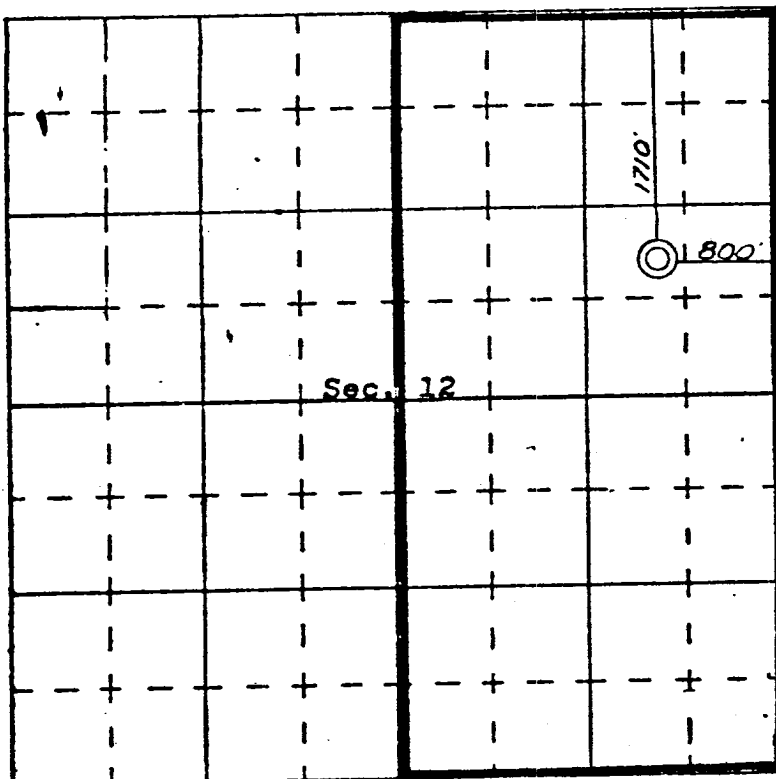

SCALE—4 INCHES EQUALS 1 MILE

SAN JUAN ENGINEERING COMPANY, FARMINGTON, N. M.

Form 9-1123

SUPERVISOR, OIL AND GAS OPERATIONS:

D E S I G N A T I O N O F O P E R A T O R

The undersigned is, on the records of the Bureau of Land Management,  
holder of Oil and Gas Lease

DISTRICT LAND OFFICE: Santa Fe, New Mexico  
SERIAL NUMBER: NM-10431

and hereby designated

NAME: Continental Oil Company  
P. O. Drawer 1267  
ADDRESS: Ponca City, Oklahoma

as his operator and local agent, with full authority to act in his behalf  
in complying with the terms of the lease and regulations applicable thereto  
and on whom the supervisor or his representative may serve written or oral  
instructions in securing compliance with the Oil and Gas Operating Regu-  
lations with respect to (describe acreage to which this designation is  
applicable):

T - 29 - N, R - 4 - W, NMPM

Section 12: E/2

Rio Arriba County, New Mexico

It is understood that this designation of operator does not relieve  
the lessee of responsibility for compliance with the terms of the lease  
and the Oil and Gas Operating Regulations. It is also understood that  
this designation of operator does not constitute an assignment of any  
interest in the lease.

In case of default on the part of the designated operator, the lessee  
will make full and prompt compliance with all regulations, lease terms, or  
orders of the Secretary of the Interior or his representative.

The lessee agrees promptly to notify the oil and gas supervisor of  
any change in the designated operator.

AZTEC OIL &amp; GAS COMPANY

ATTEST:

Naomi D. Langran  
Assistant Secretary

September 25, 1973

(Date)

By: Kenneth A. Swanson  
Vice President  
2000 First National Bank Building  
Dallas, Texas 75202

JES

Production Department

Western Hemisphere Petroleum Division  
Continental Oil Company  
152 North Durbin  
Casper, Wyoming 82601  
(307) 234-7311

October 3, 1973

Mr. Jerry W. Long (6) ✓  
District Engineer  
U. S. Geological Survey  
P.O. Box 1809  
Durango, Colorado 81301

Dear Mr. Long:

Development Plan for Surface Use  
Gas Well Drilling Program  
East San Juan Field  
Rio Arriba County, New Mexico  
File: PG-414-G7

Continental Oil Company plans development gas well drilling operations in the subject area, and the following "Development Plan For Surface Use" will apply to the following location:

Conoco 29-4 No. 5  
1710' FWH, 800' FWH  
Section 12, T29N, R4W

Development Plan For Surface Use

1. Existing roads and exit from main highway are shown on the attached topographic map. Access will be from New Mexico Highway No. 17, down the old Gas Buggy road to where an existing road branches off in Section 7 and passes near the well location in Section 12. This road has been previously used as access to Conoco 29-4 No. 1.
2. Access will be by existing roads with the exception of a lateral road to the well location. The proposed lateral road of approximately 200 yards will be constructed according to U. S. Forest Service specifications.
3. Conoco 29-4 No. 2 in SE NE of Section 11 is the nearest well to the proposed location.
4. Covered in Item No. 2.
5. No tank battery is planned at this time; however, if condensate production makes the setting of a tank necessary, it will be placed directly adjacent to the well and production will be trucked from the location as necessary. A gas sales line, if needed, will be installed under the master pipeline plan outlined by the U. S. Forest Service.

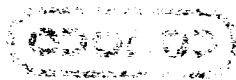

Western Hemisphere Petroleum Division  
U.S. Bureau of Mines  
Washington, D.C. 20540  
Telephone: 202-252-1400

Production Department

1960-1961

Mr. J. H. ...  
Director, ...  
U.S. ...  
Washington, D.C.

Dear Sir:

Enclosed for your information are ...  
The ...  
The ...  
The ...

Enclosed for your information are ...  
The ...  
The ...  
The ...

Very truly yours,  
[Signature]  
[Name]  
[Title]

Very truly yours,  
[Signature]

Enclosed for your information are ...  
The ...  
The ...  
The ...

Enclosed for your information are ...  
The ...  
The ...  
The ...

Enclosed for your information are ...  
The ...  
The ...  
The ...

Very truly yours,

Enclosed for your information are ...  
The ...  
The ...  
The ...

Mr. Jerry W. Long  
Page 2  
October 3, 1973

6. Water will be trucked from the Vaqueros water pit and, if needed, from the pond near the old Gas Buggy well location.
7. Contract for the drilling operations will obligate the contractor to keep the location and right-of-ways clean of debris at all times. A burn pit at the drillsite will be used to dispose of all burnable materials. All unburnable trash will be buried or hauled away to designated dumping areas. A pit toilet will be provided by the contractor for personnel use.
8. No camps will be constructed.
9. No airstrips are planned.
10. The attached Rig Layout plat indicates the general dimensions and location of the various components to be used in the drilling operation.
11. Topsoil will be stockpiled and used to reshape the location after operations are completed. Reseeding and reshaping the location will be subject to U. S. Forest Service specifications.
12. The location is situated on a slight rise, which will require a 3-6' cut to level the location. Vegetation consists of sagebrush, grass and a few small Juniper trees. Mr. B. E. Anderson, Production Superintendent for this area, may be reached by phone at Farmington, New Mexico, No. 325-1168, or by radio through Ute Communications, Cortez, Colorado, No. 303-365-7210.

Very truly yours,

Original Signed By:  
J. A. UBBEN

J. A. Ubben  
Administrative Supervisor

bjs  
att.

CC: Mr. Larry A. Seehlig  
District Forest Ranger  
Gobernador District  
Blanco, New Mexico 87412

the 1990s, the number of people in the world who are illiterate has increased from 1.2 billion to 1.5 billion. The number of illiterate people in the world is projected to reach 1.7 billion by the year 2015. The number of illiterate people in the world is projected to reach 1.7 billion by the year 2015.

On 10/1/1964, the following information was received from the  
U.S. Navy, Naval Air Station, Alameda, California, regarding the  
status of the aircraft carrier USS Intrepid (CV-11) and the  
USS Yorktown (CV-5) which were scheduled to be in the  
San Francisco Bay area on 10/1/1964. The USS Intrepid was  
scheduled to arrive in the San Francisco Bay area on 10/1/1964  
and the USS Yorktown was scheduled to arrive in the San Francisco  
Bay area on 10/2/1964. The USS Intrepid was scheduled to  
depart the San Francisco Bay area on 10/3/1964 and the USS Yorktown  
was scheduled to depart the San Francisco Bay area on 10/4/1964.

[illegible][illegible]

1992. *Journal of the American Statistical Association*, 87, 103-113.

10. 在 2008 年 12 月 31 日，A 公司应计提的坏账准备为 100 元。

[illegible]

1. *Phragmites australis* (Cav.) Trin. ex Steud.

10

100

...and the ...

● ● ● ● ●

*Journal of Management Studies*, 19(6), 701-718.

[illegible]

...and the

1997, 1998, 1999, 2000, 2001, 2002, 2003, 2004, 2005, 2006, 2007, 2008, 2009, 2010, 2011, 2012, 2013, 2014, 2015, 2016, 2017, 2018, 2019, 2020, 2021, 2022, 2023, 2024, 2025, 2026, 2027, 2028, 2029, 2030, 2031, 2032, 2033, 2034, 2035, 2036, 2037, 2038, 2039, 2040, 2041, 2042, 2043, 2044, 2045, 2046, 2047, 2048, 2049, 2050, 2051, 2052, 2053, 2054, 2055, 2056, 2057, 2058, 2059, 2060, 2061, 2062, 2063, 2064, 2065, 2066, 2067, 2068, 2069, 2070, 2071, 2072, 2073, 2074, 2075, 2076, 2077, 2078, 2079, 2080, 2081, 2082, 2083, 2084, 2085, 2086, 2087, 2088, 2089, 2090, 2091, 2092, 2093, 2094, 2095, 2096, 2097, 2098, 2099, 2100, 2101, 2102, 2103, 2104, 2105, 2106, 2107, 2108, 2109, 2110, 2111, 2112, 2113, 2114, 2115, 2116, 2117, 2118, 2119, 2120, 2121, 2122, 2123, 2124, 2125, 2126, 2127, 2128, 2129, 2130, 2131, 2132, 2133, 2134, 2135, 2136, 2137, 2138, 2139, 2140, 2141, 2142, 2143, 2144, 2145, 2146, 2147, 2148, 2149, 2150, 2151, 2152, 2153, 2154, 2155, 2156, 2157, 2158, 2159, 2160, 2161, 2162, 2163, 2164, 2165, 2166, 2167, 2168, 2169, 2170, 2171, 2172, 2173, 2174, 2175, 2176, 2177, 2178, 2179, 2180, 2181, 2182, 2183, 2184, 2185, 2186, 2187, 2188, 2189, 2190, 2191, 2192, 2193, 2194, 2195, 2196, 2197, 2198, 2199, 2200, 2201, 2202, 2203, 2204, 2205, 2206, 2207, 2208, 2209, 2210, 2211, 2212, 2213, 2214, 2215, 2216, 2217, 2218, 2219, 2220, 2221, 2222, 2223, 2224, 2225, 2226, 2227, 2228, 2229, 2230, 2231, 2232, 2233, 2234, 2235, 2236, 2237, 2238, 2239, 2240, 2241, 2242, 2243, 2244, 2245, 2246, 2247, 2248, 2249, 2250, 2251, 2252, 2253, 2254, 2255, 2256, 2257, 2258, 2259, 2260, 2261, 2262, 2263, 2264, 2265, 2266, 2267, 2268, 2269, 2270, 2271, 2272, 2273, 2274, 2275, 2276, 2277, 2278, 2279, 2280, 2281, 2282, 2283, 2284, 2285, 2286, 2287, 2288, 2289, 2290, 2291, 2292, 2293, 2294, 2295, 2296, 2297, 2298, 2299, 2300, 2301, 2302, 2303, 2304, 2305, 2306, 2307, 2308, 2309, 2310, 2311, 2312, 2313, 2314, 2315, 2316, 2317, 2318, 2319, 2320, 2321, 2322, 2323, 2324, 2325, 2326, 2327, 2328, 2329, 2330, 2331, 2332, 2333, 2334, 2335, 2336, 2337, 2338, 2339, 2340, 2341, 2342, 2343, 2344, 2345, 2346, 2347, 2348, 2349, 2350, 2351, 2352, 2353, 2354, 2355, 2356, 2357, 2358, 2359, 2360, 2361, 2362, 2363, 2364, 2365, 2366, 2367, 2368, 2369, 2370, 2371, 2372, 2373, 2374, 2375, 2376, 2377, 2378, 2379, 2380, 2381, 2382, 2383, 2384, 2385, 2386, 2387, 2388, 2389, 2390, 2391, 2392, 2393, 2394, 2395, 2396, 2397, 2398, 2399, 2400, 2401, 2402, 2403, 2404, 2405, 2406, 2407, 2408, 2409, 2410, 2411, 2412, 2413, 2414, 2415, 2416, 2417, 2418, 2419, 2420, 2421, 2422, 2423, 2424, 2425, 2426, 2427, 2428, 2429, 2430, 2431, 2432, 2433, 2434, 2435, 2436, 2437, 2438, 2439, 2440, 2441, 2442, 2443, 2444, 2445, 2446, 2447, 2448, 2449, 2450, 2451, 2452, 2453, 2454, 2455, 2456, 2457, 2458, 2459, 2460, 2461, 2462, 2463, 2464, 2465, 2466, 2467, 2468, 2469, 2470, 2471, 2472, 2473, 2474, 2475, 2476, 2477, 2478, 2479, 2480, 2481, 2482, 2483, 2484, 2485, 2486, 2487, 2488, 2489, 2490, 2491, 2492, 2493, 2494, 2495, 2496, 2497, 2498, 2499, 2500, 2501, 2502, 2503, 2504, 2505, 2506, 2507, 2508, 2509, 2510, 2511, 2512, 2513, 2514, 2515, 2516, 2517, 2518, 2519, 2520, 2521, 2522, 2523, 2524, 2525, 2526, 2527, 2528, 2529, 2530, 2531, 2532, 2533, 2534, 2535, 2536, 2537, 2538, 2539, 2540, 2541, 2542, 2543, 2544, 2545, 2546, 2547, 2548, 2549, 2550, 2551, 2552, 2553, 2554, 2555, 2556, 2557, 2558, 2559, 2560, 2561, 2562, 2563, 2564, 2565, 2566, 2567, 2568, 2569, 2570, 2571, 2572, 2573, 2574, 2575, 2576, 2577, 2578, 2579, 2580, 2581, 2582, 2583, 2584, 2585, 2586, 2587, 2588, 2589, 2590, 2591, 2592, 2593, 2594, 2595, 2596, 2597, 2598, 2599, 2600, 2601, 2602, 2603, 2604, 2605, 2606, 2607, 2608, 2609, 2610, 2611, 2612, 2613, 2614, 2615, 2616, 2617, 2618, 2619, 2620, 2621, 2622, 2623, 2624, 2625, 2626, 2627, 2628, 2629, 2630, 2631, 2632, 2633, 2634, 2635, 2636, 2637, 2638, 2639, 2640, 2641, 2642, 2643, 2644, 2645, 2646, 2647, 2648, 2649, 2650, 2651, 2652, 2653, 2654, 2655, 2656, 2657, 2658, 2659, 2660, 2661, 2662, 2663, 2664, 2665, 2666, 2667, 2668, 2669, 2670, 2671, 2672, 2673, 2674, 2675, 2676, 2677, 2678, 26

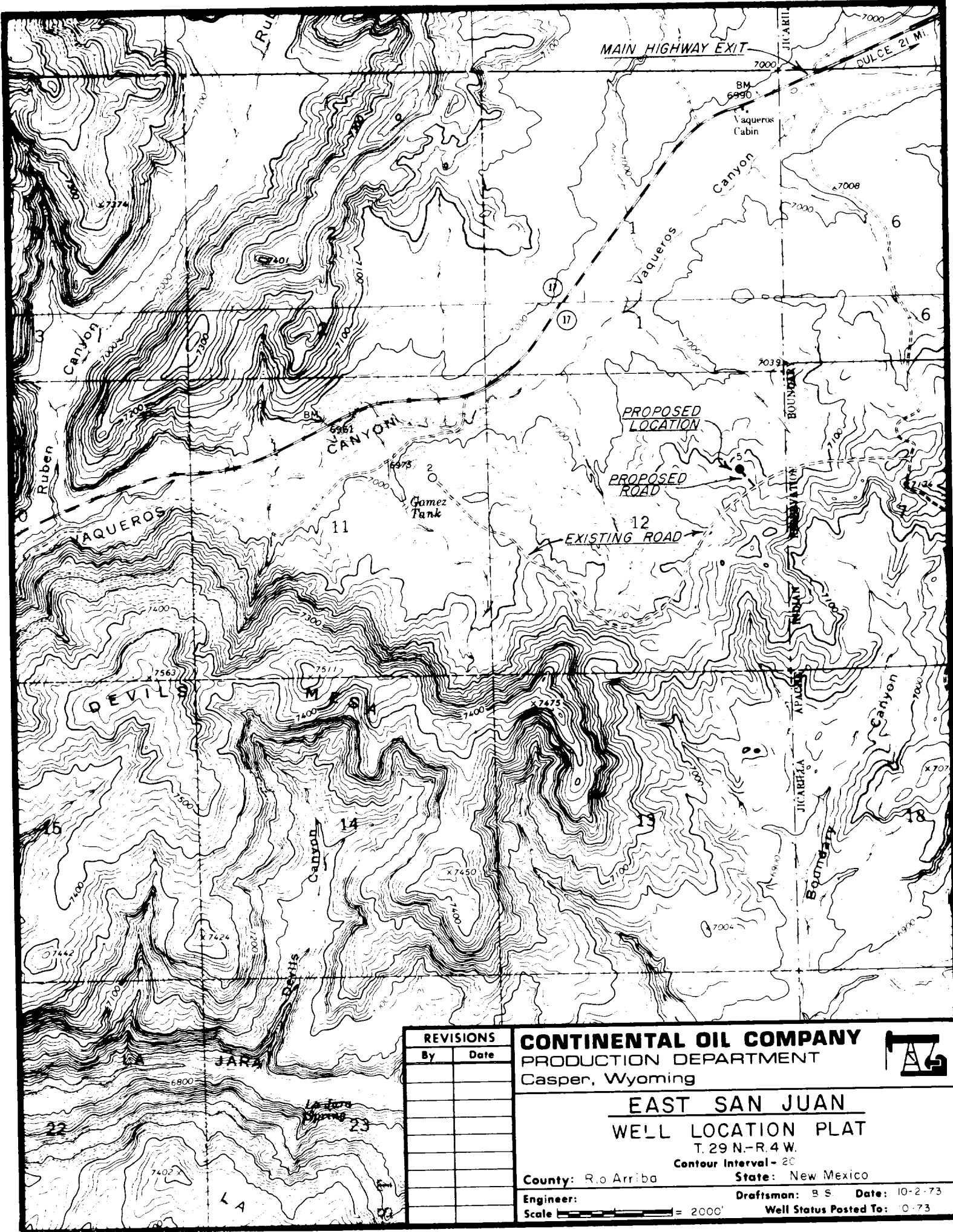

REVISIONS	
By	Date

**CONTINENTAL OIL COMPANY**  
PRODUCTION DEPARTMENT  
Casper, Wyoming



**EAST SAN JUAN**  
**WELL LOCATION PLAT**  
T. 29 N.-R. 4 W.  
Contour Interval - 20'

County: R. o Arriba

State: New Mexico

Engineer:

Draftsman: B S Date: 10-2-73

Scale: = 2000'

Well Status Posted To: 0-73



T  
29  
N

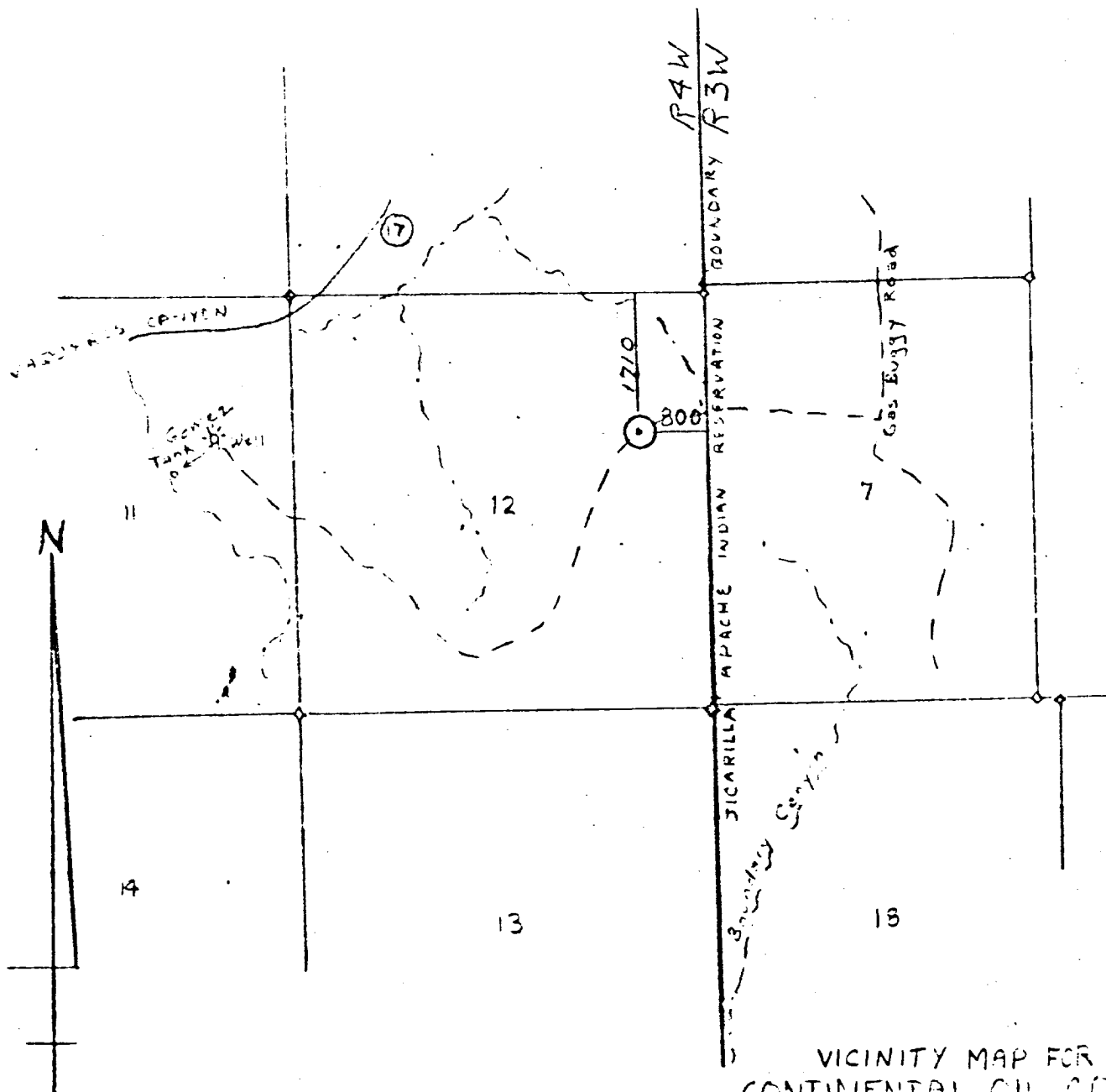

VICINITY MAP FOR  
CONTINENTAL OIL CO.  
SHOWING

well location in NE/4 of Sec 12  
T29N, R4W, N.M. P.M. Rio

Arriba County, New Mexico

Scale 1"=2000

Date: 26 Sept. 1973

by T. C. Forrester, Geologist - Firmington, U.M.

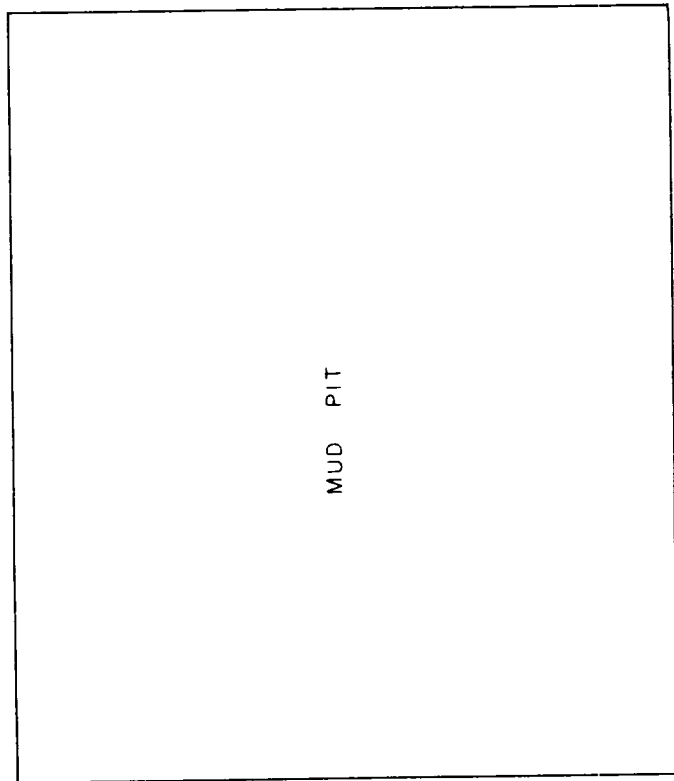
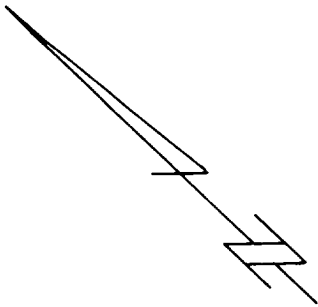

MUD PIT

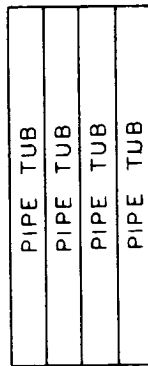

PIPE TUB  
PIPE TUB  
PIPE TUB  
PIPE TUB

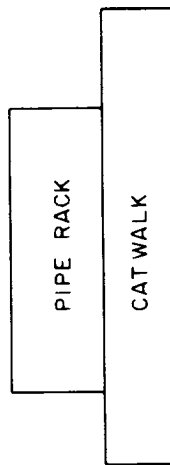

PIPE RACK

CAT WALK

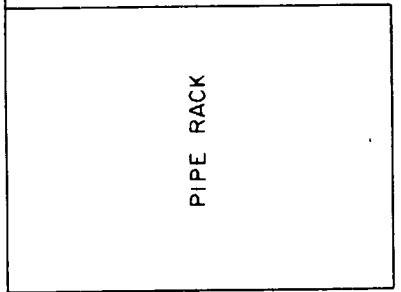

PIPE RACK



SUB BASE

WATER TANK

WELL



SUB BASE

CHANGE HOUSE



DOG HOUSE

NOTE  
200' x 400'  
Parking area for  
frac. trucks located  
on East side of  
drill site. →

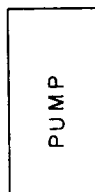

PUMP

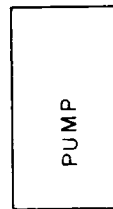

PUMP

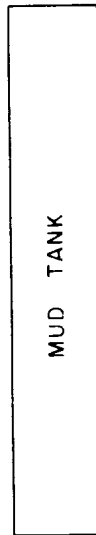

MUD TANK

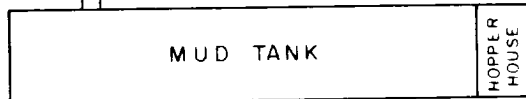

MUD TANK

HOPPER HOUSE



GEN.

ACC.

APPROX. RIG SITE DIMENSIONS  
160' x 200'

**CONTINENTAL OIL COMPANY**  
PRODUCTION DEPARTMENT  
Casper, Wyoming



RIG LAYOUT

Engineer: K.W. McDaniel

Draftsman: BS

Date: 10-2-73