

UNITED STATES
DEPARTMENT OF THE INTERIOR
GEOLOGICAL SURVEY

APPLICATION FOR PERMIT TO DRILL, DEEPEN, OR PLUG BACK

1a. TYPE OF WORK DRILL ☒ DEEPEN ☐ PLUG BACK ☐

b. TYPE OF WELL OIL WELL ☐ GAS WELL ☒ OTHER ☐ SINGLE ZONE ☒ MULTIPLE ZONE ☐

2. NAME OF OPERATOR
El Paso Natural Gas Company

3. ADDRESS OF OPERATOR
PO Box 990, Farmington, NM 87401

4. LOCATION OF WELL (Report location clearly and in accordance with any State requirements.)*
At surface 800'S, 990'W

At proposed prod. zone

14. DISTANCE IN MILES AND DIRECTION FROM NEAREST TOWN OR POST OFFICE*

15. DISTANCE FROM PROPOSED*
LOCATION TO NEAREST
PROPERTY OR LEASE LINE, FT.
(Also to nearest drig. unit line, if any)

18. DISTANCE FROM PROPOSED LOCATION*
TO NEAREST WELL, DRILLING, COMPLETED,
OR APPLIED FOR, ON THIS LEASE, FT.

21. ELEVATIONS (Show whether DF, RT, GR, etc.)

will be reported later.

16. NO. OF ACRES IN LEASE

19. PROPOSED DEPTH

7800'

17. NO. OF ACRES ASSIGNED
TO THIS WELL

320.00

20. ROTARY OR CABLE TOOLS

Rotary

22. APPROX. DATE WORK WILL START*

23. PROPOSED CASING AND CEMENTING PROGRAM

SIZE OF HOLE	SIZE OF CASING	WEIGHT PER FOOT	SETTING DEPTH	QUANTITY OF CEMENT
13 3/4"	9 5/8"	32.3#	200'	225 cu. ft. circulate
8 3/4"	7"	20.0#	3500'	220 cu. ft. cover Ojo Alamo
6 1/4"	4 1/2"	10.5&11.6#	7800'	640 cu. ft. fill to 3500'

Selectively perforate and sandwater fracture the Dakota formation.

The S/2 of Section 31 is dedicated to this well.

RECEIVED
DEC 21 1971
OIL CON. COM.
DIST. 3

U. S. GEOLOGICAL SURVEY
DURANGO, COLO.

IN ABOVE SPACE DESCRIBE PROPOSED PROGRAM: If proposal is to deepen or plug back, give data on present productive zone and proposed new productive zone. If proposal is to drill or deepen directionally, give pertinent data on subsurface locations and measured and true vertical depths. Give blowout preventer program, if any.

24. Original Signed F. H. WOOD

SIGNED

TITLE Petroleum Engineer

DATE December 20, 1971

(This space for Federal or State office use)

PERMIT NO.

APPROVAL DATE

APPROVED BY

TITLE

DATE

CONDITIONS OF APPROVAL, IF ANY:

NEW MEXICO OIL CONSERVATION COMMISSION
WELL LOCATION AND ACREAGE DEDICATION PLAT

EL PASO NATURAL GAS COMPANY

SAN JUAN 29-6 UNIT (NM-03040-A)

106

N

31

29-N

6-W

RIO ARriba

800

SOUTH

990

WEST

DAKOTA

BASIN DAKOTA

320.00

1. Outline the acreage dedicated to the subject well by colored pen or machine marks on the plat.
2. If more than one lease is dedicated to the well, outline each and identify the ownership, term, and interest.
3. If more than one lease of different ownership is dedicated to the well, have the interests dated by communitization, unitization, force pooling, etc.

X

No

If answer is "yes," type of communitization

Unitization

If answer is "no," list the owners and tract descriptions which have actually been communitized on this form if necessary.

No allowable will be assigned to the well until all interests have been communitized or unitized or force pooled, or otherwise for unit or non-unitized tract, and having such interests, has been approved by the Commission.

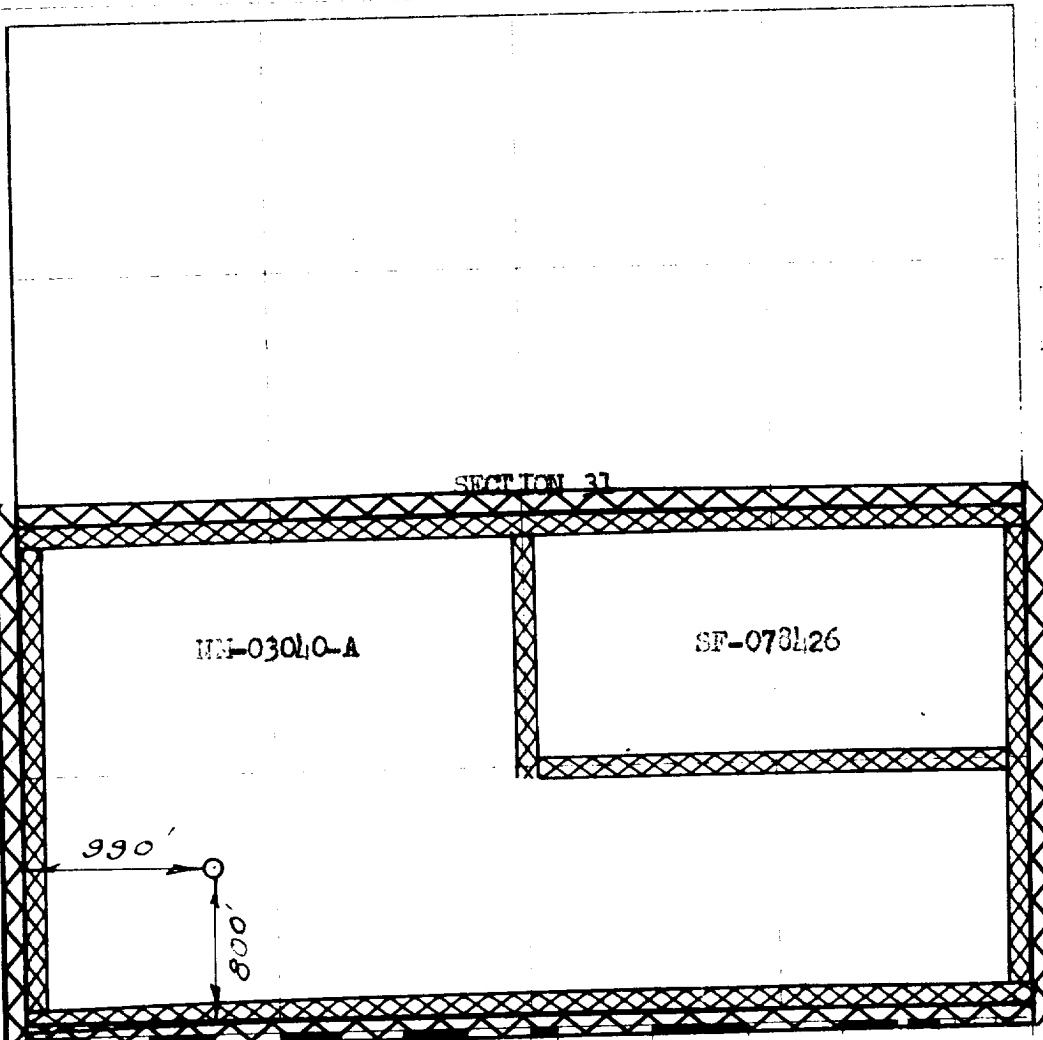

Original Signed F. H. WOOD

Petroleum Engineer

El Paso Natural Gas Co.

December 20, 1971

NOVEMBER 29, 1971

Paul Wilson
1760

UNITED STATES
DEPARTMENT OF THE INTERIOR
GEOLOGICAL SURVEYSUBMIT IN TRIPLICATE*
(Other instructions on re-
verse side)Form approved.
Budget Bureau No. 42 R1424

SUNDRY NOTICES AND REPORTS ON WELLS

(Do not use this form for proposals to drill or to deepen or plug back to a different reservoir.
Use "APPLICATION FOR PERMIT—" for such proposals.)

1. OIL WELL <input type="checkbox"/> GAS WELL <input checked="" type="checkbox"/> OTHER <input type="checkbox"/>		5. LEASE DESIGNATION AND SERIAL NO. NM 03040-A	
2. NAME OF OPERATOR El Paso Natural Gas Company		6. IF INDIAN, ALLOTTEE OR TRIBE NAME	
3. ADDRESS OF OPERATOR PO Box 990, Farmington, New Mexico 87401		7. UNIT AGREEMENT NAME San Juan 29-6 Unit	
4. LOCATION OF WELL (Report location clearly and in accordance with any State requirements.* See also space 17 below.) At surface 800'S, 990'W		8. FARM OR LEASE NAME San Juan 29-6 Unit	
14. PERMIT NO.		9. WELL NO. 106	
15. ELEVATIONS (Show whether LF, RT, GR, etc.) 6822'GL		10. FIELD AND POOL, OR WILDCAT Basin Dakota	
		11. SEC., T., R., M., OR BLK. AND SURVEY OR AREA Sec. 31, T-29-N, R-6-W NMPM	
		12. COUNTY OR PARISH Rio Arriba	
		13. STATE New Mexico	
16. Check Appropriate Box To Indicate Nature of Notice, Report, or Other Data			
NOTICE OF INTENTION TO:		SUBSEQUENT REPORT OF:	
TEST WATER SHUT-OFF <input type="checkbox"/>	PULL OR ALTER CASING <input type="checkbox"/>	WATER SHUT-OFF <input type="checkbox"/>	REPAIRING WELL <input type="checkbox"/>
FRACTURE TREAT <input type="checkbox"/>	MULTIPLE COMPLETE <input type="checkbox"/>	FRACTURE TREATMENT <input type="checkbox"/>	ALTERING CASING <input type="checkbox"/>
SHOOT OR ACIDIZE <input type="checkbox"/>	ABANDON* <input type="checkbox"/>	SHOOTING OR ACIDIZING <input type="checkbox"/>	ABANDONMENT* <input type="checkbox"/>
REPAIR WELL <input type="checkbox"/>	CHANGE PLANS <input type="checkbox"/>	(Other) <input type="checkbox"/>	Report Elevation <input checked="" type="checkbox"/>
(Other) <input type="checkbox"/>		(NOTE: Report results of multiple completion on Well Completion or Recompletion Report and Log form.)	
17. DESCRIBE PROPOSED OR COMPLETED OPERATIONS (Clearly state all pertinent details, and give pertinent dates, including estimated date of starting any proposed work. If well is directionally drilled, give subsurface locations and measured and true vertical depths for all markers and zones pertinent to this work.)*			

RECEIVED

FEB 3 1972

U. S. GEOLOGICAL SURVEY
DURANGO, COLO.OIL COAL COAL
DIST. 3

18. I hereby certify that the foregoing is true and correct

SIGNED Original Signed F. H. WOOD

TITLE: Petroleum Engineer

DATE February 1, 1972

(This space for Federal or State office use)

APPROVED BY
CONDITIONS OF APPROVAL, IF ANY:

TITLE:

DATE:

*See Instructions on Reverse Side

Mod.

Dec. 22, 1977

30-059-20452

F. Loc. 800/S; 990/W Elev. 6822 G-L Spd. _____ Comp. _____ TD _____ PB _____

Casing S. _____ @ _____ W _____ Sx. Int. _____ @ _____ W _____ Sx. Pr. _____ @ _____ W _____ Sx. T. _____ @ _____
Csg. Perf. _____ Prod. Stim. _____

TRANS

I.P. _____ BO/D _____ MCF/D After _____ Hrs. SICP _____ PSI After _____ Days GOR _____ Grav. _____ 1st Del. _____ s _____

TOPS		NITD	Well Log	TEST DATA							Ref.No.
Kirtland		C-103	Plot	Schd.	PC	Q	PW	PD	D		
Fruitland		C-104	Electric Log								
Pictured Cliffs			C-122								
Cliff House		Ditr	Dfa								
Menefee		Datr	Dac								
Point Lookout		<div style="text-align: center;"> <p><i>Abandoned</i> <i>See per Report</i> <i>Received 11-18-74</i></p> </div>									
Mancos											
Gallup											
Sanostee											
Greenhorn											
Dakota											
Morrison											
Entrada											
			S 320								

P
o
Basin Dax. Co. 30 S 31 T 29N R 6W U.M. Oper. EPNG C. Lse. San Juan 29-6 Unit No. 106

UNITED STATES
DEPARTMENT OF THE INTERIOR
GEOLOGICAL SURVEYSUBMIT IN TRIPPLICATE*
(other instructions on re-
verse side)Form approved.
Budget Bureau No. 42-R1424

5. LEASE DESIGNATION AND SERIAL NO.

NM03040-A

6. IF INDIAN, ALLOTTEE OR TRIBE NAME

SUNDRY NOTICES AND REPORTS ON WELLS

(Do not use this form for proposals to drill or to deepen or plug back to a different reservoir.
Use "APPLICATION FOR PERMIT--" for such proposals.)

1. <input type="checkbox"/> OIL WELL <input type="checkbox"/> GAS WELL <input type="checkbox"/> OTHER		7. UNIT AGREEMENT NAME San Juan 29-6 Unit
2. NAME OF OPERATOR El Paso Natural Gas Company		8. FARM OR LEASE NAME San Juan 29-6 Unit
3. ADDRESS OF OPERATOR P. O. Box 990, Farmington, NM 87401		9. WELL NO. 106
4. LOCATION OF WELL (Report location clearly and in accordance with any State requirements.* See also space 17 below.) At surface 800'S, 990'W		10. FIELD AND POOL, OR WILDCAT Basin Dakota
14. PERMIT NO.		11. SEC. T., R., M., OR BLK. AND SURVEY OR AREA Sec. 31, T-29-N, R-6-W N.M.P.M.
15. ELEVATIONS (Show whether DF, RT, GR, etc.) 6822' GL		12. COUNTY OR PARISH Rio Arriba
		13. STATE New Mexico

16. Check Appropriate Box To Indicate Nature of Notice, Report, or Other Data

NOTICE OF INTENTION TO:

TEST WATER SHUT-OFF

FRACTURE TREAT

SHOOT OR ACIDIZE

REPAIR WELL

(Other)

PULL OR ALTER CASING

MULTIPLE COMPLETE

ABANDON*

CHANGE PLANS

SUBSEQUENT REPORT OF:

WATER SHUT-OFF

FRACTURE TREATMENT

SHOOTING OR ACIDIZING

(Other)

REPAIRING WELL

ALTERING CASING

ABANDONMENT*

(NOTE: Report results of multiple completion on Well Completion or Recompletion Report and Log form.)

17. DESCRIBE PROMISED OR COMPLETED OPERATIONS. (Clearly state all pertinent details, and give pertinent dates, including estimated date of starting any proposed work. If well is directionally drilled, give subsurface locations and measured and true vertical depths for all markers and zones pertinent to this work.)*

The San Juan 29-6 Unit was acquired by Northwest Pipeline Corporation under the Divestiture Decree effective February 1, 1974, therefore, El Paso Natural Gas Company has abandoned this location.

18. I hereby certify that the foregoing is true and correct

SIGNED J. P. BriscoeTITLE Drilling ClerkDATE November 5, 1974

(This space for Federal or State office use)

APPROVED BY _____

TITLE _____

DATE _____

CONDITIONS OF APPROVAL, IF ANY:

*See Instructions on Reverse Side