

UNITED STATES
DEPARTMENT OF THE INTERIOR
GEOLOGICAL SURVEY

30-039-21088

APPLICATION FOR PERMIT TO DRILL, DEEPEN, OR PLUG BACK

1a. TYPE OF WORK

DRILL ☒DEEPEN ☐PLUG BACK ☐

b. TYPE OF WELL

OIL
WELL ☐GAS
WELL ☒

OTHER

SINGLE
ZONE ☒MULTIPLE
ZONE ☐

2. NAME OF OPERATOR

Northwest Pipeline Corporation

3. ADDRESS OF OPERATOR

P.O. Box 90 Farmington, New Mexico 87401

4. LOCATION OF WELL (Report location clearly and in accordance with any State requirements.)

At surface

800' FNL & 1140' FWL

At proposed prod. zone

14. DISTANCE IN MILES AND DIRECTION FROM NEAREST TOWN OR POST OFFICE*

20 Miles East Blanco, New Mexico

15. DISTANCE FROM PROPOSED*
LOCATION TO NEAREST
PROPERTY OR LEASE LINE, FT.
(Also to nearest drilg. unit line, if any)

16. NO. OF ACRES IN LEASE

17. NO. OF ACRES ASSIGNED
TO THIS WELL

320

18. DISTANCE FROM PROPOSED LOCATION*
TO NEAREST WELL, DRILLING, COMPLETED,
OR APPLIED FOR, ON THIS LEASE, FT.

19. PROPOSED DEPTH

5960

20. ROTARY OR CABLE TOOLS

Rotary

21. ELEVATIONS (Show whether DF, RT, GR, etc.)

6689 GR

22. APPROX. DATE WORK WILL START*

June 30, 1975

23.

PROPOSED CASING AND CEMENTING PROGRAM

SIZE OF HOLE	SIZE OF CASING	WEIGHT PER FOOT	SETTING DEPTH	QUANTITY OF CEMENT
13-3/4	9-5/8	32.3	200	180 sx circ
8-3/4	7	20	3875	165 sx
6-1/4	4-1/2" liner	10.5	5960	215 sx

Selectively perforate and stimulate the Mesa Verde formation.

A BOP will be installed after the surface casing is set and cemented.
All subsequent work will be conducted through the BOP.

The W/2 of Section 31 is dedicated to this well.

IN ABOVE SPACE DESCRIBE PROPOSED PROGRAM: If proposal is to deepen or plug back, give data on present productive zone and proposed new productive zone. If proposal is to drill or deepen directionally, give pertinent data on subsurface locations and measured and true vertical depths. Give blowout preventer program, if any.

24.

SIGNED

O. B. Whitenburg
(This space for Federal or State office use)

TITLE Sr. Drilling Engineer

DATE 5-7-75

PERMIT NO.

APPROVAL DATE

APPROVED BY

TITLE

DATE

CONDITIONS OF APPROVAL, IF ANY:

*See Instructions On Reverse Side

**NEW MEXICO OIL CONSERVATION COMMISSION
WELL LOCATION AND ACREAGE DEDICATION PLAT**

Form C-102
Supersedes C-128
Effective 1-1-65

All distances must be from the outer boundaries of the Section.

Operator Northwest Pipeline Corporation			Lease San Juan 29-6 Unit		Well No. 51A
Unit Letter D	Section 31	Township 29N	Range 6W	County Rio Arriba	
Actual Footage Location of Well: 800 feet from the North line and 1140 feet from the West line					
Ground Level Elev. 6689	Producing Formation Mesa Verde		Pool Blanco Mesa Verde		Dedicated Acreage 320 Acres

1. Outline the acreage dedicated to the subject well by colored pencil or hachure marks on the plat below.
2. If more than one lease is dedicated to the well, outline each and identify the ownership thereof (both as to working interest and royalty).
3. If more than one lease of different ownership is dedicated to the well, have the interests of all owners been consolidated by communitization, unitization, force-pooling, etc?

☐ Yes ☒ No If answer is "yes," type of consolidation _____

If answer is "no," list the owners and tract descriptions which have actually been consolidated. (Use reverse side of this form if necessary.) NW/4, NW/4, Sec 31, T29N, R6W

No allowable will be assigned to the well until all interests have been consolidated (by communitization, unitization, forced-pooling, or otherwise) or until a non-standard unit, eliminating such interests, has been approved by the Commission.

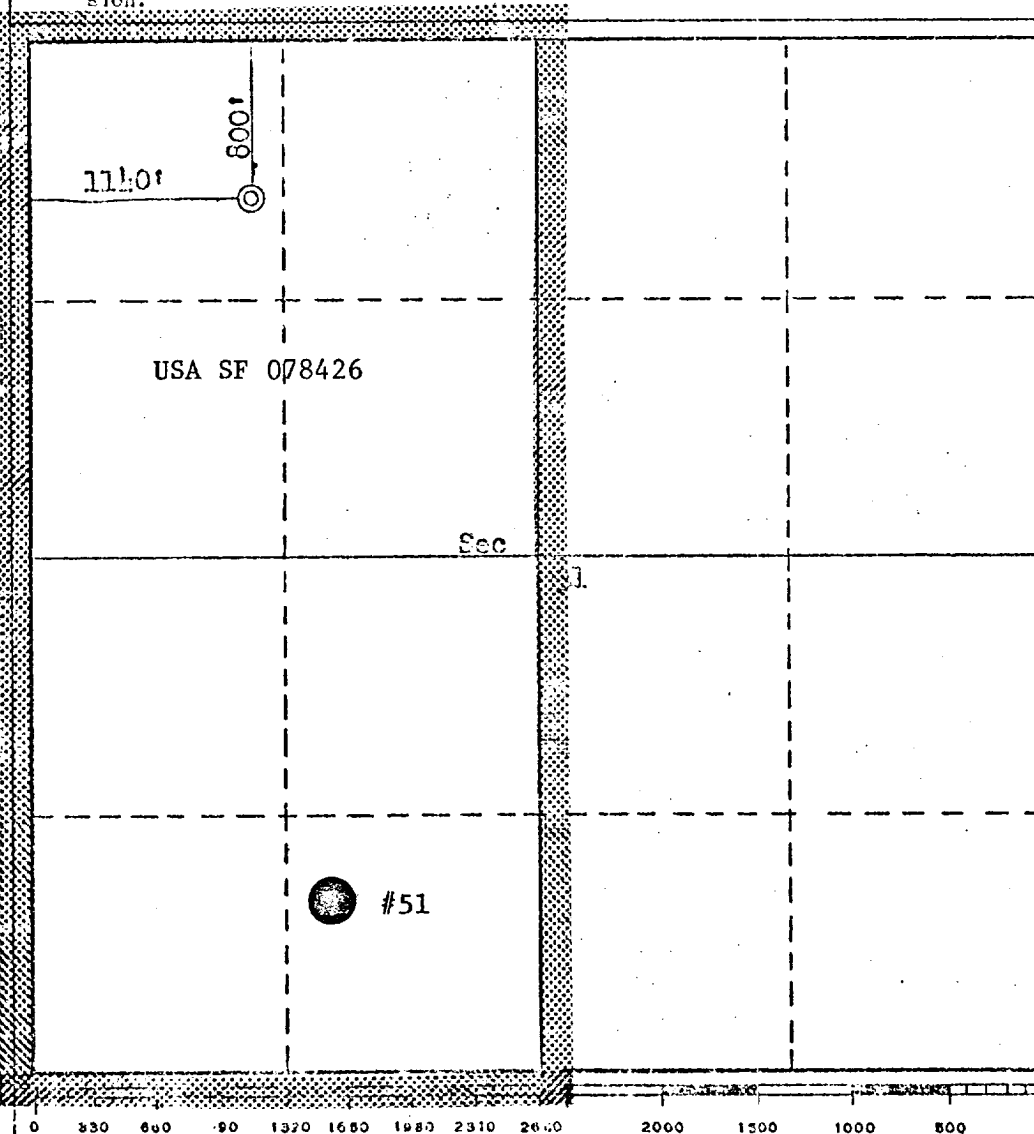
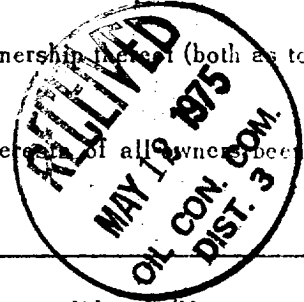

CERTIFICATION

I hereby certify that the information contained herein is true and complete to the best of my knowledge and belief.

O.B. Whitenburg
 Name
O.B. Whitenburg js
 Position
Sr. Drilling Engineer
 Company
Northwest Pipeline Corp.
 Date
May 7, 1975

I hereby certify that the well location shown on this plat was plotted from field notes of actual surveys made by me or under my supervision, and that the same is true and correct to the best of my knowledge and belief.

Date Surveyed
April 18, 1975
 Registered Professional Engineer and/or Land Surveyor's
Fred B. Korr Jr.
Fred B. Korr Jr.

Certificate No.
3950

0 330 660 990 1320 1650 1980 2310 2640 2970 3300 3630 3960 4290 4620 4950 5280 5610 5940 6270 6600

Northwest Pipeline Corporation



PRODUCTION & DRILLING
P. O. BOX 90
FARMINGTON, NEW MEXICO 87401

May 7, 1975

United States Geological Survey
P.O. Box 1809
Durango, Colorado 81301

Re: Application for "Permit to Drill"
San Juan 29-6 Unit #51A
NW/4 Sec 31, T29N,R6W
Rio Arriba County, New Mexico

Gentlemen:

Information regarding existing roads, pipelines, flowlines, etc., relative to the above well location are included on the enclosed attachments.

Water for drilling and completion operations will be obtained from the San Juan 29-6 Water well #1 located in the NW/4 SW/4 Sec 28,T29N,R6W.

Waste disposal will be in the burn pit, latrine or reserve pit. There will be no camp or airstrip associated with drilling this well. Upon completion or abandonment of this well the location will be cleaned, leveled and a dry hole marker placed if applicable.

Sincerely,

A handwritten signature in cursive script, appearing to read "O.B. Whitenburg".

O.B. Whitenburg
Northwest Pipeline Corporation
Senior Production & Drilling Engineer

OBW/js

San Juan 29-6 Unit #51A

GOULD PASS QUADRANGLE
NEW MEXICO
15 MINUTE SERIES (TOPOGRAPHIC)

1240

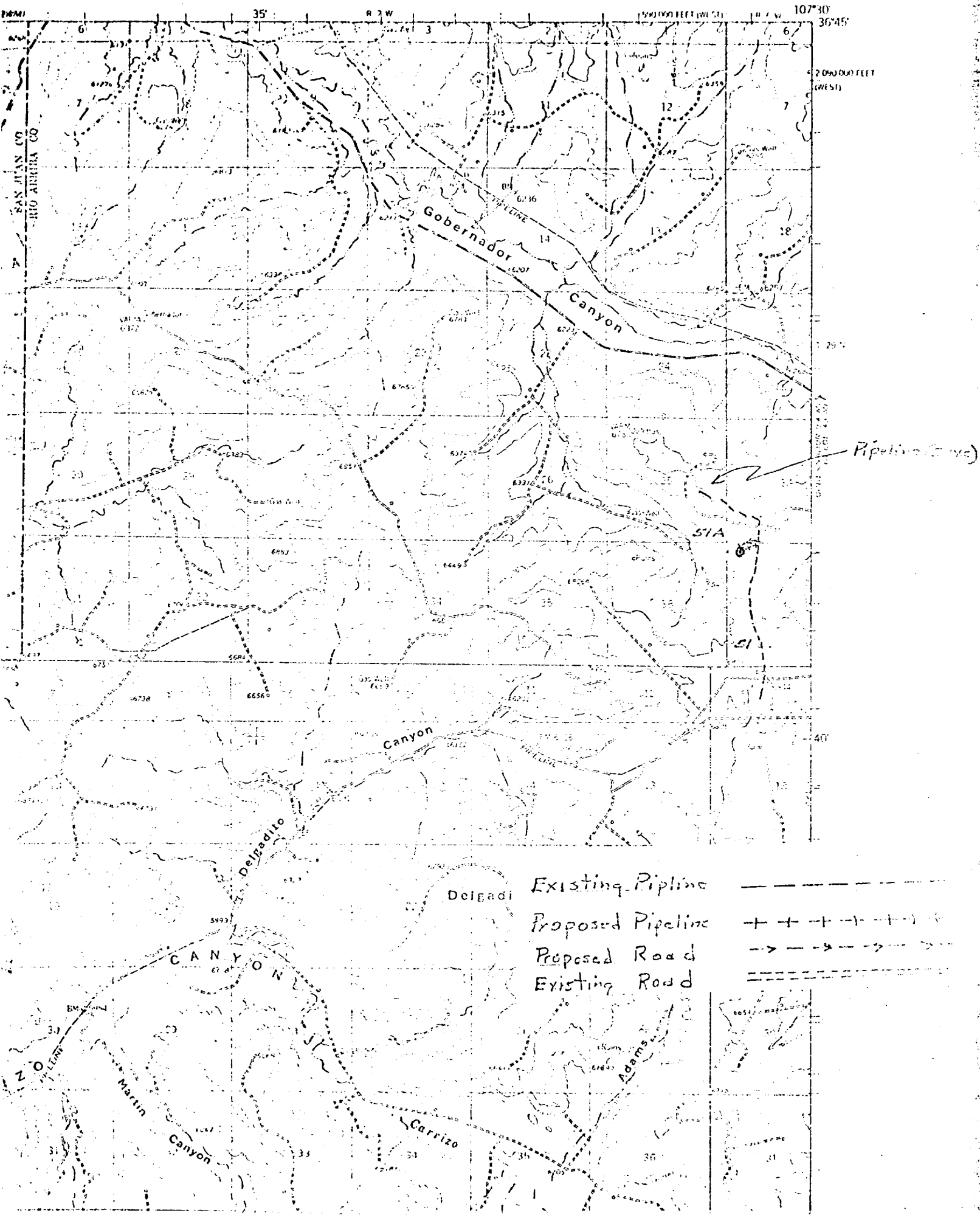

LOCATION AND EQUIPMENT LAYOUT

San Juan 29-6 Unit # 51A

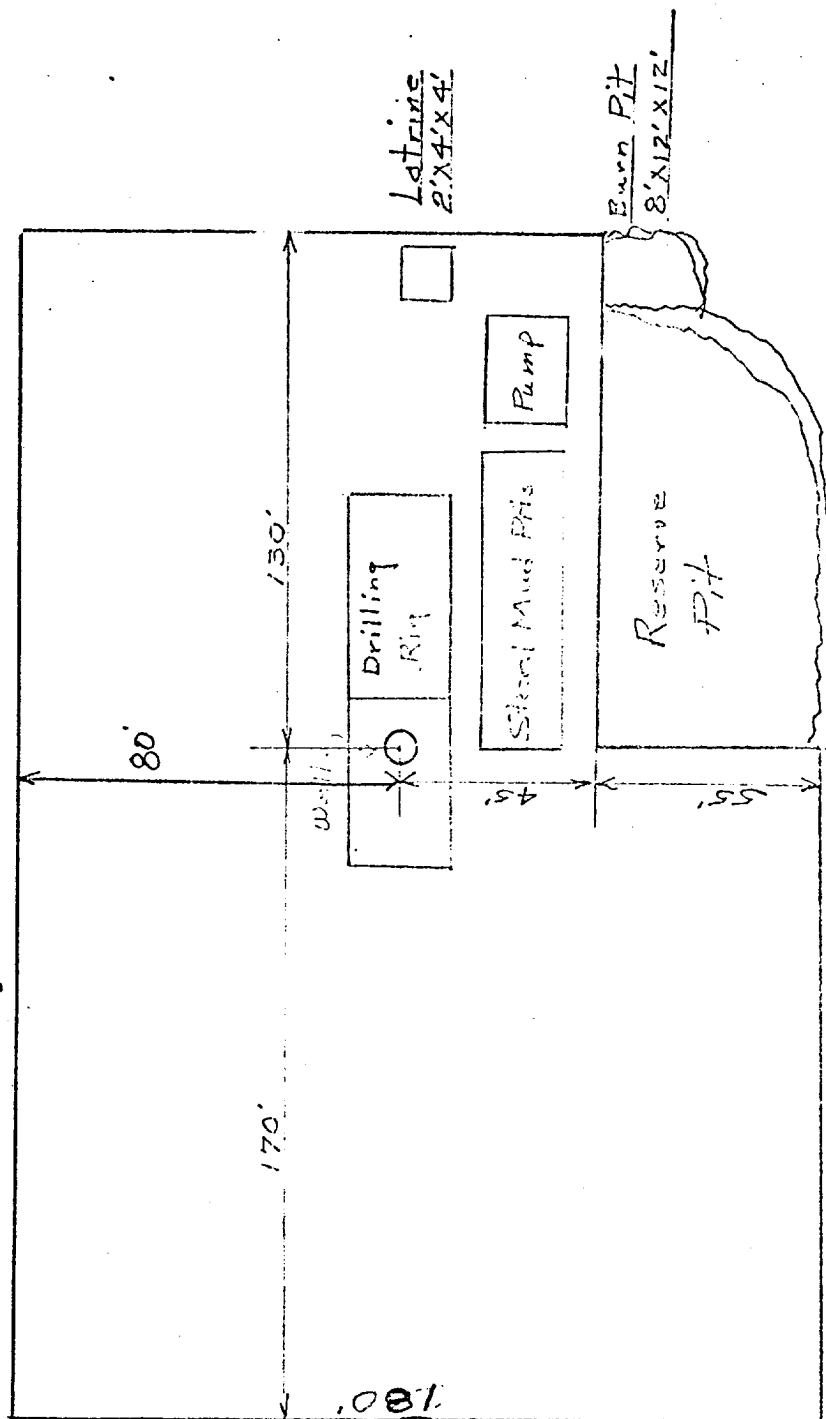

Note: This Location size was reduced due to some ruins to the East of the well site.