

NO. OF COPIES RECEIVED	6
DISTRIBUTION	
SANTA FE	1
FILE	1
U.S.G.S.	2
LAND OFFICE	1
OPERATOR	1

# NEW MEXICO OIL CONSERVATION COMMISSION

30-039-21092

Form C-101  
Revised 1-1-65

5A. Indicate Type of Lease	
STATE <input checked="" type="checkbox"/>	FEE <input type="checkbox"/>
5. State Oil & Gas Lease No.	
E-289-36	

## APPLICATION FOR PERMIT TO DRILL, DEEPEN, OR PLUG BACK

1a. Type of Work		7. Unit Agreement Name	
b. Type of Well		San Juan 29-6 Unit	
DRILL <input checked="" type="checkbox"/>	DEEPEN <input type="checkbox"/>	8. Farm or Lease Name	
OIL WELL <input type="checkbox"/>	GAS WELL <input checked="" type="checkbox"/>	San Juan 29-6 Unit	
OTHER <input type="checkbox"/>		9. Well No.	
2. Name of Operator		25A	
Northwest Pipeline Corporation		10. Field and Pool, or Name	
3. Address of Operator		Blanco Mesa Ver	
P.O. Box 90 Farmington, New Mexico 87401		11. County	
4. Location of Well		Rio Arriba	
UNIT LETTER 0	LOCATED 1460	12. Proposed Depth	
FEET FROM THE East	LINE	6015	
AND 1150	South	12A. Formation	
LINE OF SEC. 32	TWP. 29N	Mesa Verde	
RGE. 6W	NADP.	23. Status of Well	
21. Elevations (Show whether DT, RL, etc.)		Rotary	
6742 GR	21A. Kind & Status Plug. Bond	22. Approx. Date Work will be Done	
Blanket	21B. Drilling Contractor	August 1, 1975	
23.			

## PROPOSED CASING AND CEMENT PROGRAM

SIZE OF HOLE	SIZE OF CASING	WEIGHT PER FOOT	SETTING DEPTH	SACKS OF CEMENT	EST. TIME
13-3/4	9-5/8	32.3	200	180	circ.
8-3/4	7	20	3930	165	250
6-1/4	4-1/2 liner	10.5	6015	215	

Selectively perforate and stimulate the Mesa Verde formation.

A BOP will be installed after the surface casing is set and cemented.  
All subsequent work on the well will be conducted through the BOP.

The E/2 of Section 32 is dedicated to this well.

APPROVAL VALID  
FOR 90 DAYS UNLESS  
DRILLING COMMENCED,

EXPIRES 8-6-75

IN ABOVE SPACE DESCRIBE PROPOSED PROGRAM: IF PROPOSAL IS TO DEEPEN OR PLUG BACK, GIVE DATA ON PRESENT PRODUCTIVE ZONE AND PROPOSED NEW PRODUCTIVE ZONE. GIVE BLOWOUT PREVENTER PROGRAM, IF ANY.

I hereby certify that the information above is true and complete to the best of my knowledge and belief.

Signed Orville Whitenburg Title Sr. Prod. & Drlg. Engineer Date May 6, 1975  
(This space for State Use)

APPROVED BY Cecilia Amund TITLE SUPERVISOR DIST. #3 DATE MAY 8 1975  
CONDITIONS OF APPROVAL, IF ANY:

**NEW MEXICO OIL CONSERVATION COMMISSION  
WELL LOCATION AND ACREAGE DEDICATION PLAT**

Form C-132  
Supersedes C-131  
Effective 1-1-66

All distances must be from the outer boundaries of the Section.

Operator <b>Northwest Pipeline Corporation</b>			Lease <b>San Juan 29-6 Unit</b>		Well No. <b>25A</b>
Unit Letter <b>0</b>	Section <b>32</b>	Township <b>29N</b>	Range <b>6W</b>	County <b>Rio Arriba</b>	
Actual Footage Location of Well: <b>1150</b> feet from the <b>South</b> line and <b>1160</b> feet from the <b>East</b> line					
Ground Level Elev. <b>6742</b>	Producing Formation <b>Mesa Verde</b>		Pool <b>Blanco Mesa Verde</b>	Dedicated Acreage <b>320</b>	

1. Outline the acreage dedicated to the subject well by colored pencil or hachure marks on the plat below.
2. If more than one lease is dedicated to the well, outline each and identify the ownership thereof (both as to working interest and royalty).
3. If more than one lease of different ownership is dedicated to the well, have the interests of all owners been consolidated by communitization, unitization, force-pooling, etc?

☐ Yes ☒ No If answer is "yes," type of consolidation \_\_\_\_\_

If answer is "no," list the owners and tract descriptions which have actually been consolidated. (Use reverse of this form if necessary.) SW/4, SE/4, Sec 32, T29N, R6W

No allowable will be assigned to the well until all interests have been consolidated (by communitization, unitization, forced-pooling, or otherwise) or until a non-standard unit, eliminating such interests, has been approved by the Commission.

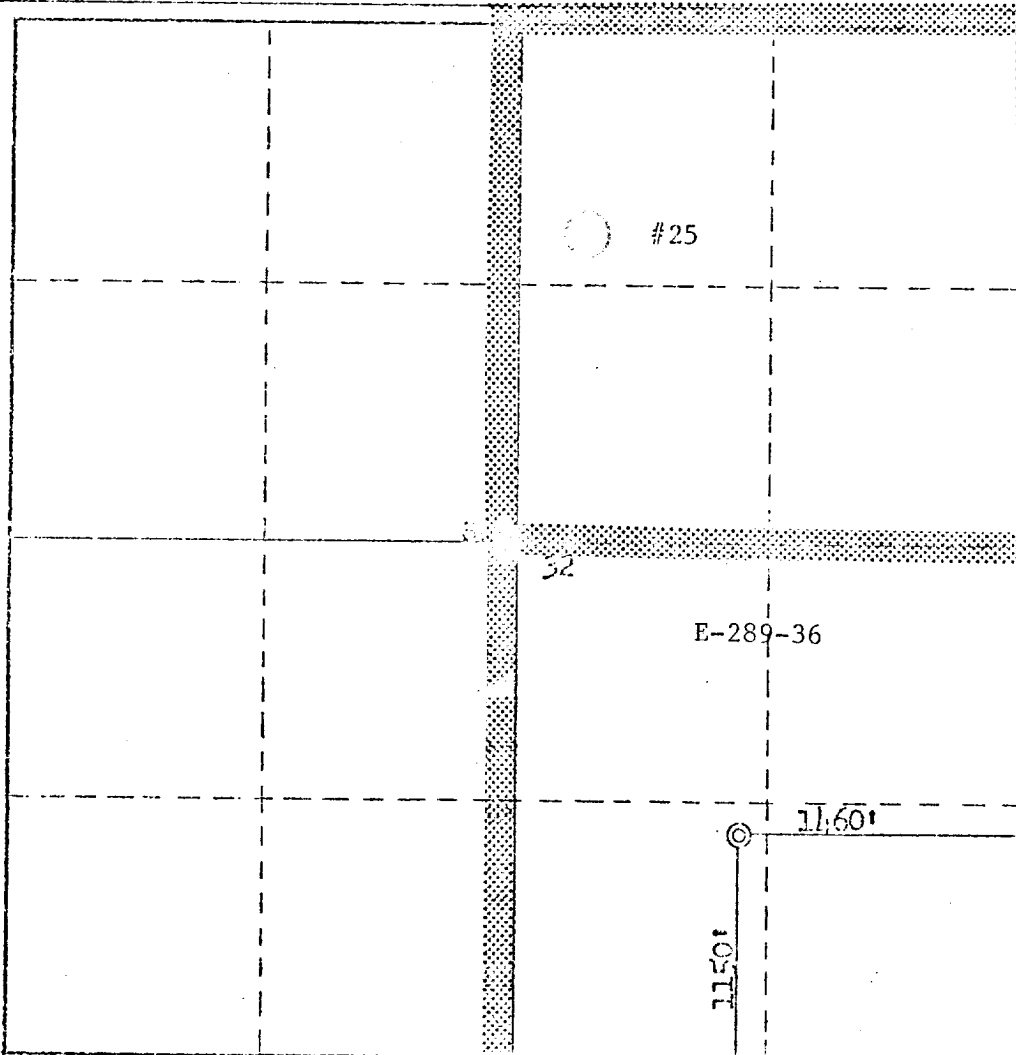

**CERTIFICATION**

I hereby certify that the information contained herein is true and correct to the best of my knowledge and belief.

Name O.B. Whitenburg  
O.B. Whitenburg  
Position  
Prod. & Drlg. Engineer  
Company  
Northwest Pipeline Corp.  
Date  
May 6, 1975

I hereby certify that the well shown on this plat was plotted in accordance with notes of actual survey made under my supervision, and that the information is true and correct to the best of my knowledge and belief.

Date Surveyed  
April 17, 1975  
Registered Professional Engineer and/or Land Surveyor  
[Signature]  
License No. \_\_\_\_\_