

NO. OF COPIES RECEIVED	5
DISTRIBUTION	
SANTA FE	/
FILE	/
U.S.G.S.	/
LAND OFFICE	/
OPERATOR	/

NEW MEXICO OIL CONSERVATION COMMISSION

30-039-21118

Form C-101
Revised 1-1-65

5A. Indicate Type of Lease	
STATE <input type="checkbox"/>	FEE <input checked="" type="checkbox"/>
5. State Oil & Gas Lease No.	

APPLICATION FOR PERMIT TO DRILL, DEEPEN, OR PLUG BACK

1a. Type of Work		7. Unit Agreement Name	
b. Type of Well DRILL <input checked="" type="checkbox"/> DEEPEN <input type="checkbox"/> PLUG BACK <input type="checkbox"/>		San Juan 29-6 Unit	
OIL WELL <input type="checkbox"/> GAS WELL <input checked="" type="checkbox"/> OTHER <input type="checkbox"/>		8. Farm or Lease Name	
SINGLE ZONE <input checked="" type="checkbox"/> MULTIPLE ZONE <input type="checkbox"/>		San Juan 29-6 Unit	
2. Name of Operator		9. Well No.	
Northwest Pipeline Corporation		29A	
3. Address of Operator		10. Field and Pool, or Wildcat	
P. O. Box 90 Farmington, New Mexico 87401		Blanco Mesa Verde	
4. Location of Well UNIT LETTER <u>F</u> LOCATED <u>1490</u> FEET FROM THE <u>West</u> LINE		12. County	
AND <u>1820</u> FEET FROM THE <u>North</u> LINE OF SEC. <u>3</u> TWP. <u>29N</u> RGE. <u>6W</u> NMPM		Rio Arriba	
19. Proposed Depth		19A. Formation	
		Mesa Verde	
20. Rotary or C.T.		Rotary	
21. Elevations (Show whether DF, RT, etc.)		22. Approx. Date Work will start	
6364' GR		November 1, 1975	
21A. Kind & Status Plug. Bond		21B. Drilling Contractor	
Blanket		Arapahoe	

23.

PROPOSED CASING AND CEMENT PROGRAM

SIZE OF HOLE	SIZE OF CASING	WEIGHT PER FOOT	SETTING DEPTH	SACKS OF CEMENT	EST. TOP
13-3/4	9-5/8	36	200	180	Circ.
8-3/4	7	20	3675	165	2200
6-1/4	4-1/2 liner	10.5	5805	215	circ. liner'

Selectively perforate and stimulate the Mesa Verde formation.

A BOP will be installed when the 9-5/8" surface casing is run and cemented.
All subsequent work will be conducted through the BOP.

The west half of Section 3 is dedicated to this well.

EXPIRES 11-3-75

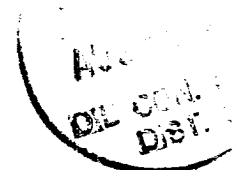

IN ABOVE SPACE DESCRIBE PROPOSED PROGRAM: IF PROPOSAL IS TO DEEPEN OR PLUG BACK, GIVE DATA ON PRESENT PRODUCTIVE ZONE AND PROPOSED NEW PRODUCTIVE ZONE. GIVE BLOWOUT PREVENTER PROGRAM, IF ANY.

I hereby certify that the information above is true and complete to the best of my knowledge and belief.

Signed O. B. Whitenburg Title Sr. Prod. & Drlg. Engr. Date July 25, 1975

(This space for State Use)

APPROVED BY AR Hendrick TITLE PETROLEUM ENGINEER DIST. NO. 3 DATE AUG 4 1975

CONDITIONS OF APPROVAL, IF ANY:

NEW MEXICO OIL CONSERVATION COMMISSION WELL LOCATION AND ACREAGE DEDICATION PLAT

Form C-102
Supersedes C-128
Effective 1-1-65

All distances must be from the outer boundaries of the Section.

Operator Northwest Pipeline Corporation			Lease San Juan 29-6 Unit		Well No. 29A
Unit Letter F	Section 3	Township 29N	Range 6W	County Rio Arriba	
Actual Footage Location of Well: 1820 feet from the North line and 1190 feet from the West line			Dedicated Acreage: 320 Acres		
Ground Level Elev. 6361	Producing Formation Mesa Verde		Pool Blanco Mesa Verde		

1. Outline the acreage dedicated to the subject well by colored pencil or hachure marks on the plat below.
2. If more than one lease is dedicated to the well, outline each and identify the ownership thereof (both as to working interest and royalty).
3. If more than one lease of different ownership is dedicated to the well, have the interests of all owners been consolidated by communitization, unitization, force-pooling, etc?

☐ Yes ☒ No If answer is "yes," type of consolidation _____

If answer is "no," list the owners and tract descriptions which have actually been consolidated. (Use reverse side of this form if necessary.) SE/4 NW/4 Section 3, T29N, R6W

No allowable will be assigned to the well until all interests have been consolidated (by communitization, unitization, forced-pooling, or otherwise) or until a non-standard unit, eliminating such interests, has been approved by the Commission.

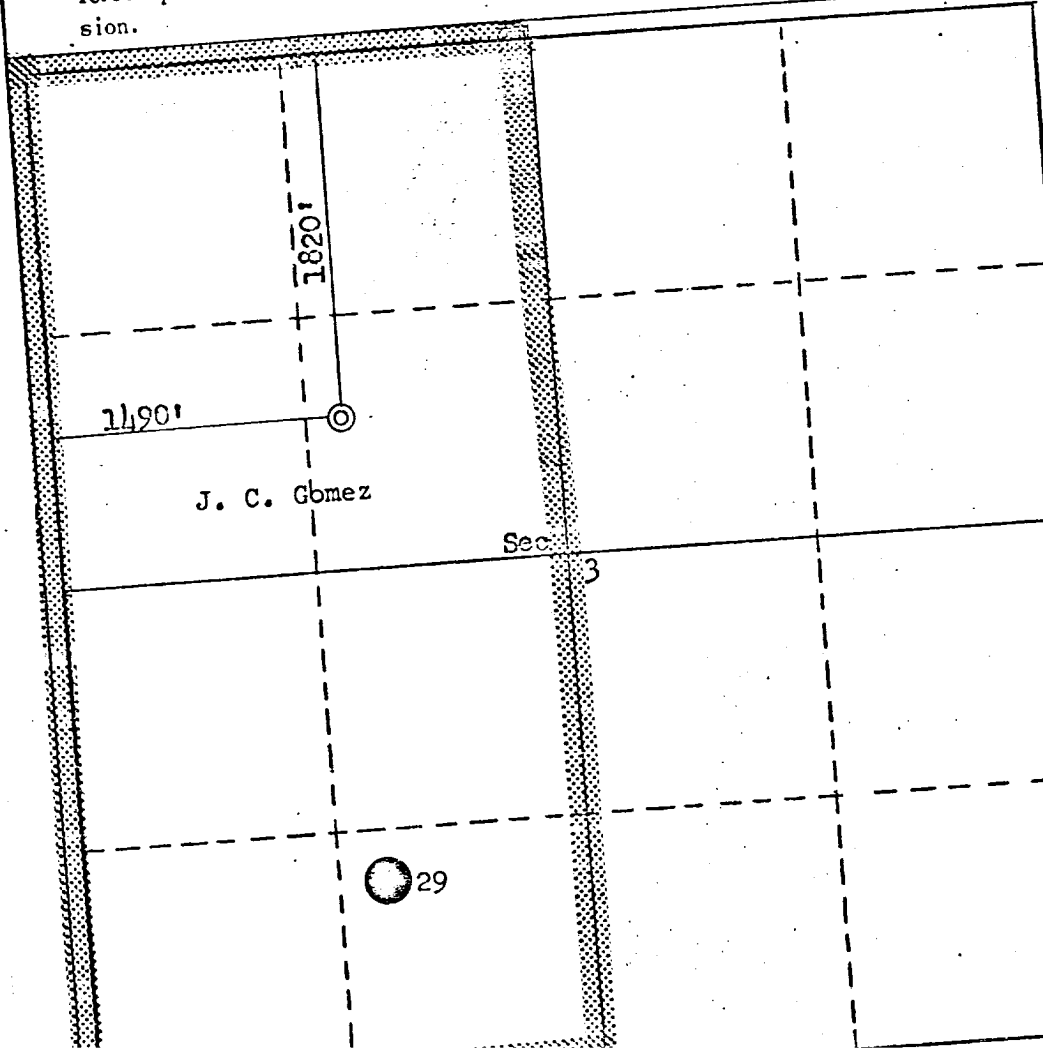

<p>CERTIFICATION</p> <p>I hereby certify that the information contained herein is true and complete to the best of my knowledge and belief.</p> <p><i>O. B. Whitenburg</i></p>	
Name	O. B. Whitenburg
Position	Sr. Prod. & Drlg. Engr.
Company	Northwest Pipeline Corp.
Date	July 25, 1975
<p>I hereby certify that the well location shown on this plat was plotted from field notes of actual surveys made by me or under my supervision, and that the same is true and correct to the best of my knowledge and belief.</p>	
Date Surveyed	April 19, 1975
Registered Professional Engineer and/or Land Surveyor	<i>Fred B. Kerr Jr.</i>
Certificate No.	