

NEW MEXICO OIL CONSERVATION COMMISSION

Form C-101  
Revised 1-1-65

|                          |     |
|--------------------------|-----|
| NO. OF COPIES RECEIVED   | 6   |
| DISTRIBUTION             |     |
| SANTA FE                 | 1   |
| FILE                     | 1 ✓ |
| U.S.G.S. <i>Huerfano</i> | 2   |
| LAND OFFICE              | 1   |
| OPERATOR                 | 1   |

5A. Indicate Type of Lease  
STATE  FEE

5. State Oil & Gas Lease No.  
E-289-40

**API 30-039-21225**

APPLICATION FOR PERMIT TO DRILL, DEEPEN, OR PLUG BACK

|  |                               |                             |   |  |  |
|--|-------------------------------|-----------------------------|---|--|--|
| 1a. Type of Work<br>DRILL <input checked="" type="checkbox"/> DEEPEN <input type="checkbox"/> PLUG BACK <input type="checkbox"/>   |                               |                             | 7. Unit Agreement Name<br>San Juan 29-6 Unit        |  |  |
| b. Type of Well<br>OIL WELL <input type="checkbox"/> GAS WELL <input checked="" type="checkbox"/> OTHER <input type="checkbox"/>   |                               |                             | 8. Farm or Lease Name<br>San Juan 29-6 Unit         |  |  |
| 2. Name of Operator<br>Northwest Pipeline Corporation  |                               |                             | 9. Well No.<br>37A                                  |  |  |
| 3. Address of Operator<br>P.O. Box 90 Farmington, New Mexico 87401   |                               |                             | 10. Field and Pool, or Wildcat<br>Blanco Mesa Verde |  |  |
| 4. Location of Well<br>UNIT LETTER <u>P</u> LOCATED <u>990</u> FEET FROM THE <u>South</u> LINE<br>AND <u>1100</u> FEET FROM THE <u>East</u> LINE OF SEC. <u>16</u> TWP. <u>29N</u> RGE. <u>6W</u> NMPM |                               |                             | 12. County<br>Rio Arriba                            |  |  |
|  |                               | 19. Proposed Depth<br>5788' | 19A. Formation<br>Mesa Verde                        | 20. Rotary or C.T.<br>Rotary                     |  |
| 21. Elevations (Show whether DF, RT, etc.)<br>6416'  | 21A. Kind & Status Plug. Bond | 21B. Drilling Contractor    |   | 22. Approx. Date Work will start<br>June 1, 1976 |  |

PROPOSED CASING AND CEMENT PROGRAM

| SIZE OF HOLE | SIZE OF CASING | WEIGHT PER FOOT | SETTING DEPTH | SACKS OF CEMENT | EST. TOP |
|--------------|----------------|-----------------|---------------|-----------------|----------|
| 13 3/4"      | 9 5/8"         | 36              | 200'          | 180             | circ.    |
| 8 3/4"       | 7"             | 20              | 3700'         | 160             | 2468'    |
| 6 1/4"       | 4 1/2" Liner   | 10.5            | 3550'-5788'   | 215             | 3550'    |

Selectively perforate and stimulate the Mesa Verde formation.

A BOP will be installed after the surface casing has been run and cemented. All subsequent work will be conducted through the BOP.

The E/2 of Section 16 is dedicated to this well.

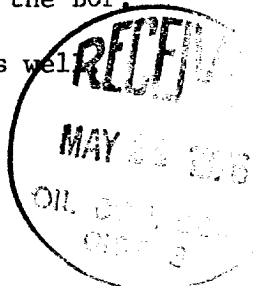

APPROVAL VALID FOR 90 DAYS UNLESS DRILLING COMMENCED, EXPIRES Aug 22 1976

*Gas is dedicated*

IN ABOVE SPACE DESCRIBE PROPOSED PROGRAM: IF PROPOSAL IS TO DEEPEN OR PLUG BACK, GIVE DATA ON PRESENT PRODUCTIVE ZONE AND PROPOSED NEW PRODUCTIVE ZONE. GIVE BLOWOUT PREVENTER PROGRAM, IF ANY.

I hereby certify that the information above is true and complete to the best of my knowledge and belief.

Signed D. H. Maroncelli Title Production Engineer Date May 18, 1976  
*(This space for State Use)*

APPROVED BY AK Kendrick TITLE SUPERVISOR DIST. #3 DATE MAY 24 1976

CONDITIONS OF APPROVAL, IF ANY:

NEW MEXICO OIL CONSERVATION COMMISSION  
WELL LOCATION AND ACREAGE DEDICATION PLAT

Form C-102  
Supersedes C-128  
Effective 1-1-65

All distances must be from the outer boundaries of the Section.

|   |  |                        |  |                             |                        |
|---|--|------------------------|--|-----------------------------|------------------------|
| Operator<br><b>Northwest Pipeline Corporation</b>   |  |                        | Lease<br><b>San Juan 29-6 Unit</b>       |                             | Well No.<br><b>37A</b> |
| Unit Letter<br><b>P</b>   | Section<br><b>16</b>                     | Township<br><b>29N</b> | Range<br><b>6W</b>                       | County<br><b>Rio Arriba</b> |                        |
| Actual Footage Location of Well:<br><b>990</b> feet from the <b>South</b> line and <b>1100</b> feet from the <b>East</b> line |  |                        |  |                             |                        |
| Ground Level Elev.<br><b>6416</b>   | Producing Formation<br><b>Mesa Verde</b> | Pool<br><b>Blanco</b>  | Dedicated Acreage:<br><b>4/320</b> Acres |                             |                        |

1. Outline the acreage dedicated to the subject well by colored pencil or hachure marks on the plat below.
2. If more than one lease is dedicated to the well, outline each and identify the ownership thereof (both as to working interest and royalty).
3. If more than one lease of different ownership is dedicated to the well, have the interests of all owners been consolidated by communitization, unitization, force-pooling, etc?

Yes  No If answer is "yes," type of consolidation \_\_\_\_\_

If answer is "no," list the owners and tract descriptions which have actually been consolidated. (Use reverse side of this form if necessary.) \_\_\_\_\_

No allowable will be assigned to the well until all interests have been consolidated (by communitization, unitization, forced-pooling, or otherwise) or until a non-standard unit, eliminating such interests, has been approved by the Commission.

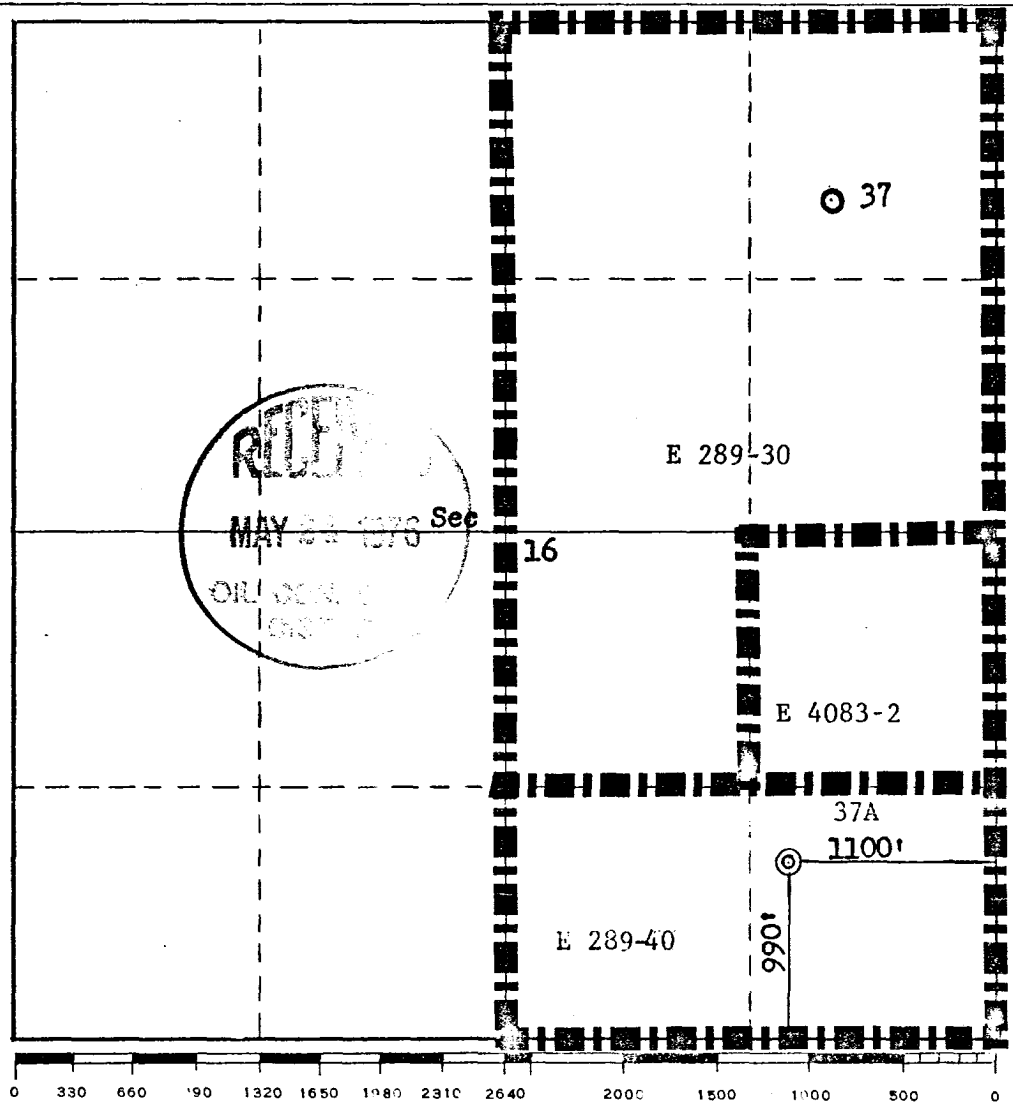

|  |                                 |
|--|---------------------------------|
| CERTIFICATION  |                                 |
| <i>I hereby certify that the information contained herein is true and complete to the best of my knowledge and belief.</i>   |                                 |
| Name   | <i>D.H. Maroncelli</i>          |
| Position   | <b>D.H. Maroncelli</b>          |
| Company  | <b>Production Engineer</b>      |
| Company  | <b>Northwest Pipeline Corp.</b> |
| Date   | <b>May 12, 1976</b>             |
| <i>I hereby certify that the well location shown on this plat was plotted from field notes of actual surveys made by me or under my supervision, and that the same is true and correct to the best of my knowledge and belief.</i> |                                 |
| Date Surveyed  | <b>May 11, 1976</b>             |
| Registered Professional Engineer and/or Land Surveyor  | <i>Fred B. Kerr Jr.</i>         |
| Certificate No.  | <b>Fred B. Kerr Jr.</b>         |
|  | <b>3950</b>                     |