

OIL CONSERVATION COMMISSION
Carter DISTRICT

OIL CONSERVATION COMMISSION
BOX 2088
SANTA FE, NEW MEXICO

DATE 11-29-77

RE: Proposed MC ☒
Proposed DHC _____
Proposed NSL _____
Proposed SWD _____
Proposed WFX _____
Proposed PMX _____

Gentlemen:

I have examined the application dated 11-22-77
for the Dugan Production Corp. Sherman Edward #2B
Operator Lease and Well No. Unit, S-T-R
and my recommendations are as follows: O-3-29N-5W

Approve

Yours very truly,

AR Gendrich

NEW MEXICO OIL CONSERVATION COMMISSION
SANTA FE, NEW MEXICO
APPLICATION FOR MULTIPLE COMPLETION

Fbrm C-107
5-1-61

Operator Dugan Production Corp.		County Rio Arriba		Date 11-22-77
Address P. O. Box 234 , Farmington, NM 87401		Lease Sherman Edward		Well No. 2B
Location of Well	Unit 0	Section 3	Township 29N	Range 5W

1. Has the New Mexico Oil Conservation Commission heretofore authorized the multiple completion of a well in these same pools or in the same zones within one mile of the subject well? YES X NO
2. If answer is yes, identify one such instance: Order No. MC-2286 MC-2285, Operator Lease, and Well No.: Dugan Production Corp. Sherman #2, E Sec. 3, T29N, R5W, and Sherman Edward #2, M Sec. 3 T29N, R5W

3. The following facts are submitted:	Upper Zone	Intermediate Zone	Lower Zone
a. Name of Pool and Formation	Gobernador Pictured Cliffs		Blanco Mesaverde
b. Top and Bottom of Pay Section (Perforations)	3212-3380'		5274-5600'
c. Type of production (Oil or Gas)	Gas		Gas
d. Method of Production (Flowing or Artificial Lift)	Flowing		Flowing

4. The following are attached. (Please check YES or NO)

- | Yes | No | |
|-------------------------------------|-------------------------------------|---|
| <input checked="" type="checkbox"/> | <input type="checkbox"/> | a. Diagrammatic Sketch of the Multiple Completion, showing all casing strings, including diameters and setting depths, centralizers and/or turbolizers and location thereof, quantities used and top of cement, perforated intervals, tubing strings, including diameters and setting depth, location and type of packers and side door chokes, and such other information as may be pertinent. |
| <input checked="" type="checkbox"/> | <input type="checkbox"/> | b. Plat showing the location of all wells on applicant's lease, all offset wells on offset leases, and the names and addresses of operators of all leases offsetting applicant's lease. |
| <input checked="" type="checkbox"/> | <input type="checkbox"/> | c. Waivers consenting to such multiple completion from each offset operator, or in lieu thereof, evidence that said offset operators have been furnished copies of the application.* |
| <input type="checkbox"/> | <input checked="" type="checkbox"/> | *d. Electrical log of the well or other acceptable log with tops and bottoms of producing zones and intervals of perforation indicated thereon. (If such log is not available at the time application is filed it shall be submitted as provided by Rule 112-A.) |

5. List all offset operators to the lease on which this well is located together with their correct mailing address.

*** Previously sent to NMOCC in Aztec, NM**

SEE ATTACHED SCHEDULE "A"

6. Were all operators listed in Item 5 above notified and furnished a copy of this application? YES X NO . If answer is yes, give date of such notification 11-28-77.

CERTIFICATE: I, the undersigned, state that I am the General Counsel of the Dugan Production Corp. (company), and that I am authorized by said company to make this report; and that this report was prepared under my supervision and direction and that the facts stated therein are true, correct and complete to the best of my knowledge.

Richard Tully
Richard Tully Signature

*Should waivers from all offset operators not accompany an application for administrative approval, the New Mexico Oil Conservation Commission will hold the application for a period of twenty (20) days from date of receipt by the Commission's Santa Fe office. If, after said twenty-day period, no protest nor request for hearing is received by the Santa Fe office, the application will then be processed.

NOTE: If the proposed multiple completion will result in an unorthodox well location and/or a non-standard perforation unit in one or more of the producing zones, then separate application for approval of the same should be filed simultaneously with this application.

CERTIFICATE OF MAILING

I hereby certify that I mailed a true copy of the Application for Multiple Completion for the Sherman Edward #2B Well by certified mail to each of the offsetting operators on November 28, 1977.

DUGAN PRODUCTION CORP.

By: Richard Tully
General Counsel

CERTIFICATE OF MAILING

I hereby certify that I mailed a true copy of the Application for .
Multiple Completion for the Sherman Edward #2B Well by certified mail to
each of the offsetting operators on November 28, 1977.

DUGAN PRODUCTION CORP.

By: Richard Tully
General Counsel

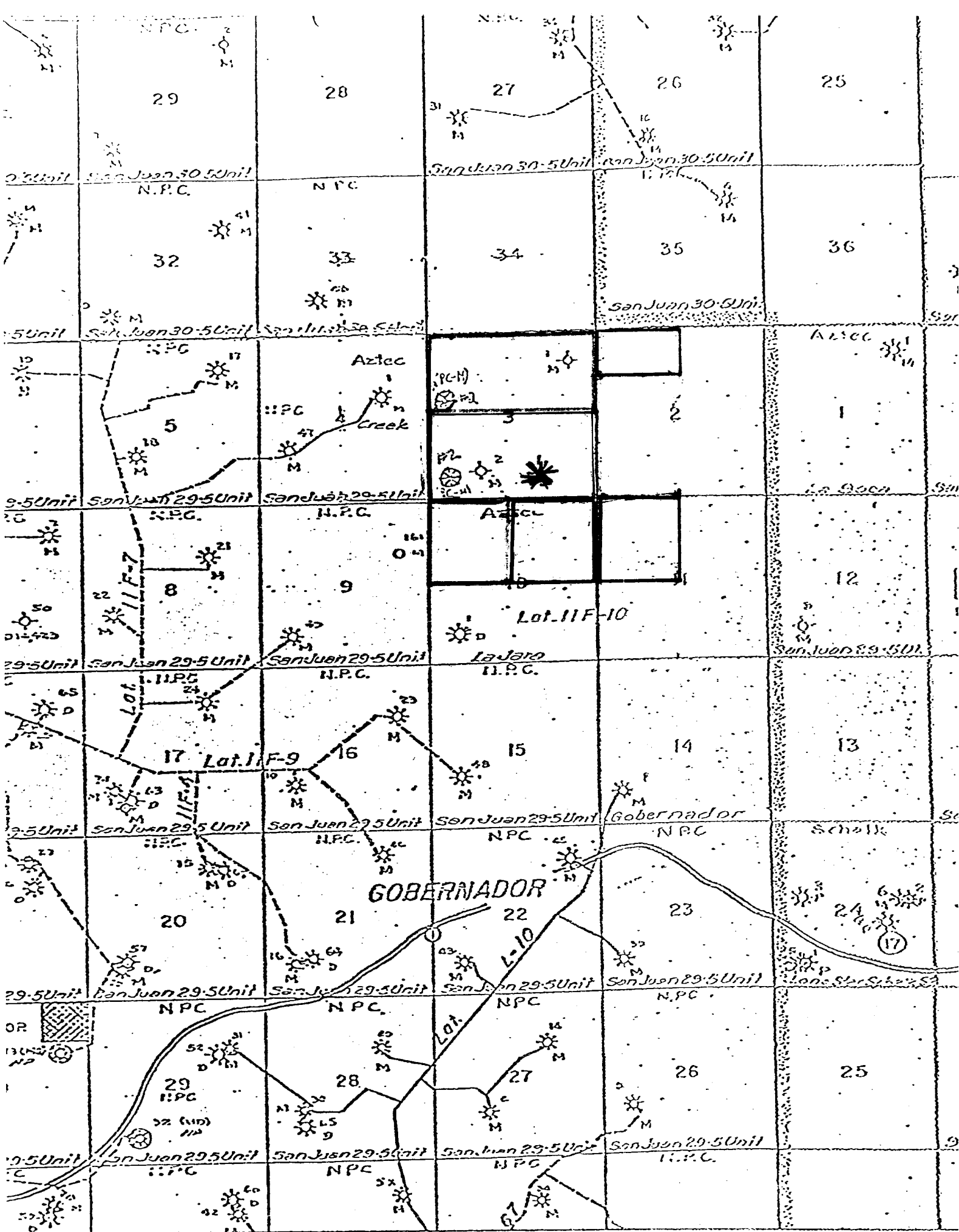

Township 29 North, Range 5 West, NMPM

Sherman Edward 2B Well

Offsetting Leases and Operators

- | | |
|--|--|
| <p>A. — USA NM 23047
Dugan Production Corp.</p> <p>B. — USA NM 0558140
Aztec Oil & Gas Company.</p> <p>C. — USA SF 078642
El Paso Natural Gas Company
Northwest Pipeline Corporation</p> | <p>D. — USA SF 078736
El Paso Natural Gas Co.
Northwest Pipeline Corp.</p> <p>E. State of NM E-289-42
Northwest Pipeline Corp.</p> <p>F. — State of NM E-289-39
Northwest Pipeline Corp.</p> |
|--|--|

SCHEDULE "A"

OFFSETTING LEASES AND OPERATORS

- A. USA NM 23047
Township 29 North, Range 5 West, NMPM
Section 3: Lots 1, 2, 3, 4, S/2 N/2 (N/2)
Operator: Dugan Production Corp.
P. O. Box 234
Farmington, NM 87401
- B. USA NM 0558140
Township 29 North, Range 5 West, NMPM
Section 10: NW/4
Operator: G. L. Stone
Exploration Manager
Aztec Oil & Gas Company
1010 Denver Club Building
518 17th Street
Denver, CO 80202
- C. USA SF 078642
Township 29 North, Range 5 West, NMPM
Section 10: NE/4
Operators: D. N. Canfield
Director, Land
El Paso Natural Gas Company
Box 1492
El Paso, TX 79978

John W. Shepardson
Manager, Land
Northwest Pipeline Corporation
One Park Central, Suite 1487
Denver, CO 80202
- D. USA SF 078736
Township 29 North, Range 5 West, NMPM
Section 11: NW/4
Operators: D. N. Canfield
Director, Land
El Paso Natural Gas Company
Box 1492
El Paso, TX 79978

John W. Shepardson
Manager, Land
Northwest Pipeline Corporation
One Park Central, Suite 1487
Denver, CO 80202
- E. State of NM E-289-42
Township 29 North, Range 5 West, NMPM
Section 2: SW/4, S/2 NW/4
Operator: John W. Shepardson
Manager, Land
Northwest Pipeline Corporation
One Park Central, Suite 1487
Denver, CO 80202
- F. State of NM E-289-39
Township 29 North, Range 5 West, NMPM
Section 2: N/2 NW/4
Operator: John W. Shepardson
Manager, Land
Northwest Pipeline Corporation
One Park Central, Suite 1487
Denver, CO 80202

DIAGRAMATIC SKETCH OF DUAL GAS COMPLETION

DUGAN PRODUCTION CORP.

Sherman Edward #2B

8-5/8" OD casing @ 249'
Cemented to surface with 150/sx

Two stage tool @ 3581'
Cemented with 350 sx

3212'

1-1/4" OD tbg @ 3373' RKB.

Pictured Cliffs Perforations
1 jet/2 ft. 3316-3380',
3212-30', 3236-48'.

3380'

Baker Model "D" Packer @ 5200'

5274'

Mesaverde Perforations
(1 hole) 5274', 5277', 5451'
5455', 5610', 5622', 5629', 5636'
5641'.
(1 hole/2 ft) 5286-92', 5564-72',
5592-5600'.
1 jet/2 ft. 3316-3380', 3212-
30', 3236-48'.

5600'

1-1/4" tbg set @ 5625'
5-1/2" csg set @ 5758'
7-7/8" hole to TD 5758'
Cemented first stage
w/385 cu. ft.

DUGAN PRODUCTION CORP.

APPLICATION FOR MULTIPLE COMPLETION
SHERMAN EDWARD #2-B
IN PICTURED CLIFFS & MESAVERDE FORMATIONS

940' FSL - 2070' FEL
Section 3, T29n, R5W
Rio Arriba County, New Mexico