

OIL CONSERVATION COMMISSION

Carter DISTRICT

OIL CONSERVATION COMMISSION
BOX 2088
SANTA FE, NEW MEXICO

DATE 4-27-78

RE: Proposed MC _____
Proposed DHC _____
Proposed NSL XX _____
Proposed SWD _____
Proposed WFX _____
Proposed PMX _____

Dick Stamets

Gentlemen:

I have examined the application dated 4-20-78
for the John E. Schack Shack 29-4 #11 P-23-29N-4W
Operator Lease and Well No. Unit, S-T-R

and my recommendations are as follows:

Approve

Yours very truly,

AR Kendrick

JOHN E. SCHALK
P. O. BOX 25825
ALBUQUERQUE, NEW MEXICO 87125

AREA CODE 505
TELEPHONE 247-2294

April 20, 1978

Mr. Joe D. Ramey
Secretary-Director
New Mexico Oil Conservation Commission
P. O. Box 2088
Santa Fe, New Mexico 87501

Dear Mr. Ramey:

We wish to submit for your consideration, a request for the approval of the following location, located in Section 23, Township 29 North, Range 4 West, Rio Arriba County, New Mexico:

John E. Schalk, Schalk 29-4 #11
(Pictured Cliffs) 610' from the
South line, 660' from the East
line.

Ecological and environmental restrictions imposed by the Forest Service influenced the spotting of this location. A Topographic map showing the existing terrain problems is attached.

John E. Schalk is the designated operator by way of a Farm-in from Continental Oil Company, for all of Section 23, Township 29 North, Range 4 West, Rio Arriba County, New Mexico.

Yours very truly,

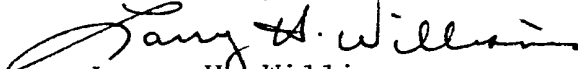
Larry H. Williams
Agent

LHW:lr
enclosure

cc: 2
Al Kendrick - NMOCC- Aztec





L. P. Thompson
Division Manager

E. L. Oshlo
Assistant Division Manager

Production Department
Hobbs Division
North American Production

Continental Oil Company
P.O. Box 460
1001 North Turner
Hobbs, New Mexico 88240
(505) 393-4141

April 18, 1978

New Mexico Oil Conservation Commission
P. O. Box 2088
Santa Fe, New Mexico 85701

Gentlemen:

We have been advised of John E. Schalk's application to drill the Schalk 29-4 Well No. 11 to the Pictured Cliffs formation at a location 610 feet from the South line and 660 feet from the East line of Section 23, Township 29 North, Range 4 West, Rio Arriba County, New Mexico.

Continental Oil Company has no objection to this non-standard location and hereby waives notice and hearing of this application.

Yours very truly,

A handwritten signature in dark ink, appearing to read "Don Bolt, Jr.", written over a horizontal line.

Don Bolt, Jr.
Division Engineer

CCW-JS

Copy to: John E. Schalk
P. O. Box 26687
Albuquerque, New Mexico 87125

LEASE OWNERSHIP

TOWNSHIP 29 NORTH, RANGE 4 WEST

JOHN E. SCHALK —

CONTINENTAL OIL COMPANY —

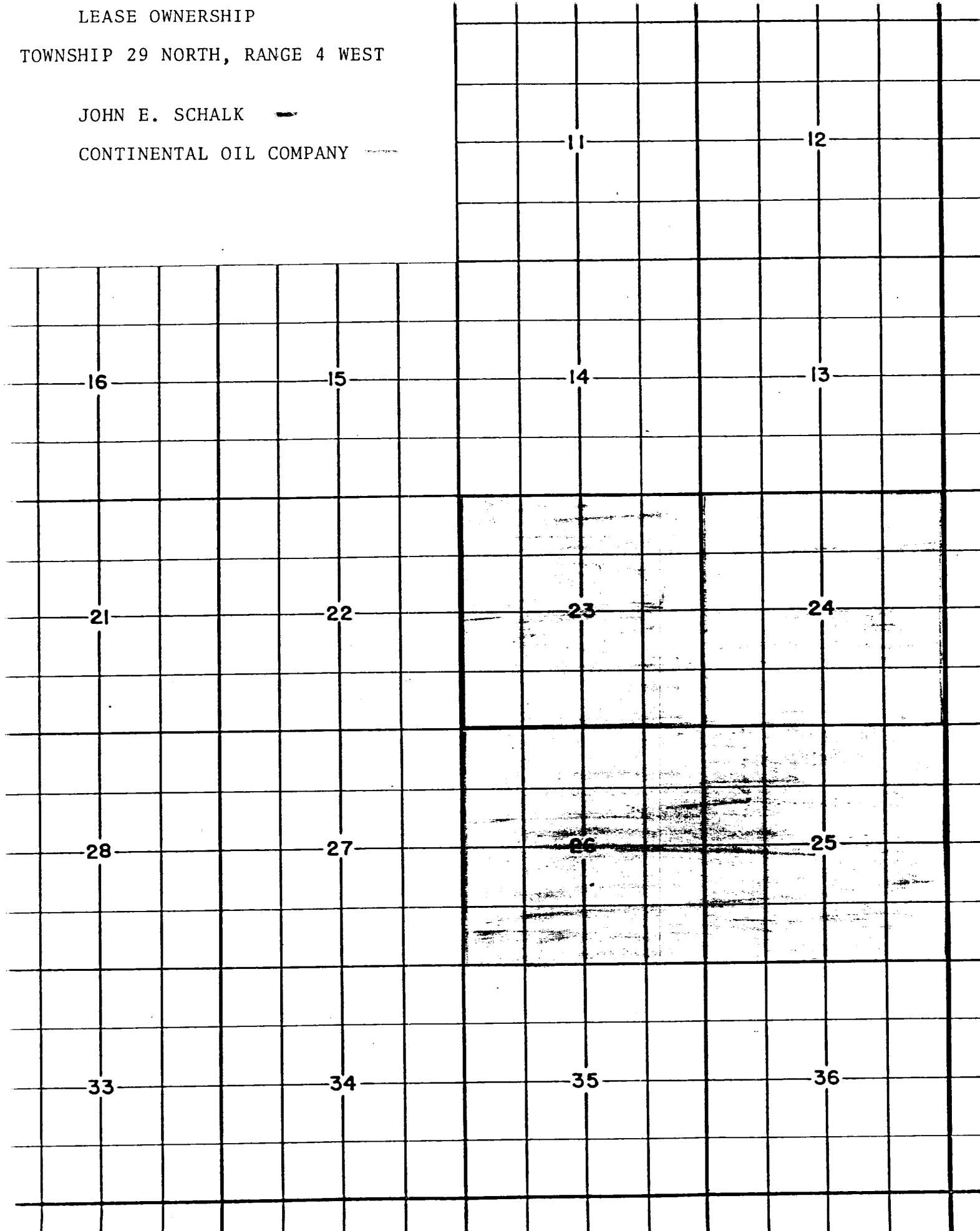



VICINITY MAP
John E Schalk
Schalk #11
610F/5 660F/E
Sec. 23, T29N, R24W
Scale: 1"=2000'