

UNITED STATES
DEPARTMENT OF THE INTERIOR
GEOLOGICAL SURVEY

SUNDRY NOTICES AND REPORTS ON WELLS

(Do not use this form for proposals to drill or to deepen or plug back to a different reservoir. Use Form 9-331-C for such proposals.)

1. oil ☐ well gas ☒ well other ☐

2. NAME OF OPERATOR
Northwest Pipeline Corporation

3. ADDRESS OF OPERATOR
P.O. Box 90, Farmington, New Mexico 87401

4. LOCATION OF WELL (REPORT LOCATION CLEARLY. See space 17 below.)
AT SURFACE: 1540' FNL & 1740' FWL
AT TOP PROD. INTERVAL: Same
AT TOTAL DEPTH: Same

16. CHECK APPROPRIATE BOX TO INDICATE NATURE OF NOTICE, REPORT, OR OTHER DATA

REQUEST FOR APPROVAL TO:

TEST WATER SHUT-OFF ☐
FRACTURE TREAT ☐
SHOOT OR ACIDIZE ☐
REPAIR WELL ☐
PULL OR ALTER CASING ☐
MULTIPLE COMPLETE ☐
CHANGE ZONES ☐
ABANDON* ☐
(other) ☐

SUBSEQUENT REPORT OF:

☐
☐
☐
☐
☐
☐
☐
☐

5. LEASE

SF 078343

6. IF INDIAN, ALLOTTEE OR TRIBE NAME

7. UNIT AGREEMENT NAME

San Juan 29-5 Unit

8. FARM OR LEASE NAME

San Juan 29-5 Unit

9. WELL NO.

#84

10. FIELD OR WILDCAT NAME

Blanco Pictured Cliffs

11. SEC., T., R., M., OR BLK. AND SURVEY OR AREA

SEC 5, T29N, R5W

12. COUNTY OR PARISH

Rio Arriba

13. STATE

N.M.

14. API NO.

15. ELEVATIONS (SHOW DF, KDB, AND WD)
6725' GR

(NOTE: Report results of multiple completion or zone change on Form 9-330.)

17. DESCRIBE PROPOSED OR COMPLETED OPERATIONS (Clearly state all pertinent details, and give pertinent dates, including estimated date of starting any proposed work. If well is directionally drilled, give subsurface locations and measured and true vertical depths for all markers and zones pertinent to this work.)*

The original plat submitted with the APD had an error in the footage location of this well. Please change the APD to reflect the correct footage location.

Amended Location

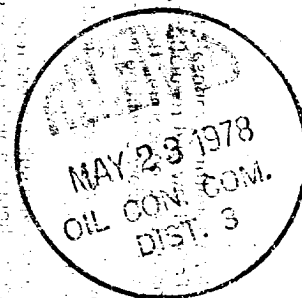

Subsurface Safety Valve: Manu. and Type _____

Set @ _____ Ft.

18. I hereby certify that the foregoing is true and correct

SIGNED D.H. Maroncelli TITLE Sr. Drilling Engr. DATE 5/19/78

(This space for Federal or State office use)

APPROVED BY _____ TITLE _____ DATE _____
CONDITIONS OF APPROVAL, IF ANY:

**NEW MEXICO OIL CONSERVATION COMMISSION
WELL LOCATION AND ACREAGE DEDICATION PLAT**

Form C-102
Supersedes C-128
Effective 1-1-65

All distances must be from the outer boundaries of the Section.

Operator NORTHWEST PIPELINE CORPORATION			Lease SAN JUAN 29-5 UNIT		Well No. 84
Unit Letter F	Section 5	Township 29N	Range 5W	County Rio Arriba	
Actual Footage Location of Well: 1540 feet from the North line and 1740 feet from the West line					
Ground Level Elev. 6725	Producing Formation Pictured Cliffs		Pool Blanco Pictured Cliffs	Dedicated Acreage: 161 Acres	

1. Outline the acreage dedicated to the subject well by colored pencil or hachure marks on the plat below.
2. If more than one lease is dedicated to the well, outline each and identify the ownership thereof (both as to working interest and royalty).
3. If more than one lease of different ownership is dedicated to the well, have the interests of all owners been consolidated by communitization, unitization, force-pooling, etc?

☒ Yes ☐ No If answer is "yes," type of consolidation Unitization

If answer is "no," list the owners and tract descriptions which have actually been consolidated. (Use reverse side of this form if necessary.) _____

No allowable will be assigned to the well until all interests have been consolidated (by communitization, unitization, forced-pooling, or otherwise) or until a non-standard unit, eliminating such interests, has been approved by the Commission.

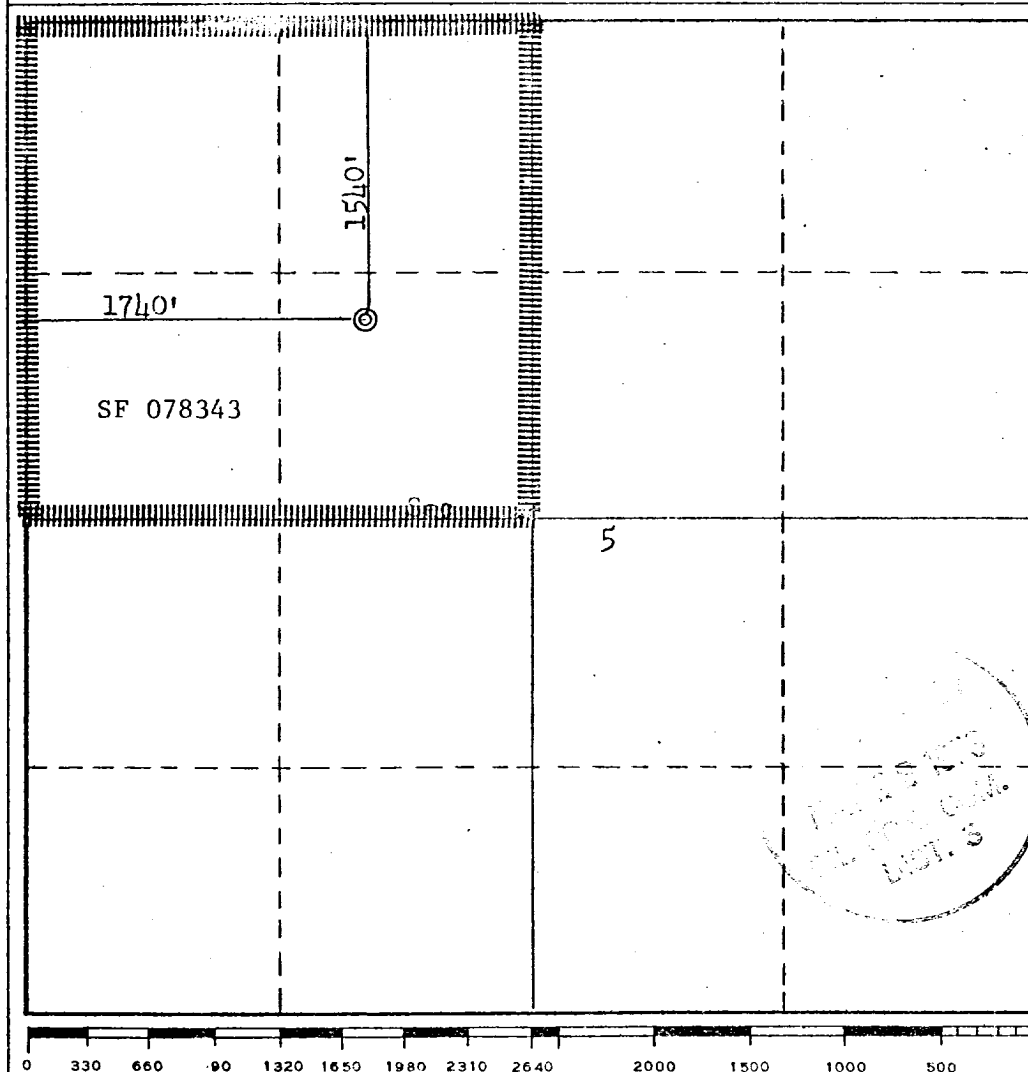

CERTIFICATION

I hereby certify that the information contained herein is true and complete to the best of my knowledge and belief.

D.H. Maroncelli

Name
D.H. Maroncelli
Position
Sr. Drilling Engineer
Company
Northwest Pipeline Corp.

Date
5/19/78

I hereby certify that the well location shown on this plat was plotted from field notes of actual surveys made by me or under my supervision, and that the same is true and correct to the best of my knowledge and belief.

Date Surveyed
May 11, 1978
Registered Professional Engineer and/or Land Surveyor

Fred B. Kerr Jr.
Fred B. Kerr Jr.

Certificate No.

3950