

NO. OF COPIES RECEIVED	
DISTRIBUTION	
SANTA FE	
FILE	
U.S.G.S.	
LAND OFFICE	
OPERATOR	

NEW MEXICO OIL CONSERVATION COMMISSION

30-039-22702

Form C-101
Revised 1-1-65

5A. Indicate Type of Lease	
STATE <input checked="" type="checkbox"/>	FEE <input type="checkbox"/>
5. State Oil & Gas Lease No.	
E-289-32	

APPLICATION FOR PERMIT TO DRILL, DEEPEN, OR PLUG BACK

1a. Type of Work		7. Unit Agreement Name	
DRILL <input checked="" type="checkbox"/> DEEPEN <input type="checkbox"/> PLUG BACK <input type="checkbox"/>		San Juan 29-5 Unit	
b. Type of Well		8. Farm or Lease Name	
OIL WELL <input type="checkbox"/> GAS WELL <input checked="" type="checkbox"/> OTHER <input type="checkbox"/>		San Juan 29-5 Unit	
c. Name of Operator		9. Well No.	
Northwest Pipeline Corporation		105	
d. Address of Operator		10. Field and Pool, or Wildcat	
P.O. Box 90, Farmington, N.M. 87401		Basin Dakota	
e. Location of Well		12. County	
UNIT LETTER <u>A</u> LOCATED <u>800'</u> FEET FROM THE <u>North</u> LINE		Rio Arriba	
AND <u>870'</u> FEET FROM THE <u>East</u> LINE OF SEC. <u>2</u> TWP. <u>29N</u> RGE. <u>5W</u> NMPM			
19. Proposed Depth		19A. Formation	
8650'		Dakota	
20. Rotary or C.T.		Rotary	
21. Elevations (Show whether DF, RT, etc.)		22. Approx. Date Work will start	
7239' GR		May 15, 1981	

PROPOSED CASING AND CEMENT PROGRAM

SIZE OF HOLE	SIZE OF CASING	WEIGHT PER FOOT	SETTING DEPTH	SACKS OF CEMENT	EST. TOP
12-1/4"	9-5/8"	36#	350'	185 cu.ft	Surface
8-3/4"	7"	20#	4500'	300 cu.ft	3325'
6-1/4"	4-1/2"	10.5# & 11.6#	8650'	650 cu.ft	4400'

Selectively perforate and stimulate the Dakota formation.
Completion plans will be determined at Total Depth.

A BOP will be installed after the surface casing is set and cemented. All subsequent work will be conducted through the BOP's.

The East half of Section 2 is dedicated to this well.

Gas is dedicated.

APPROVAL VALID
FOR ~~30~~ ⁶⁰ DAYS UNLESS
DRILLING COMMENCED,

EXPIRES 10-8-81

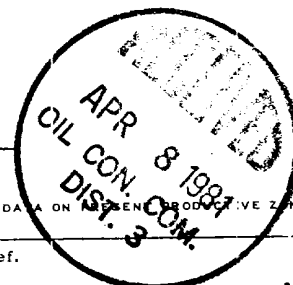

IN ABOVE SPACE DESCRIBE PROPOSED PROGRAM: IF PROPOSAL IS TO DEEPEN OR PLUG BACK, GIVE DATA ON PREVIOUS PRODUCTIVE ZONE AND PROPOSED NEW PRODUCTIVE ZONE. GIVE BLOWOUT PREVENTER PROGRAM, IF ANY.

I hereby certify that the information above is true and complete to the best of my knowledge and belief.

Signed Paul C. Thompson Title Drilling Engineer Date April 7, 1981

Paul C. Thompson
(This space for State Use)

APPROVED BY Frank B. Cheney TITLE SUPERVISOR DISTRICT # 3 DATE APR 8 1981

CONDITIONS OF APPROVAL, IF ANY:

OIL CONSERVATION DIVISION

STATE OF NEW MEXICO
ENERGY AND MINERALS DEPARTMENTP. O. BOX 2088
SANTA FE, NEW MEXICO 87501Form C-107
Revised 10-1-72

All distances must be from the outer boundaries of the Section.

Operator NORTHWEST PIPELINE CORPORATION			Lease SAN JUAN 29-5 UNIT		Well No. 105
Unit Letter A	Section 2	Township 29N	Range 5W	County Rio Arriba	
Actual Footage Location of Well: 800 feet from the North line and 870 feet from the East line					
Ground Level Elev. 7239	Producing Formation Dakota		Pool Basin Dakota		Dedicated Acreage: 320 324.67 Acres

1. Outline the acreage dedicated to the subject well by colored pencil or hachure marks on the plat below.
2. If more than one lease is dedicated to the well, outline each and identify the ownership thereof (both as to working interest and royalty).
3. If more than one lease of different ownership is dedicated to the well, have the interests of all owners been consolidated by communitization, unitization, force-pooling, etc?

☒ Yes ☐ No If answer is "yes," type of consolidation

Unitization

If answer is "no," list the owners and tract descriptions which have actually been consolidated: (Use reverse side of this form if necessary.)

No allowable will be assigned to the well until all interests have been consolidated (by communitization, unitization, forced-pooling, or otherwise) or until a non-standard unit, eliminating such interests, has been approved by the Commission.

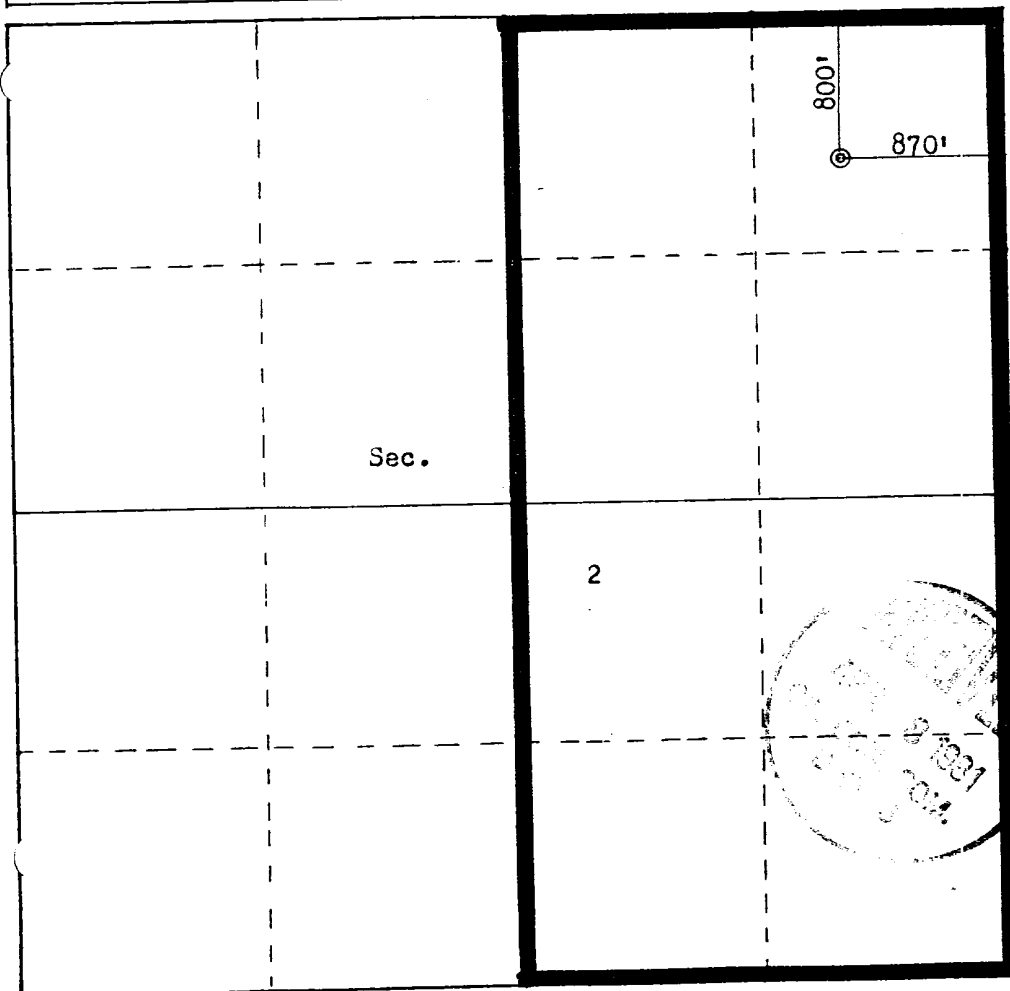

Scale: 1"=1000'

CERTIFICATION

I hereby certify that the information contained herein is true and complete to the best of my knowledge and belief.

Name
Paul C. Thompson

Position
Drilling Engineer

Company
Northwest Pipeline Corporation

Date
4-6-81

I hereby certify that the well location shown on this plat was plotted from field notes of actual surveys made by me or under my supervision, and that the same is true and correct to the best of my knowledge and belief.

Date Surveyed
March 24, 1981

Registered Professional Engineer and Land Surveyor
Fred B. Kerr Jr.

Certificate No. **3950**

