

UNITED STATES
DEPARTMENT OF THE INTERIOR
GEOLOGICAL SURVEY

SUNDRY NOTICES AND REPORTS ON WELLS

(Do not use this form for proposals to drill or to deepen or plug back to a different reservoir. Use Form 9-331-C for such proposals.)

1. oil well ☐ gas well ☒ other

2. NAME OF OPERATOR
M. R. Schalk

3. ADDRESS OF OPERATOR
P.O. Box 25825, Albuquerque, New Mex. 87125

4. LOCATION OF WELL (REPORT LOCATION CLEARLY. See space 17 below.)
AT SURFACE: SW/4 SW/4 Section 23
AT TOP PROD. INTERVAL:
AT TOTAL DEPTH: 950' FSL; 800' FWL, Sec. 23

16. CHECK APPROPRIATE BOX TO INDICATE NATURE OF NOTICE, REPORT, OR OTHER DATA

REQUEST FOR APPROVAL TO:

TEST WATER SHUT-OFF ☐
FRACTURE TREAT ☐
SHOOT OR ACIDIZE ☐
REPAIR WELL ☐
PULL OR ALTER CASING ☐
MULTIPLE COMPLETE ☐
CHANGE ZONES ☒
ABANDON* ☐
(other) ☐

SUBSEQUENT REPORT OF:

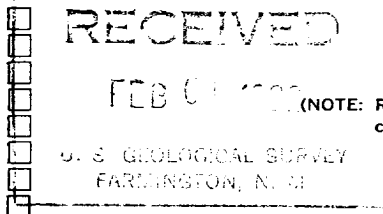

(NOTE: Report results of multiple completion or zone change on Form 9-330.)

17. DESCRIBE PROPOSED OR COMPLETED OPERATIONS (Clearly state all pertinent details, and give pertinent dates, including estimated date of starting any proposed work. If well is directionally drilled, give subsurface locations and measured and true vertical depths for all markers and zones pertinent to this work.)*

We request approval to change this location from a Pictured Cliffs well to a Mesa Verde well. The estimated formation tops, revised total depth and the proposed casing and cementing program are shown on Attachment I.

Proposed operations under the original Permit to Drill (approved June 9, 1981) will remain the same.

Subsurface Safety Valve: Manu. and Type _____ Set @ _____ Ft.

18. I hereby certify that the foregoing is true and correct

SIGNED M. R. Schalk TITLE Agent DATE January 29, 1982

(This space for Federal or State office use)

APPROVED BY _____ TITLE _____ DATE _____
CONDITIONS OF APPROVAL, IF ANY:

*Note is safe
on copy attached
to Approved APD*

*See Instructions on Reverse Side

NMOCC

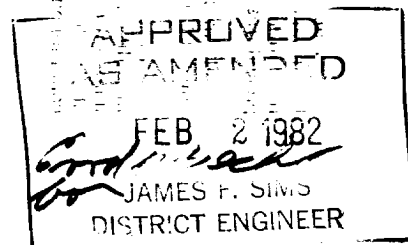

ATTACHMENT I

PROPOSED CHANGES REQUESTED ON THE SCHALK 29 - 4 WELL NO. 10 CONCERNING THE
CHANGE OF ZONES FROM THE PICTURED CLIFFS TO THE MESA VERDE

ESTIMATED FORMATION TOPS:	Ojo Alamo	-	3320'
	Kirtland	-	3864'
	Fruitland	-	3959'
	Pictured Cliffs	-	4069'
	Cliff House	-	6100'
	Point Lookout	-	6385'
	Mancos	-	6486'

TOTAL DEPTH: 6650'

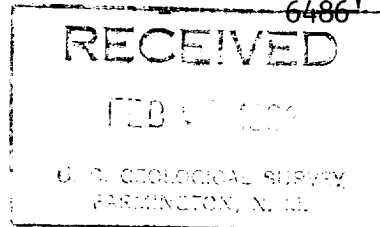

PROPOSED CASING AND CEMENTING PROGRAM

<u>Size of Hole</u>	<u>Size of Casing</u>	<u>Weight / Foot</u>	<u>Setting Depth</u>	<u>Quantity of Cement</u>
12-1/4"	8-5/8"	24#	300'	300 sacks - circ. to surface
7-7/8"	4-1/2"	10.5#	6650'	1st Stage: 350 sacks. 2nd Stage: 750 sacks - circ. to surface.

** D. V. Tool to be run at 4150' and cement over the
Ojo Alamo formation.

ESTIMATED DEPTHS AT WHICH WATER, OIL, GAS OR OTHER MINERALS ARE EXPECTED
TO BE ENCOUNTERED: 3959'; 4069'; 6100'; 6385'.

NO ANTICIPATED ABNORMAL PRESSURE IS EXPECTED.

**NEW MEXICO OIL CONSERVATION COMMISSION
WELL LOCATION AND ACREAGE DEDICATION PLAT**

Form C-102
Supersedes C-128
Effective 1-1-65

All distances must be from the outer boundaries of the Section.

Operator M. R. SCHALK			Lease SCHALK 29-4		Well No. 10
Unit Letter M	Section 23	Township 29 NORTH	Range 4 WEST	County RIO ARriba	
Actual Footage Location of Well: 950 feet from the SOUTH line and 800 feet from the WEST line					
Ground Level Elev. 7322	Producing Formation MESA VERDE		Pool BLANCO		Dedicated Acreage 320 Acres

1. Outline the acreage dedicated to the subject well by colored pencil or hatchure marks on the plat below.
2. If more than one lease is dedicated to the well, outline each and identify the ownership thereof (both as to working interest and royalty).
3. If more than one lease of different ownership is dedicated to the well, have the interests of all owners been consolidated by communitization, unitization, force-pooling, etc?

☐ Yes ☐ No If answer is "yes," type of consolidation _____

If answer is "no," list the owners and tract descriptions which have actually been consolidated. (Use reverse side of this form if necessary.) _____

No allowable will be assigned to the well until all interests have been consolidated (by communitization, unitization, forced-pooling, or otherwise) or until a non-standard unit, eliminating such interests, has been approved by the Commission.

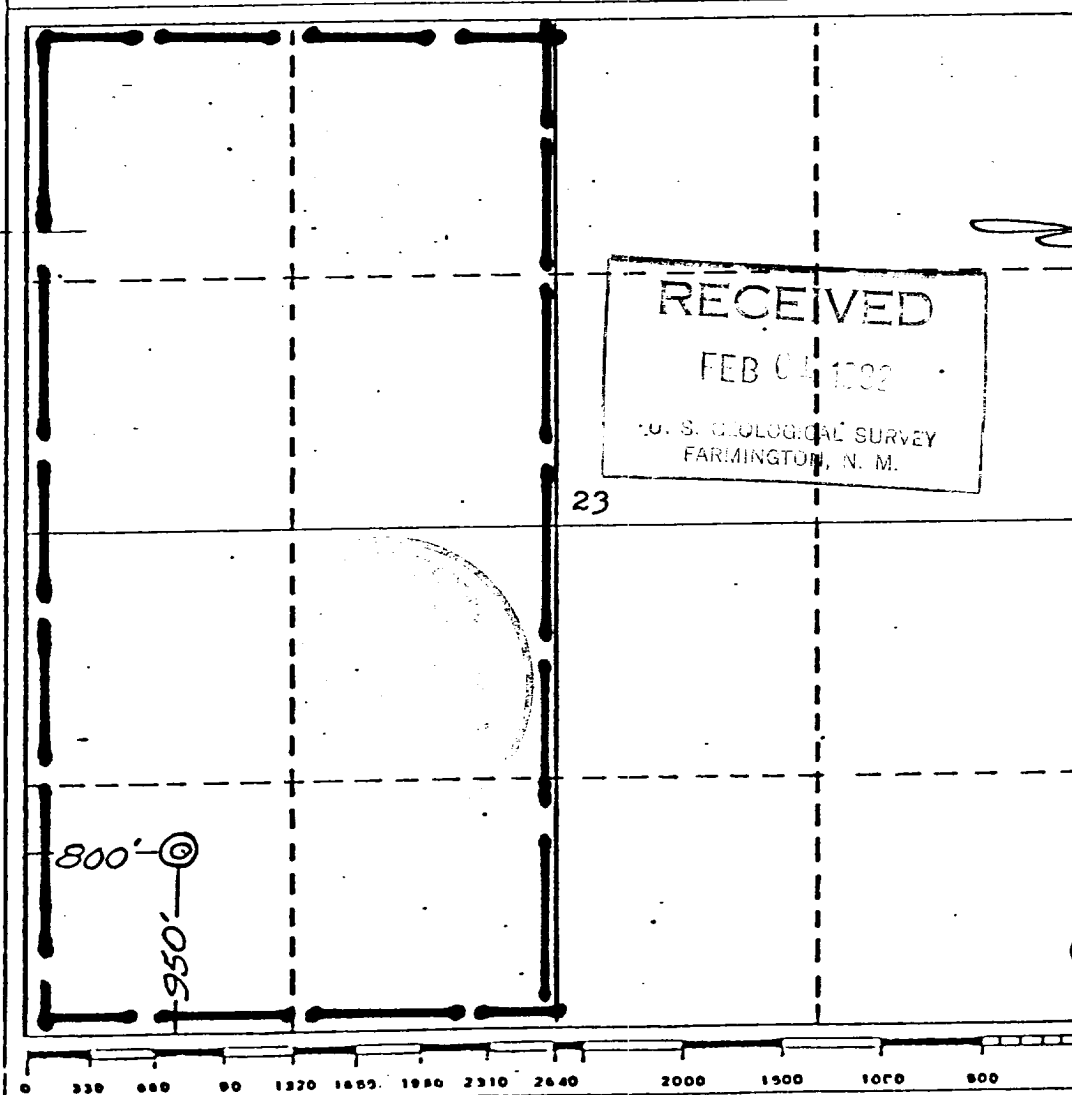

CERTIFICATION

I hereby certify that the information contained herein is true and complete to the best of my knowledge and belief.

Steve Schalk
Name

Steve Schalk

Position
Agent

Company
M. R. Schalk

Date
January 29, 1982

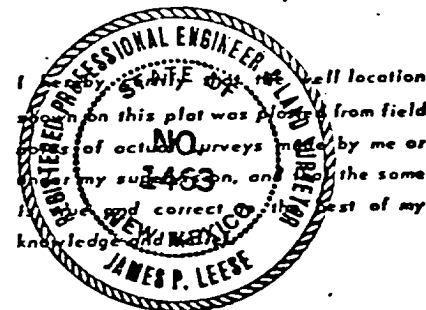

Date Surveyed
2 December 1977

Registered Professional Engineer
and/or Land Surveyor

James P. Leese
James P. Leese

Certificate No.
1463