

UNITED STATES  
DEPARTMENT OF THE INTERIOR  
GEOLOGICAL SURVEY

SUNDRY NOTICES AND REPORTS ON WELLS

(Do not use this form for proposals to drill or to deepen or plug back to a different reservoir. Use Form 9-331-C for such proposals.)

1. oil ☐ well ☐ gas ☒ well ☐ other
2. NAME OF OPERATOR  
Northwest Pipeline Corporation
3. ADDRESS OF OPERATOR  
P.O. Box 90, Farmington, N.M. 87499
4. LOCATION OF WELL (REPORT LOCATION CLEARLY. See space 17 below.)  
AT SURFACE: 1450 FWL & 1950 FSL NE/SW  
AT TOP PROD. INTERVAL: 1450 FWL & 1950 FSL  
AT TOTAL DEPTH: 1450 FWL & 1950 FSL
16. CHECK APPROPRIATE BOX TO INDICATE NATURE OF NOTICE, REPORT, OR OTHER DATA

REQUEST FOR APPROVAL TO:

- TEST WATER SHUT-OFF ☐  
FRACTURE TREAT ☐  
SHOOT OR ACIDIZE ☐  
REPAIR WELL ☐  
PULL OR ALTER CASING ☐  
MULTIPLE COMPLETE ☒  
CHANGE ZONES ☐  
ABANDON\* ☐  
(other) ☐

SUBSEQUENT REPORT OF:

- ☐  
☐  
☐  
☐  
☐  
☐  
☐  
☐  
☐  
☐

RECEIVED  
NOV 0 1982

(NOTE: Report results of multiple completion or zone change on Form 9-330.)

U.S. GEOLOGICAL SURVEY  
WASHINGTON, D.C.

5. LEASE  
SF 078917
6. IF INDIAN, ALLOTTEE OR TRIBE NAME
7. UNIT AGREEMENT NAME  
San Juan 29-5 Unit
8. FARM OR LEASE NAME  
San Juan 29-5 Unit
9. WELL NO.  
#106
10. FIELD OR WILDCAT NAME  
Gobernador PC / Blanco MV
11. SEC., T., R., M., OR BLK. AND SURVEY OR AREA  
Sec 25, T29N, R5W
12. COUNTY OR PARISH: 13. STATE  
Rio Arriba N.M.
14. API NO.  
30-039-23033
15. ELEVATIONS (SHOW DF, KDS, AND WD)  
16869' KB

17. DESCRIBE PROPOSED OR COMPLETED OPERATIONS (Clearly state all pertinent details, and give pertinent dates, including estimated date of starting any proposed work. If well is directionally drilled, give subsurface locations and measured and true vertical depths for all markers and zones pertinent to this work.)\*

We request permission to complete this well as a dual well in the Gobernador Pictured Cliffs/Blanco Mesa Verde Formations instead of just a single in the Blanco MV zone.



Subsurface Safety Valve: Manu. and Type \_\_\_\_\_ Set @ \_\_\_\_\_ Ft.

18. I hereby certify that the foregoing is true and correct

SIGNED Paul C. Thompson TITLE Drilling Engineer DATE October 27, 1982  
Paul C. Thompson

(This space for Federal or State office use)

APPROVED BY \_\_\_\_\_ TITLE \_\_\_\_\_ DATE \_\_\_\_\_  
CONDITIONS OF APPROVAL, IF ANY

APPROVED

PCT:djb/4

MOCC

\*See Instructions on Reverse Side

NOV 04 1982  
Elliott  
DISTRICT ENGINEER

All distances must be from the outer boundaries of the Section.

Operator <b>NORTHWEST PIPELINE CORPORATION</b>		Lease <b>SAN JUAN 29-5 UNIT</b>		Well No. <b>106</b>
Unit Letter <b>K</b>	Section <b>25</b>	Township <b>29N</b>	Range <b>5W</b>	County <b>Rio Arriba</b>
Actual Footage Location of Well: <b>1950</b> feet from the <b>South</b> line and <b>1450</b> feet from the <b>West</b> line				
Ground Level Elev. <b>6855</b>	Producing Formation <b>Pictured Cliffs/Mesa Verde Gobernador</b>	Pool <b>PC/Blanco MV</b>	Dedicated Acreage: <b>160-PC 320-MV</b> Acres	

1. Outline the acreage dedicated to the subject well by colored pencil or hachure marks on the plat below.
2. If more than one lease is dedicated to the well, outline each and identify the ownership thereof (both as to working interest and royalty).
3. If more than one lease of different ownership is dedicated to the well, have the interests of all owners been consolidated by communitization, unitization, force-pooling, etc?

☒ Yes ☐ No If answer is "yes," type of consolidation Unitization

If answer is "no," list the owners and tract descriptions which have actually been consolidated. (Use reverse side of this form if necessary.)

No allowable will be assigned to the well until all interests have been consolidated (by communitization, unitization, forced-pooling, or otherwise) or until a non-standard unit, eliminating such interests, has been approved by the Commission.

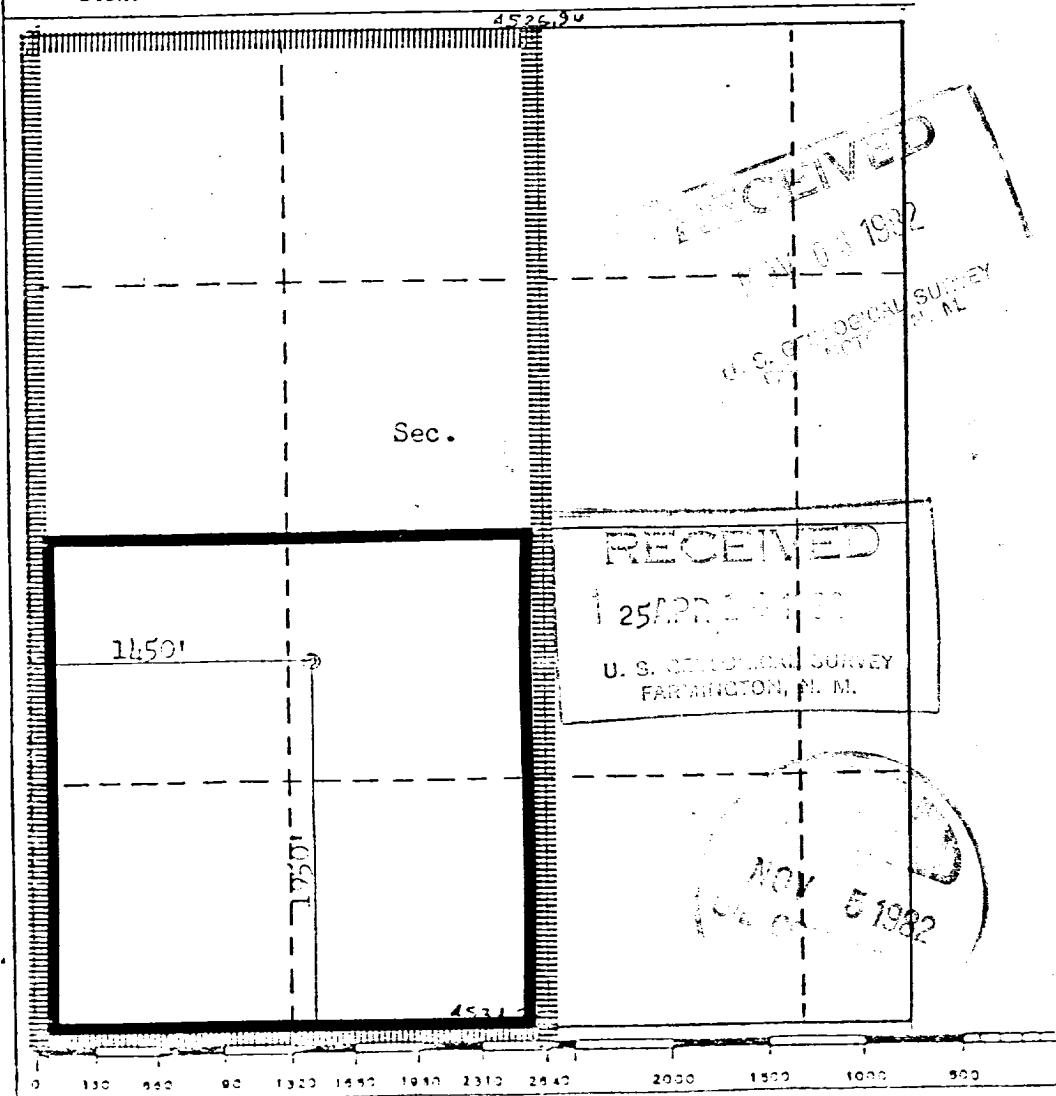

#### CERTIFICATION

I hereby certify that the information contained herein is true and complete to the best of my knowledge and belief.

Paul C. Thompson

Name  
Paul C. Thompson

Position  
Drilling Engineer

Company  
Northwest Pipeline Corp

Date  
April 5, 1982

I hereby certify that the well location shown on this plat was plotted from field notes of actual surveys made by me or under my supervision, and that the same is true and correct to the best of my knowledge and belief.

Date Surveyed

March 2, 1982

Registered Professional Engineer and/or Land Surveyor  
Fred B. Kerr Jr.

Certificate No.

3950