

Submit to Appropriate
District Office
State Lease - 6 copies
Fee Lease - 5 copies

State of New Mexico
Energy, Minerals and Natural Resources Department

Form C-101
Revised 1-1-89

OIL CONSERVATION DIVISION

P.O. Box 2088
Santa Fe, New Mexico 87504-2088

DISTRICT I
P.O. Box 1980, Hobbs, NM 88240

DISTRICT II
P.O. Drawer DD, Artesia, NM 88210

DISTRICT III
1000 Rio Brazos Rd., Aztec, NM 87410

API NO. (assigned by OCD on New Wells)

30-039-24605

5. Indicate Type of Lease

STATE ☐

FEE ☒

6. State Oil & Gas Lease No.

APPLICATION FOR PERMIT TO DRILL, DEEPEN, OR PLUG BACK

1a. Type of Work:

DRILL ☒

RE-ENTER ☐

DEEPEN ☐

PLUG BACK ☐

b. Type of Well:

OIL
WELL ☐

GAS
WELL ☒

OTHER

SINGLE
ZONE ☒

MULTIPLE
ZONE ☐

7. Lease Name or Unit Agreement Name

San Juan 29-5 Unit

2. Name of Operator

Northwest Pipeline Corporation

8. Well No.

207

3. Address of Operator

3539 East 30th St., Farmington, NM 87401

9. Pool name or Wildcat

Basin Fruitland Coal Gas

4. Well Location

Unit Leit-7 A : 891 Feet From The North Line and 1308 Feet From The East Line

Section 21

Township 29N

Range 5W

NMPM

Rio Arriba

County

10. Proposed Depth

3650' (\pm)

11. Formation

Fruitland

12. Rotary or C.T.

Rotary

13. Elevations (Show whether DF, RT, GR, etc.)

6669' (GL unprepared)

14. Kind & Status Plug. Bond

Blanket

15. Drilling Contractor

Advise Later

16. Approx. Date Work will start

Upon Approval

17.

PROPOSED CASING AND CEMENT PROGRAM

E/320

SIZE OF HOLE	SIZE OF CASING	WEIGHT PER FOOT	SETTING DEPTH	SACKS OF CEMENT	EST. TOP
12 $\frac{1}{4}$ "	9-5/8"	36# K-55 ST&C	250'	150 SXS	Circ to Surface
8 $\frac{1}{2}$ "	7"	23# K-55 LT&C	3270'	380 SXS	Circ to Surface
* 6-1/8"	5 $\frac{1}{2}$ " Liner	15.5# or 23#	3650'		Top of Liner

*If the coal is cleated a 5 $\frac{1}{2}$ ", 23#, P-110, LT&C liner will be run in the opened hole without being cemented.

*If coal is not cleated a 5 $\frac{1}{2}$ ", 15.5#, J-55, LT&C liner will be run and cemented w/85 Sxs and the well will be fractured.

APPROVAL EXPIRES 6-16-90
UNLESS DRILLING IS COMMENCED.
SPUD NOTICE MUST BE SUBMITTED
WITHIN 10 DAYS.

RECEIVED

JAN 16 1990

OIL CON. DIV.
DIST. 3

Use mud additives as required for control.

BOP Equipment: (See attached schematic - Fig. 7-9 or 7-10)

IN ABOVE SPACE DESCRIBE PROPOSED PROGRAM: IF PROPOSAL IS TO DEEPEN OR PLUG BACK, GIVE DATA ON PRESENT PRODUCTIVE ZONE AND PROPOSED NEW PRODUCTIVE ZONE. GIVE BLOWOUT PREVENTER PROGRAM, IF ANY.

I hereby certify that the information above is true and complete to the best of my knowledge and belief.

SIGNATURE Paul C. Thompson TITLE Manager, Production & Drlg DATE 1-12-90

TYPE OR PRINT NAME Paul Thompson TELEPHONE NO. 599-3400

(This space for State Use)

(Sanders)

APPROVED BY [Signature] TITLE SUPERVISOR DISTRICT III DATE JAN 16 1990

CONDITIONS OF APPROVAL, IF ANY:

Submit to Appropriate
District Office
State Lease - 4 copies
Fee Lease - 3 copies

State of New Mexico
Energy, Minerals and Natural Resources Department

Form C-102
Revised 1-1-89

OIL CONSERVATION DIVISION

P.O. Box 2088
Santa Fe, New Mexico 87504-2088

DISTRICT I
P.O. Box 1980, Hobbs, NM 88240

DISTRICT II
P.O. Drawer DD, Artesia, NM 88210

DISTRICT III
1000 Rio Brazos Rd., Aztec, NM 87410

WELL LOCATION AND ACREAGE DEDICATION PLAT

All Distances must be from the outer boundaries of the section

Operator NORTHWEST PIPELINE CORP.			Lease SAN JUAN 29-5 UNIT		Well No. 207
Unit Letter A	Section 21	Township 1.29 N.	Range R.5 W.	County RIO ARriba COUNTY	
Actual Footage Location of Well: 891 feet from the NORTH line and 1308 feet from the EAST line					
Ground level Elev. 6669	Producing Formation Fruitland		Pool Basin Fruitland Coal Gas		Dedicated Acreage: 320 Acres

1. Outline the acreage dedicated to the subject well by colored pencil or hatchure marks on the plat below.

2. If more than one lease is dedicated to the well, outline each and identify the ownership thereof (both as to working interest and royalty).

3. If more than one lease of different ownership is dedicated to the well, have the interest of all owners been consolidated by communitization, unitization, force-pooling, etc.?

☒ Yes ☐ No If answer is "yes" type of consolidation Communitization

If answer is "no" list the owners and tract descriptions which have actually been consolidated. (Use reverse side of this form if necessary.)

No allowable will be assigned to the well until all interests have been consolidated (by communitization, unitization, forced-pooling, or otherwise) or until a non-standard unit, eliminating such interest, has been approved by the Division.

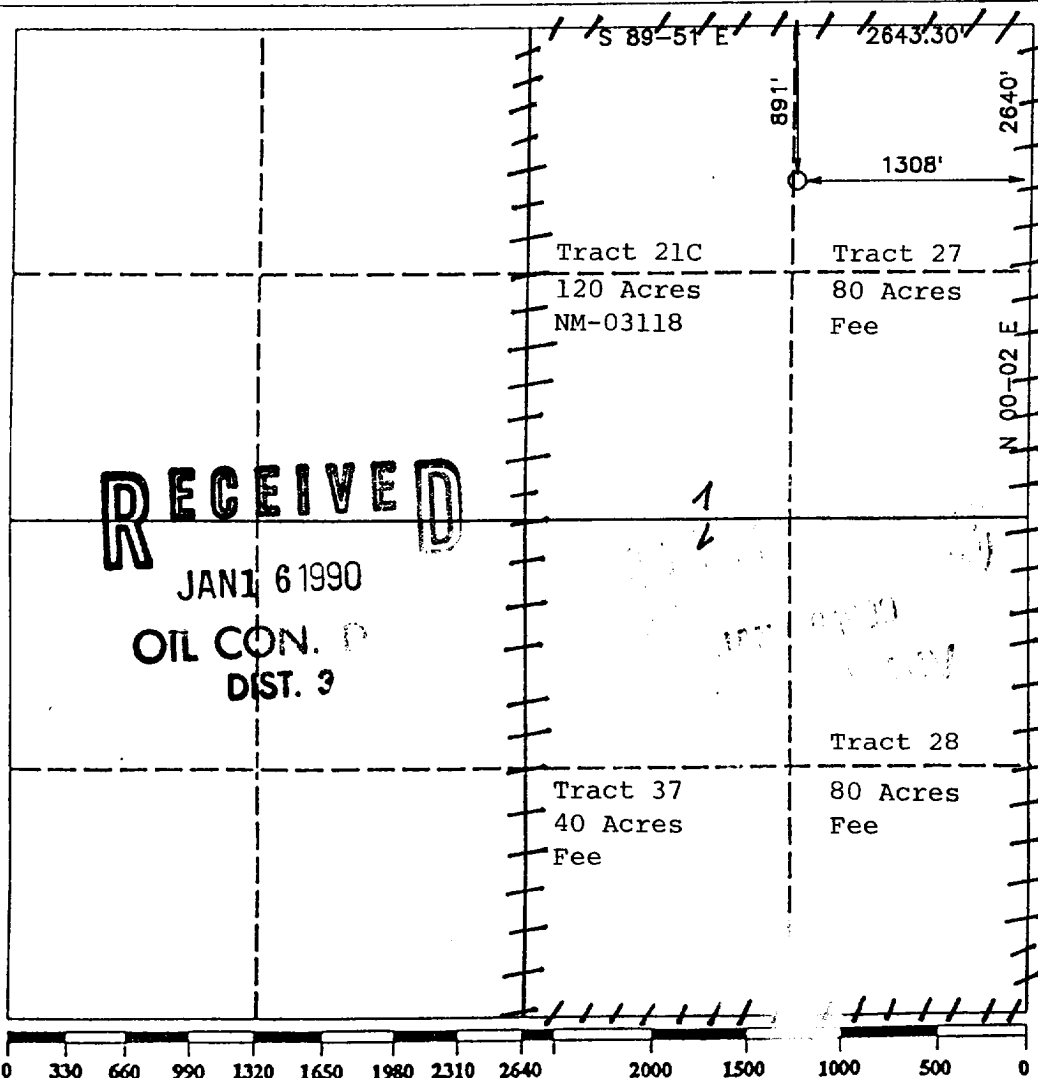

OPERATOR CERTIFICATION

I hereby certify that the information contained herein is true and complete to the best of my knowledge and belief.

Signature Paul C. Thompson
Paul Thompson

Printed Name
Manager, Prod. & Drilg.

Position
Northwest Pipeline Corp.

Company
1-12-90

Date

SURVEYOR CERTIFICATION

I hereby certify that the well location shown on this plat was plotted from field notes of actual surveys made by me or under my supervision, and that the same is true and correct to the best of my knowledge and belief.

Date Surveyed
DECEMBER 20 1989

Signature R. Howard Daggett
Professional Surveyor
R. HOWARD DAGGETT
9879

Certificate No. 6879
REGISTERED PROFESSIONAL LAND SURVEYOR

Registered Professional
Land Surveyor

FIELD PRACTICES AND STANDARDS

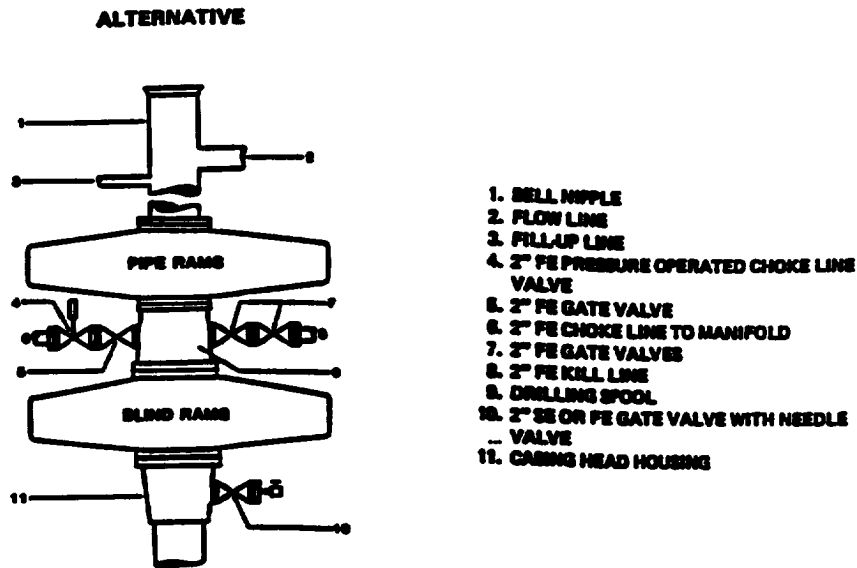

NOTE: THE DRILLING SPOOL MAY BE LOCATED BELOW BOTH SETS OF RAMS IF A DOUBLE PREVENTER IS USED AND IT DOES NOT HAVE SUITABLE OUTLETS BETWEEN RAMS

**Figure 7-9. Standard Hydraulic Blowout Preventer Assembly
3 M Working Pressure Alternative 1**

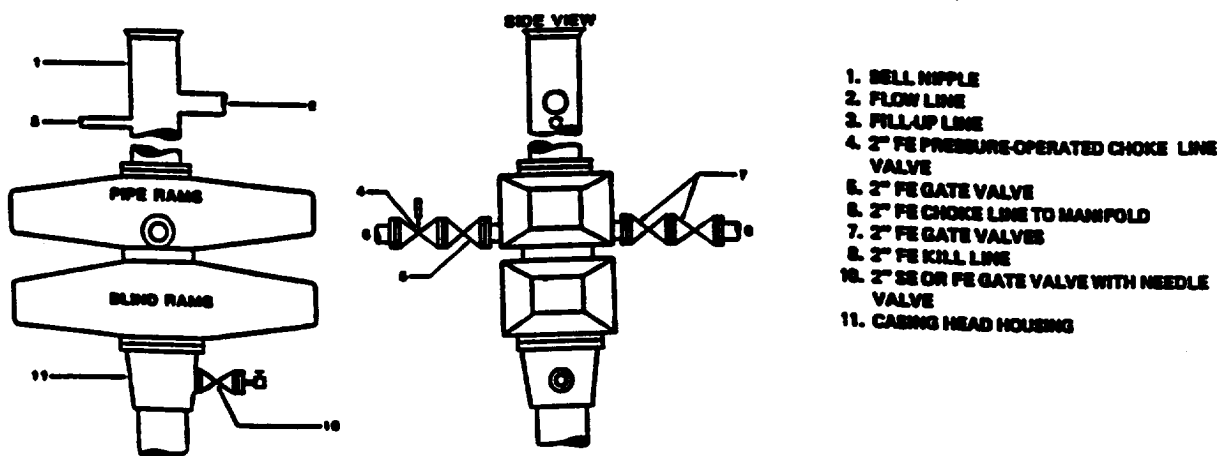

**Figure 7-10. Standard Hydraulic Blowout Preventer Assembly
3 M Working Pressure Alternative 3 (without Drilling Spool)**

