

OIL CONSERVATION DIVISION
P.O. Box 2088
Santa Fe, New Mexico 87504-2088

APPLICATION FOR PERMIT TO DRILL, DEEPEN,
OR PLUG BACK

API NO. (assigned by OCD on new well)

RECEIVED
JUL 11 1990

30-039-24230

5. Indicate Type of Lease
STATE

6. State Oil & Gas Lease No.
B-10037-55

1a. Type of Work
DRILL

**OIL CON. DIV.
DIST. 3**

7. Lease Name or Unit Agreement Name
SAN JUAN 29-7 UNIT

b. Type of Well
GAS SINGLE ZONE

2. Name of Operator
MERIDIAN OIL INC.

8. Well No.
582

3. Address of Operator
PO Box 4289, Farmington, NM 87499

9. Pool Name or Wildcat
BASIN FRUITLAND COAL

4. Well Location
Unit letter M 790' FSL 790' FWL
Section 2 T29N R07W NMPM RIO ARRIBA COUNTY

10. Proposed Depth
3395'

11. Formation 12. Rotary or C.T.
FRUITLAND COAL Rotary

13. Elevation
6528' GL

14. Bond Type
statewide

15. Drill. Contractor

16. Est. Start Date
upon approval

17. PROPOSED CASING AND CEMENT PROGRAM

SIZE HOLE	SIZE CASING	WT. PER FT.	SET. DEPTH	SKS OF CEMENT	EST. TOP
12 1/4"	9 5/8"	32.3#	200 ft.	189 cu.ft.	circ surface
8 3/4"	7"	20.0#	3226 ft.	1028 cu.ft.	circ surface
6 1/4"	5 1/2"	15.5#	3395 ft.	do not cmt.	

The Fruitland Coal formation will be completed.
A minimum 2000 psi working pressure double gate blowout preventer
equipped with blind and pipe rams will be used for blow out prevention
on this well. This gas is dedicated.
The W/2 of Sec 2 is dedicated to this well.

I hereby certify that the information above is true and complete to the best
of my knowledge and belief.

SIGNATURE *[Signature]* TITLE Reg. Drilling Engr. DATE 7/10/90

(This space for State Use)

APPROVED BY *[Signature]*
Conditions of approval, if any:

DEPUTY OIL & GAS INSPECTOR, DIST. #3
TITLE _____ DATE JUL 12 1990

APPROVAL EXPIRES 1-12-91
UNLESS DRILLING IS COMMENCED.
SFUD NOTICE MUST BE SUBMITTED
WITHIN 10 DAYS.

Submit to Appropriate
District Office
State Lease - 4 copies
Fee Lease - 3 copies

State of New Mexico
Energy, Minerals and Natural Resources Department

Form C-102
Revised 1-1-89

OIL CONSERVATION DIVISION

P.O. Box 2088

Santa Fe, New Mexico 87504-2088

DISTRICT I
P.O. Box 1980, Hobbs, NM 88240

DISTRICT II
P.O. Drawer DD, Artesia, NM 88210

DISTRICT III
1000 Rio Brazos Rd., Aztec, NM 87410

WELL LOCATION AND ACREAGE DEDICATION PLAT

All Distances must be from the outer boundaries of the section

Operator Meridian Oil Inc.		Lease (B-10037-55)		Well No. 582	
Unit Letter M		Section 2		Township 29 North	
Range 7 West		County NMPM		Rio Arriba	
Actual Footage Location of Well: 790 feet from the South line and 790 feet from the West line					
Ground level Elev. 6528'		Producing Formation Fruitland Coal		Pool Basin	
					Dedicated Acreage: 318.10 Acres

- Outline the acreage dedicated to the subject well by colored pencil or hectare marks on the plat below.
- If more than one lease is dedicated to the well, outline each and identify the ownership thereof (both as to working interest and royalty).
- If more than one lease of different ownership is dedicated to the well, have the interest of all owners been consolidated by communitization, unitization, force-pooling, etc.?

Yes No If answer is "yes" type of consolidation unitization

If answer is "no" list the owners and tract descriptions which have actually been consolidated. (Use reverse side of this form if necessary.)

No allowable will be assigned to the well until all interests have been consolidated (by communitization, unitization, forced-pooling, or otherwise) or until a non-standard unit, eliminating such interest, has been approved by the Division.

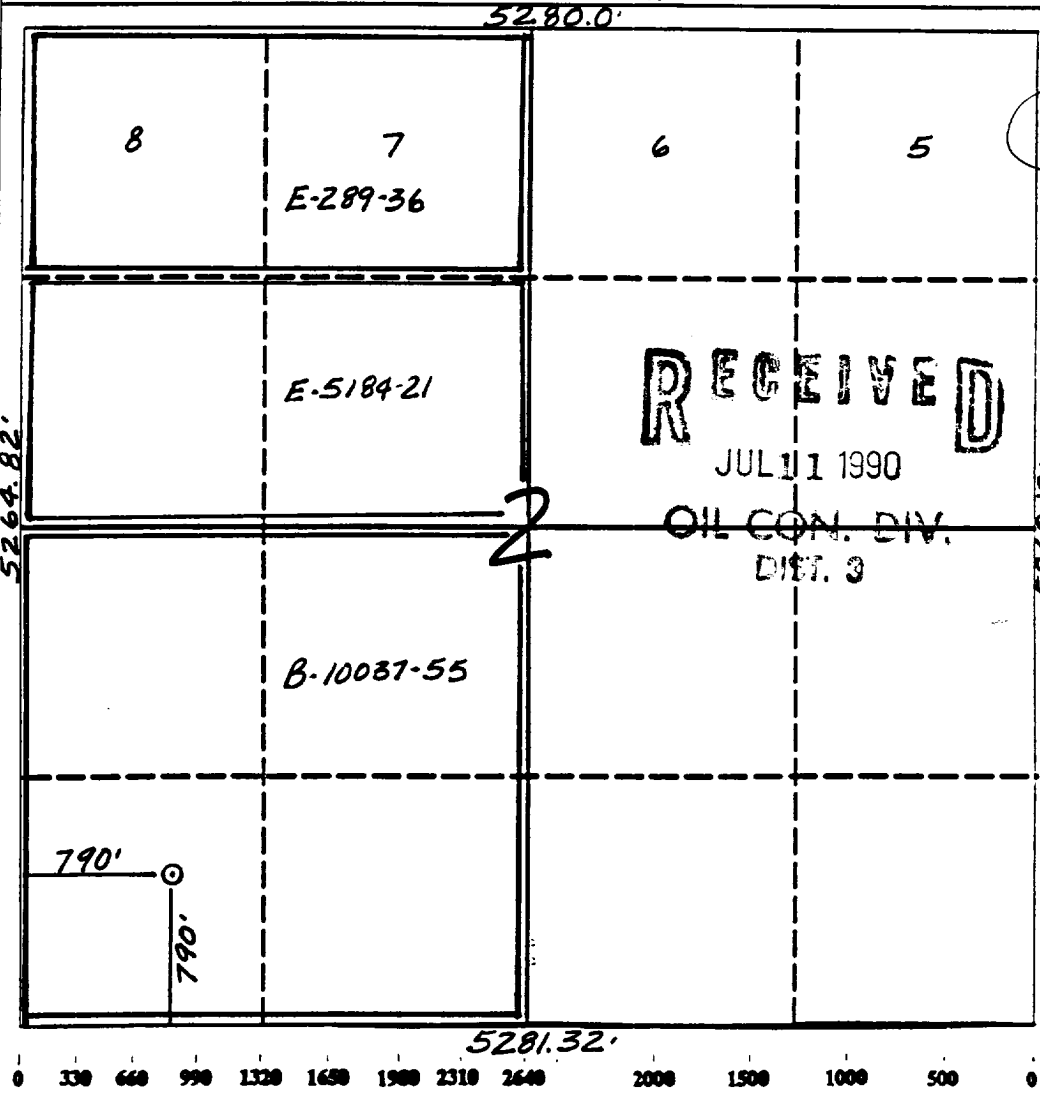

OPERATOR CERTIFICATION

I hereby certify that the information contained herein is true and complete to the best of my knowledge and belief.

Peggy Bradford
Signature

Peggy Bradford
Printed Name

Regulatory Affairs
Position

Meridian Oil Inc.
Company

7-10-90
Date

SURVEYOR CERTIFICATION

I hereby certify that the well location shown on this plat was plotted from field notes of actual surveys made by me or under my supervision, and that the same is true and correct to the best of my knowledge and belief.

7-7-90
Date Surveyed

Neale C. Edwards
Signature

Professional Surveyor
NEW MEXICO
6857
REGISTERED LAND SURVEYOR

Certificate No. 6857

Neale C. Edwards

