

District I
PO Box 1980, Hobbs, NM 88241-1980
District II
811 S. 1st Street, Artesia, NM 88210-2834
District III
1000 Rio Brazos Rd., Aztec, NM 87410
District IV
2040 South Pacheco, Santa Fe, NM 87505

State of New Mexico
Energy, Minerals & Natural Resources Department

OIL CONSERVATION DIVISION
2040 South Pacheco
Santa Fe, NM 87505

Form C-101
Revised October 18, 1994
Instructions on back
Submit to Appropriate District Office
State Lease - 6 Copies
Fee Lease - 5 Copies

☐ AMENDED REPORT

APPLICATION FOR PERMIT TO DRILL, RE-ENTER, DEEPEN, PLUG BACK, OR ADD A ZONE

| | | |
|---|--|--|
| ¹ Operator name and Address Phillips Petroleum Company 5525 Highway 64, NBU 3004 Farmington, NM 87401 | | ² OGRID Number 017654 |
| ⁴ Property Code 009256 | ⁵ Property Name San Juan 29-5 Unit | ³ API Number 30-0 39-26371 |
| | | ⁶ Well No. 6A |

⁷ Surface Location

| UL or lot no. | Section | Township | Range | Lot. Idn | Feet from the | North/South Line | Feet from the | East/West line | County |
|---------------|---------|----------|-------|----------|---------------|------------------|---------------|----------------|------------|
| D | 27 | 29N | 5W | | 790' | North | 790' | West | Rio Arriba |

⁸ Proposed Bottom Hole Location If Different From Surface

| UL or lot no. | Section | Township | Range | Lot. Idn | Feet from the | North/South Line | Feet from the | East/West line | County |
|---------------|---------|----------|-------|----------|---------------|------------------|---------------|----------------|--------|
| D | | | | | | | | | |

| | |
|--|---|
| ⁹ Proposed Pool 1 Basin Dakota 71599 | ¹⁰ Proposed Pool 2 Bianco Mesaverde 72319 |
|--|---|

| | | | | |
|-----------------------------------|--|-----------------------------------|---|---|
| ¹¹ Work Type Code N | ¹² Well Type Code G M | ¹³ Cable/Rotary R | ¹⁴ Lease Type Code P | ¹⁵ Ground Level Elevation 6697' |
| ¹⁶ Multiple Y | ¹⁷ Proposed Depth 8119' | ¹⁸ Formation Dakota | ¹⁹ Contractor 4CAT-Key Energy | ²⁰ Spud Date 2nd Qtr 2000 |

²¹ Proposed Casing and Cement Program

| Hole Size | Casing Size | Casing weight/foot | Setting Depth | Sacks of Cement | Estimated TOC |
|-----------|-------------|--------------------|---------------|-----------------|-----------------------|
| 12-1/4" | 9-5/8" | 36#, J/K-55 | 320'* | 159 sx Type 3 | surface |
| 8-3/4" | 7" | 20#, J/K-55 | 4029' | L-373 sx Type 3 | |
| | | | | T-100 sx Type 3 | surface |
| 6-1/4" | 4-1/2" | 11.6#, J-80 | 8119' | 243 sx C1 H | 100' min to 7" casing |

²² Describe the proposed program. If this application is to DEEPEN or PLUG BACK give the data on the present productive zone and proposed new productive zone. Describe the blowout prevention program, if any. Use additional sheets if necessary

* The surface casing will be set at a minimum of 320', but could be set deeper if required to maintain hole stability.

** The cement for the 4-1/2" casing is designed to cover the open hole section to 100' above the Cliff House formation with 60% excess. Squeeze/circulation cement work will be conducted in an attempt to get the TOC 100' inside the intermediate shoe.

See attached for the details on the cathodic protection groundbed.

²³ I hereby certify that the information given above is true and complete to the best of my knowledge and belief.

Signature:

Monica D. Rodahl

Printed name:

Monica D. Rodahl

Title:

Regulatory Assistant

599-3480

OIL CONSERVATION DIVISION

Approved by:

Charles T. Lerner

Title:

DEPUTY OIL & GAS INSPECTOR, DIST. #

Approval Date:

MAR - 6 2000

Expiration Date:

MAR - 6 2000

District I
PO Box 1908, Hobbs, NM 88241-1908
District II
PO Drawer DD, Artesia, NM 88211-0719
District III
1000 Rio Bravo Rd., Aztec, NM 87410
District IV
PO Box 2088, Santa Fe, NM 87504-2088

State of New Mexico
Energy, Minerals & Natural Resources Department

OIL CONSERVATION DIVISION
PO Box 2088
Santa Fe, NM 87504-2088

Form C-102
Revised February 21, 1994
Instructions on back
Submit to Appropriate District Office
State Lease - 4 Copies
Fee Lease - 3 Copies

☐ AMENDED REPORT

WELL LOCATION AND ACREAGE DEDICATION PLAT

| | | | |
|------------------------------|---|----------------------|-----------------------------|
| * API Number 30-039-26371 | | * Pool Code 71599 | * Pool Name Basin Dakota |
| * Property Code 009256 | * Property Name SAN JUAN 29-5 UNIT | | * Well Number 6A |
| * OGRID No. 017654 | * Operator Name PHILLIPS PETROLEUM COMPANY | | * Elevation 6697' |

10 Surface Location

| | | | | | | | | | |
|--------------------|---------------|-----------------|-------------|---------|-----------------------|---------------------------|-----------------------|------------------------|----------------------|
| UL or lot no. D | Section 27 | Township 29N | Range 5W | Lot Idn | Feet from the 790' | North/South line NORTH | Feet from the 790' | East/West line WEST | County RIO ARriba |
|--------------------|---------------|-----------------|-------------|---------|-----------------------|---------------------------|-----------------------|------------------------|----------------------|

11 Bottom Hole Location If Different From Surface

| | | | | | | | | | |
|-------------------------------|---------|-------------------------|-------|----------------------------|---------------|------------------|---------------|----------------|--------|
| UL or lot no. D | Section | Township | Range | Lot Idn | Feet from the | North/South line | Feet from the | East/West line | County |
| | | | | | | | | | |
| ** Dedicated Acres 320 W/2 | | ** Joint or Infill I | | ** Consolidation Code U | | ** Order No. | | | |

NO ALLOWABLE WILL BE ASSIGNED TO THIS COMPLETION UNTIL ALL INTERESTS HAVE BEEN CONSOLIDATED
OR A NON-STANDARD UNIT HAS BEEN APPROVED BY THE DIVISION

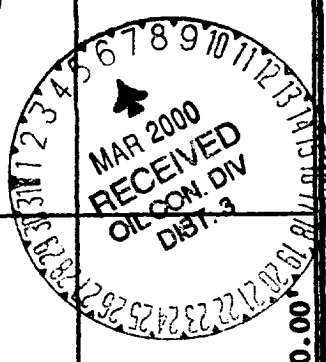
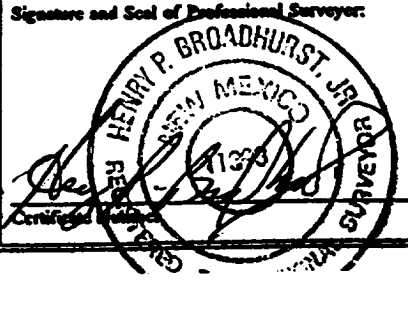
| | | | | | |
|----------------------|------------------------------|----------|--|--|---|
| 16 790' 790' | S89°48'E FEE 437 acres | 5266.80' |  | 17 OPERATOR CERTIFICATION I hereby certify that the information contained herein is true and complete to the best of my knowledge and belief Monice D. Rodahl Signature Monica D. Rodahl Printed Name Regulatory Assistant Title March 3, 2000 Date | |
| 5280.00' | NM-011349A | | | 5280.00' | 18 SURVEYOR CERTIFICATION I hereby certify that the well location shown on this plat was plotted from field notes of actual surveys made by me or under my supervision, and that the same is true and correct to the best of my belief. 02/18/2000 Date of Survey Signature and Seal of Professional Surveyor:  |
| Section 27 | | | | | |
| N00°02'E 5280.00' | NM-011349 | | | N00°03'E 5280.00' | |
| | S89°48'E 5266.80' | | | | |

District I
PO Box 1988, Hobbs, NM 88241-1988
District II
PO Drawer DD, Artesia, NM 88211-0719
District III
1800 Rio Brazos Rd., Aztec, NM 87418
District IV
PO Box 2088, Santa Fe, NM 87504-2088

State of New Mexico
Energy, Minerals & Natural Resources Department

OIL CONSERVATION DIVISION
PO Box 2088
Santa Fe, NM 87504-2088

Form C-102
Revised February 21, 1994
Instructions on back
Submit to Appropriate District Office
State Lease - 4 Copies
Fee Lease - 3 Copies

☐ AMENDED REPORT

WELL LOCATION AND ACREAGE DEDICATION PLAT

| | | | | | |
|------------------------------|--|---|--|---------------------------------|----------------------|
| 1 API Number 30-039-26371 | | 2 Pool Code 72319 | | 3 Pool Name Blanco Mesaverde | |
| 4 Property Code 009256 | | 5 Property Name SAN JUAN 29-5 UNIT | | | 6 Well Number 6A |
| 7 OGRID No. 017654 | | 8 Operator Name PHILLIPS PETROLEUM COMPANY | | | 9 Elevation 6697' |



10 Surface Location

| UL or lot no. | Section | Township | Range | Lot Idn | Feet from the | North/South line | Feet from the | East/West line | County |
|---------------|---------|----------|-------|---------|---------------|------------------|---------------|----------------|------------|
| D | 27 | 29N | 5W | | 790' | NORTH | 790' | WEST | RIO ARriba |

11 Bottom Hole Location If Different From Surface

| UL or lot no. | Section | Township | Range | Lot Idn | Feet from the | North/South line | Feet from the | East/West line | County |
|-------------------------------|---------|-------------------------|-------|----------------------------|---------------|------------------|---------------|----------------|--------|
| D | | | | | | | | | |
| 12 Dedicated Acres 320 W/2 | | 13 Joint or Infill I | | 14 Consolidation Code U | | 15 Order No. | | | |

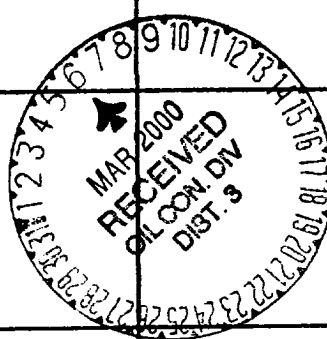
NO ALLOWABLE WILL BE ASSIGNED TO THIS COMPLETION UNTIL ALL INTERESTS HAVE BEEN CONSOLIDATED
OR A NON-STANDARD UNIT HAS BEEN APPROVED BY THE DIVISION

| | | | |
|--|--|--|--|
|  | | 17 OPERATOR CERTIFICATION I hereby certify that the information contained herein is true and complete to the best of my knowledge and belief. Signature: <u>Monica D. Rodahl</u> Printed Name: <u>Monica D. Rodahl</u> Title: <u>Regulatory Assistant</u> Date: <u>March 3, 2000</u> | |
| 18 SURVEYOR CERTIFICATION I hereby certify that the well location shown on this plat was plotted from field notes of actual surveys made by me or under my supervision, and that the same is true and correct to the best of my belief. Date of Survey: <u>02/18/2000</u> Signature and Seal of Professional Surveyor:  | | | |

PHILLIPS PETROLEUM COMPANY

SAN JUAN 29-5 UNIT No. 6A

790' FNL, 790' FWL

NW/4 SEC. 27, T-29-N, R-05-W, N.M.P.M.,

RIO ARriba COUNTY, NEW MEXICO

GROUND LEVEL ELEVATION: 6697'

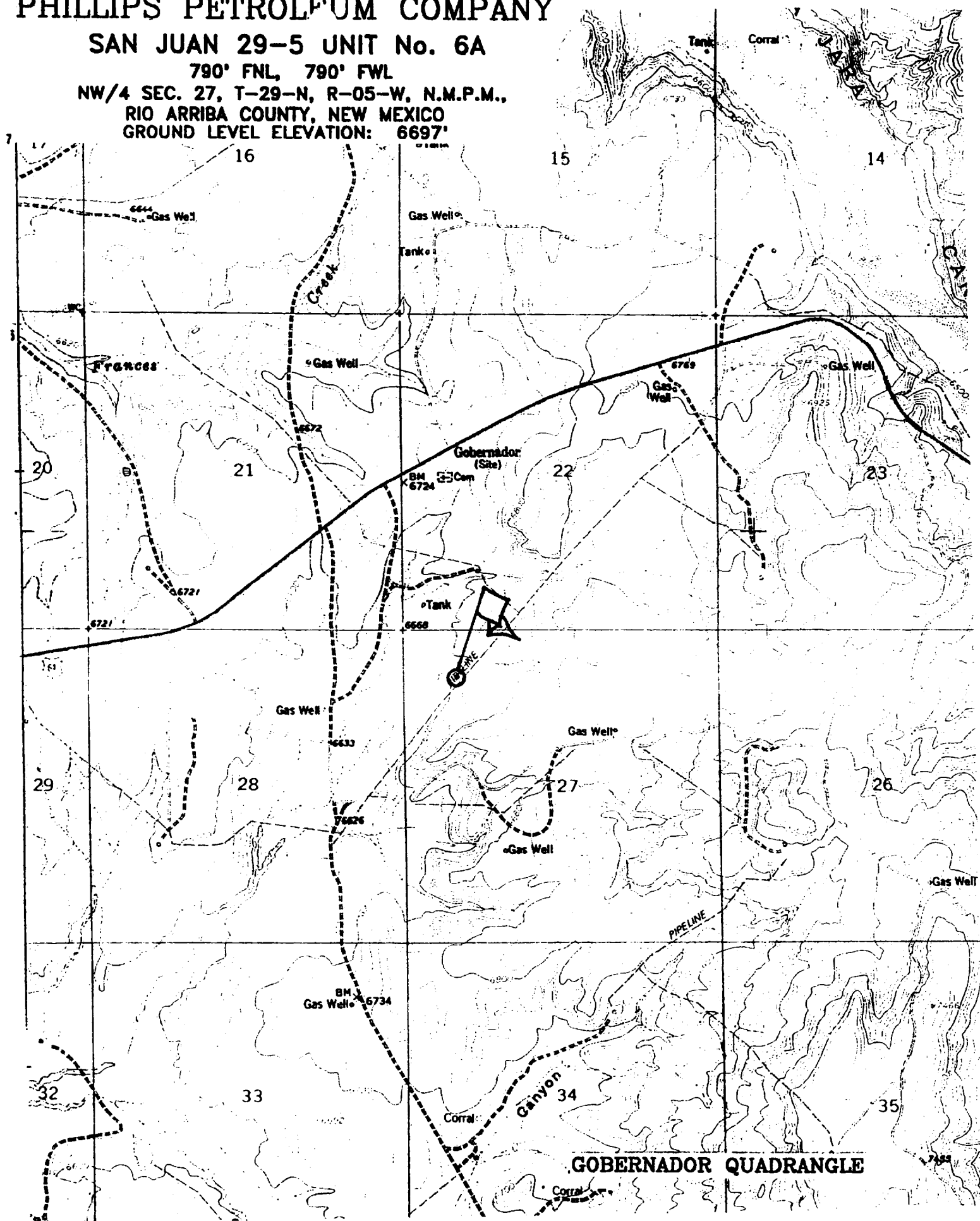

GEOLOGIC PROGNOSIS

Company: **Phillips Petroleum Company**
Project: **2000 Drilling Plan**
Area: **San Juan 29-5 Unit**

Operator: **Phillips Petroleum Company**
Well Name: **San Juan 29-5 Unit No. 6A (Kmv/Kd)**
Location: **NWNW 27-29N-05W**
Footage: **0790' FNL & 0790' FWL**
County/State: **Rio Arriba/New Mexico**

Surveyed GL: **6697** Est (12') KB: **6709**

| <u>Formation</u> | <u>Thickness</u> | <u>Depth</u> | <u>Struct. Elev.</u> |
|----------------------------|-------------------------|---------------------|-----------------------------|
| San Jose Fm. | 1744 | Surface | 6697 |
| Nacimiento Fm. | 1140 | 1744 | 4965 |
| Ojo Alamo Ss. | 170 | 2884 | 3825 |
| Kirtland Sh. | 320 | 3054 | 3655 |
| Fruitland Fm. | 280 | 3374 | 3335 |
| Pictured Cliffs Ss. | 225 | 3654 | 3055 |
| Lewis Sh. | 150 | 3879 | 2830 |
| Int. Csg. Depth | 1430 | 4029 | 2680 |
| Cliff House Ss. | 95 | 5459 | 1250 |
| Menefee Fm. | 265 | 5554 | 1155 |
| Point Lookout Ss. | 320 | 5819 | 890 |
| Mancos Sh. | 925 | 6139 | 570 |
| Gallup Ss. | 740 | 7064 | -355 |
| Greenhorn Ls. | 50 | 7804 | -1095 |
| Graneros Sh. | 115 | 7854 | -1145 |
| Dakota Ss. | 150 | 7969 | -1260 |
| Total Depth | NA | 8119 | -1410 |

Mechanical Logs: DIL from intermediate casing to TD;
CNL/FDC over intervals of interest

Correlation Logs: San Juan 29-5 Unit #43 (SWSW 22-29N-05W)
San Juan 29-5 Unit #75 (SWSW 22-29N-05W)

Estimated Intervals of water, oil and gas:

| | | |
|--------------|---------------|-----------|
| Water: | Ojo Alamo Ss. | 2884-3054 |
| Gas & Water: | Fruitland Fm. | 3374-3654 |
| Gas: | Mesaverde Gp. | 5459-6139 |
| | Dakota Ss. | 7969-8119 |

Notes: Revised for surveyed GL

John E. Bircher

Rev: February 28, 2000

10" 3000 Psi BOP Stack for Gas Drilling

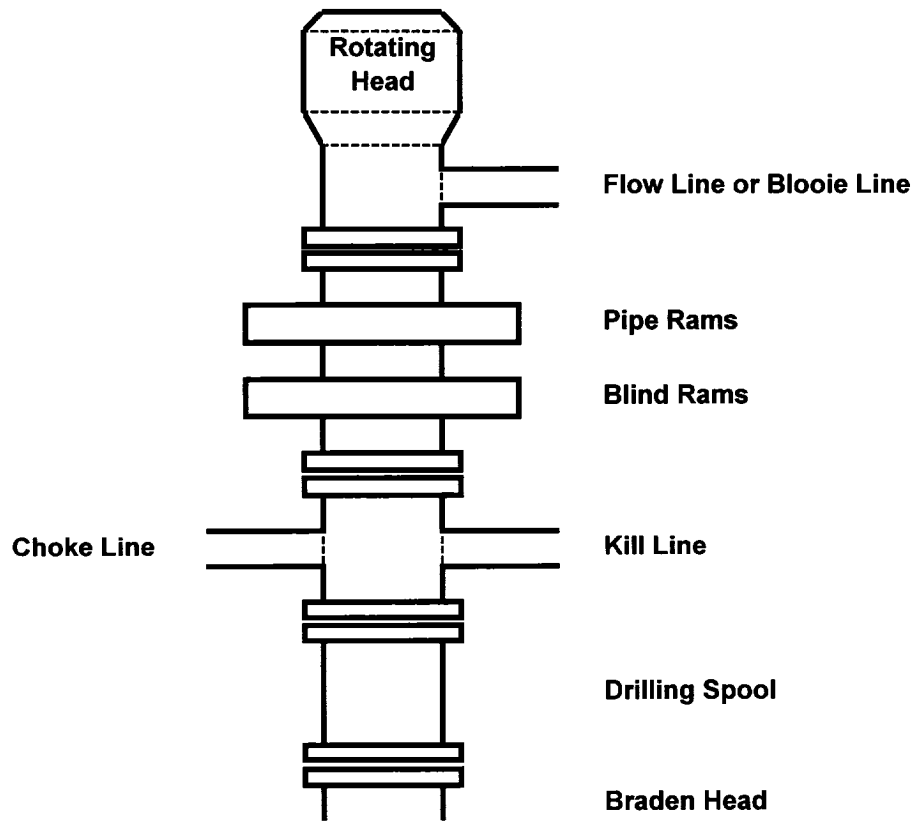

BOP AND RELATED EQUIPMENT CHECK LIST

3M SYSTEM:

2 hydr. rams (pipe & blind) or hydr. ram and annular with blind ram on bottom

Kill Line (2-inch minimum)

1 kill line valve (2-inch minimum)

1 choke line valve

2 chokes (refer to diagram in attachment 1) on choke manifold

Upper kelly cock valve in open position with handle available

Safety valve (in open position) and subs to fit all drill strings in use (with handle available)

Pressure gauged on choke manifold

2 inch minimum choke line

Fill-up line above the uppermost preventer

The BOPs will be pressure tested according to Onshore Order #2 III, A 1 and 30% safety factor.

**San Juan 29-5 Unit #6A
Fee; Unit D, 790' FNL & 790' FWL
Section 27, T29N, R5W; Rio Arriba County, NM**

Cathodic Protection

Phillips proposes to drill a cathodic protection deep well groundbed for the subject well. Will drill a 6-7/8" hole to an anticipated minimum depth of 300' (maximum depth of 500'). Cement plugs will not be used unless more than one water zone is encountered. Prior drilling history for the area indicates only one zone to that depth. If more than one water zone is encountered, notification will be made and details of cement and casing will be provided.

All drilling activity will remain on existing well pad and a Farmington based company will be doing the drilling for Phillips.