

District I
1625 N. French Dr., Hobbs, NM 88240
District II
811 S. 1st Street, Artesia, NM 88210
District III
1000 Rio Brazos Rd., Aztec, NM 87410
District IV
2040 South Pacheco, Santa Fe, NM 87505

State of New Mexico
Energy, Minerals & Natural Resources

Form C-101
Revised March 17, 1999

Oil Conservation Division
2040 South Pacheco
Santa Fe, NM 87505

Submit to appropriate District Office
State Lease - 6 Copies
Fee Lease - 5 Copies

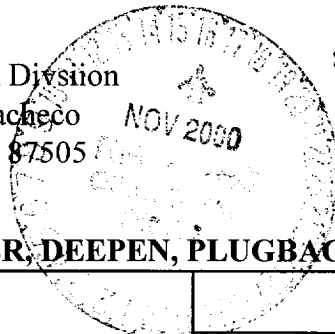

AMENDED REPORT

APPLICATION FOR PERMIT TO DRILL, RE-ENTER, DEEPEN, PLUGBACK, OR ADD A ZONE

¹ Operator Name and Address Phillips Petroleum Company 5525 Highway 64, NBU 3004, Farmington, NM 87401		² OGRID Number 017654
⁴ Property Code 009256	⁵ Property Name San Juan 29-5 Unit	³ API Number 30-039-26564
		⁶ Well No. 55M

⁷ Surface Location

UL or lot no.	Section	Township	Range	Lot. Idn	Feet from the	North/South Line	Feet from the	East/West line	County
C	18	29N	5W		1262'	North	1978'	West	Rio Arriba

⁸ Proposed Bottom Hole Location If Different From Surface

UL or lot no.	Section	Township	Range	Lot. Idn	Feet from the	North/South Line	Feet from the	East/West line	County
C									

⁹ Proposed Pool 1

Blanco Mesaverde - 72319

¹⁰ Proposed Pool 2

Basin Dakota - 71599

¹¹ Work Type Code N	¹² Well Type Code M	¹³ Cable/Rotary R	¹⁴ Lease Type Code P	¹⁵ Ground Level Elevation 6518'
¹⁶ Multiple Y	¹⁷ Proposed Depth 7972'	¹⁸ Formation Dakota	¹⁹ Contractor Key Energy	²⁰ Spud Date 1st Qtr 2001 (January)

²¹ Proposed Casing and Cement Program

Hole Size	Casing Size	Casing weight/foot	Setting Depth	Sacks of Cement	Estimated TOC
12-1/4"	9-5/8"	32.3#, H-40	320*	158.5 sx	surface
8-3/4"	7"	20#, J/K-55	3707'	L-444 sx:T-50sx	surface
6-1/4"	4-1/2"	11.6#, I/N-80	7972'—	335 sx	**

²² Describe the proposed program. If this application is to DEEPEN or PLUG BACK, give the data on the present productive zone and proposed new productive zone.

Describe the blowout prevention program, if any. Use additional sheets if necessary.

* The surface casing will be set at a minimum of 320', but could be set deeper if required to maintain hole stability.

** The Production String casing cement is designed to cover openhole section with 40% excess and 100' inside the 7" shoe.

See attached for the details on the BOP program and the cathodic protection groundbed.

²³ I hereby certify that the information given above is true and complete to the best of my knowledge and belief.		OIL CONSERVATION DIVISION	
Signature: <i>Patsy Clugston</i>		Approved by: <i>[Signature]</i>	
Printed name: Patsy Clugston		Title: DEPUTY OIL & GAS INSPECTOR DIST. 45	
Title: Sr. Regulatory/Proration Clerk		Approval Date: NOV 16 2000	Expiration Date: NOV 16 2001
Date: 11/15/00	Phone: 505-599-3454	Conditions of Approval:	
		Attached <input type="checkbox"/>	

District I
 (N) Box 1900, Hobbs, NM 88241-1900
 District II
 811 South First, Artesia, NM 88210
 District III
 1000 Rio Brazos Rd., Aztec, NM 87410
 District IV
 2040 South Pacheco, Santa Fe, NM 87505

State of New Mexico
 Energy, Minerals & Natural Resources Department

OIL CONSERVATION DIVISION
 2040 South Pacheco
 Santa Fe, NM 87505

Form C-102
 Revised October 18, 1994
 Instructions on back
 Submit to Appropriate District Office
 State Lease - 4 Copies
 Fee Lease - 3 Copies

AMENDED REPORT

WELL LOCATION AND ACREAGE DEDICATION PLAT

¹ APT Number 30-039-26524		² Pool Code 72319	³ Pool Name Blanco Mesaverde
⁴ Property Code 009256	⁵ Property Name SAN JUAN 29-5 UNIT		⁶ Well Number 55M
⁷ OGRID No. 017654	⁸ Operator Name PHILLIPS PETROLEUM COMPANY		⁹ Elevation 6518'

¹⁰ Surface Location

UL or lot no.	Section	Township	Range	Lot Ida	Feet from the	North/South line	Feet from the	East/West line	County
C	18	29N	5W		1262'	NORTH	1978'	WEST	RIO ARRIBA

¹¹ Bottom Hole Location If Different From Surface

UL or lot no.	Section	Township	Range	Lot Ida	Feet from the	North/South line	Feet from the	East/West line	County
C									

¹² Dedicated Acres	¹³ Joint or Infill	¹⁴ Consolidation Code	¹⁵ Order No.
320 W/2	Y	U	

NO ALLOWABLE WILL BE ASSIGNED TO THIS COMPLETION UNTIL ALL INTERESTS HAVE BEEN CONSOLIDATED OR A NON-STANDARD UNIT HAS BEEN APPROVED BY THE DIVISION

	<p>¹⁷ OPERATOR CERTIFICATION</p> <p>I hereby certify that the information contained herein is true and complete to the best of my knowledge and belief</p> <p><i>Patsy Clugston</i></p> <p>Signature Patsy Clugston</p> <p>Printed Name Sr. Regulatory/Proration Clerk</p> <p>Title November 15, 2000</p> <p>Date</p>
	<p>¹⁸ SURVEYOR CERTIFICATION</p> <p>I hereby certify that the well location shown on this plat was plotted from field notes of actual surveys made by me or under my supervision, and that the same is true and correct to the best of my belief.</p> <p>08/22/00</p> <p>Date of Survey</p> <p>Signature and Seal of Professional Surveyer:</p>
	<p>Certificate Number</p>

HILLIPS PETROLEUM COMPANY

SAN JUAN 29-5 UNIT No. 55M

1262' FNL, 1978' FWL

NW/4 SEC. 18, T-29-N, R-05-W, N.M.P.M.,
RIO ARRIBA COUNTY, NEW MEXICO
GROUND LEVEL ELEVATION: 6518'

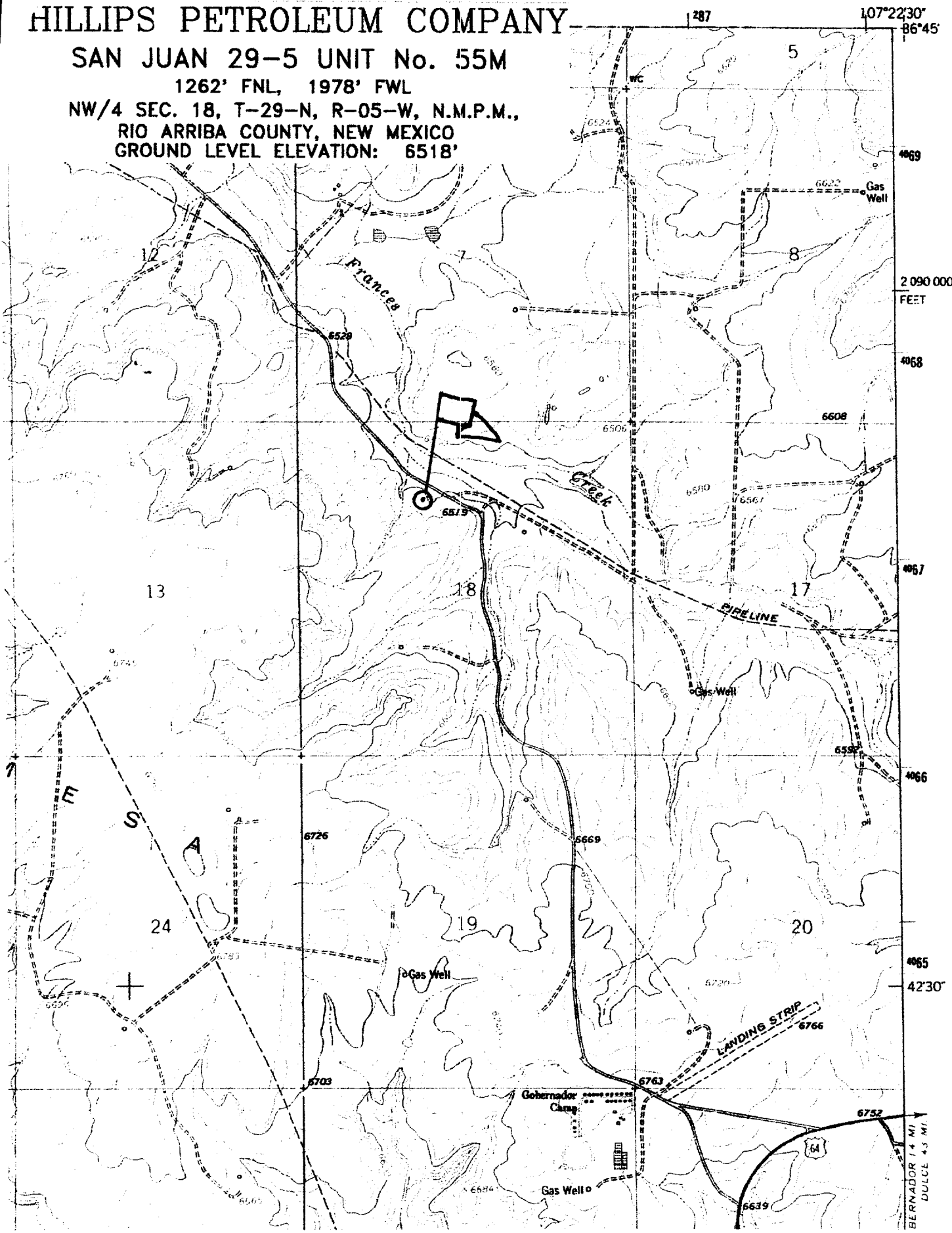

BOP AND RELATED EQUIPMENT CHECK LIST

3M SYSTEM:

2 hydr. rams (pipe & blind) or hydr. ram and annular with blind ram on bottom

Kill Line (2-inch minimum)

1 kill line valve (2-inch minimum)

1 choke line valve

2 chokes (refer to diagram in attachment 1) on choke manifold

Upper kelly cock valve in open position with handle available

Safety valve (in open position) and subs to fit all drill strings in use (with handle available)

Pressure gauged on choke manifold

2 inch minimum choke line

Fill-up line above the uppermost preventer

The BOPs will be pressure tested according to Onshore Order #2 III, A 1 and 30% safety factor.