

(SUBMIT IN TRIPLICATE)

UNITED STATES
DEPARTMENT OF THE INTERIOR
GEOLOGICAL SURVEY

Land Office Santa Fe
Lease No. 080377
Unit San Juan 29-6 Unit

SUNDRY NOTICES AND REPORTS ON WELLS

NOTICE OF INTENTION TO DRILL	SUBSEQUENT REPORT OF WATER SHUT-OFF	
NOTICE OF INTENTION TO CHANGE PLANS	SUBSEQUENT REPORT OF SHOOTING OR ACIDIZING	
NOTICE OF INTENTION TO TEST WATER SHUT-OFF	SUBSEQUENT REPORT OF ALTERING CASING	
NOTICE OF INTENTION TO RE-DRILL OR REPAIR WELL	SUBSEQUENT REPORT OF RE-DRILLING OR REPAIR	
NOTICE OF INTENTION TO SHOOT OR ACIDIZE	SUBSEQUENT REPORT OF ABANDONMENT	X
NOTICE OF INTENTION TO PULL OR ALTER CASING	SUPPLEMENTARY WELL HISTORY	
NOTICE OF INTENTION TO ABANDON WELL		

(INDICATE ABOVE BY CHECK MARK NATURE OF REPORT, NOTICE, OR OTHER DATA)

September 26, 1963

Well No. 35 (ND) is located 890 ft. from S line and 1090 ft. from W line of sec. 15

SW/4 Sec. 15

29N

6W

N.M.P.M.

(1/4 Sec. and Sec. No.)

(Twp.)

(Range)

(Meridian)

Blanco M.V. & Basin Dakota

Rio Arriba

New Mexico

(Field)

(County or Subdivision)

(State or Territory)

The elevation of the derrick floor above sea level is 6450 ft.

DETAILS OF WORK

(State names of and expected depths to objective sands; show sizes, weights, and lengths of proposed casings; indicate mudding jobs, cementing points, and all other important proposed work)

This plat is being re-issued to show South Half Dakota dedication.



I understand that this plan of work must receive approval in writing by the Geological Survey before operations may be commenced.

Company El Paso Natural Gas Company

Box 990

Address _____

Farmington, New Mexico

By OR. G. NAL SIGNED E. S. OBERLY

Title Petroleum Engineer

Well Location and Acreage Dedication Plat

Section A.

Date **AUGUST 3, 1960**

Operator **EL PASO NATURAL GAS COMPANY** Lease **SAN JUAN 29-6 UNIT** SF **080377**
 Well No. **35(MD)** Unit Letter **M** Section **15** Township **29-N** Range **6-W** NMPM
 Located **890** Feet From **SOUTH** Line **1090** Feet From **WEST** Line
 County **RIO ARriba** G. L. Elevation **6440** Dedicated Acreage **320 & 320** Acres
 Name of Producing Formation **MESA VERDE & DAKOTA** Pool **BLANCO MV & WILDCAT DAKOTA**

1. Is the Operator the only owner in the dedicated acreage outlined on the plat below? **Basin**
 Yes ☒ No ☐
2. If the answer to question one is "no", have the interests of all the owners been consolidated by communitization agreement or otherwise? Yes ☐ No ☐ If answer is "yes", Type of Consolidation.

3. If the answer to question two is "no", list all the owners and their respective interests below:

Owner

Land Description

Section B.

This is to certify that the information in Section A above is true and complete to the best of my knowledge and belief.

El Paso Natural Gas Company

(Operator)

OR G NAL SIGNED **E. S. OBERLY**

(Representative)

Box 990

(Address)

Farmington, New Mexico

NOTE: THIS PLAT IS REISSUED TO SHOW SOUTH HALF DAKOTA DEDICATION.

9 23 63

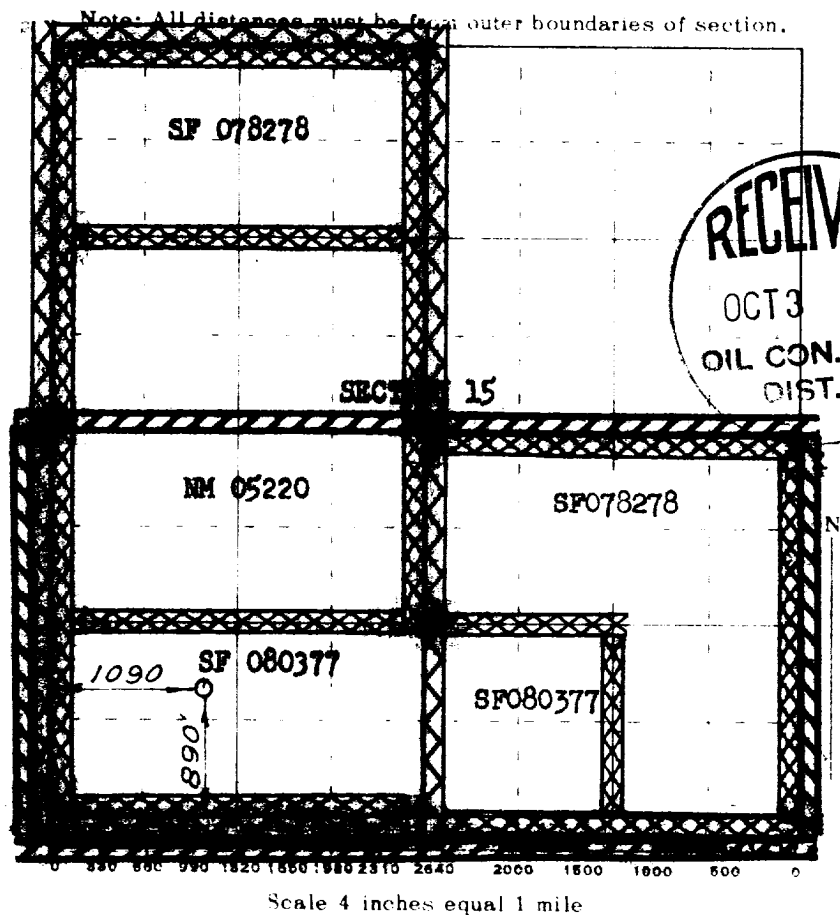

This is to certify that the above plat was prepared from field notes of actual surveys made by me or under my supervision and that the same are true and correct to the best of my knowledge and belief.

Date Surveyed **SEPTEMBER 1, 1955**

John P. Lee
 Registered Professional Engineer and/or Land Surveyor

