

UNITED STATES
DEPARTMENT OF THE INTERIOR
GEOLOGICAL SURVEY

APPLICATION FOR PERMIT TO DRILL, DEEPEN, OR PLUG BACK

| | | | | | |
|--|--|--|---|--|--|
| 1a. TYPE OF WORK DRILL <input checked="" type="checkbox"/> DEEPEN <input type="checkbox"/> PLUG BACK <input type="checkbox"/> | | | 5. LEASE DESIGNATION AND SERIAL NO. NOO-C-14-20-5322 | | |
| b. TYPE OF WELL OIL WELL <input checked="" type="checkbox"/> GAS WELL <input type="checkbox"/> OTHER Wildcat SINGLE ZONE <input type="checkbox"/> MULTIPLE ZONE <input type="checkbox"/> | | | 6. IF INDIAN, ALLOTTEE OR TRIBE NAME Navajo | | |
| 2. NAME OF OPERATOR Palmer Oil Company | | | 7. UNIT AGREEMENT NAME | | |
| 3. ADDRESS OF OPERATOR P.O. Box 2564, Billings, Montana 59103 | | | 8. FARM OR LEASE NAME Navajo | | |
| 4. LOCATION OF WELL (Report location clearly and in accordance with any State requirements.) At surface 2180 f S line + 2180 f E line, Section 20, Township 28 North, Range 16 West, San Juan County, New Mexico At proposed prod. zone Same | | | 9. WELL NO. 1 | | |
| 14. DISTANCE IN MILES AND DIRECTION FROM NEAREST TOWN OR POST OFFICE* 10 miles SE of Shiprock, New Mexico | | | 10. FIELD AND POOL, OR WILDCAT Wildcat <i>Dakota</i> | | |
| 15. DISTANCE FROM PROPOSED* LOCATION TO NEAREST PROPERTY OR LEASE LINE, FT. (Also to nearest drig. unit line, if any) 2180' | | | 11. SEC., T., R., M., OR BLK. AND SURVEY OR AREA NWNWSE Sec. 20, T28N, R16W | | |
| 16. NO. OF ACRES IN LEASE 1280 | | | 12. COUNTY OR PARISH 13. STATE San Juan New Mexico | | |
| 17. DISTANCE FROM PROPOSED LOCATION* TO NEAREST WELL, DRILLING, COMPLETED, OR APPLIED FOR, ON THIS LEASE, FT. 3700' | | | 17. NO. OF ACRES ASSIGNED TO THIS WELL 40 | | |
| 18. PROPOSED DEPTH 2800' | | | 20. ROTARY OR CABLE TOOLS Rotary | | |
| 21. ELEVATIONS (Show whether DF, RT, GR, etc.) 5374' Gr. | | | 22. APPROX. DATE WORK WILL START* December 1, 1975 | | |

PROPOSED CASING AND CEMENTING PROGRAM

| SIZE OF HOLE | SIZE OF CASING | WEIGHT PER FOOT | SETTING DEPTH | QUANTITY OF CEMENT |
|--------------|----------------|-----------------|---------------|------------------------------------|
| 11" | 7 5/8" | 24# | 60 | Sufficient to circulate to surface |
| 6 3/4" | 4 1/2" | 9.5# | 2800' | 50 sx |

This prospect is a 2800' Dakota wildcat oil test.

Well will be drilled by rotary, logs run and, if commercial, new 4 1/2" casing will be set, cemented and perforated.

When drilling with air, a Guiberson Rotating BOP head will be used.

When drilling with mud, a manual operated BOP will be used and properly tested before drilling with mud.

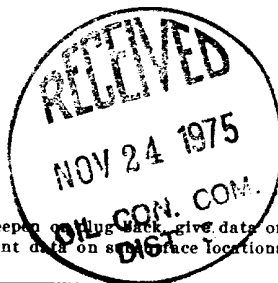

NOV 21 1975

IN ABOVE SPACE DESCRIBE PROPOSED PROGRAM: If proposal is to deepen or plug back, give data on present productive zone and proposed new productive zone. If proposal is to drill or deepen directionally, give pertinent data on surface locations and measured and true vertical depths. Give blowout preventer program, if any.

24. SIGNED [Signature] TITLE Vice-President DATE November 20, 1975
(This space for Federal or State office use)

PERMIT NO. _____ APPROVAL DATE _____

APPROVED BY _____ TITLE _____ DATE _____
CONDITIONS OF APPROVAL, IF ANY:

NEW MEXICO OIL CONSERVATION COMMISSION
WELL LOCATION AND ACREAGE DEDICATION PLAT

Form C-101
Supersedes C-128
Effective 1-1-65

All distances must be from the outer boundaries of the Section.

| | | | | | |
|--|--------------------------------------|-----------------------------|-------------------------|------------------------------------|----------------------|
| Operator PALMER OIL COMPANY | | | Lease NAVAJO | | Well No. 1 |
| Unit Letter J | Section 20 | Township 23 NORTH | Range 16 WEST | County SAN JUAN | |
| Actual Footage Location of Well: 2180 feet from the SOUTH line and 2180 feet from the EAST line | | | | | |
| Ground Level Elev. 5374.0 | Producing Formation DAKOTA | | Pool WILDCAT | Dedicated Acreage: 40 Acres | |

1. Outline the acreage dedicated to the subject well by colored pencil or hatchure marks on the plat below. *ce*
2. If more than one lease is dedicated to the well, outline each and identify the ownership thereof (both as to working interest and royalty).
3. If more than one lease of different ownership is dedicated to the well, have the interests of all owners been consolidated by communitization, unitization, force-pooling, etc?

☐ Yes ☐ No If answer is "yes," type of consolidation _____

If answer is "no," list the owners and tract descriptions which have actually been consolidated. (Use reverse side of this form if necessary.) _____

No allowable will be assigned to the well until all interests have been consolidated (by communitization, unitization, forced-pooling, or otherwise) or until a non-standard unit, eliminating such interests, has been approved by the Commission.

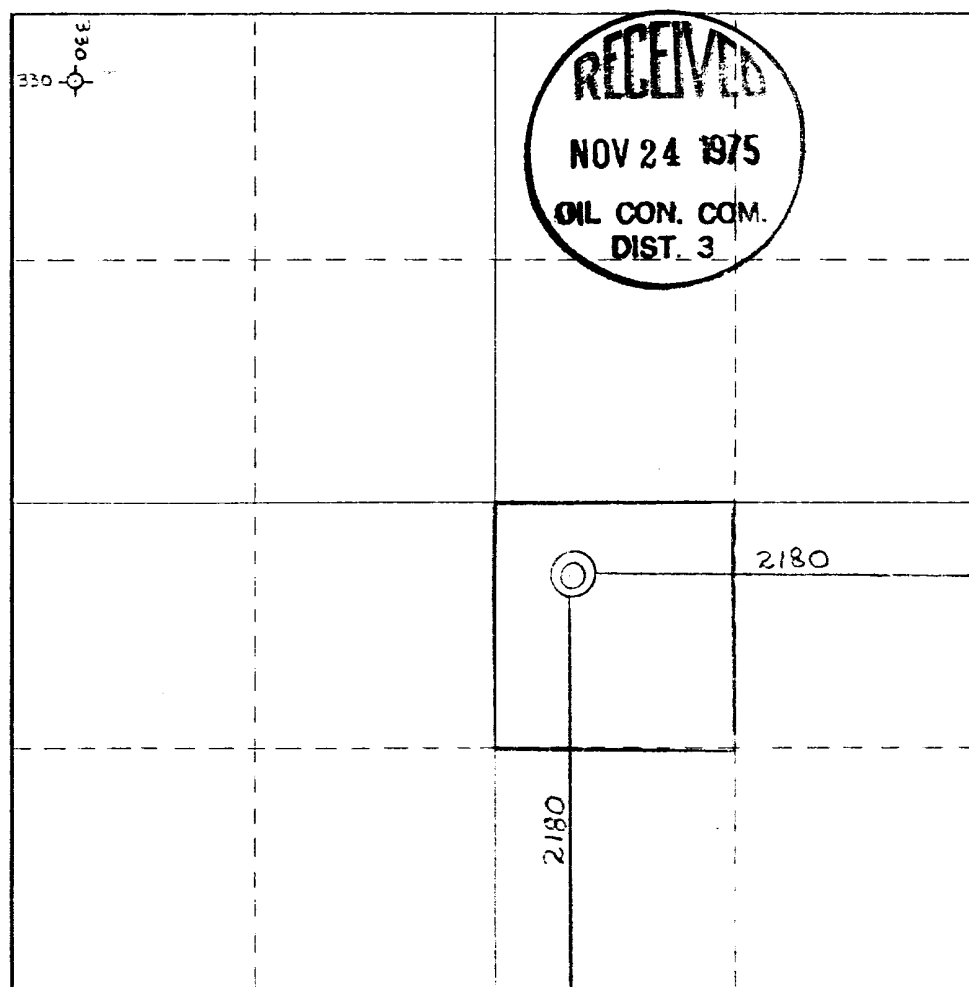

CERTIFICATION

I hereby certify that the information contained herein is true and complete to the best of my knowledge and belief.

Name
Gene L. Shaw
Position
Vice President
Company
Palmer Oil Company
Date
20 November, 1975

I hereby certify that the location shown on this plat was plotted on field notes of actual surveys made by me or under my supervision, and that the same is true and correct to the best of my knowledge and belief.

Date Surveyed
20 November, 1975

Registered Professional Engineer and of Land Survey
James P. Leese
James P. Leese

Certificate No.
1463

0 500 600 900 1200 1500 1800 2100 2400 2700 3000 3300 3600 3900 4200 4500 4800 5100 5400 5700 6000

DEVELOPMENT PLAN

Palmer Oil Company

Navajo 1

1. Existing roads shown on attached plat.
2. Planned access from existing road approximately 4000' to new location.
3. Location of well: Southeast Quarter
Section 20, T 28N, R 16W
San Juan County, New Mexico
4. No additional well(s) planned on this lease at this time.
5. Separator and flow line will be located within 50' of wellhead.
6. Water will be secured from San Juan River.
7. Waste materials will be buried on location or in reserve pit.
8. No permanent camp is planned; trailer house will be used on location while drilling.
9. Do not plan to build airstrip.
10. See attached plat for layout.
11. Pits will be filled, location cleaned up, and area not in use for producing well will be reseeded using broadcast method of planting.

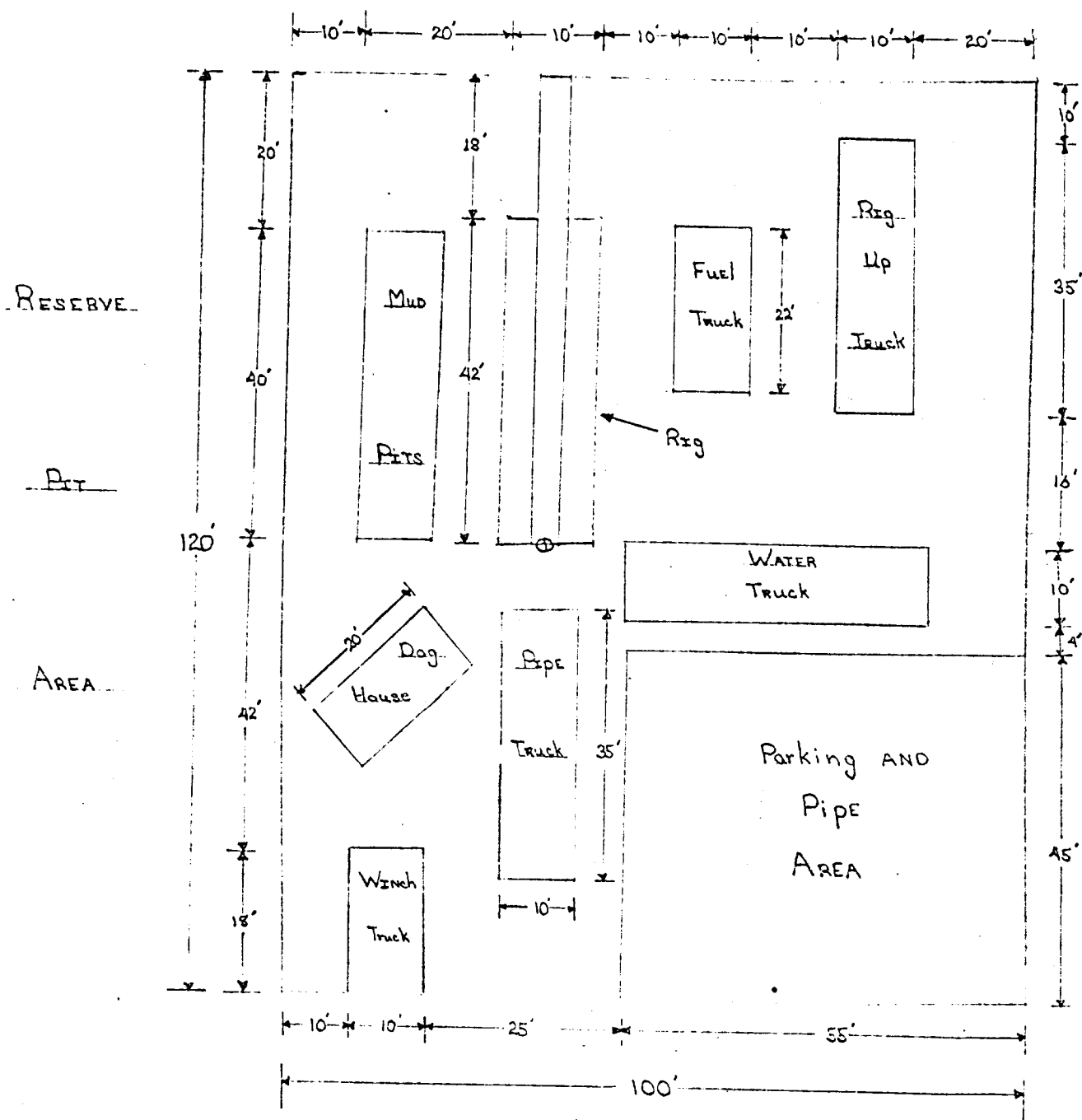

Scale: 1"=20'

LOCATION Plot
For
Wilson Drilling Company D-104

