

(SUBMIT IN TRIPLICATE)

UNITED STATES
DEPARTMENT OF THE INTERIOR
GEOLOGICAL SURVEY

Land Office **Santa Fe**
Lease No. **SW 070425**
Unit **W/2 Sec. 34, T 29N, R 7W**
N.M.P.M. Rio Arriba
County, New Mexico

SUNDRY NOTICES AND REPORTS ON WELLS

NOTICE OF INTENTION TO DRILL.....	<input checked="" type="checkbox"/>	SUBSEQUENT REPORT OF WATER SHUT-OFF.....	
NOTICE OF INTENTION TO CHANGE PLANS.....		SUBSEQUENT REPORT OF SHOOTING OR ACIDIZING.....	
NOTICE OF INTENTION TO TEST WATER SHUT-OFF.....		SUBSEQUENT REPORT OF ALTERING CASING.....	
NOTICE OF INTENTION TO RE-DRILL OR REPAIR WELL.....		SUBSEQUENT REPORT OF RE-DRILLING OR REPAIR.....	
NOTICE OF INTENTION TO SHOOT OR ACIDIZE.....		SUBSEQUENT REPORT OF ABANDONMENT.....	
NOTICE OF INTENTION TO PULL OR ALTER CASING.....		SUPPLEMENTARY WELL HISTORY.....	
NOTICE OF INTENTION TO ABANDON WELL.....			

(INDICATE ABOVE BY CHECK MARK NATURE OF REPORT, NOTICE, OR OTHER DATA)

June 4, 1957

San Juan 29-7 Unit
Well No. **61** is located **950** ft. from **{N}** line and **1740** ft. from **{E}** line of sec. **34**
SE/4 SW/4 Sec. 34 **29 N** **7 W** **N.M.P.M.**
(1/4 Sec. and Sec. No.) (Twp.) (Range) (Meridian)
Blanco Mesaverte **Rio Arriba County,** **New Mexico**
(Field) (County or Subdivision) (State or Territory)

The elevation of the derrick floor above sea level is _____ ft. **To be determined.**

DETAILS OF WORK

(State names of and expected depths to objective sands; show sizes, weights, and lengths of proposed casings; indicate mudding jobs, cementing points, and all other important proposed work)

The objective sands are the Cliff House and Point Lookout formations anticipated at approximately 5025 and 5750' respectively.

Proposed Casing Program: 200' 10 3/4" Cemented to surface
3400' 7 5/8" Cemented with 150 sacks
5750' 5 1/2" Cemented with 250 sacks

Rotary tools will be employed using mud through the Pictured Cliffs and gas drill to T.D.

The well will be perforated and sand fraced in an effort to stimulate production.

I understand that this plan of work must receive approval in writing by the Geological Survey before operations may be commenced.

Company **Southern Union Gas Company**
Address **1001 Bart Building**
Dallas 1, Texas
By **L. S. Macumink**
Title **Exploration Engineer**

NEW MEXICO
OIL CONSERVATION COMMISSION

Form C-12a

WELL LOCATION AND/OR GAS PRORATION PLAT

DATE June 4, 1957

OPERATOR SOUTHERN UNION GAS COMPANY LEASE San Juan 29-7 Unit

WELL NO. 61 SECTION 34 TOWNSHIP 29 NORTH RANGE 7 WEST NMPM

LOCATED 950 FEET FROM the SOUTH LINE 1740 FEET FROM the WEST LINE
RIO ARRIBA COUNTY, NEW MEXICO G.L. ELEVATION To be determined

NAME OF PRODUCING FORMATION Mesa Verde POOL Blanco DEDICATED ACREAGE 300

Note: All distances must be from outer boundaries of section.

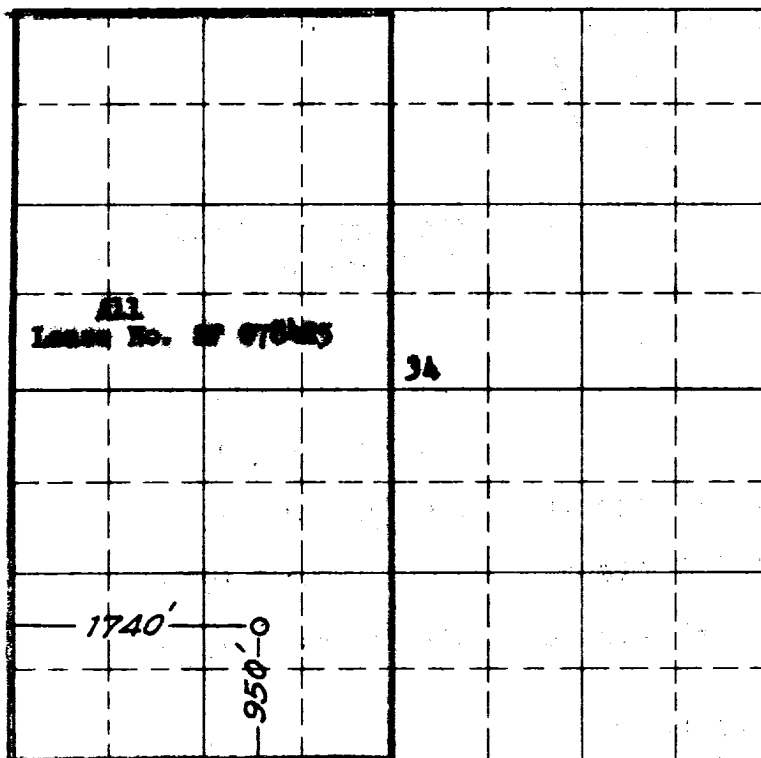

Scale 4 inches equal 1 mile

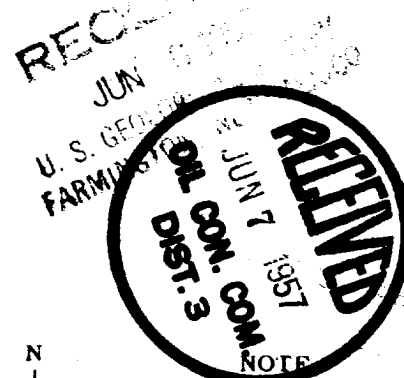

This section of
form is to be used
for gas wells only

This is to certify that the above plat was prepared from
field notes of actual surveys made by me or under my
supervision and that the same are true and correct to the
best of my knowledge and belief.

Date Surveyed 26 MARCH 1957

James P. Lease
Registered Professional Engineer and/or Land Surveyor
JAMES P. LEASE
R. REG. ENG. No. 1463

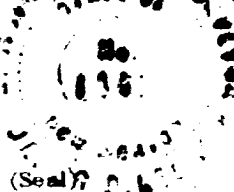

Farmington, New Mexico

1. Is this well a Dual Comp.

Yes _____ No XX

2. If the answer to Question 1
is yes, are there any other dually
completed wells within the
dedicated acreage.

Yes _____ No _____

Name J. S. McQuinn
J. S. McQuinn

Position Registration Engineer

Representing Southern Union Gas Co.

Address 1002 Fort Blvd., Dallas,
Texas