

(SUBMIT IN TRIPLICATE)

UNITED STATES
DEPARTMENT OF THE INTERIOR
GEOLOGICAL SURVEY

Land Office Santa Fe
Lease No. SF 078425
Unit SW/4 SW/4 Sec. 25,
29N-7W, Rio Arriba County,
New Mexico

SUNDRY NOTICES AND REPORTS ON WELLS

NOTICE OF INTENTION TO DRILL.....	X	SUBSEQUENT REPORT OF WATER SHUT-OFF.....
NOTICE OF INTENTION TO CHANGE PLANS.....		SUBSEQUENT REPORT OF SHOOTING OR ACIDIZING.....
NOTICE OF INTENTION TO TEST WATER SHUT-OFF.....		SUBSEQUENT REPORT OF ALTERING CASING.....
NOTICE OF INTENTION TO RE-DRILL OR REPAIR WELL.....		SUBSEQUENT REPORT OF RE-DRILLING OR REPAIR.....
NOTICE OF INTENTION TO SHOOT OR ACIDIZE.....		SUBSEQUENT REPORT OF ABANDONMENT.....
NOTICE OF INTENTION TO PULL OR ALTER CASING.....		SUPPLEMENTARY WELL HISTORY.....
NOTICE OF INTENTION TO ABANDON WELL.....		

(INDICATE ABOVE BY CHECK MARK NATURE OF REPORT, NOTICE, OR OTHER DATA)

29-7 Unit
Well No. 74, S.J. is located 1190 ft. from S line and 1190 ft. from W line of sec. 25
SW/4 25 29N 7W N.M.P.S.
(1/4 Sec. and Sec. No.) (Twp.) (Range) (Meridian)
Blanco Mesaverde Rio Arriba New Mexico
(Field) (County or Subdivision) (State or Territory)

The elevation of the derrick floor above sea level is 6374 ft. GL

DETAILS OF WORK

(State names of and expected depths to objective sands; show sizes, weights, and lengths of proposed casings; indicate mudding job, cementing points, and all other important proposed work)

The objective sands are the Cliff House and Point Lookout anticipated at approximately 4909' and 5325' respectively.

Proposed Casing Programs: 200' 10-3/4" cemented to surface
3380' 7-5/8" cemented w/150 sx.
2395' 5 1/2" liner cemented w/250 sx.

Rotary tools will be used mud drilling through Pictured Cliffs and gas drilling to TD This well will be mud fraced in an effort to stimulate production.

I understand that this plan of work must receive approval in writing by the Geological Survey before operations may be commenced.

Company SOUTHERN UNION GAS COMPANY
Address P. O. Box 815
Farmington, New Mexico
By Paul L. Haseltine
Title Drilling Superintendent

NEW MEXICO OIL CONSERVATION COMMISSION

Well Location and Acreage Dedication Plat

Section A.

Date July 8, 1959

Operator Southern Union Gas Company Lease San Juan 29-7 Unit
Well No. 74 Unit Letter M Section 25 Township 29 North Range 7 West NMFM
Located 1190 Feet From South Line, 1190 Feet From West Line
County Rio Arriba G. L. Elevation 6374 Dedicated Acreage 320 Acres
Name of Producing Formation Mesaverde Pool Blanco - Mesaverde

1. Is the Operator the only owner* in the dedicated acreage outlined on the plat below?
Yes No X.
2. If the answer to question one is "no," have the interests of all the owners been consolidated by communitization agreement or otherwise? Yes X No . If answer is "yes," Type of Consolidation Unit Agreement
3. If the answer to question two is "no," list all the owners and their respective interests below:

Owner

Land Description

Section B

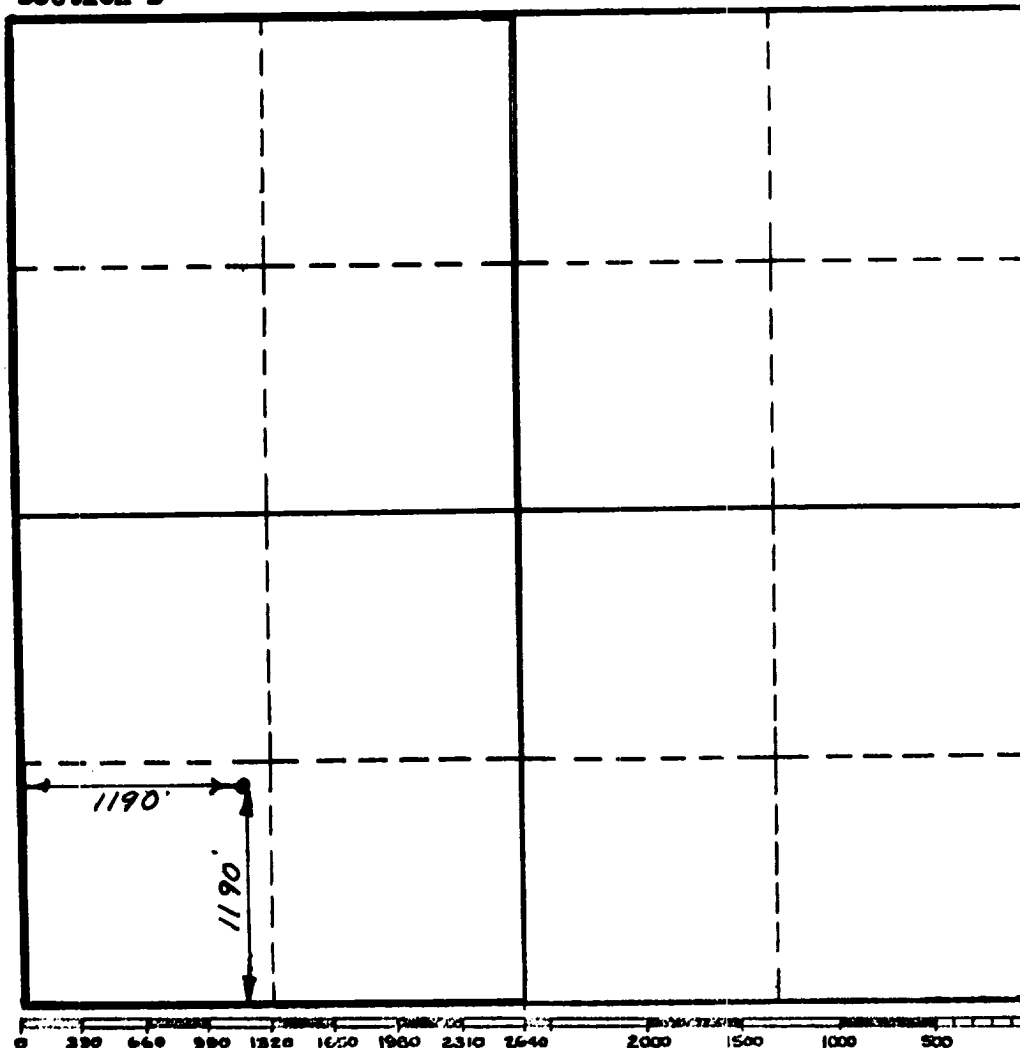

This is to certify that the information in Section A above is true and complete to the best of my knowledge and belief.

SOUTHERN UNION GAS COMPANY
(Operator)
Oran L. Haseltine
(Representative)

P. O. Box 815, Farmington
Address

This is to certify that the well location shown on the plat in Section B was plotted from field notes of actual surveys made by me or under my supervision and that the same is true and correct to the best of my knowledge and belief.

Date Surveyed July 2, 1959

C. L. Poter
Registered Professional
Engineer and/or Land Surveyor.

Certificate No. 3084

NEW MEXICO OIL CONSERVATION COMMISSION

Well Location and Acreage Dedication Plat

Date July 8, 1959

Section A

Operator Southern Union Gas Company Lease 25 Township 29 North Range 7 West NMMN
Well No. 1190 Unit Letter M Section 25 Located 1190 feet from South line, West line
County Rio Arriba G. L. Elevation 6374 Dedicated Acreage 320 Acres
Name of Producing Formation Permian - Mesaverde Pool Permian - Mesaverde
1. Is the Operator the only owner* in the dedicated acreage outlined on the plat below?
Yes No X
2. If the answer to question one is "no," have the interests of all the owners been
consolidated by communication agreement or otherwise? Yes No X. If answer is
"yes," type of Consolidation Joint Interest
3. If the answer to question two is "no," list all the owners and their respective interests
below:

Land Description

Owner

Section B

This is to certify that the
information in Section A
above is true and complete
to the best of my knowledge
and belief.

(Operator)

(Representative)

Address

This is to certify that the
well location shown on the
plat in Section B was plotted
from field notes of actual
surveys made by me or under
my supervision and that the
same is true and correct to
the best of my knowledge and
belief.

Date Surveyed July 5, 1959

Registered Professional
Engineer and/or Land Surveyor

Certificate No. 5081