

STATE OF NEW MEXICO  
OIL CONSERVATION  
COMMISSION  
DISTRICT NO. 3  
Phone 99 P. O. Box 697  
AZTEC, NEW MEXICO

(SUBMIT IN TRIPLICATE)  
UNITED STATES  
DEPARTMENT OF THE INTERIOR  
GEOLOGICAL SURVEY

Santa Fe  
Land Office 077842  
Lease No. W/2 Sec. 15, 29-N., 7-W.  
Unit

RECEIVED

OCT 31 1952

U. S. GEOLOGICAL SURVEY  
FARMINGTON, N. M.

SUNDRY NOTICES AND REPORTS ON WELLS

NOTICE OF INTENTION TO DRILL	SUBSEQUENT REPORT OF WATER SHUT-OFF
NOTICE OF INTENTION TO CHANGE PLANS	SUBSEQUENT REPORT OF SHOOTING OR ACIDIZING
NOTICE OF INTENTION TO TEST WATER SHUT-OFF	SUBSEQUENT REPORT OF ALTERING CASING
NOTICE OF INTENTION TO RE-DRILL OR REPAIR WELL	SUBSEQUENT REPORT OF REDRILLING OR REPAIR
NOTICE OF INTENTION TO SHOOT OR ACIDIZE	SUBSEQUENT REPORT OF ABANDONMENT
NOTICE OF INTENTION TO PULL OR ALTER CASING	SUPPLEMENTARY WELL HISTORY
NOTICE OF INTENTION TO ABANDON WELL	

(INDICATE ABOVE BY CHECK MARK NATURE OF REPORT, NOTICE, OR OTHER DATA)

October 28, 1952

Well No. 1 Lease is located 1650 ft. from [N] line and 1650 ft. from [E] line of sec. 15  
[SW] Sec. 15 T-29-N., R-7-W. N.M.P.M.  
(1/4 Sec. and Sec. No.) (Twp.) (Range) (Meridian)  
Blanco (EXT) Rio Arriba County New Mexico  
(Field) (County or Subdivision) (State or Territory)

The elevation of the derrick floor above sea level is \_\_\_\_\_ ft. To be furnished

DETAILS OF WORK

(State names of and expected depths to objective sands; show sizes, weights, and lengths of proposed casings; indicate mudlogging jobs, cementing points, and all other important proposed work)

The objective sands are the Cliff House and Point Lookout. Their respective tops are expected at about 4790 and 5230'. The producing string will be 7" O.D. casing which will be cemented.

Approximate casing program:

200' of 9-5/8" Surface casing cemented with about 75 sacks  
4740' of 7" O.D. casing cemented with about 175 sacks

Well will be drilled with rotary tools to top of Cliff House, and 7" casing set. The pay sands will be drilled in with rotary using natural gas method to a total depth of approximately 5450 feet.

Well will then be shot with approximately 1800 quarts of nitro glycerine

I understand that this plan of work must receive approval in writing by the Geological Survey before operations may be commenced.

Company SOUTHERN UNION GAS COMPANY

Address 1104 Burt Bldg.,

Dallas, Texas

By Van Thompson  
Title Manager Exploration Dept.



GEOLOGICAL SURVEY  
DEPARTMENT OF THE INTERIOR  
UNITED STATES  
(SUBMIT IN TRIPLICATE)

NOI TAVOLINO LO  
NOI SI, MOO

SUNDRY NOTICES AND REPORTS ON WELLS

INDICATE THE NATURE OF REPORT, LOSS OR OTHER FACT	
NOTICE OF INTENTION TO ABANDON WELL	SUBSEQUENT REPORT OF ABANDONMENT
NOTICE OF INTENTION TO PULL OF WELL CASING	SUPPLEMENTARY WELL HISTORY
NOTICE OF INTENTION TO SHOOT OR WHIPPLE	SUBSEQUENT REPORT OF ABANDONMENT
NOTICE OF INTENTION TO RE-DRILL OR REPAIR WELL	SUBSEQUENT REPORT OF RE-DRILLING OR REPAIR
NOTICE OF INTENTION TO TEST WATER BOND OR LIFT	SUBSEQUENT REPORT OF WATERING CASING
NOTICE OF INTENTION TO CHANGE PLUGS	SUBSEQUENT REPORT IN SHOOTING OR ACIDIZING
NOTICE OF INTENTION TO DRILL	SUBSEQUENT REPORT OF WATER SHUT-OFF

[illegible]

THE NEW YORK PUBLIC LIBRARY

1. The first part of the document is a letter from the President of the United States to the Congress, dated January 3, 1862. It is a message of condolence to the people of the State of California, who have been afflicted by a severe earthquake. The President expresses his sympathy for the victims and offers his assistance in the reconstruction of the State.

2. The second part of the document is a report from the Secretary of the Interior, dated January 10, 1862. It contains information about the progress of the survey of the public lands in California, and the results of the examination of the claims of the State of California to the public lands.

3. The third part of the document is a report from the Secretary of the Interior, dated January 10, 1862. It contains information about the progress of the survey of the public lands in California, and the results of the examination of the claims of the State of California to the public lands.

4. The fourth part of the document is a report from the Secretary of the Interior, dated January 10, 1862. It contains information about the progress of the survey of the public lands in California, and the results of the examination of the claims of the State of California to the public lands.

5. The fifth part of the document is a report from the Secretary of the Interior, dated January 10, 1862. It contains information about the progress of the survey of the public lands in California, and the results of the examination of the claims of the State of California to the public lands.

6. The sixth part of the document is a report from the Secretary of the Interior, dated January 10, 1862. It contains information about the progress of the survey of the public lands in California, and the results of the examination of the claims of the State of California to the public lands.

7. The seventh part of the document is a report from the Secretary of the Interior, dated January 10, 1862. It contains information about the progress of the survey of the public lands in California, and the results of the examination of the claims of the State of California to the public lands.

8. The eighth part of the document is a report from the Secretary of the Interior, dated January 10, 1862. It contains information about the progress of the survey of the public lands in California, and the results of the examination of the claims of the State of California to the public lands.

9. The ninth part of the document is a report from the Secretary of the Interior, dated January 10, 1862. It contains information about the progress of the survey of the public lands in California, and the results of the examination of the claims of the State of California to the public lands.

10. The tenth part of the document is a report from the Secretary of the Interior, dated January 10, 1862. It contains information about the progress of the survey of the public lands in California, and the results of the examination of the claims of the State of California to the public lands.



Company \_\_\_\_\_

Address \_\_\_\_\_

RECEIVED

OCT 31 1952

U. S. GEOLOGICAL SURVEY  
FARM BUREAU, N. M.

Company.....Southern Union Gas Company.....

Lease.....1188..... Well No.....2.....

Sec.....15....., T.....29 N......, R.....7 W......, N.M.P.M.....

Location.....1650' from the South line and 1650' from the West line......

~~XXXXXXXXXXXXXXXXXXXXXXXXXXXX~~

Rio Arriba County

New Mexico

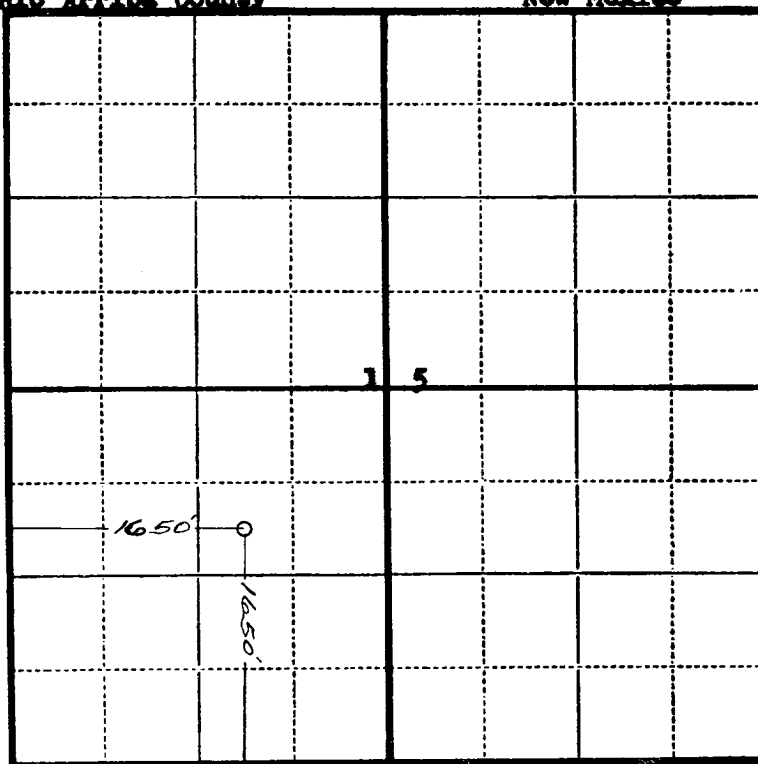

Scale—4 inches equal 1 mile.

This is to certify that the above plat was prepared from field notes of actual surveys made by me or under my supervision and that the same are true and correct to the best of my knowledge and belief.

*Charles J. Pinklea*

Seal:

Registered Professional  
Engineer and Land Surveyor.

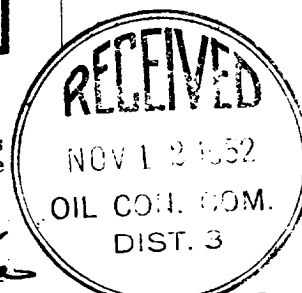

Charles J. Pinklea  
N. Mex. Reg. No. 1302

Surveyed .....October 22....., 19...52.....