

## DISTRICT I

P.O. Box 1980, Hobbs, NM 88241-1980

## DISTRICT II

811 South First St., Artesia, NM 88210-2835

## DISTRICT III

1000 Rio Brazos Rd, Aztec, NM 87410-1693

State of New Mexico  
Energy, Minerals and Natural Resources Department

## OIL CONSERVATION DIVISION

2040 S. Pacheco  
Santa Fe, New Mexico 87505-6429Form C-107-A  
New 3-12-96

## APPROVAL PROCESS :

☒ Administrative  
☐ Hearing

## APPLICATION FOR DOWNHOLE COMMINGLING

## EXISTING WELLBORE

☒ YES ☐ NO

Burlington Resources Oil and Gas

PO Box 4289, Farmington, NM 87499

Operator

San Juan 29-7 Unit #109-M J-30-29N-07W Rio Arriba

Address

Lease

Well No.

Unit Ltr. - Sec - Twp - Rge

County

Spacing Unit Lease Types: (check 1 or more)

OGRID NO. 14538 Property Code 7465 API NO. 30-039-22399 Federal ☒ State ☐ Fee ☐

The following facts are submitted in support of downhole commingling:	Upper Zone	Intermediate Zone	Lower Zone
1. Pool Name and Pool Code	Mesa Verde - 72319		Dakota - 71599
2. Top and Bottom of Pay Section (Perforations)	4631'-5549'		7261'-7483'
3. Type of production (Oil or Gas)	Gas		Gas
4. Method of Production (Flowing or Artificial Lift)	Flowing		Flowing
5. Bottomhole Pressure Oil Zones - Artificial Lift: Estimated Current Gas & Oil - Flowing: Measured Current All Gas Zones: Estimated or Measured Original	(Current) a. 364 psi (see attachment)  (Original) b. 1045 psi (see attachment)		a. 330 psi (see attachment)  b. 2318 psi (see attachment)
6. Oil Gravity ( $^{\circ}$ API) or Gas BTU Content	BTU 1225		BTU 1134
7. Producing or Shut-In?	Producing		Producing
Production Marginal? (yes or no)	No		Yes
* If Shut-In and oil/gas/water rates of last production  Note: For new zones with no production history, applicant shall be required to attach production estimates and supporting data	Date: N/A Rates:		Date: N/A Rates:
* If Producing, give data and oil/gas/water water of recent test (within 60 days)	Date: 12/97 Rates: 212 mcf/d 1.2 bopd		Date: 12/97 Rates: 8.0 mcf/d 0.0 bopd
8. Fixed Percentage Allocation Formula - % for each zone (total of %'s to equal 100%)	Will be supplied upon completion.		Will be supplied upon completion.

9. If allocation formula is based upon something other than current or past production, or is based upon some other method, submit attachments with supporting data and/or explaining method and providing rate projections or other required data.

10. Are all working, overriding, and royalty interests identical in all commingled zones? ☐ Yes ☒ No  
If not, have all working, overriding, and royalty interests been notified by certified mail? ☐ Yes ☒ No  
Have all offset operators been given written notice of the proposed downhole commingling? ☐ Yes ☒ No11. Will cross-flow occur? ☒ Yes ☐ No If yes, are fluids compatible, will the formations not be damaged, will any cross-flowed production be recovered, and will the allocation formula be reliable. ☒ Yes ☐ No (If No, attach explanation)12. Are all produced fluids from all commingled zones compatible with each other? ☒ Yes ☐ No13. Will the value of production be decreased by commingling? ☐ Yes ☒ No (If Yes, attach explanation)14. If this well is on, or communitized with, state or federal lands, either the Commissioner of Public Lands or the United States Bureau of Land Management has been notified in writing of this application. ☒ Yes ☐ No

15. NMOC Reference Cases for Rule 303(D) Exceptions: ORDER NO(S). Reference Order # R-10697

## 16. ATTACHMENTS:

- \* C-102 for each zone to be commingled showing its spacing unit and acreage dedication.
- \* Production curve for each zone for at least one year. (If not available, attach explanation.)
- \* For zones with no production history, estimated production rates and supporting data.
- \* Data to support allocation method or formula.
- \* Notification list of all offset operators.
- \* Notification list of working, overriding, and royalty interests for uncommon interest cases.
- \* Any additional statements, data, or documents required to support commingling.

I hereby certify that the information above is true and complete to the best of my knowledge and belief.

SIGNATURE L. Tom Loveland TITLE Engineer I DATE 03-02-98TYPE OR PRINT NAME L. Tom Loveland TELEPHONE NO. ( 505 ) 326-9700

All distances must be from the outer boundaries of the Section.

Operator EL PASO NATURAL GAS COMPANY			Lease SAN JUAN 29-7 UNIT (SF078503)		Well No. 109-M
Unit Letter J	Section 30	Township 29N	Range 7W	County Rio Arriba	
Actual Footage Location of Well: 1520' feet from the South line and 1810 feet from the East line					
Ground Level Elev. 6303	Producing Formation MESA VERDE - DAKOTA		Pool BLANCO MESA VERDE BASIN DAKOTA	Dedicated Acreage: 320.00 & 320.00 Acres	

1. Outline the acreage dedicated to the subject well by colored pencil or hachure marks on the plat below.
2. If more than one lease is dedicated to the well, outline each and identify the ownership thereof (both as to working interest and royalty).
3. If more than one lease of different ownership is dedicated to the well, have the interests of all owners been consolidated by communitization, unitization, force-pooling, etc?

☒ Yes ☐ No If answer is "yes," type of consolidation Unitization

If answer is "no," list the owners and tract descriptions which have actually been consolidated. (Use reverse side of this form if necessary.)

No allowable will be assigned to the well until all interests have been consolidated (by communitization, unitization, forced-pooling, or otherwise) or until a non-standard unit, eliminating such interests, has been approved by the Commission.

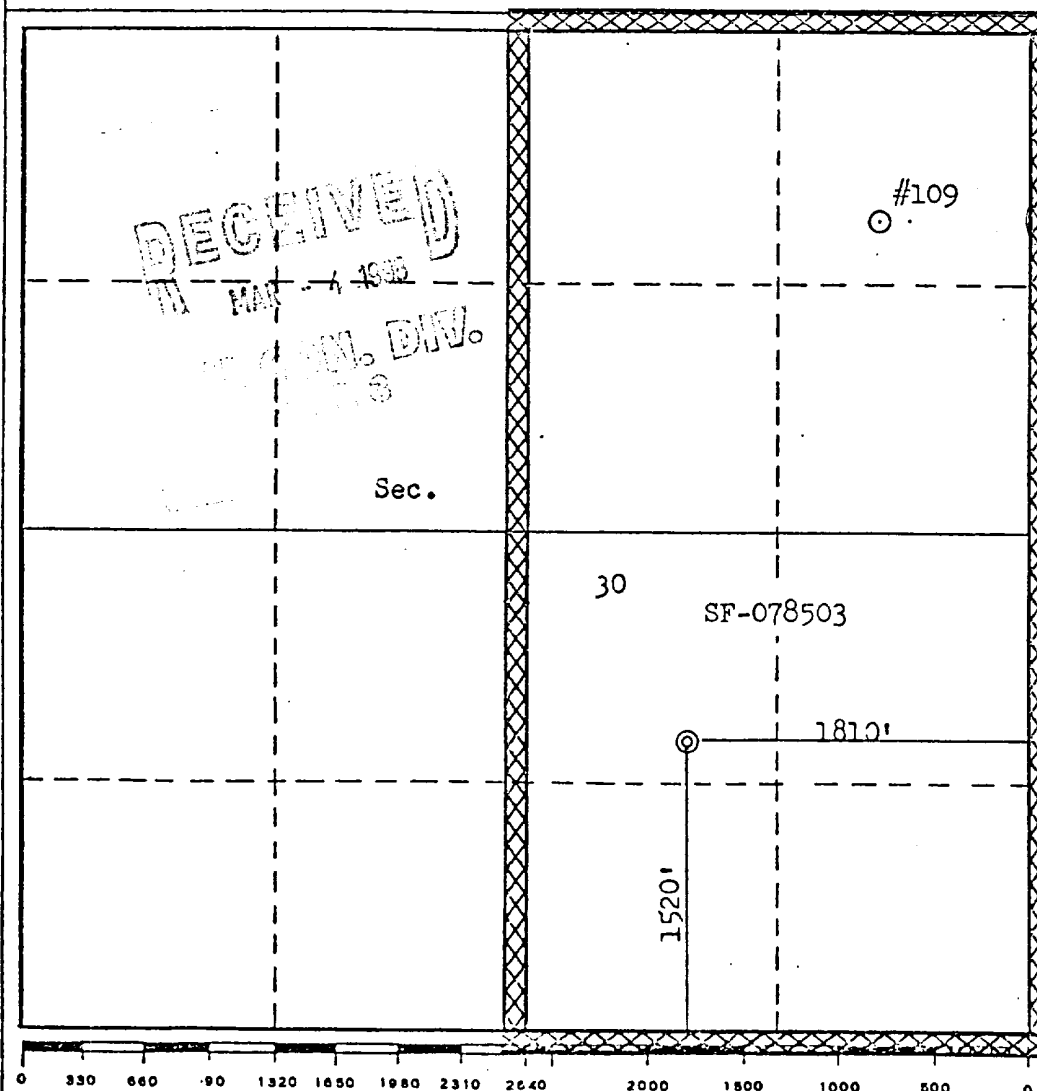

## CERTIFICATION

I hereby certify that the information contained herein is true and complete to the best of my knowledge and belief.

Name  
Drilling Clerk  
Position  
El Paso Natural Gas Co.  
Company  
April 23, 1980  
Date

I hereby certify that the well location shown on this plat was plotted from field notes of actual surveys made by me or under my supervision, and that the same is true and correct to the best of my knowledge and belief.

Date Surveyed  
March 18, 1980  
Registered Professional Engineer  
and/or Land Surveyor  
Fred B. Kern Jr.  
Certificate No.  
3950

ml

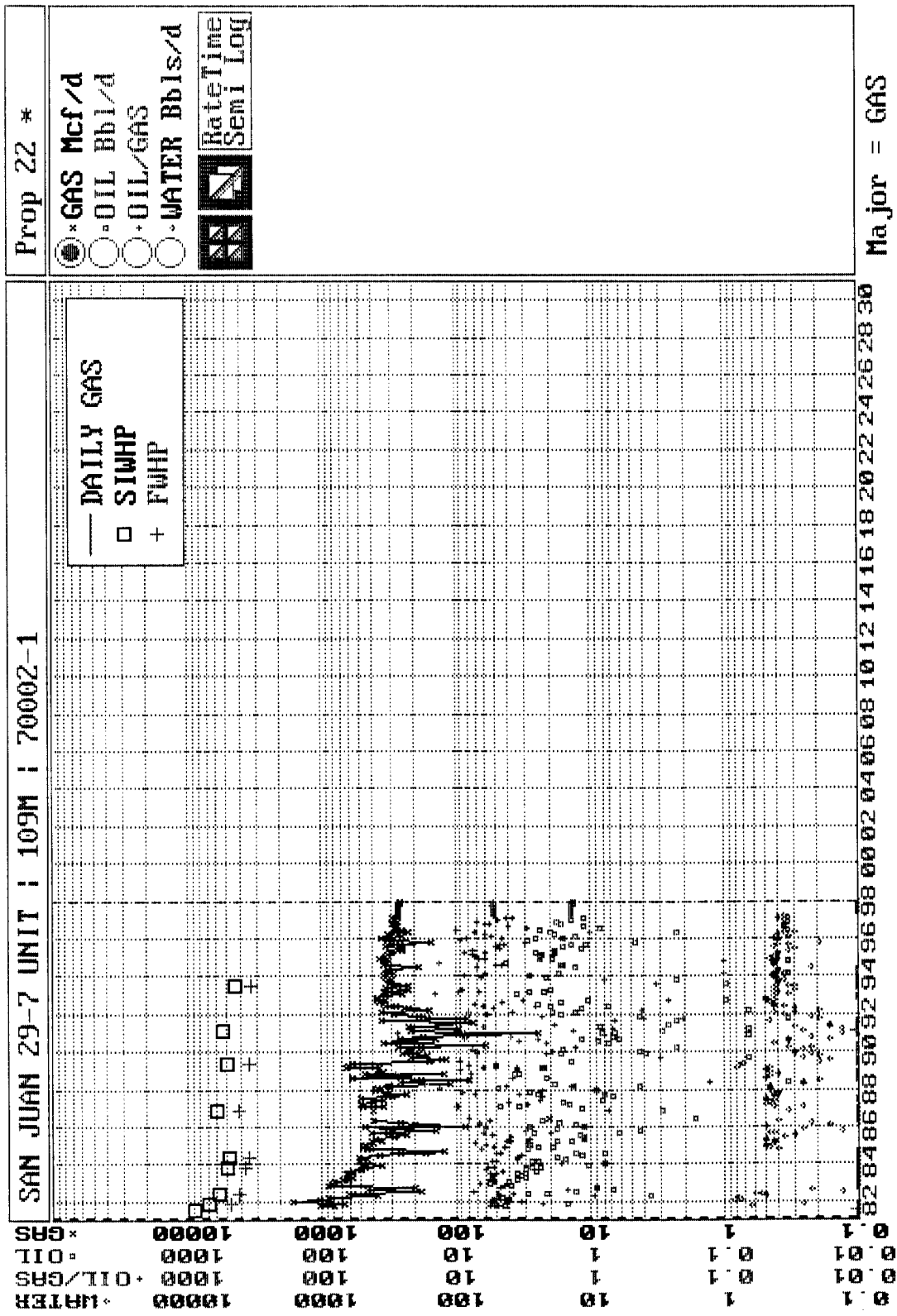

OK

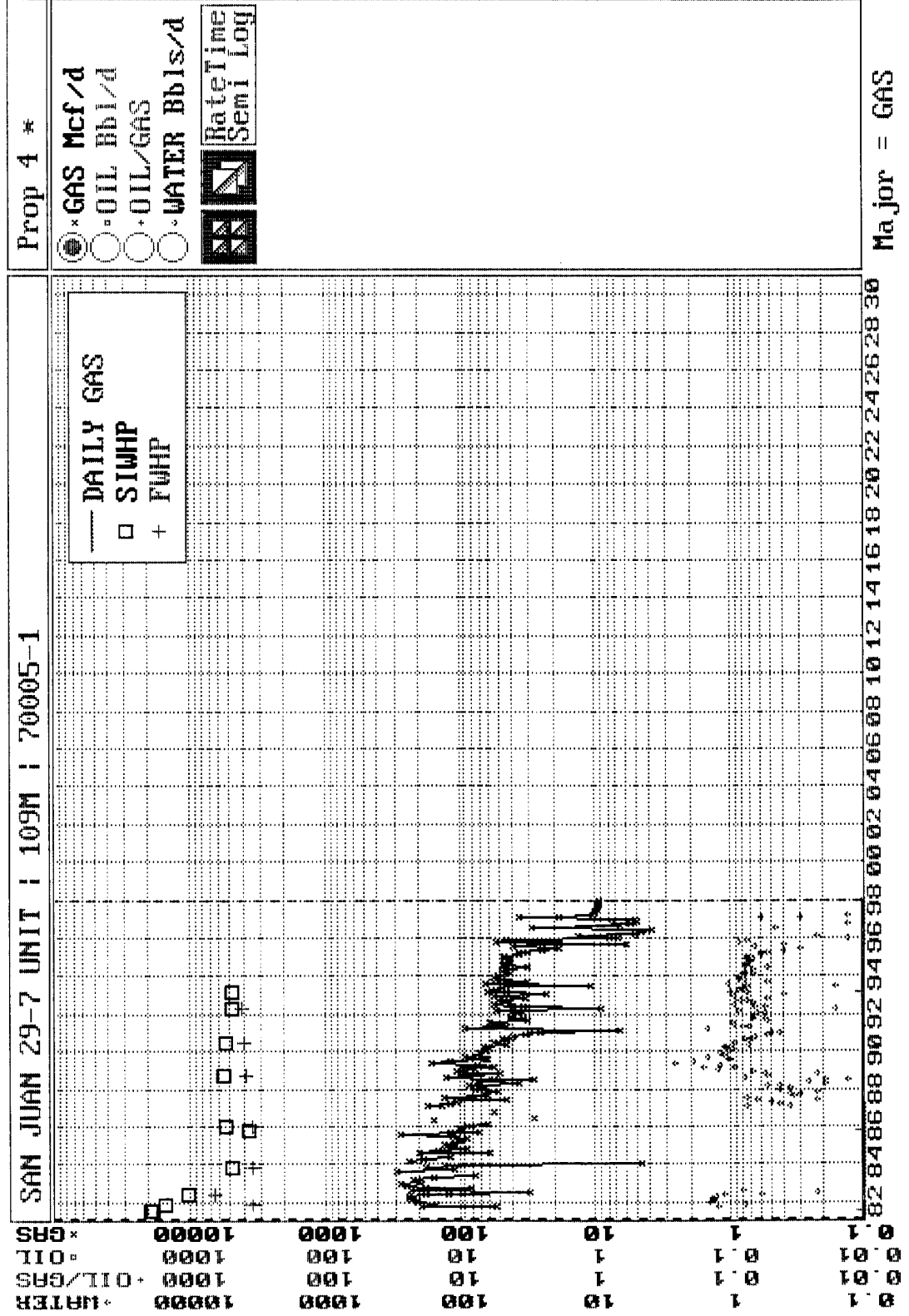

**San Juan 29-7 Unit #109M**  
**Bottom Hole Pressures**  
**Flowing and Static BHP**  
**Cullender and Smith Method**

Version 1.0 1/14/98

<b>Mesaverde</b>		<b>Dakota</b>	
<b><u>MV-Current</u></b>		<b><u>DK-Current</u></b>	
GAS GRAVITY	0.716	GAS GRAVITY	0.653
COND. OR MISC. (C/M)	C	COND. OR MISC. (C/M)	C
%N2	0.28	%N2	0.28
%CO2	0.83	%CO2	0.28
%H2S	0	%H2S	0
DIAMETER (IN)	7	DIAMETER (IN)	2.375
DEPTH (FT)	5090	DEPTH (FT)	7372
SURFACE TEMPERATURE (DEG F)	60	SURFACE TEMPERATURE (DEG F)	60
BOTTOMHOLE TEMPERATURE (DEG F)	143	BOTTOMHOLE TEMPERATURE (DEG F)	180
FLOWRATE (MCFPD)	0	FLOWRATE (MCFPD)	0
SURFACE PRESSURE (PSIA)	320	SURFACE PRESSURE (PSIA)	280
BOTTOMHOLE PRESSURE (PSIA)	364.1	BOTTOMHOLE PRESSURE (PSIA)	329.5
<b><u>MV-Original</u></b>		<b><u>DK-Original</u></b>	
GAS GRAVITY	0.716	GAS GRAVITY	0.653
COND. OR MISC. (C/M)	C	COND. OR MISC. (C/M)	C
%N2	0.28	%N2	0.28
%CO2	0.83	%CO2	0.28
%H2S	0	%H2S	0
DIAMETER (IN)	7	DIAMETER (IN)	2.375
DEPTH (FT)	5090	DEPTH (FT)	7372
SURFACE TEMPERATURE (DEG F)	60	SURFACE TEMPERATURE (DEG F)	60
BOTTOMHOLE TEMPERATURE (DEG F)	143	BOTTOMHOLE TEMPERATURE (DEG F)	180
FLOWRATE (MCFPD)	0	FLOWRATE (MCFPD)	0
SURFACE PRESSURE (PSIA)	905	SURFACE PRESSURE (PSIA)	1908
BOTTOMHOLE PRESSURE (PSIA)	1045.3	BOTTOMHOLE PRESSURE (PSIA)	2318.0

MV

Page No.: 5  
 Print Time: Tue Jan 06 06:48:40 1998  
 Property ID: 22  
 Property Name: SAN JUAN 29-7 UNIT | 109M | 70002-1  
 Table Name: S:\ARIES\RSCOM98\TEST.DBF

--DATE--	--CUM_OIL- Bbl	---CUM_GAS-- Mcf	M_SIWHP Psi
----------	-------------------	---------------------	----------------

07/29/81		0	905.0	Original
11/17/81		74691	709.0	
05/25/82		237649	589.0	
11/01/83		534477	500.0	
06/01/84		631205	483.0	
12/01/86		859349	597.0	
05/18/89		1182721	510.0	Current Estimated from P/z data
02/18/91		1297068	537.0	
07/05/93		1543438	445.0	
12/01/97		1973084	320.0	

NC

Page No.: 1  
 Print Time: Tue Jan 06 06:48:39 1998  
 Property ID: 4  
 Property Name: SAN JUAN 29-7 UNIT | 109M | 70005-1  
 Table Name: S:\ARIES\RSCOM98\TEST.DBF

--DATE--	--CUM OIL-- Bbl	---CUM GAS-- Mcf	M SIWHP Psi	
07/22/81		0	1908.0	Original
07/29/81		0	1921.0	
11/17/81		11985	1541.0	
05/25/82		51789	1029.0	
11/01/83		131150	493.0	
09/25/85		207389	374.0	
01/17/86		218843	538.0	
08/31/88		278949	572.0	
05/30/90		328977	535.0	
04/29/92		357927	491.0	
03/19/93		373039	491.0	
12/01/97		419980	280.0	Current Estimated from P/z data

FARMINGTON 1997 MONTHLY PRODUCTION FOR 70002  
 SAN JUAN 29-7 UNIT 109M  
 BLANCO MESAVERDE (PRORATED GAS FIELD MESAVERDE ZONE

PHS030M1

DAYS			OIL			GAS								
MO	T	S	ON	PC	PROD	GRV	PC	PROD	ON	BTU	PRESS	WATER	PROD	C
1				02	34		01	9050		1225	15.025		12	
2				02	34		01	8123		1225	15.025		10	
3				02	16		01	8492		1225	15.025		11	
4				02	28		01	8235		1225	15.025		11	
5				02	19		01	8841		1225	15.025		11	
6	2	F	24	02	36	62.0	01	6711	24	1225	15.025		9	
7	2	F	31	02	32		01	7177	31	1225	15.025		9	
8	2	F	31	02	38	63.0	01	6474	31	1225	15.025		8	
9	2	F	30	02	15		01	8301	30	1225	15.025		11	
10	2	F	31	02	85		01	7509	31	1225	15.025		10	
11	2	F	30	02	35		01	6039	30	1225	15.025		8	
12	2	F	31	02	36		01	6585	31	1223	15.025		8	

36831 = 1.16 bopd

658531 = 212.4 mcf/d

PF6 - RETURNS TO ANNUAL DISPLAY  
 PF10 - HELP INFORMATION

PF3 - TRANSFER TO UPDATE  
 PF9 - DISPLAY MONTHLY INJECTION

00/00/00 00:00:00:0

PRS 02/04/98



FARMINGTON 1997 MONTHLY PRODUCTION FOR 70005

PHS030M1

SAN JUAN 29-7 UNIT 109M

BASIN DAKOTA (PRORATED GAS) FIELD

DAKOTA ZONE

DAYS =====				OIL =====			GAS =====							
MO	T	S	ON	PC	PROD	GRV	PC	PROD	ON	BTU	PRESS	WATER	PROD	C
1							01	1121		1134	15.025		18	
2							01	557		1134	15.025		9	
3							01	219		1134	15.025		4	
4							01	181			15.025		3	
5							01	187			15.025		3	
6	2	F	22				01	133	22		15.025		2	
7	2	F	31				01	187	31		15.025		3	
8	2	F	31				01	1042	31	1134	15.025		17	
9	2	F	30				01	237	30	1134	15.025		4	
10	2	F	31				01	187	31		15.025		3	
11	2	F	30				01	181	30		15.025		3	
12	2	F	31				01	187	31		15.025		3	

187431 = 6.03 mcf/d

PF6 - RETURNS TO ANNUAL DISPLAY

PF3 - TRANSFER TO UPDATE

PF10 - HELP INFORMATION

PF9 - DISPLAY MONTHLY INJECTION

00/00/00 00:00:00:0

PRS 02/04/98

***BURLINGTON RESOURCES OIL AND GAS COMPANY***

**San Juan 29-7 Unit #109M**

**OFFSET OPERATOR/OWNER PLAT  
Mesaverde / Dakota Formations Commingle Well**

**Township 29 North, Range 7 West**

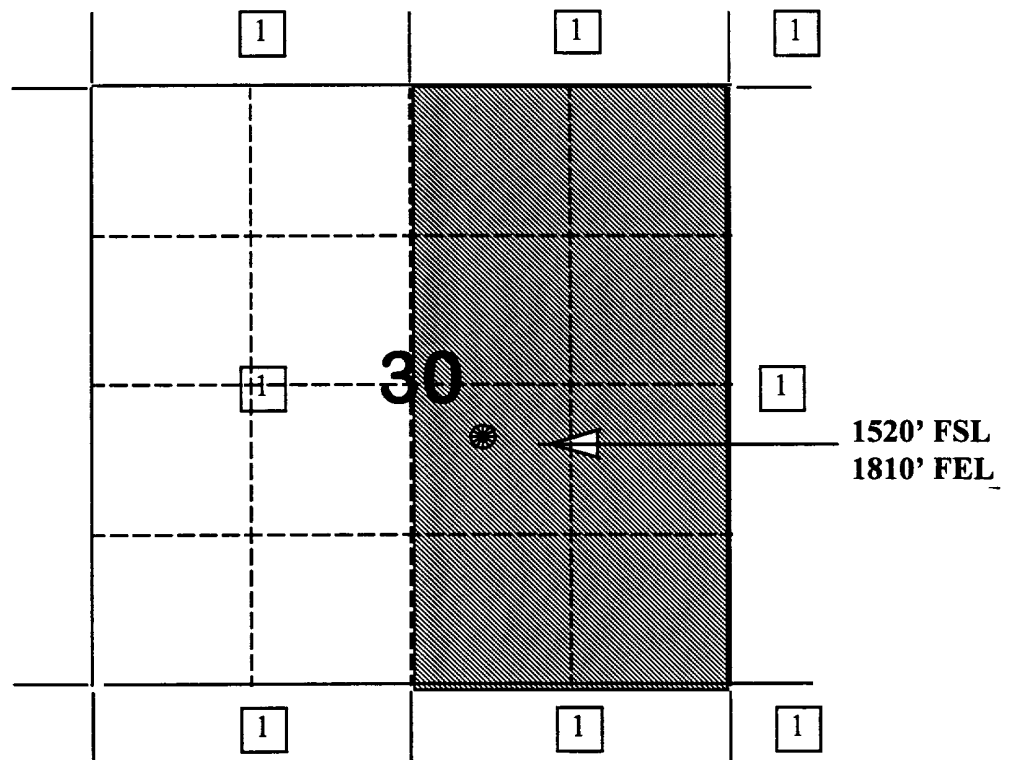

**1) Burlington Resources**



STATE OF NEW MEXICO  
ENERGY, MINERALS AND NATURAL RESOURCES DEPARTMENT  
OIL CONSERVATION DIVISION

IN THE MATTER OF THE HEARING  
CALLED BY THE OIL CONSERVATION  
DIVISION FOR THE PURPOSE OF  
CONSIDERING:

CASE NO. 11629  
ORDER NO. R-10697

APPLICATION OF BURLINGTON RESOURCES  
OIL & GAS COMPANY FOR THE ESTABLISHMENT  
OF A DOWNHOLE COMMINGLING "REFERENCE  
CASE" FOR ITS SAN JUAN 29-7 UNIT PURSUANT  
TO DIVISION RULE 303.E. AND THE ADOPTION  
OF SPECIAL ADMINISTRATIVE RULES THEREFOR,  
SAN JUAN COUNTY, NEW MEXICO.

ORDER OF THE DIVISION

BY THE DIVISION:

This cause came on for hearing at 8:15 a.m. on October 17, and November 7, 1996, at Santa Fe, New Mexico, before Examiners David R. Catanach and Michael E. Stogner, respectively.

NOW, on this 8th day of November, 1996, the Division Director, having considered the testimony, the record and the recommendations of the Examiner, and being fully advised in the premises.

FINDS THAT:

- (1) Due public notice having been given as required by law, the Division has jurisdiction of this cause and the subject matter thereof.
- (2) The applicant, Burlington Resources Oil & Gas Company (Burlington), pursuant to the provisions of Division Rule 303.E., seeks to establish a downhole commingling "reference case" to provide exceptions for (a) marginal economic criteria, (b) pressure criteria, (c) allocation formulas and (d) modification of notification rules on a unit-wide basis for downhole commingling of Dakota, Mesaverde, Fruitland Coal and Pictured Cliffs gas production within existing or future drilled wells within the San Juan 29-7 Unit, San Juan County, New Mexico.
- (3) Division Rule No. 303.E., amended by Order No. R-10470-A, currently states:

"If sufficient data exists on a lease, pool, formation, geographic area, etc., so as to render it unnecessary to repeatedly provide such data on Form C-107-A, an operator may except any of the various criteria required under Paragraph 303.D. of this rule by establishing a "reference case". The Division, upon its own motion, or by application from an operator, may establish "reference cases" either administratively or by hearing. Upon Division approval of such "reference cases" for specific criteria, subsequent applications to downhole commingle (Form C-107-A) will be required only to cite the Division order number which established such exceptions and shall not be required to submit data for those criteria."

(4) The applicant is the current operator of the San Juan 29-7 Unit which encompasses some 22,500 acres in Township 29 North, Range 7 West, NMPM, San Juan County, New Mexico.

(5) Within the San Juan 29-7 Unit, the applicant currently operates fifty-five (55) Basin-Dakota Gas Pool wells, one hundred thirty-one (131) Blanco-Mesaverde Gas Pool wells, thirteen (13) Blanco-Pictured Cliffs and South Blanco-Pictured Cliffs Gas Pool wells, and forty-nine (49) Basin-Fruitland Coal Gas Pool wells.

(6) According to its evidence and testimony, Burlington seeks to:

- a) establish a "reference case" for marginal economic criteria in the Dakota and Pictured Cliffs formations whereby these formations and/or pools may be identified as "marginal" on Form C-107-A's subsequently filed for wells within the San Juan 29-7 Unit. The applicant further proposes that the data provided in the immediate case serve as supplemental data or confirmation that these formations and/or pools should be classified as "marginal";
- b) establish a "reference case" for pressure criteria in the Dakota and Pictured Cliffs formations whereby the Division may utilize data provided in the immediate case to verify the pressure data provided on Form C-107-A's subsequently filed for wells within the San Juan 29-7 Unit;
- c) establish a "reference case" whereby the Division utilizes the data presented in the immediate case to endorse or approve certain methods of allocating production whereby the applicant need not submit additional data or justification when proposing a certain method of allocating production on Form C-107-A's subsequently filed for wells within the San Juan 29-7 Unit; and.

- d) establish a "reference case" or an administrative procedure for authorizing the downhole commingling of existing or future drilled wells within the San Juan 29-7 Unit without additional notice to each affected interest owner as required by Division Rule No. 303.D.

(7) In support of its request to except marginal economic criteria, the applicant presented geologic and engineering evidence and testimony which indicates that within the San Juan 29-7 Unit:

- a) the structure and thickness of the Dakota and Pictured Cliffs formations are very consistent;
- b) the average recoverable Dakota and Pictured Cliffs gas reserves underlying an undeveloped drill block are approximately 245 MMCFG and 76 MMCFG, respectively;
- c) the average initial producing rate for a newly drilled or recompleted Dakota and Pictured Cliffs gas well is approximately 218 MCFGD and 238 MCFGD, respectively; and,
- d) the estimated ultimate gas recoveries and initial producing rates from the Dakota and Pictured Cliffs formations are insufficient to justify drilling stand alone wells and/or dually completed wells to recover such gas reserves.

(8) The evidence and testimony presented by the applicant indicates that the Dakota and Pictured Cliffs formations within the San Juan 29-7 Unit should be properly classified as "marginal".

(9) In support of its request to except pressure criteria within the Dakota and Pictured Cliffs formations within the San Juan 29-7 Unit, the applicant presented engineering evidence and testimony which indicates that:

- a) the average shut-in bottomhole pressure within the Dakota and Pictured Cliffs formations at the time of initial development was approximately 3,209 psi and 1,148 psi, respectively; and,
- b) the average current shut-in bottomhole pressure within the Dakota and Pictured Cliffs formations is approximately 952 psi and 655 psi, respectively.

(10) There is sufficient pressure data available within the San Juan 29-7 Unit so as to except pressure criteria as proposed by the applicant.

(11) The applicant testified that various allocation methods will be utilized for downhole commingled wells within the San Juan 29-7 Unit depending on the circumstances. Some of the methods and circumstances are described as follows:

- a) the subtraction method will likely be utilized in those instances involving the Basin-Fruitland Coal Gas Pool and in those instances where a zone with a well established decline rate is commingled with a newly completed zone;
- b) a fixed allocation formula will be utilized in those instances where production history for both zones is available, or in those instances where newly completed zones are tested and stabilized flow rates obtained.

(12) The allocation methods proposed by the applicant are routinely utilized by industry and approved by the Division and therefore, the proposal to except allocation formulas should be approved.

(13) In support of its request to establish a "reference case" or administrative procedure for providing notice within the San Juan 29-7 Unit the applicant presented evidence and testimony which indicates that:

- a) the interest ownership between two zones within a given wellbore in the San Juan 29-7 Unit is generally not common;
- b) pursuant to Division Rule No. 303.D., applicant is currently required to notify all interest owners within the San Juan 29-7 Unit every time a Form C-107-A is submitted to the Division. There are a considerable number of such interest owners within the unit;
- c) providing notice to each interest owner within the San Juan 29-7 Unit of subsequent downhole comminglings is unnecessary and is an excessive burden on the applicant;
- d) the downhole commingling of wells within the San Juan 29-7 Unit Area will benefit working, royalty, and overriding royalty interest owners. In addition, the downhole commingling of wells within the San Juan 29-7 Unit should not violate the correlative rights of any interest owner;

- e) no interest owner appeared at the hearing in opposition to the establishment of a "reference case" or administrative procedure for notice.

(14) An administrative procedure should be established within the San Juan 29-7 Unit for obtaining approval for subsequent downhole commingled wells without notice to Unit interest owners, provided however that, all other provisions contained within Division Rule No. 303.C. are complied with.

(15) Approval of the proposed "reference cases" for marginal economic criteria, pressure criteria, allocation formulas and notice will lessen the burden on the applicant insofar as providing the data required pursuant to Division Rule No. 303.D. and Form C-107-A, will provide the applicant a streamlined method for obtaining downhole commingling approvals within the San Juan 29-7 Unit, and will not violate correlative rights.

**IT IS THEREFORE ORDERED THAT:**

(1) The application of Burlington Resources Oil & Gas Company to establish a "reference case" for (a) marginal economic criteria, (b) pressure criteria, (c) allocation formulas and (d) modification of notification rules on a unit-wide basis for downhole commingling of Dakota, Mesaverde, Fruitland Coal and Pictured Cliffs gas production within existing or future drilled wells within the San Juan 29-7 Unit, San Juan County, New Mexico, is hereby approved.

(2) Upon filing of Division Form No. C-107-A's for wells subsequently downhole commingled within the San Juan 29-7 Unit Area, the applicant shall not be required to submit supporting data to justify the classification of the Pictured Cliffs and Dakota formations as "marginal", supporting data to verify the Pictured Cliffs and Dakota pressure information provided, and support or justification for utilizing a given method or formula for allocation of production, provided however, in the event any of the data described above appearing on Form C-107-A appears to be beyond the data range provided in this case, the Division may require the submittal of additional supporting data.

(3) In order to obtain Division authorization to downhole commingle wells within the San Juan 29-7 Unit, the applicant shall file a Form C-107-A with the Santa Fe and Aztec Offices of the Division. Such application shall contain all the information required under Rule No. 303.C. of the Division Rules and Regulations, provided however that the applicant shall not be required to provide notice to all interest owners within the San Juan 29-7 Unit of such proposed commingling.



(4) Jurisdiction of this cause is retained for the entry of such further orders as the Division may deem necessary.

DONE at Santa Fe, New Mexico, on the day and year hereinabove designated.

STATE OF NEW MEXICO  
OIL CONSERVATION DIVISION

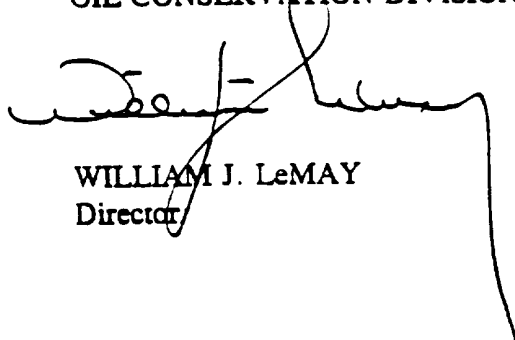

WILLIAM J. LeMAY  
Director

S E A L